



Equipped with AEM® Dryflow™ Filter
No Oil Required!

INSTALLATION INSTRUCTIONS

PART NUMBER: 21-9033DS

2010	CHEVROLET	Silverado 2500 HD	V8	6.6L	DSL	C.A.R.B. E.O. # D-670-13
2010	CHEVROLET	Silverado 3500 HD	V8	6.6L	DSL	C.A.R.B. E.O. # D-670-13
2010	GMC	Sierra 2500 HD	V8	6.6L	DSL	C.A.R.B. E.O. # D-670-13
2010	GMC	Sierra 3500 HD	V8	6.6L	DSL	C.A.R.B. E.O. # D-670-13
2009	CHEVROLET	Silverado 2500 HD	V8	6.6L	DSL	C.A.R.B. E.O. # D-670-13
2009	CHEVROLET	Silverado 3500 HD	V8	6.6L	DSL	C.A.R.B. E.O. # D-670-13
2009	GMC	Sierra 2500 HD	V8	6.6L	DSL	C.A.R.B. E.O. # D-670-13
2009	GMC	Sierra 3500 HD	V8	6.6L	DSL	C.A.R.B. E.O. # D-670-13
2008	CHEVROLET	Silverado 2500 HD	V8	6.6L	DSL	C.A.R.B. E.O. # D-670-13
2008	CHEVROLET	Silverado 3500 HD	V8	6.6L	DSL	C.A.R.B. E.O. # D-670-13
2008	GMC	Sierra 2500 HD	V8	6.6L	DSL	C.A.R.B. E.O. # D-670-13
2008	GMC	Sierra 3500 HD	V8	6.6L	DSL	C.A.R.B. E.O. # D-670-13
2007	CHEVROLET	Silverado 2500 HD	V8	6.6L	DSL	C.A.R.B. E.O. # D-670-13
2007	CHEVROLET	Silverado 3500 HD	V8	6.6L	DSL	C.A.R.B. E.O. # D-670-13
2007	GMC	Sierra 2500 HD	V8	6.6L	DSL	C.A.R.B. E.O. # D-670-13
2007	GMC	Sierra 3500 HD	V8	6.6L	DSL	C.A.R.B. E.O. # D-670-13

* **NOTE: Legal in California only for racing vehicles which may never be used upon a highway**

PARTS LIST

	Description	Qty.	Part Number
A	INTAKE TUBE	1	9-0427
B	TUBE; INTAKE ELBOW	1	9-0412
C	LID, AIR BOX	1	9-0411
D	AIR BOX	1	9-0406
E	HOSE; COUPLER, 4.25" DIA. X 3.0"	1	5-1069
F	HOSE, SILICONE 4.5"X3" BLACK	1	5-450
G	AIR FILTER	1	21-2258DK
H	INSERT, DIESEL A/F ASSY 5"	1	5-2279
I	EDGE TRIM, 20"	1	102494A
J	HOSE CLAMP, 1/2" 4.00"-5.00"	4	9472
K	ADAPTER, MAF WITH O-RING GROOVE	1	8-181
L	O-RING	1	8-182
M	MOUNT, RUBBER 5/8" X 6MM	1	1228598
N	BOLT; SOCKET M4-.7 X 8MM	4	1-2105
O	BOLT; BTN HD M4-.7 X 6MM	2	1-2051
P	WASHER; 1"D X 1/4 HOLE FENDER	5	08160
Q	HOSE CLAMP #80 STAINLESS	1	KITHS80
R	PLUG	1	09711
S	BRACKET, L, MOUNTING; 1.0 X 1.0	1	32-3087
T	BOLT; HEX/FLANGE M6-1 X 30	4	1-1016
U	BOLT; HEX M6-1 X 12MM	1	07727
V	BOLT; HEX M6-1 X 25MM	3	07704
W	NUT; M6 HEX SERRATED	1	444.460.04
X	WASHER, M6 SPLIT LOCK ZINC	1	1-3025
Y	GROMMET; 7/8" O.D. X 3/8" I.D.	1	784647

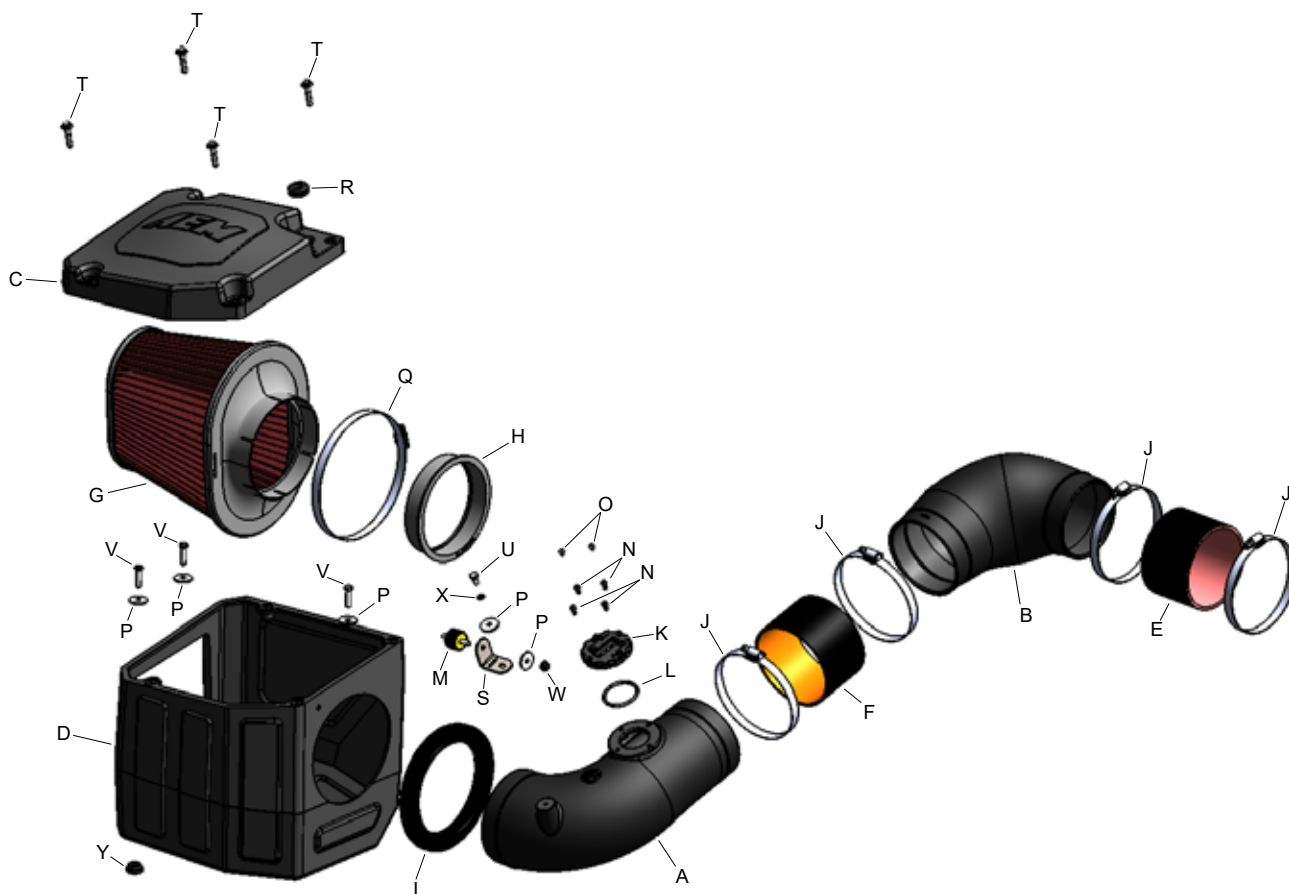

Read and understand these instructions **BEFORE** attempting to install this product. Failure to follow installation instructions and not using the provided hardware may damage the intake tube, throttle body and engine.

1. Preparing Vehicle

- a. Make sure vehicle is parked on level surface.
- b. Set parking brake.
- c. If engine has run in the past two hours, let it cool down.
- d. Disconnect negative battery terminal.
- e. Raise the front of the vehicle with a jack. Refer to your owner's manual for proper jack and jack stand placement to properly support vehicle. Support your vehicle using properly rated jack stands before wheel removal or while working under the vehicle.

NEVER WORK UNDER A VEHICLE WITHOUT USING JACK STANDS.

- g. Do not discard stock components after removal of the factory system.

2. Removal of stock system



a. Depress the locking tab on the mass air sensor, then disconnect the mass air sensor.



b. Loosen the two hose clamps retaining the stock intake tube, then remove the stock intake tube from the air box and the engine intake port.



c. Pull up firmly on the stock air box starting on the side closest to the engine to dislodge it from the mounting grommets. Remove the air box from the engine bay.



d. Using a 10mm socket, remove the four bolts retaining the stock air box mounting plate. Remove the mounting plate.



e. Using a T20 Torx bit, remove the two screws retaining the mass air sensor to the upper air box lid and remove the mass air sensor. Ensure the O-ring seal is still intact.

3. Installation of AEM® Intake System

a. When installing the intake system, do not completely tighten the hose clamps or mounting hardware until instructed to do so.



b. Install the mass air sensor adapter plate and O-ring seal in the 9-0427 lower intake tube using the four 4mm allen bolts provided.



c. Install the mass air sensor on the mass air sensor adapter plate using the two buttonhead allen bolts provided.



d. Install the 4.25 X 2.5" silicone hose onto the outlet of the 9-0412 intake tube, on the "A" side of the AEM® logo. Install the 4.5 X 3" silicone hose onto the inlet side of the intake tube, on the "M" side of the AEM® logo. Secure both silicone hoses with the #9472 hose clamps as shown.



e. Install a #9472 hose clamp over the outlet hose and install the intake tube assembly onto the engine intake port as shown. Do not fully tighten the hose clamp.



f. Install the bulb seal around the inside of the outlet hole on the 9-0406 air box as shown. Trim excess as needed.



g. install the 784647 grommet into the larger left front mounting hole as shown.



h. Place the air box into the engine bay into the stock location as shown. Ensure the new left front mounting grommet is lined up with the threaded hole in the engine bay.



i. While pulling the air box toward the stock coolant reservoir to align the air box, install two M6 X 25mm bolts with two flat washers at the two mounting holes shown. Ensure the air box inlet window is aligned with the stock air inlet window in the sheet metal fender liner. Tighten the two bolts.



j. Install a M6 X 25mm bolt with a flat washer in the remaining mounting hole near the inlet window and tighten the bolt. Note that the large air inlet window is aligned with the smaller stock air inlet window in the vehicle fender.



k. Install the large hose clamp provided onto the AEM® DRYFLOW® Air Filter; then, Install the air filter base adapter into the outlet of the AEM® DRYFLOW® Air Filter.



l. Place the AEM® Air Filter assembly into the air box as shown.



m. Loosely Install the lower intake tube through the bulb seal and into the air filter assembly as shown.



n. Re-connect the mass air sensor, fully seating the connector to lock it.



o. Fully seat the AEM® air filter onto the lower intake tube inlet and align it vertically as shown. Tighten the hose clamp at the air filter base.



p. Install a #9472 hose clamp on the silicone hose already mounted on the intake tube elbow. Install the lower intake tube into the silicone hose. Do not fully tighten the hose clamp.



q. Install the rubber isolator stud mount into the 6mm insert on the side of the airbox as shown. Tighten by hand.



r. Loosely install the "L" bracket, one flat washer, and the 6mm serrated nut onto the isolator stud mount.



s. Install one flat washer, the split washer, and the M6 X 12mm hex bolt through the "L" bracket slot and into the mounting boss in the lower intake tube. Tighten the bolt and hex nut with a 10mm socket.



t. Rotate the lower intake tube and air filter assembly until the edge of the air filter cap lines up with the top edge of the air box opening near the fender as shown.



u. Tighten the hose clamp at the silicone hose connecting the upper and lower intake tubes.



v. Fully seat the silicone hose at the engine intake port and tighten the hose clamp.



w. Install the plug into the 3/4" hole in the corner of the air box lid as shown.



x. install the air box lid onto the air box using the provided 6mm hex bolts. Tighten all bolts by hand first, then tighten with a 10mm socket to seal the air box.



AEM® intake system installed.

4. Reassemble Vehicle

- a. Position the inlet pipes for the best fitment. Be sure that the pipes or any other components do not contact any part of the vehicle. Tighten any rubber mounts (if applicable), all bolts, and hose clamps.
- b. Check for proper hood clearance. Re-adjust pipes if necessary and re-tighten them.
- c. Inspect the engine bay for any loose tools and check that all fasteners that were moved or removed are properly tightened.
- d. Reconnect the negative battery terminal and start the engine. Let the vehicle idle for 3 minutes. Perform a final inspection before driving the vehicle.

5. VECI (Vehicle Emission Control Information)

- a. Most General Motors trucks (including Chevrolet) have the Vehicle Emissions Certification Information (VECI) label affixed to the air filter box. In order to be compliant with California emissions laws, the label MUST remain in the engine compartment. If the Vehicle Emission Control Information label is removed during modification, a new replacement label must be obtained and installed in a readily visible position in the engine compartment. The label shall not be affixed to any equipment which is easily detached from the vehicle. We recommend that the label is affixed to the underside of the hood adjacent to the hood latch. The label is Vehicle Identification Number dependent and can be ordered from the vehicle dealership. In order to receive the proper decal, please bring your VIN with you. Failure to have the VECI under the hood may result in failure of a pre-registration smog test.

6. CARB Sticker Placement

- a. The C.A.R.B. exemption sticker, (attached), must be visible under the hood so that an emissions inspector can see it when the vehicle is required to be tested for emissions. California requires testing every two years, other states may vary.

7. Service and Maintenance

- a. AEM Induction Systems requires cleaning the intake system's air filter element every 100,000 miles. When used in dusty or off-road environments, our filters will require cleaning more often. We recommend that you visually inspect your filter once every 25,000 miles to determine if the screen is still visible. When the screen is no longer visible some place on the filter element, it is time to clean it. To clean, purchase our Synthetic air filter cleaner, part number 1-1000 and follow the easy instructions.

For technical inquiries e-mail us at sales@aemintakes.com or call us at 800.992.3000

AEM Air Intake System Warranty Policy

AEM® warrants that its intake systems will last for the life of your vehicle. AEM will not honor this warranty due to mechanical damage (i.e. improper installation or fitment), damage from misuse, accidents or flying debris. AEM will not warrant its powder coating if the finish has been cleaned with a hydrocarbon-based solvent. The powder coating should only be cleaned with a mild soap and water solution. Proof of purchase of both the vehicle and AEM intake system is required for redemption of a warranty claim.

This warranty is limited to the repair or replacement of the AEM part. In no event shall this warranty exceed the original purchase price of the AEM part nor shall AEM be responsible for special, incidental or consequential damages or cost incurred due to the failure of this product. Warranty claims to AEM must be transportation prepaid and accompanied with dated proof of purchase. This warranty applies only to the original purchaser of product and is nontransferable. Improper use or installation, use for racing, accident, abuse, unauthorized repairs or alterations voids this warranty. AEM disclaims any liability for consequential damages due to breach of any written or implied warranty on all products manufactured by AEM. Warranty returns will only be accepted by AEM when accompanied by a valid Return Merchandise Authorization (RMA) number. Credit for defective products will be issued pending inspection. Product must be received by AEM within 30 days of the date RMA is issued.

If you have a warranty issue, please call (800) 992-3000 and our customer service department will assist you. A proof of purchase is required for all AEM warranty claims.