



Equipped with AEM® Dryflow™ Filter
No Oil Required!

INSTALLATION INSTRUCTIONS

PART NUMBER: 41-1405

2011 SCION tC L4-2.5L SEE * NOTE

* NOTE: Legal in California only for racing vehicles which may never be used upon a highway

PARTS LIST

	Description	Qty.	Part Number
A	Upper Pipe, Scion Tc	1	2-1465
B	Hose, Adapter 2.75/3.00 X 3" Blk.	1	5-273
C	Zip Tie, 8" Tree Push-Mnt.	1	1-127
D	Grommet, Filter Minder	1	1675-044
E	Mount, Rubber 1" X 6mm Modified	1	1228599-1
F	Washer; 1"D X 1/4 Hole Fender	2	08160
G	Nut, M6 Hex Serrated	2	444.460.04
H	Eti Module; Scion Tc, Programmed	1	40-1405-002
I	Bolt, Socket M6-1 X 14mm	2	1-2041
J	Bolt, Socket M4-.7 X 8mm	2	1-2105
K	Hose, Silicone 2.75x3" Blk.	1	5-275
L	Lower Pipe, Scion Tc	1	2-1466
M	Mount, rubber 5/8" X 6mm	1	1228598
N	Hose Clamp, 2.31-3.25"	3	9444
O	1/2" Bnd. Hose Clamp, 2.56"-3.50"	2	9448
P	Air Filter; 2.75" X 5" Dryflow™	1	21-202DK

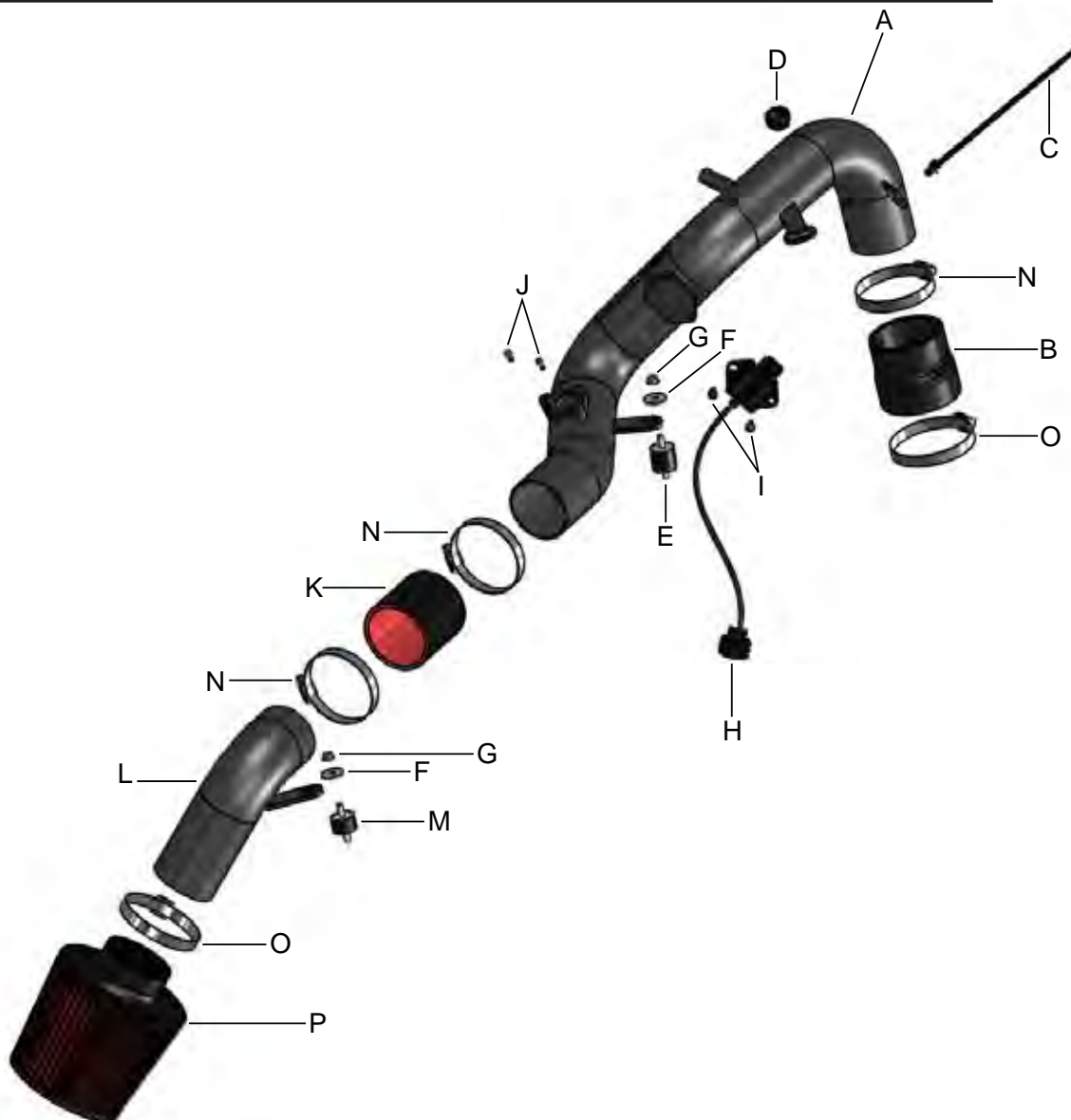

Read and understand these instructions **BEFORE** attempting to install this product. Failure to follow installation instructions and not using the provided hardware may damage the intake tube, throttle body and engine.

The AEM® intake system is a performance product that can be used safely during mild weather conditions. During harsh and inclement weather conditions, you must return your vehicle to stock OEM airbox and intake tract configuration. Failure to follow these instructions will void your warranty.

1. Preparing Vehicle

- a. Make sure vehicle is parked on level surface.
- b. Set parking brake.
- c. If engine has run in the past two hours, let it cool down.
- d. Disconnect negative battery terminal.
- e. Do not discard stock components after removal of the factory system.

2. Removal of stock system



a. Stock airbox system installed.



b. Disconnect negative terminal on battery using 10mm socket and tuck away from battery.



c. Disconnect wire harness from MAF sensor and unclip MAF wire harness from stock airbox.



d. Pinch and slide back the black spring clamp on the valve cover hose. Twist valve cover hose to disconnect from intake tube.



e. Unhook the vacuum switching valve (VSV) from the rubber inlet tube bracket.



f. Unclip the VSV hose on the rear side of the inlet tube. Tuck the hose and VSV away from inlet tube.



g. Use needle nose pliers to lock open the tube clamp securing the inlet tube to the throttle body. Carefully disconnect the inlet tube from the throttle body, ensuring the tube clamp does not snap back into the unlocked position



h. Locate the two clips securing the airbox lid next to the battery. Unhook the clips and slowly remove the airbox lid and tube assembly, ensuring the MAF wire harness, VSV, and VSV hose are not snagged during removal.



i. Remove the stock air filter. Loosen and remove the 3 bolts securing the lower airbox using a 10mm socket. Loosen and remove the (1) bolt securing the inlet air tube in place using a 10mm socket.



j. Detach the wire harness from the rear side of the lower airbox and slide off the metal bracket by slightly pulling back on plastic tab.



k. Disconnect lower airbox from inlet tube. Remove the lower airbox and set aside.



l. Slide the inlet tube down towards the headlight slightly and remove the inlet tube from the vehicle.



m. Remove the MAF sensor using a Phillips head screwdriver and set aside for later use during the AEM® intake installation.

3. Installation of AEM® Intake System

a. When installing the intake system, do not completely tighten the hose clamps or mounting hardware until instructed to do so.



b. Install the MAF sensor onto the upper intake tube (2-1465) using the provided M4 bolts(1-2105), tighten with an allen wrench.

c. Insert the rubber grommet (1675-044) into the VSV bracket as shown.



d. Mount the ETI module onto the upper intake tube using the provided M6 bolts(1-2041).

e. Connect the ETI module harness to MAF sensor as shown.



f. Insert the tree mount zip tie into the bracket of the upper intake tube as shown.

g. Slide coupler (5-273) onto the upper tube about 1-1/8th inch and fasten with #44 hose clamp.



h. Install the shorter end of the rubber mount (1228599-1) into the threaded hole originally used for the airbox bolt as shown.



i. Maneuver the inlet side of the upper intake tube through the channel near the battery and under the wire harness. Pull back the plastic cover panel slightly and carefully slide the outlet side of tube towards throttle body. Insert the #48 hose clamp over the coupler/ throttle body.



j. Position the intake pipe so the mounting bracket slides into position over the rubber mount, then loosely fasten with the provided washer and M6 nut. Tighten the hose clamp to secure the intake tube to the throttle body.



k. Connect the valve cover hose to the intake tube and secure with the stock spring clamp.



l. Slide the VSV bracket into the rubber grommet as shown.



m. Fasten the VSV hose to the upper intake pipe using the provided tree mount zip tie, trim off excess.



n. Connect the stock MAF sensor harness to the ETI module.



o. Slide coupler (5-275) half way over the upper tube inlet and secure with 1 #40 hose clamp.



p. Install the short rubber mount (1228598) into the hole previously used to mount the stock air inlet tube as shown. Also slide an additional #40 hose clamp onto the coupler (5-275) installed in the previous step.



q. Raise the front of the vehicle with a jack. Refer to your owner's manual for proper jack and jack stand placement to properly support vehicle. Support your vehicle using properly rated jack stands before wheel removal or while working under the vehicle.
NEVER WORK UNDER A VEHICLE WITHOUT USING JACK STANDS.
Remove the specified (1) 10mm bolt and (1) plastic clip on the belly pan near the driver side.



r. Install the DryFlow™ air filter onto the lower intake pipe using a #48 hose clamp and tighten securely.



s. Pull the belly pan edge down and carefully slide the lower intake pipe through the opening. Slide the lower intake pipe into position to mount to the coupler attached to the upper intake pipe. Reinstall the 10mm bolt and plastic clip onto the belly pan, then lower the vehicle.



t. Attach the lower intake pipe to the coupler and maneuver the intake pipe so the bracket slides into place over the rubber mount. Loosely fasten the provided washer and M6 nut. Check for clearance on the headlight housing and fog light housing (if applicable). Tighten all clamps and nuts once proper clearance is obtained.



u. AEM® intake system installed.

4. Reassemble Vehicle

- Position the inlet pipes for the best fitment. Be sure that the pipes or any other components do not contact any part of the vehicle. Tighten the rubber mount, all bolts, and hose clamps.
- Check for proper hood clearance. Re-adjust pipes if necessary and re-tighten them.
- Inspect the engine bay for any loose tools and check that all fasteners that were moved or removed are properly tightened.
- Reconnect the negative battery terminal and start the engine. Let the vehicle idle for 3 minutes. Perform a final inspection before driving the vehicle.

5. Service and Maintenance

- It is recommended that you service your AEM® Dryflow™ filter every 20,000 miles for optimum performance. Use AEM Dryflow cleaning kit part # 21-110.
- Use aluminum polish to clean your polished AEM® intake tube.
- Use window cleaner to clean your powder coated AEM® intake tube. **(NOTE: DO NOT USE aluminum polish on powder coated AEM intake tubes).**

For technical inquiries
e-mail us at
sales@aemintakes.com
or
call us at
800.992.3000

AEM Air Intake System Warranty Policy

AEM® warrants that its intake systems will last for the life of your vehicle. AEM will not honor this warranty due to mechanical damage (i.e. improper installation or fitment), damage from misuse, accidents or flying debris. AEM will not warrant its powder coating if the finish has been cleaned with a hydrocarbon-based solvent. The powder coating should only be cleaned with a mild soap and water solution. Proof of purchase of both the vehicle and AEM intake system is required for redemption of a warranty claim.

This warranty is limited to the repair or replacement of the AEM part. In no event shall this warranty exceed the original purchase price of the AEM part nor shall AEM be responsible for special, incidental or consequential damages or cost incurred due to the failure of this product. Warranty claims to AEM must be transportation prepaid and accompanied with dated proof of purchase. This warranty applies only to the original purchaser of product and is nontransferable. Improper use or installation, use for racing, accident, abuse, unauthorized repairs or alterations voids this warranty. AEM disclaims any liability for consequential damages due to breach of any written or implied warranty on all products manufactured by AEM. Warranty returns will only be accepted by AEM when accompanied by a valid Return Merchandise Authorization (RMA) number. Credit for defective products will be issued pending inspection. Product must be received by AEM within 30 days of the date RMA is issued.

If you have a warranty issue, please call (800) 992-3000 and our customer service department will assist you. A proof of purchase is required for all AEM warranty claims.