



Equipped with AEM® Dryflow™ Filter

No Oil Required!

## INSTALLATION INSTRUCTIONS

**PART NUMBER: 41-1408**

---

2017 SCION	FRS	2.0L-H4		
2017 SUBARU	BRZ	2.0L-H4		
2013-2016 SCION	FRS	2.0L-H4	C.A.R.B. E. O.	# D-670-24
2013-2016 SUBARU	BRZ	2.0L-H4	C.A.R.B. E. O.	# D-670-24

**SOME INTAKE SYSTEMS ARE NOT LEGAL FOR  
SALE OR USE ON ANY POLLUTION CONTROLLED  
MOTOR VEHICLE IN CALIFORNIA OR STATES  
ADOPTING CALIFORNIA EMISSION PROCEDURES.**

See [aemintakes.com](http://aemintakes.com) for CARB status on each part for a specific vehicle

## PARTS LIST

ITEM NO.	PART NUMBER	DESCRIPTION	QTY.
A	9-0433	AIR BOX; LOWER, 41-1408, FRS/BRZ	1
B	9-0419	INLET TUBE, FRS/BRZ 2.0L-H4	1
C	9-0434	AIR BOX; UPPER, 41-1408, FRS/BRZ	1
D	21-203DK	AIR FILTER; 3"X5" DRYFLOW	1
E	5-300	HOSE, SILICONE 3.00X3" BLK	1
F	9448	1/2" BNDHOSE CLAMP, 2.56"-3.50"	2
G	8-166	PLUG, LG TREE CLIP BLK	2
H	8-168	ADAPTER, PCV	1
I	8-4012	EDGE TRIM, 12"	1
J	9452	1/2" BNDHOSE CLAMP, 2.90"-3.75"	1
K	1-2051	BOLT; BTN HD M4-0.7 X 6MM	2
L	4D-1405-002	ETI MODULE; 2013 FRS/BRZ, PROGRAMMED	1
M	784643	GROMMET 3/8" I.D. X 1-5/8" O.D. X 1-1/4" PANEL HOLE X 3/16" GAP	1
N	1-1016	BOLT; HEX/FLANGE M6-1 X 30	4
O	2-648	SPACER, 1.00 OD X .335 ID X .79	1
P	1-2070	BOLT; HEX/FLANGE M6-1 X 50	1
Q	8-206	VACUUM CAP, 1-5/8" HI-TEMP VINYL	1

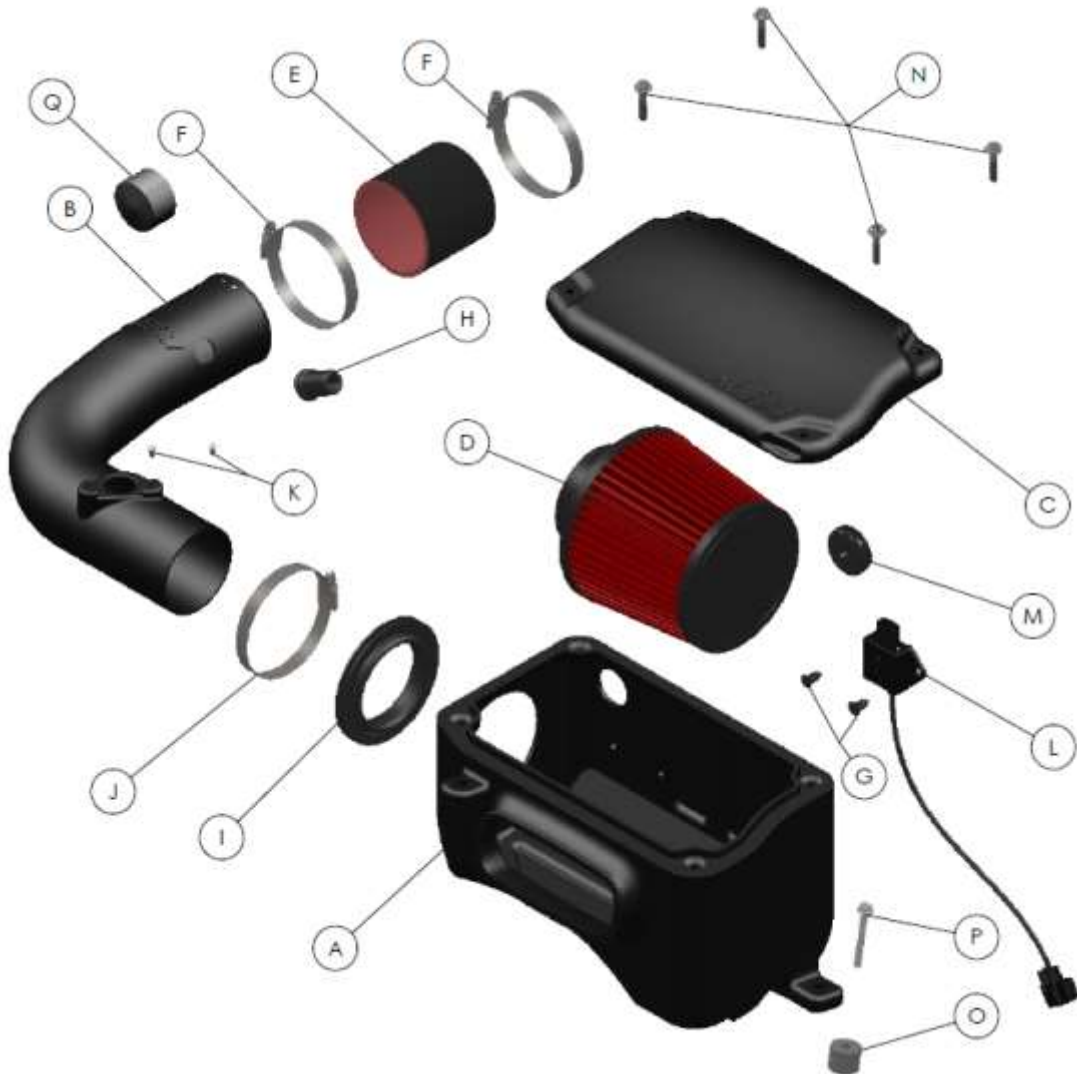

Read and understand these instructions **BEFORE** attempting to install this product. Failure to follow installation instructions and not using the provided hardware may damage the intake tube, throttle body and engine.

## 1. Preparing Vehicle

- a. Make sure vehicle is parked on a level surface.
- b. Set parking brake.
- c. If engine has run in the past two hours, let it cool down.
- d. Disconnect negative battery terminal.
- e. Do not discard stock components after removal of the factory system.

## 2. Removal of stock system



a. Stock intake system



b. Loosen hose clamps on intake sound creator and throttle body. Disconnect plastic tube from sound creator.



c. Compress spring clamp on rubber intake tube nipple and disconnect plastic elbow from tube. Set spring clamp aside for later use with AEM tube.



d. Disconnect MAF plug from sensor. Detach gray plastic clip on MAF harness from rear intake box as shown.



e. Remove the three M6 bolts indicated using a 10mm socket.



f. Slide rubber intake tube off throttle body and carefully remove intake box off inlet duct and set assembly aside.



g. Remove 2 screws on intake box to remove MAF sensor and set aside for installation on AEM intake tube.



### 3. Installation of AEM Intake System

- a. When installing the intake system, do not completely tighten the hose clamps or mounting hardware until instructed to do so.



a. Install MAF sensor into intake tube(B) and secure with M4 button screws provided(K).



b. Install edge trim(I) along outlet hole of airbox(A) as shown. Trim to fit if necessary.



c. Use plastic tree mount clips(G) to secure ETI module(L) along inside of box making sure male end is pointed upwards as shown.



d. Slide intake tube thru the rubber lined outlet from inside of airbox as shown.



e. Place air filter element(D) inside airbox with hose clamp(J) and slide onto intake tube. Ensure tube is fully seated within filter base and fasten hose clamp.



f. Use mild soap/water solution to slide coupler(E) over other end of intake tube along with 2 hose clamps(F) provided.



g. With intake tube pointing up, carefully install airbox, lining up stock inlet duct within AEM airbox inlet provision.



h. Slightly lift rear of airbox and insert spacer(O) between stock mounting stand and airbox mount feature.



i. Fasten upper airbox mount with stock bolt removed in step 5 of removal instructions and use hex flange bolt(P) to secure lower right airbox mount.



j. Insert MAF connector through rear hole of airbox and connect to ETI module.



k. Insert MAF wire harness into slit grommet(M) provided and carefully install into rear side of airbox using flathead screwdriver. Relieve any excessive tension at MAF plug with additional wire slack inside airbox.



l. Rotate intake tube to line up with throttle body and slide coupler over throttle body. Ensure adequate clearance around cone filter and adjust tube position accordingly prior to tightening hose clamps on coupler. Connect ETI module plug to MAF sensor.



m. Install PCV adapter(H) onto intake tube hole located near AEM logo. Insert plastic elbow into adapter and fasten using stock spring clamp.



n. Line lid(C) up with airbox and fasten down with hex flange bolts(N) provided.



o. Install supplied vinyl cap(Q) over inlet of sound creator.



p. AEM intake installed.



#### 4. Reassemble Vehicle

- a. Position the inlet pipe for the best fitment. Be sure that the pipe or any other components do not contact any part of the vehicle. Tighten any rubber mounts (if applicable), all bolts, and hose clamps.
- b. Check for proper hood clearance. Re-adjust pipe if necessary and re-tighten.
- c. Inspect the engine bay for any loose tools and check that all fasteners that were moved or removed are properly tightened.
- d. Reconnect the negative battery terminal and start the engine. Let the vehicle idle for 3 minutes. Perform final inspection before driving the vehicle.

#### 5. CARB Sticker Placement

- a. The C.A.R.B. exemption sticker, (attached), must be visible under the hood so than an emissions inspector can see it when the vehicle is required to be tested for emissions. California requires testing every two years, other states may vary.

#### 6. Service and Maintenance

- a. AEM Induction Systems requires cleaning the intake system's air filter element every 100,000 miles. When used in dusty or off-road environments, our filters will require cleaning more often. We recommend that you visually inspect your filter once every 25,000 miles to determine if the screen is still visible. When the screen is no longer visible some place on the filter element, it is time to clean it. To clean, purchase our Synthetic air filter cleaner, part number 1-1000 and follow the easy instructions.
- b. Use window cleaner to clean your powder coated AEM<sup>®</sup> intake tube. **NOTE: DO NOT USE aluminum polish on powder coated AEM<sup>®</sup> intake tubes.**

For Technical inquiries  
E-mail us at  
sales@aemintakes.com  
Or  
Call us at  
800.992.3000

#### AEM<sup>®</sup> Air Intake System Warranty Policy

AEM<sup>®</sup> warrants that its intake systems will last the life of your vehicle. AEM<sup>®</sup> will not honor this warranty due to mechanical damage (i.e. improper installation or fitment), damage from misuse, accidents or flying debris. AEM<sup>®</sup> will not warrant its powder coating if the finish has been cleaned with a hydrocarbon-based solvent. The powder coating should only be cleaned with a mild soap and water solution. Proof of purchase of both the vehicle and AEM<sup>®</sup> intake system is required for redemption of a warranty claim.

This warranty is limited to the repair or replacement of the AEM<sup>®</sup> part. In no event shall this warranty exceed the original purchase price of the AEM<sup>®</sup> part nor shall AEM<sup>®</sup> be responsible for special, incidental or consequential damages or cost incurred due to the failure of this product. Warranty claims to AEM<sup>®</sup> must be transportation prepaid and accompanied with dated proof of purchase. This warranty applies only to the original purchaser of product and is nontransferable. Improper use or installation, use for racing, accident, abuse, unauthorized repairs or alterations voids this warranty. AEM disclaims any liability for consequential damages due to breach of any written or implied warranty on all products manufactured by AEM<sup>®</sup>. Warranty returns will only be accepted by AEM<sup>®</sup> when accompanied by a valid Return Merchandise Authorization (RMA) number. Credit for the defective products will be issued pending inspection. Product must be received by AEM<sup>®</sup> within 30 days of the date RMA is issued.

If you have a warranty issue, please call (800) 992-3000 and our customer service department will assist you. A proof of purchase is required for all AEM<sup>®</sup> warranty claims.



**SOME INTAKE SYSTEMS ARE NOT LEGAL FOR  
SALE OR USE ON ANY POLLUTION CONTROLLED  
MOTOR VEHICLE IN CALIFORNIA OR STATES  
ADOPTING CALIFORNIA EMISSION PROCEDURES.**

**See [aemintakes.com](http://aemintakes.com) for CARB status on each part for a specific vehicle**