



P.O. Box 1719  
 Corona, CA 92878  
 Support: 951-493-7100  
 www.aFeFilters.com

# Intake Kit Installation Instructions: '04-'05 Ford F-150 V8-5.4L

<b>Kit Part #</b> 54-10512	<b>Tools Required:</b> 8mm socket 5/16" nut driver 10mm socket Flathead screwdriver Ratchet and extension T-20 Torx Bit	<b>Part List:</b> 1- Air filter p/n# 24-90008 1- Air filter Housing 1- Intake tube rotomolded 1- Intake tube support mount 1- Housing support tab 1- MAS sensor gasket 4- M6 Button head screws 5- M6 x 12 hex head screws 9- M6 washers	2- 8-32 x 5/8" screws 2- M6 Wavy washers 4- Clamps #064 2- Nylon spacers 1/8" 1- Coupler (4" x 3") 1- Coupler (3.5" x 4.0") 35"- Trim seal 3/4" bulb
<b>Make:</b> Ford			
<b>Model</b> F-150	<b>Year</b> '04-'05	<b>Engine</b> V8-5.4L	
<b>Note:</b> Please confirm Parts List and read all instructions steps before proceeding with actual installation.			



Complete kit with parts.

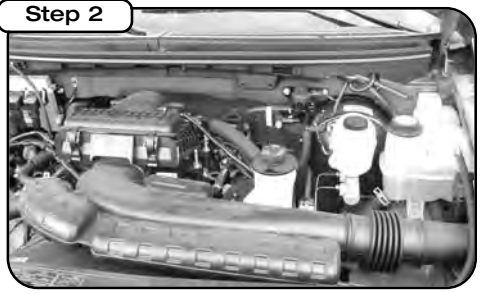

Complete stock intake.

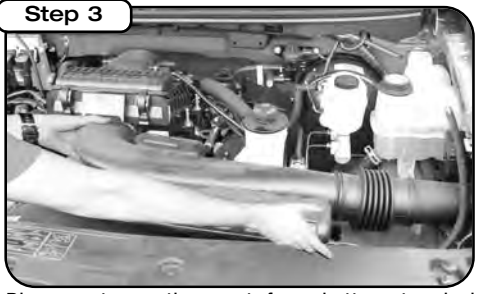

Disconnect negative post from battery terminal. Remove intake air duct by grabbing firmly from both sides and pulling straight back and out.

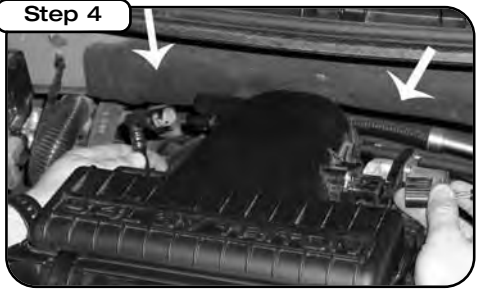

Disconnect the MAF sensor and breather tube on the sides of the airbox. Remove the 4 10mm screws holding the airbox to the intake manifold and remove intake box.



Install the intake tube support bracket to the intake manifold and fasten with the supplied M6 button head screws and washers.

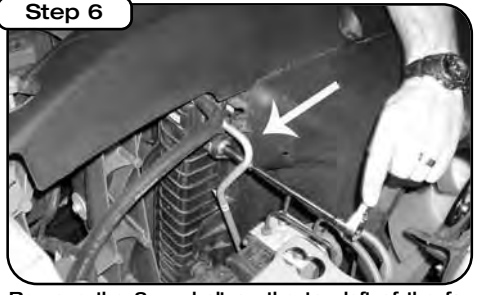

Remove the 8mm bolt on the top left of the fan shroud.

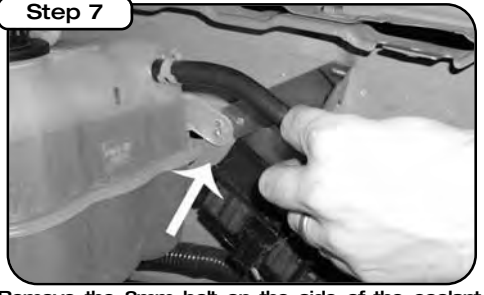

Remove the 8mm bolt on the side of the coolant reservoir. Sandwich the housing support bracket between the coolant reservoir tab and the fenderwell. Reinstall the 8mm bolt.

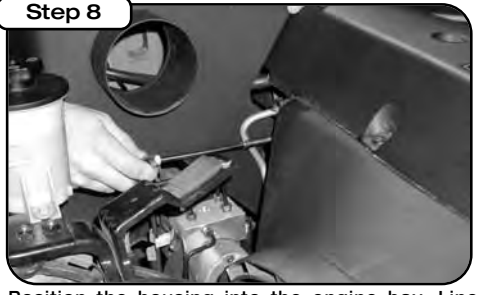

Position the housing into the engine bay. Line up the mounting holes with the rear support bracket and the radiator shroud and tighten all the nuts and bolts using the supplied hardware.



Transfer the MAF sensor from the factory airbox to the new intake tube. Make sure you use the provided spacer and gasket.



Place urethane coupler on the throttle body (see diagram below for correct coupler position) and the housing. Position intake duct into engine bay and tighten down the clamps.

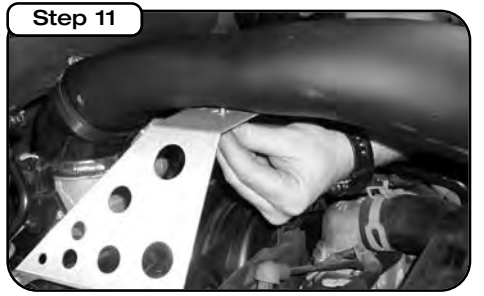

Line up the mounting holes on the intake duct and tighten assembly with the provided screws and washers.

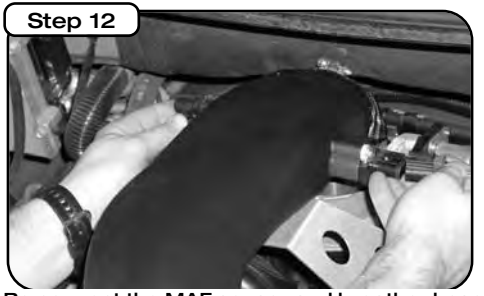

Re connect the MAF sensor and breather hose to the intake duct.

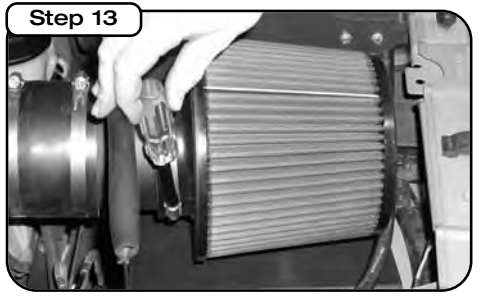

Install the pre-oiled filter in the housing and tighten down clamp. DO-NOT use any oil or grease. Install the housing trim seal on the sides of the panel by starting at one corner and working your way around the edge of the housing.



Place enclosed CARB EO sticker on a clean/smooth surface on or near the intake system. EO identification label is required in passing the Smog Check inspection. Your installation is now complete. Tighten all connections and clamps. Re-check after a few hours.



THROTTLE BODY

Position coupler and clamps over throttle body (3.5" x 4.0") (clamps removed for clarification). The smaller (3.5") end of the coupler goes over the throttle body. The (4") end of the coupler goes around the intake tube.