



P.O. Box 1719  
 Corona, CA 92878  
 Support: 951-493-7100  
 www.aFeFilters.com

# Intake Kit Installation Instructions: '97-'05 Ford Class C Motorhome & E-Series Vans V10-6.8L

<b>Kit Part #</b> 54-10542	<b>Tools Required:</b> 8mm socket 5/16" nut driver 10mm socket Flathead screwdriver Ratchet and extension	<b>Part List:</b> 1 Air filter part # 24-60512 / 72-60512 1 Intake tube rotomolded 1 Gasket MAF 1 Filter adapter 5 M6 x 1 x 20mm hex head 1 Spacer nylon 1 Coupler 3.5 x 2.0"	2 Trim seal (15") 2 Clamps #056 1 Grommet temp sensor 1 Decal Magnum Force 1 Instruction sheet
<b>Make:</b> Ford			
<b>Model</b>	<b>Year</b>	<b>Engine</b>	
Class C Motorhome	'97-'05	V10-6.8L	
E 250 Van	1997	V10-6.8L	
E 350 Van	'97-'05	V10-6.8L	
E 450 Van	'97-'05	V10-6.8L	
E 550 Van	'97-'05	V10-6.8L	



**Step 1**  
Complete kit with parts. Please confirm parts list and read all instructions steps before proceeding with actual installation.

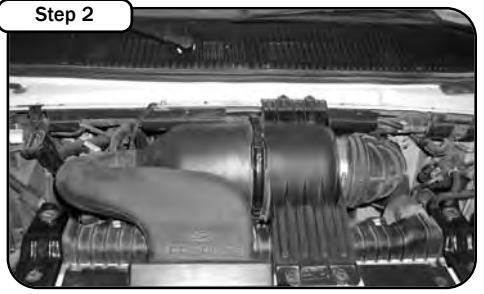

**Step 2**  
Complete stock intake.



**Step 3**  
Disconnect negative post from battery terminal. Remove the (4) 8mm bolts that hold the factory air intake assembly (set these bolts to the side you will be reusing these later).



**Step 4**  
Loosen the factory hose clamp with a nut driver or screwdriver connecting the black rubber intake pipe to the factory air filter housing. Unplug MAF sensor from harness and remove connector from the bracket located on side of air box by pulling straight out.

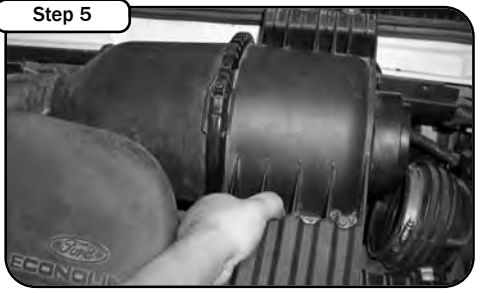

**Step 5**  
Remove air filter housing by pulling straight up and out of the engine bay.



**Step 6**  
Loosen hose clamp on the intake pipe and plastic internal baffle with a nut driver or flat head screwdriver. Remove the intake pipe and baffle out of vehicle.



**Step 7**  
Separate the filter canister by unfastening the band clamp and removing the air filter, disconnect the harness from the MAF sensor. Unbolt the MAF Sensor from the filter base and the short wire harness set aside for later use

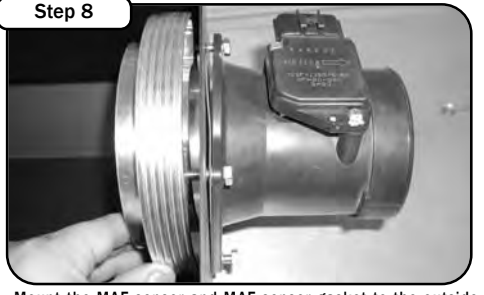

**Step 8**  
Mount the MAF sensor and MAF sensor gasket to the outside of the air filter housing. On the inside of the housing mount the air filter adapter. Use the (4) M6x1x20 screws and tighten down with a 10mm wrench.

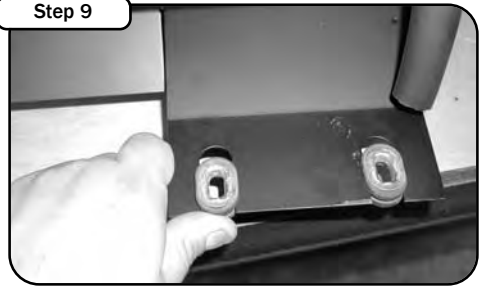

**Step 9**  
Transfer the (4) rubber grommets from the factory air box over to the new air filter housing by pushing the grommets into the provided slots.

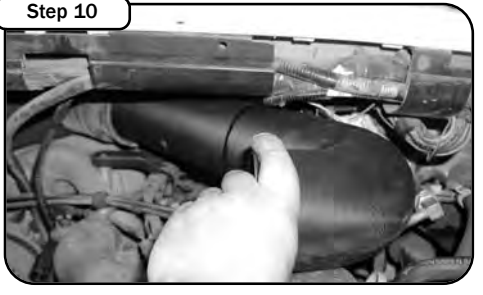

**Step 10**  
Remove the black grounding strap and bolt located on the top of the engine bay. Install the new intake pipe to the engine and tighten down the factory hose clamp.

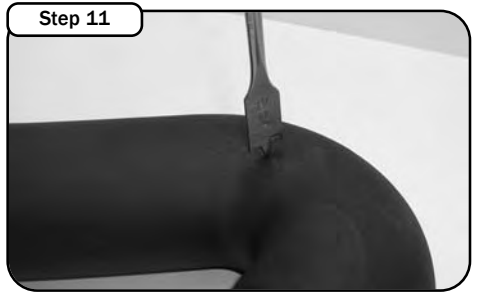

**Step 11**  
Note: On some models if you have a IAT sensor you will have to drill a hole in the intake pipe for the sensor. The location for this sensor is already pre determined with a yellow dot. Carefully drill a 11/16" hole in the intake pipe, install the supplied rubber grommet in the hole and insert the IAT Sensor. (Make sure the pipe is clean of any debris inside prior to installation)



**Step 12**  
Mount the housing into the engine compartment. Insert the supplied plastic spacer over the grounding strap location. Lower the housing in the engine bay and line up the mounting locations. Secure the housing with the (4) factory bolts. Then reinstall the bolt holding the grounding strap making sure the plastic spacer is lined up correctly. Finally tighten down all the bolts.

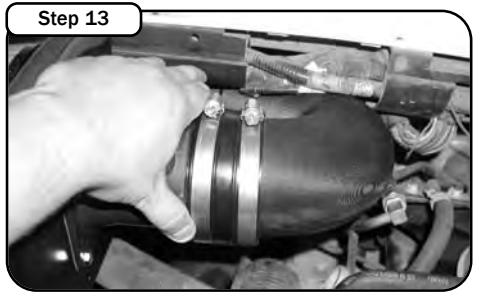

**Step 13**  
Place the rubber coupler between the MAF sensor and the intake pipe and slip the (2) #56 hose clamps over the connection and tighten the hose clamps. Insert the white mounting fastener on the MAF harness into the provided hole located on the side of the housing. Reconnect the MAF wiring harness to the engine.

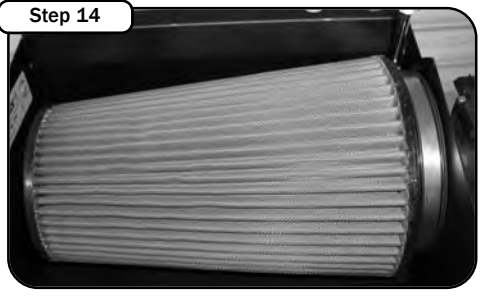

**Step 14**  
Install the pre-oiled filter in the housing and tighten down clamp. DO-NOT use any oil or grease. Install the housing trim seal on the sides of the panel.

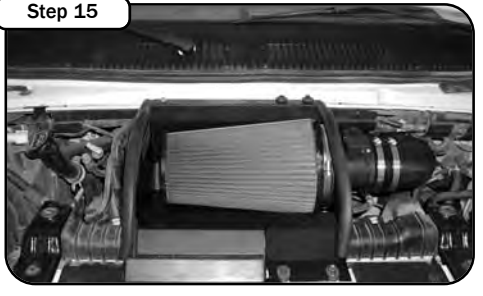

**Step 15**  
Place enclosed CARB EO sticker on a clean/smooth surface on or near the intake system. EO identification label is required in passing the Smog Check inspection. Your installation is now complete. Tighten all connections and clamps. Re-check after a few hours.

Note: Filter Cleaning and Re-oiling: When cleaning your aFe filter, be sure to use only aFe's "Restore Kit" aFe P/N: 90-50001 blue oil aerosol, or aFe P/N: 90-50501 blue squeeze bottle oil on Filter Replacement: PN: 24-60512 (black w/blue media) or aFe P/N: 90-50000 yellow oil aerosol, or aFe P/N: 90-50500 yellow squeeze bottle oil on Filter Replacement: PN: 72-60512 Pro-GUARD 7 (black w/gold media).