



P.O. Box 1719
 Corona, CA 92878
 Support: 951-493-7100
 www.aFeFilters.com

Intake Kit Installation Instructions: 2005 Ford Mustang V8-4.6L

Kit Part #	54-10292	Tools Required:	Part List:	2 Washer Wavy M6
Make:	Ford	5/16" nut driver or slotted screwdriver	1 Air filter (replacement # 24-90025)	2 M6 nut
Model		10mm socket or wrench	1 Intake tube	2 Flat washers M6
Year		Ratchet and extension	1 Intake housing	2 #8-32 screw x 1/2"
Mustang GT	2005		1 Housing Cover	2 Nylon spacer
	V8-4.6L		1 Coupler 4.5 x 2.25"	1 Gasket MAF
			2 Clamps #072	
			2 Screw M6 x 1 x 25	
			3 Bottom Head Screws M6 x 1 X 10	



Step 1
Complete kit



Step 2
Complete stock intake.

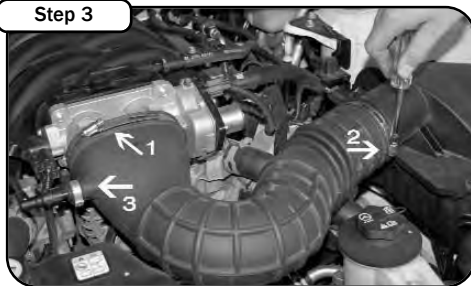

Step 3
Disconnect negative terminal from battery. Loosen the hose clamp on the throttle body (1) airbox (2) and remove the breather hose vent tube (3).



Step 4
Disconnect the MAF Sensor. you need to pull up on the red clip in order to remove the sensor.



Step 5
Remove the 10mm screw that secures the airbox to the inner fender well. Save the bolt you will be re-using this bolt later. Remove airbox out of the engine bay.

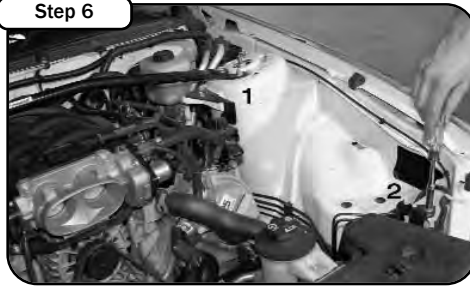

Step 6
Remove the 10mm bolt by the strut tower (1) and the ABS module(2). Set the bolts to the side you will be re-using these later.



Step 7
Transfer the rubber isolation mount from the stock airbox to the housing. Position the housing into the engine bay. Re-install the 10mm bolts removed in steps 5 and 6.

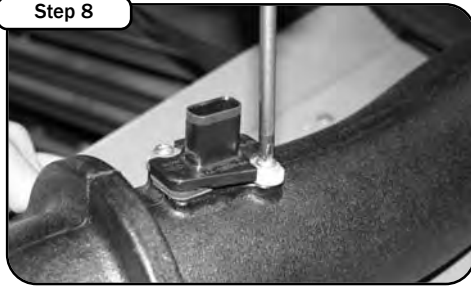

Step 8
Transfer the MAF sensor from the factory intake tube to the intake tube. Use the supplied spacers and gasket supplied with the kit.



Step 9
Place coupler and hose clamps on the throttle body. Position tube into coupler and tighten the clamps down.



Step 10
Align the mounting holes on the tube and the housing. Secure the assembly with the provided M6 bolts washers and nuts.



Step 11
Re-connect the MAF sensor to the wiring harness. make sure the red clip is pushed down to secure the harness.



Step 12
Install and tighten your pre-oiled filter. Do not use any grease or oil.



Step 13
Connect rubber breather hose to the factory vent location on the side of the valve cover and connect the other end to the side of the intake tube. Do not use any grease or oil.



Step 14
Place the housing lid over the airbox and fasten with the supplied button head screws. **Verify filter clearance with cover.**



Step 15
Place enclosed CARB EO sticker on a clean/smooth surface on or near the intake system. EO identification label is required in passing the Smog Check inspection. Your installation is now complete. Tighten all connections and clamps. Re-check after a few hours.

Note: Filter Cleaning and Re-oiling: When cleaning your aFe filter, be sure to use only aFe's "Restore Kit" (aFe P/N: 90-50001 blue oil aerosol, or aFe P/N: 90-50501 blue squeeze bottle oil or aFe P/N: 90-50000 gold oil aerosol, or aFe P/N: 90-50500 gold squeeze oil).
 Filter Replacement: Magnum FLOW PN: 24-90025 (black w/blue media).