

# Intake Kit Installation Instructions: '07-'08 GM Truck/SUV GMT900 Series Gas Applications V8-4.8L/5.3L/6.0L\*/6.2L



advanced FLOW engineering™  
 P.O. Box 1719  
 Corona, CA 92878  
 Support: 951-493-7100  
 aFepower.com

Kit Part #	51/54-11071 Stage 1 51/54-11072 Stage 2 Cx 54-11079 Torque Booster Tube 54-11073 Value Pack	Tools Required:	Part List: Stage 1	Stage 2 Cx / Torque Booster Tube	Bonus Part List: ( 54-11073 Only)
<b>Make:</b>	<b>Chevrolet (GMT900)</b>	5/16" Nut Driver and Slotted Screwdriver	1 Air Filter (Pro-5R™ 24-90015 or Pro Dry S™ 21-90015)	1 Tube, Intake	1 Air Filter P/N (Pro Dry S™ 21-90015)
<b>Model:</b>	<b>Engine</b>	10mm Socket and Wrench	1 Housing, Intake	1 Coupler, Reducer (05-00020)	1 Restore Kit, Blue Squeeze
<b>Year:</b>	V8-4.8L/5.3L	4mm or 5/32" Hex Head Wrench	1 Cover, Intake	1 Coupler, Reducer (05-00834)	1 Pre-filter
<b>Tahoe</b>	'07-'08 V8-4.8L/5.3L	Ratchet and Extension	1 Adaptor, Air Filter	1 Nipple, Brass 3/8" x 1/4"	
<b>Suburban</b>	'07-'08 V8-5.3L/6.0L*		1 Coupler, Reducer (05-00020)	1 Hose, 3/8" @ 14" L	
<b>Silverado 1500</b>	'07-'08 V8-4.8L/5.3L/6.0L*		1 Clamp, #072	2 Clamps, #064	
<b>Avalanche</b>	'07-'08 V8-5.3L/6.0L*		1 Clamp, #064	2 Clamps, #072	
<b>Make:</b>	<b>GMC (GMT900)</b>		8 Screw, Button Head M6 x 1 x 10		
<b>Yukon</b>	'07-'08 V8-4.8L/5.3L				
<b>Yukon XL</b>	'07-'08 V8-5.3L/6.0L*				
<b>Yukon Denali</b>	'07-'08 V8-6.2L				
<b>Sierra 1500</b>	'07-'08 V8-4.8L/5.3L/6.0L*				
<b>Sierra Denali</b>	'07-'08 V8-6.2L				
<b>Make:</b>	<b>Cadillac (GMT900)</b>				
<b>Escalade</b>	'07-'08 V8-6.2L				



**Step 1**  
Complete Stage 1 intake kit. Please verify all components are present prior to beginning installation.



**Step 2**  
Complete stock intake system.



**Step 3**  
Remove engine cover, lift up and pull out.

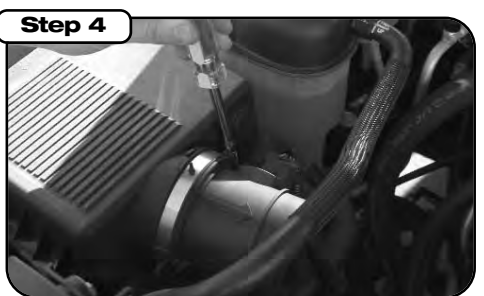

**Step 4**  
Loosen the clamp attaching the MAF sensor to the intake housing.



**Step 5**  
Remove the MAF sensor from the housing.

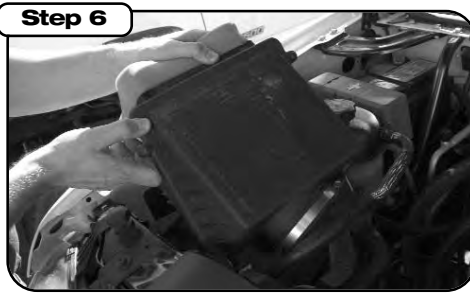

**Step 6**  
Lift up and out to remove the stock airbox.



**Step 7**  
Remove the 4 bolts that fasten the airbox mounting plate. Remove the plate and save the bolts for later use.

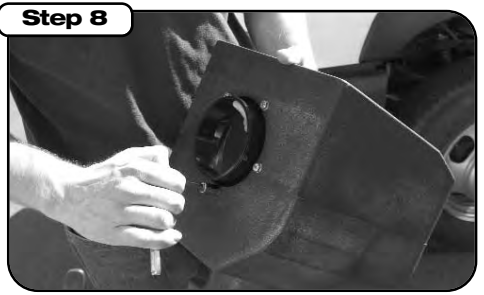

**Step 8**  
Using (5) M6 button head screws fasten the air filter adaptor to the aFe intake housing.



**Step 9**  
With the filter adaptor and reducer coupler installed, lower the aFe intake housing into the engine compartment.



**Step 10**  
Using the 4 bolts from the stock mounting plate fasten the aFe intake housing to the chassis.



**Step 11**  
Using the reducer coupler, insert and clamp the MAF sensor onto the aFe housing.



**Step 12**  
Insert and fasten the aFe air filter.



**Step 13**  
Install the housing cover and fasten using three button head screws.



**Step 14**  
Your Stage 1 installation is now complete. Replace engine cover. If installing Stage 2 Cx/Torque Booster Tube components, leave cover off. Make sure to tighten all clamps and check all electrical connections. Re-tighten clamps after a few hours of operation.



**For Stage 2 Cx and Torque Booster Tube install, please see reverse side. Continue on to page 2.**

**Note:** Filter Cleaning and Re-oiling: When cleaning your aFe filter, be sure to use only aFe's "Restore Kit" (aFe P/N: 90-50001 blue oil aerosol, or aFe P/N: 90-50501 blue squeeze bottle oil)  
 Filter Replacement: Magnum FLOW PN: Pro-5R™#24-90015 (black w/blue media) or Pro Dry S™#21-90015 (black w/white media)  
 (\*6.0L with Electric Fan Only)

# Intake Kit Installation Instructions: '07-'08 GM Truck/SUV GMT900 Series Gas Applications V8-4.8L/5.3L/6.0L\*/6.2L



advanced FLOW engineering™  
 P.O. Box 1719  
 Corona, CA 92878  
 Support: 951-493-7100  
 aFepower.com

Kit Part #	51/54-11071 Stage 1 51/54-11072 Stage 2 Cx 54-11079 Torque Booster Tube 54-11073 Value Pack	Tools Required:	Part List: Stage 1	Stage 2 Cx / Torque Booster Tube	Bonus Part List: ( 54-11073 Only)
<b>Make:</b>	<b>Chevrolet (GMT900)</b>	5/16" Nut Driver and Slotted Screwdriver	1 Air Filter (Pro-5R™ 24-90015 or Pro Dry S™ 21-90015)	1 Tube, Intake	1 Air Filter P/N (Pro Dry S™ 21-90015)
<b>Model:</b>	<b>Engine</b>	10mm Socket and Wrench	1 Housing, Intake	1 Coupler, Reducer (05-00020)	1 Restore Kit, Blue Squeeze
Tahoe	'07-'08 V8-4.8L/5.3L	4mm or 5/32" Hex Head Wrench	1 Cover, Intake	1 Coupler, Reducer (05-00834)	1 Pre-filter
Suburban	'07-'08 V8-5.3L/6.0L*	Ratchet and Extension	1 Adaptor, Air Filter	1 Nipple, Brass 3/8" x 1/4"	
Silverado 1500	'07-'08 V8-4.8L/5.3L/6.0L*		1 Coupler, Reducer (05-00020)	1 Hose, 3/8" @ 14"L	
Avalanche	'07-'08 V8-5.3L/6.0L*		1 Clamp, #072	2 Clamps, #064	
<b>Make:</b>	<b>GMC (GMT900)</b>		1 Clamp, #072	2 Clamps, #072	
Yukon	'07-'08 V8-4.8L/5.3L		1 Clamp, #064		
Yukon XL	'07-'08 V8-5.3L/6.0L*		8 Screw, Button Head M6 x 1 x 10		
Yukon Denali	'07-'08 V8-6.2L				
Sierra 1500	'07-'08 V8-4.8L/5.3L/6.0L*				
Sierra Denali	'07-'08 V8-6.2L				
<b>Make:</b>	<b>Cadillac (GMT900)</b>				
Escalade	'07-'08 V8-6.2L				



**Step 15**

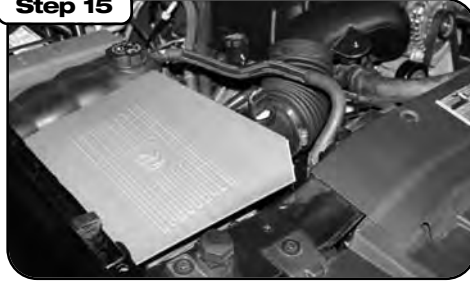

Complete Stage 1 intake system.

**Step 16**



If not already removed, remove engine cover, lift up and pull out.

**Step 17**



With 5/16" nut driver, loosen both clamps at end of OE intake tube. Carefully remove radiator support clamp from OE intake tube.

**Step 18**



Carefully remove vacuum line and remove OE intake tube from vehicle.

**Step 19**



With brass nipple insert provided, install into tube. Apply 3/8" hose to brass nipple.

**Step 20**



Apply coupler reducer to both ends of new intake tube with clamps provided. Install into vehicle and tighten using 5/16" nut driver. (Use 05-00020 @ throttle body and 05-00834 @ tube & MAF Sensor)

**Step 21**



Install new 3/8" vacuum line into vehicle. Re-install engine cover.

**Step 22**



Your Stage 2 installation is now complete. Make sure to tighten all clamps and check all electrical connections. Re-tighten clamps after a few hours of operation.