



P.O. Box 1719
 Corona, CA 92878
 Support: 951-493-7100
 www.aFeFilters.com

Stage 2 Intake Kit Installation Instructions: '04-'05 Cadillac CTS/ SRX V6-3.6L

Kit Part #	54-10892	Tools Required:	Part List:	1 Reducer coupler (4-3/8"x3-1/2")
Make:	Cadillac	Slotted Screwdriver	1 Air Filter (P/N: #24-91031)	1 Straight coupler (3-1/4"x2")
Model	Year	Engine	1 Intake tube	1 Clamps #48
CTS	'04-'05	V6-3.6L	1 Housing	3 Clamps #52
SRX	'04-'05	V6-3.6L	1 Housing cover	1 Clamps #56
			1 Adapter Injection Molded	1 Clamps #72
			7 M6x1x10 Button head screws	
			5 M6 Wavy Washer	
			1 Reducer coupler (3-1/4"x3")	



Complete Intake System



Complete Stock Intake

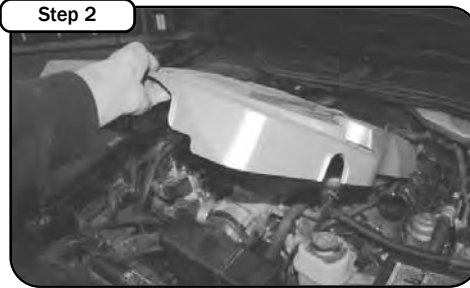

Remove oil cap, then pull up on engine cover to release from its retainers.



Remove the three screws that secure the air box to the vehicle.



Loosen the two hose clamps from the intake plenum. Remove plenum from vehicle.



Pull out factory air box and remove MAS from factory airbox.

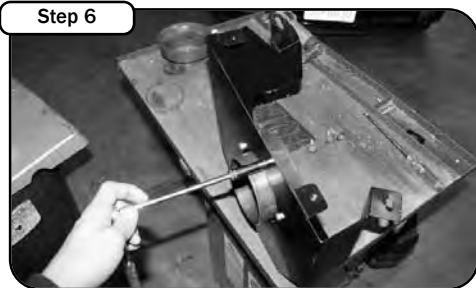

Install provided 3-angle adaptor onto aFe housing using supplied M6 hardware.

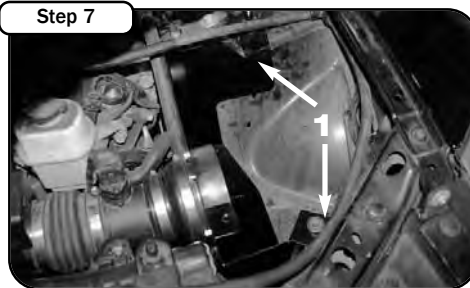

Install housing into vehicle. (1) Re-use all factory screws from airbox.

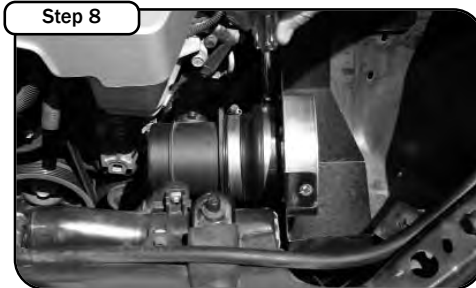

Install mass sensor and reducer coupler onto 3-angle adaptor.

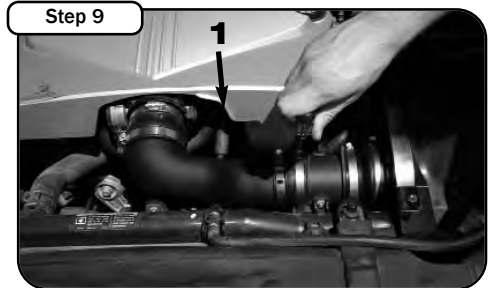

Install tube onto vehicle using supplied couplers and (1) reconnect Crank Case Breather onto tube.



Install aFe filter onto 3-angle adaptor.



Install housing cover with supplied button head screws.



Place enclosed CARB EO sticker on a clean/smooth surface on or near the intake system. EO identification label is required in passing the Smog Check inspection. Your installation is now complete. Make sure you tighten all clamps and check all electrical connections. Re check periodically.