



P.O. Box 1719
 Corona, CA 92878
 Support: 951-493-7100
 www.aFeFilters.com

Intake Kit Installation Instructions: '07 Chevrolet Tahoe/ Suburban/ GMC Yukon/ Yukon XL V8-5.3L

Kit Part #	51/54-81072	Tools Required:	Part List:	4	Clamp #060	
Make:	Chevrolet	5/16" nut driver or slotted screwdriver	1	Air filter Replacement P/N (24-91007	2	Coupler straight 4"x2"
Model	Year	Engine		Pro Dry S 21-90015)	9	Screw, button Head M6x1
Tahoe	'07	V8-5.3L	1	Intake tube	1	Brass nipple 3/8" ID x 1/4" NPT
Suburban	'07	V8-5.3L	1	Intake housing	12"	3/8" Breather hose
Make:	GMC		1	Intake housing cover	5	Washer Wavy, M6
Model	Year	Engine	1	Air filter adapter		
Yukon	'07	V8-5.3L	2	Coupler, reducer 4x3 3/4"		
Yukon XL	'07	V8-5.3L	1	Clamp #072		
			1	Clamp #064		



Step 1
 Complete intake kit. Please verify all components are present prior to beginning installation.

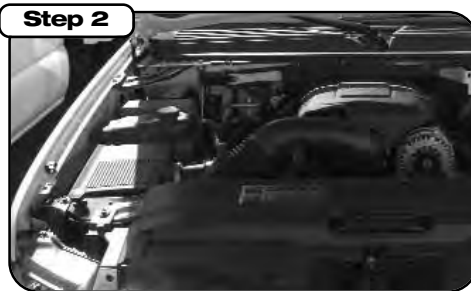

Step 2
 Complete stock intake system.

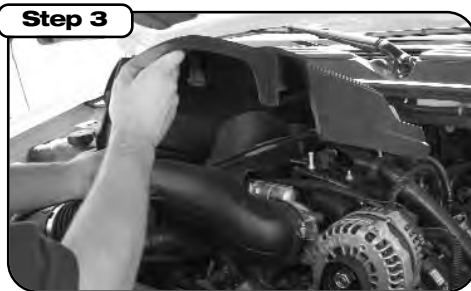

Step 3
 Remove engine cover, lift up and pull out.

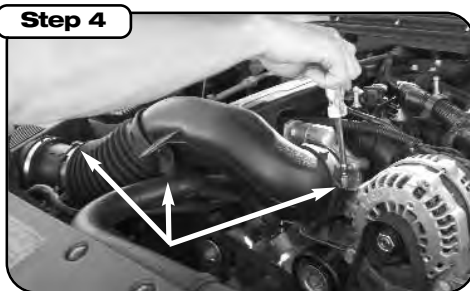

Step 4
 Loosen clamps and pull the intake tube/hose mount off. Disconnect the crankcase breather hose. Remove the intake tube.



Step 5
 Loosen the clamp attaching the MAF sensor to the intake housing. Remove the MAF sensor.

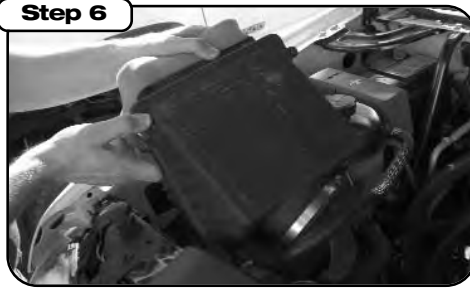

Step 6
 Lift up and out to remove the stock air box.

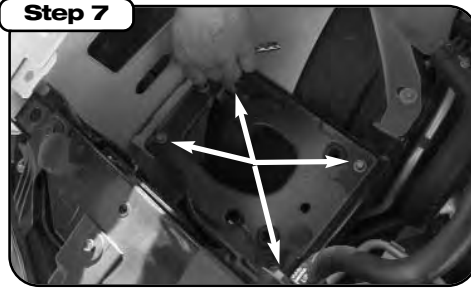

Step 7
 Remove the 4 bolts that fasten the air box mounting plate. Save these bolts for later use.



Step 8
 For extra air remove the rubber flap on the inside part of the air box area.

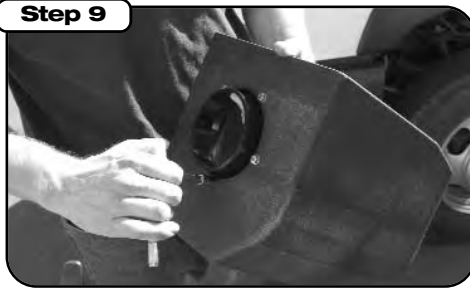

Step 9
 Using 5 M6 button head screws and 5 wavy washers fasten the air filter adapter to the aFe intake housing.

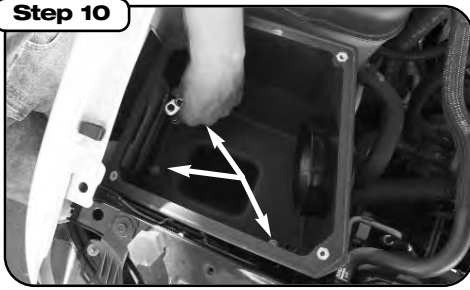

Step 10
 Using the 3 bolts from the stock mounting plate fasten the aFe airbox on the chassis.



Step 11
 Using the reducer coupler, clamp the MAF sensor onto the aFe housing. If this is a flex-fuel vehicle, use second reducer coupler between sensor and intake tube.



Step 12
 Attach the aFe intake tube onto the MAF and throttle body. Secure the clamps when properly positioned. Connect the supplied crankcase breather hose to the intake tube.



Step 13
 Insert and fasten the aFe air filter.

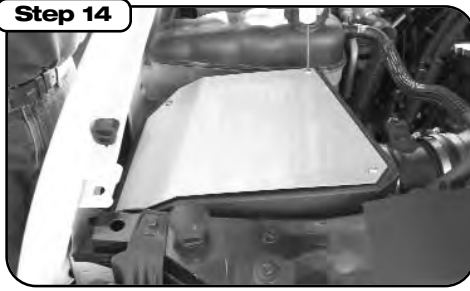

Step 14
 Fasten the housing cover to the air box. Using 4 supplied button head screws.



Step 15
 Your installation is now complete. Make sure to tighten all clamps and check all electrical connections. Re-check periodically.

Note: Filter Cleaning and Re-oiling: When cleaning your aFe filter, be sure to use only aFe's "Restore Kit" (aFe P/N: 90-50001 blue oil aerosol, or aFe P/N: 90-50501 blue squeeze bottle oil or aFe P/N: 90-50000 gold oil aerosol, or aFe P/N: 90-50500 gold squeeze oil). Filter Replacement: Magnum FLOW PN: #24-91007 (black w/blue media). Pro Dry S P/N 21-90015 (black w/white media) Pro Dry S cleaning: see cleaning instruction sheet 06-00074