



P.O. Box 1719  
 Corona, CA 92878  
 Support: 951-493-7100  
 www.aFeFilters.com

# Intake Kit Installation Instructions: '05-'06 Jeep Grand Cherokee WK / '06 Commander 4.7L V8

<b>Kit Part #</b>	54-10252 51-10252 Pro Dry S	<b>Tools Required:</b>	<b>Part List:</b>	1 Coupler, hump, 3 1/2 x 3"
<b>Make:</b>	Jeep	7/16 socket or wrench	1 Air filter Replacement P/N (24-40011 or Pro Dry S 21-40011)	2 Clamps, #056
<b>Model</b>	<b>Year</b>	<b>Engine</b>	1 Housing cover, aluminum clear coat	2 Mini Clamps, #006
Grand Cherokee	05-06	4.7L V8	1 Intake tube, rotomolded	4 Screw, Button head M6 x 10mm
Commander	06	4.7L V8	2 Screw 1/4 20x1"	
			2 Self locking nut 1/4- 20	
			4 Flat washer 1/4	
			1 Hose, 5/8" x 18" L	
			1 Housing, powder coat black wrinkle	



Complete kit components.



Complete stock intake.



With 5/16" nut driver loosen top of OE intake tube.

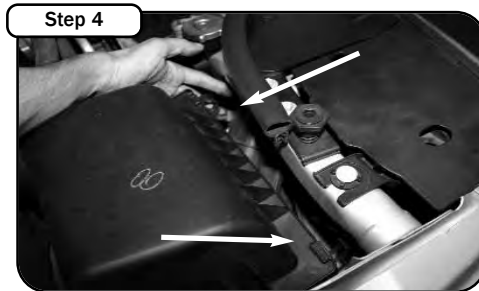

Disconnect the 2 factory clips holding the upper half of OE airbox. Also, disconnect the valve cover vent hose away from airbox.

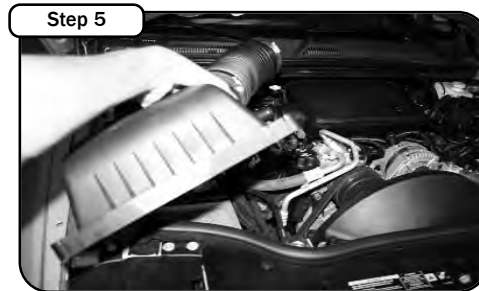

Carefully take out the OE intake and filter away from vehicle. Leave bottom half of OE airbox in vehicle.



Remove the vent hose from Commander models. Remove hose to tee junction on Grand Cherokee models.



With 5/8" hose provided, install new hose into valve cover vent (on Grand Cherokee models connect hose to vent tee). Place mini clamp onto hose and wait to tighten on new intake tube.



With screws, nuts, and washers provided, place new aFe tube onto housing and tighten using a phillips screwdriver and 7/16" socket or wrench.



Place the hump coupler onto the tube with clamps provided and install intake into vehicle.

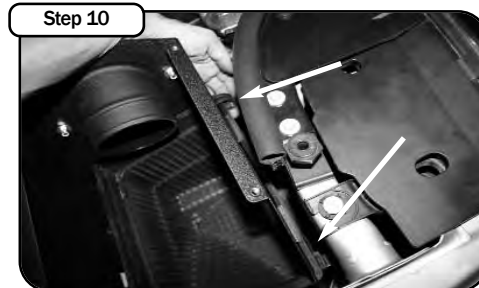

Carefully place back half of housing into grooves of the OE airbox and connect clips to new housing.



Tighten clamps on intake tube to plenum box with 5/16 nut driver. Place new vent hose onto tube and tighten clamp using 1/4" nut driver. (on Grand Cherokee models the excess vent hose will need to be trimmed to length approx. 4")



Install filter onto intake tube and tighten using 5/16" nut driver.



Install housing cover using button head screws provided. Tighten using 5/32" allen key.



Your installation is now complete. Check all clamps and connections. Periodically check all clamps and hoses. Thanks you for choosing aFe!

Note: Filter Cleaning and Re-oiling: When cleaning your aFe filter, be sure to use only aFe's "Restore Kit" (aFe P/N: 90-50001 blue oil aerosol, or aFe P/N: 90-50501 blue squeeze bottle oil or aFe P/N: 90-50000 gold oil aerosol, or aFe P/N: 90-50500 gold squeeze oil). on Filter Replacement: Magnum FLOW PN: 24-40011 (black w/ blue media). **Pro Dry S** P/N 21-40011 (black w/ white media) **Pro Dry S** cleaning: see cleaning instruction sheet 06-00074