



advanced FLOW engineering™
P.O. Box 1719
Corona, CA 92878
Support: 951-493-7100
aFepower.com

Intake Kit Installation Instructions: 2004-2008 Ford F-150 V8-5.4L Stage 2 Si

Kit P/N:	51/54-80512 (Matte Black) 51/54-80513 (Clearcoat) 54-80514	Tools Required:	10mm Socket 5/16" Nut Driver 5/32" Allen Key Flathead Screwdriver Ratchet and Extension T-20 Torx Bit	Part List:	2 Phillip Hd. Screws, 8-32x5/8 2 Nylon Spacers 3 Clamp, #064 1 Clamp, #056 1 Coupling, Straight (05-00441) 1 Coupling, Elbow (05-00464) 1 Trim Seal, 3/4" @ 15"L 1 Fuel Hose, 5/16" @17"L 5 Wavy Washers, M6 1 Hex Nut, M6X1 1 Hex Hd. Screws, M6x1x25 1 Hex Hd. Screws, M6x1x40	Bonus List: (54-80514 Only)	1 Air Filter 1 Pre-Filter 1 Restore Kit
Make:	Ford	Engine:	V8-5.4L				
Model:	F-150	Year:	'04-'08				
Make:	Lincoln	Engine:	V8-5.4L				
Model:	Mark LT	Year:	2006				



Step 1
Complete kit with parts. 54-80513 (Clearcoat) shown 5X-80512 (Matte Black) also available!



Step 2
Complete stock intake.

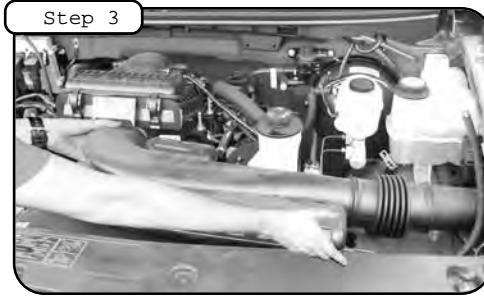

Step 3
Disconnect negative post from battery terminal. Remove intake air duct by grabbing firmly from both sides and pulling straight back and out.

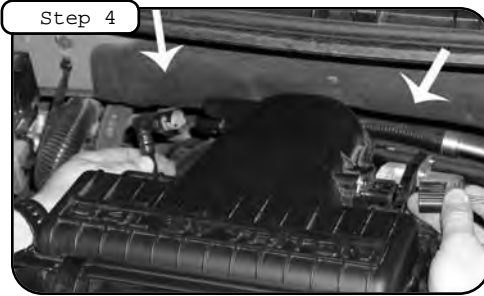

Step 4
Disconnect the MAF sensor and breather tube on the sides of the airbox. Remove the (4) 10mm screws holding the airbox to the intake manifold and remove intake box.

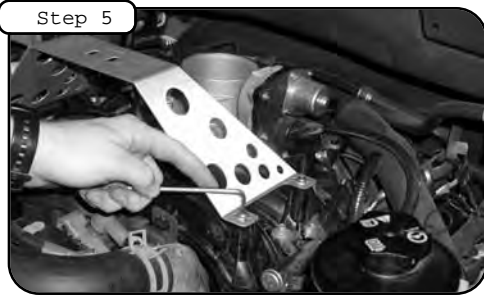

Step 5
Install the intake tube support bracket to the intake manifold and fasten with the supplied M6x1x10 button head screws and washers.



Step 6
Push clip holding factory wire harness and push to the side, this allows more room for housing. Remove bolt holding in radiator support and set aside for later use. Install trim seal to new housing fender scoop.



Step 7
Install housing into vehicle. With hardware provided, install M6 x1x30 screw and washer into radiator support. Install to bottom of housing. M6x1x25 screw with washers and M6 nut. With screw from step 6 install into hole with threaded insert, also in bottom of housing.



Step 8
With button head screws and wavy washers install filter injection molded adapter. Tighten using 5/32" allen key.

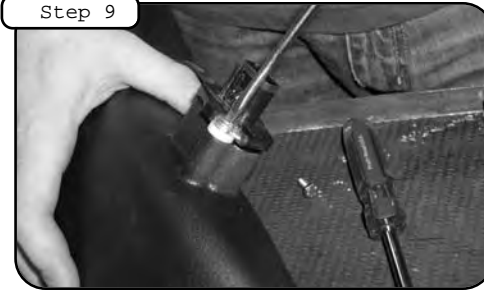

Step 9
Transfer the MAF sensor from the factory airbox to the new intake tube. Make sure you use the provided spacers and gasket between sensor and tube.



Step 10
Place coupler (05-00464) on the throttle body (see diagram below for correct coupler position) and the housing. Position intake duct into engine bay and tighten down the clamps.

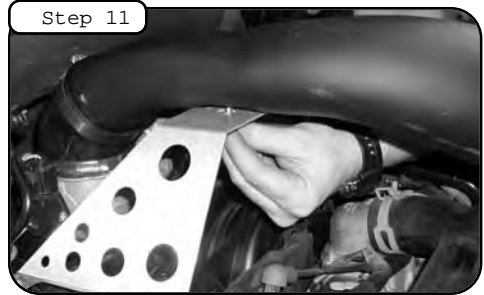

Step 11
Line up the mounting holes on the intake duct and tighten assembly with the provided screws and washers.

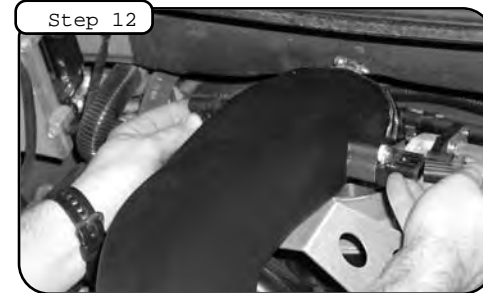

Step 12
Re-connect the MAF sensor and use provided 5/16" breather hose to connect the intake duct to the crankcase breather on the engine valve cover.



Step 13
Install the pre-oiled filter in the housing and tighten down clamp. With button head screws, install housing cover and tighten using 5/32" allen key.

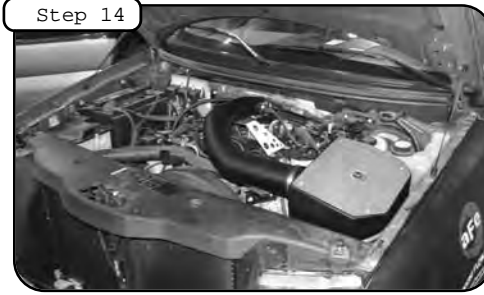

Step 14
Place enclosed CARB EO sticker on a clean/smooth surface on or near the intake system. EO identification label is required in passing the Smog Check Inspection. Your installation is now complete. Check after a few hours of operation all hoses and clamps are tight and that all electrical components are secure. Thank you for choosing aFe!

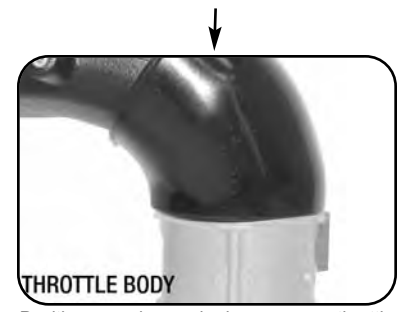

THROTTLE BODY
Position coupler and clamps over throttle body (3.5" x 4.0") (clamps removed for clarification). The smaller (3.5") end of the coupler goes over the throttle body. The (4") end of the coupler goes around the intake tube.

Note: Filter Cleaning and Re-oiling: When cleaning your aFe filter, be sure to use only aFe's "Restore Kit" (aFe P/N: 90-50001 blue oil aerosol, or aFe P/N: 90-50501 blue squeeze bottle oil).
Filter Replacement: Pro-5R™ P/N: 24-90008 (black w/ blue media), Pro Dry S™ P/N: 21-90008 (black w/ white media).