



P.O. Box 1719  
 Corona, CA 92879  
 Support: 877-512-8111  
 www.aFeFilters.com

# Intake Kit Installation Instructions: 03-07 Honda Element L4-2.4L Stage 1 Cx

|                                    |                  |                                  |   |
|------------------------------------|------------------|----------------------------------|---|
| <b>Kit Part #</b>                  | 51 / 54-11291    | <b>Tools Required</b>            | <b>Part List:</b>                                 |
| <b>Make:</b>                       | Honda            | 5/16 nut driver                  | 1 Air Filter P/N (24-33507 or Pro Dry S 21-33507) |
| <b>Model:</b>                      |                  | 10mm socket w/ Ratchet or wrench | 1 Housing, powder coated wrinkle black            |
| <b>Year:</b>                       |                  | Phillips screwdriver             | 3 Screw, hex M6 x 1 x 16"                         |
| <b>Engine:</b>                     |                  |                                  | 3 Washer, flat M6                                 |
| <b>Element</b>                     | <b>2003-2006</b> |                                  | 1 3/4" trim seal @ 38"L                           |
| <i>Excludes 2007 models and up</i> |                  |                                  | 1 Rubber edge trim @ 3-1/2"L                      |

## Step 1

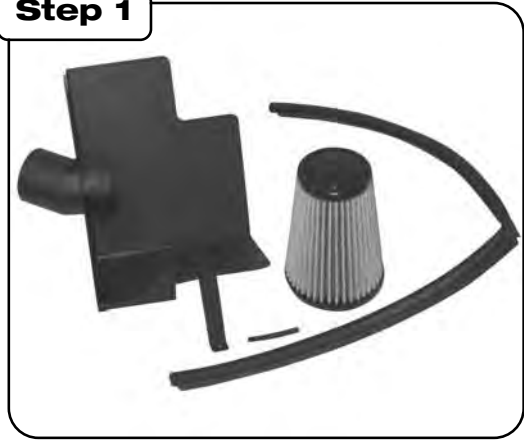

Complete Kit

## Step 2

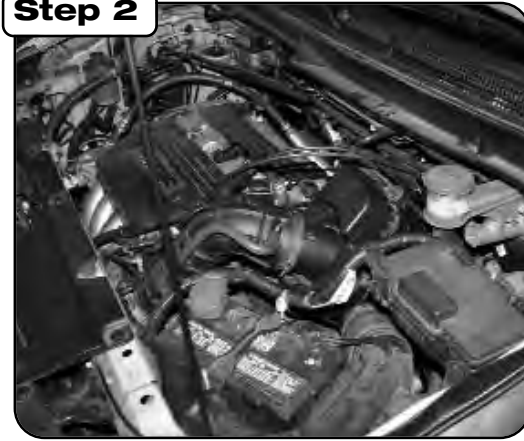

Complete stock intake

## Step 3



With phillips screwdriver, loosen OE intake tube clamp @ airbox and pull away.

## Step 4

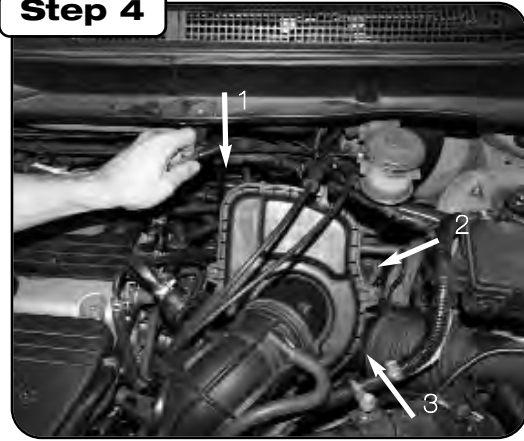

With 10mm socket and extension, loosen the 3 OE bolts holding in airbox. Carefully remove OE airbox out of vehicle.

## Step 5



Install new housing into vehicle. Place 3-1/2L" rubber edge trim in groove above *Magnum Force* decal. Have both cable lines between groove in housing. Now install 3/4" trim seal to housing.

## Step 5

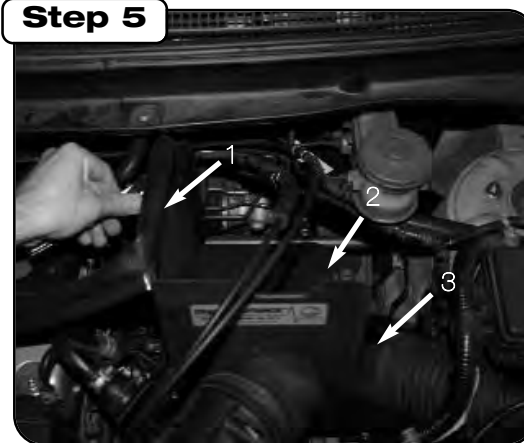

Tighten down housing using 3 M6 screws and washers provided with 10mm socket. Re-connect OE intake tube to new housing and tighten using phillips screwdriver.

## Step 6

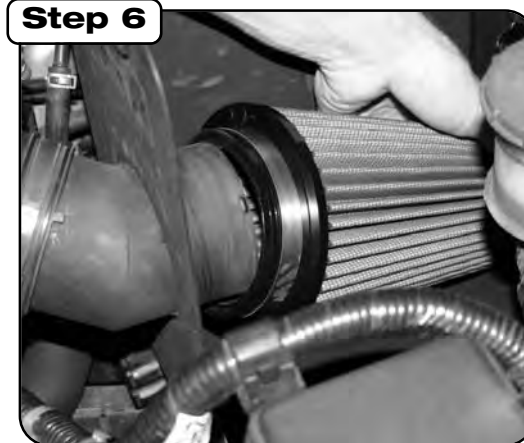

Install aFe air filter and tighten using 5/16" nut driver.

## Step 7



Your installation is now complete! Check all hoses, clamps and connections periodically. Thank you for choosing aFe!

Note: Filter Cleaning and Re-oiling: When cleaning your aFe filter, be sure to use only aFe's "Restore Kit" ( aFe P/N: 90-50001 blue oil aerosol, or aFe P/N: 90-50501 blue squeeze bottle oil ). Filter Replacement P/N: 24-33507 ( black w/blue media ) Pro Dry S™ P/N: 21-33507 (black w/white media) Pro Dry S™ cleaning: see cleaning instruction sheet 06-00074