

Intake Kit Installation Instructions: GM Duramax GMT 900 LMM 2007 V8-6.6L (td)



P.O. Box 1719
Corona, CA 92878
Support: 951-493-7100
www.aFePower.com

Kit Part #	51/54/75-81332-0 & 75-81332-0V	
Make:	GMC	
Model	Year	Engine
Sierra 2500HD	'07-'09	V8-6.6L LMM
Sierra 3500HD	'07-'09	V8-6.6L LMM
Make:	Chevrolet	
Model	Year	Engine
Silverado 2500HD	'07-'09	V8-6.6L LMM
Silverado 3500HD	'07-'09	V8-6.6L LMM

Tools Required:
5/16" nut driver
10mm socket or wrench
7/16" socket or wrench
Flathead screwdriver
Phillips screwdriver
Ratchet and extension
T-20 torx bit (included)
5/32" allen key

Part List:
1 Air filter Replacement (24-90038, Pro Dry S 21-90038, Pro GUARD 7 72-90038)
1 Housing, rotomold
1 Tube, rotomold
1 Cover, housing
1 Coupler, hump 4-1/4" x 3"L
2 Clamp, #072
4 Screws, button head M6
2 Spacer, nylon 1/2"
2 Screws, #8-32 x 5/8"L

1 Gasket, MAF sensor
2 Screws, Hex 1/4-20
2 Nut, self locking 1/4-20
4 Washers, flat 1/4-20
1 T-20 torx bit
BonusPart List in Value Pack only:
1 Air filter P/N (Pro Dry S™ 21-90038)
1 Restore kit, gold squeeze (90-50500)
1 Pre-filter (28-10051)



Complete kit components

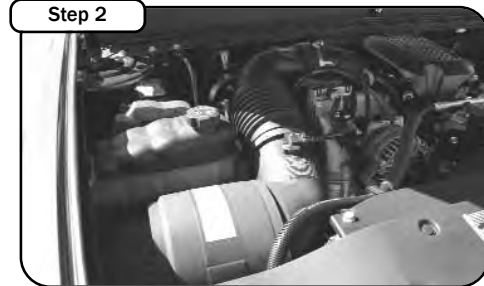

Complete stock Intake.

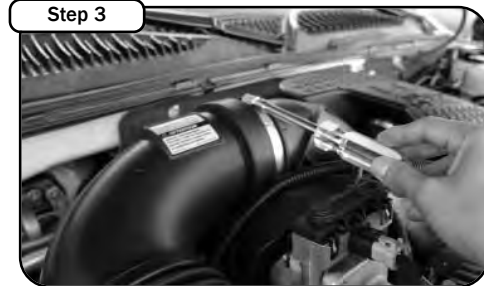

With 5/16" nut driver, loosen the clamp @ turbo end.



Disconnect MAF sensor harness .



Carefully grab and pull out OE intake system from vehicle.

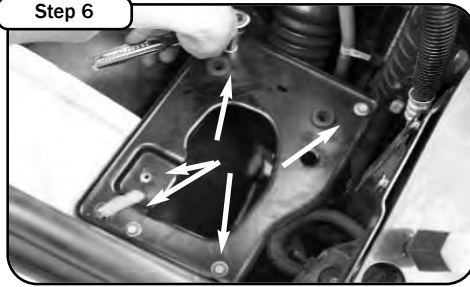

With 10mm socket, loosen the 5 screws holding the OE intake bracket and remove. Save 4 screws for later install.

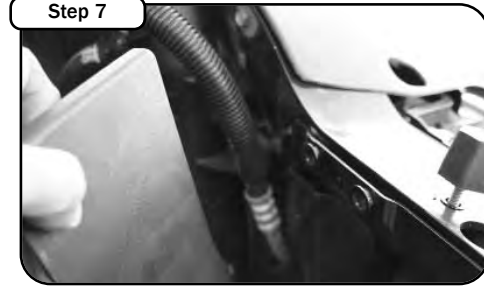

Remove plastic cover behind passenger head light.

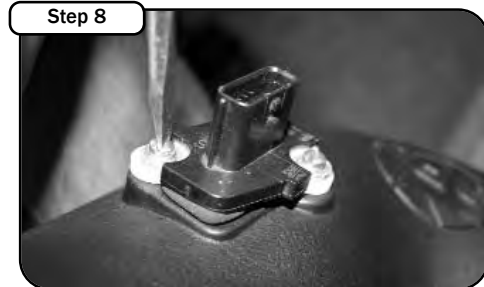

Remove MAF sensor from OE intake with T-20 torx bit. Insert MAF sensor into new tube with gasket, nylon spacer and #8-32 screws provided, spacers and gasket should be between tube and sensor.



Install tube to outside of housing. Tighten using screws, washers and nuts provided with 7/16" socket or wrench.



Place hump coupler at end of tube with clamps provided. Install into vehicle. Position tube and housing to factory position. Do not tighten clamps!



With 10mm socket or wrench, tighten down housing using 4 screws from step 6.



Tighten clamps @ turbo end with 5/16" nut driver. Re-connect MAF sensor harness.



Install air filter and tighten using 5/16" nut driver.



With button head screws provided, install housing cover and tighten using 5/32" allen key.



Your installation is now complete. Check all clamps and connections. Periodically check all clamps and hoses. Thank you for choosing aFe!

Note: Filter Cleaning and Re-oiling: When cleaning your aFe filter, be sure to use only aFe's "Restore Kit" (aFe P/N: 90-50000 gold oil aerosol, or aFe P/N: 90-50500 gold squeeze oil). Filter Replacement: 72-90038 Pro-GUARD 7 (black w/gold media) or 21-90038 Pro Dry S (black w/white media) or 24-90038 Pro5R (black w/bluemedia).