



advanced FLOW engineering™
 P.O. Box 1719
 Corona, CA 92878
 Support: 951-493-7100
 www.aFepower.com

Intake kit Installation Instructions: 2006-2008 BMW M5 / M6 V10-5.0L Stage 2

Kit P/N: 51/54-11272	Tools Required: 5/16" nut driver 1/4" nut driver Flat head screwdriver 10mm socket or extension T20 torx bit T30 torx bit 5mm allen key	Parts list Passenger side: 1 Air filter (Pro-5R™ 24-90052 or Pro Dry S™ 21-90052) 1 Housing 1 Diverter, air filter 05-00970 1 Diverter, housing 05-00983 1 Coupler, reducer (4-1/4" X 3-1/2") 1 Coupler, straight (3-1/2" X 2") 1 Tube, 05-00889 1 Adaptor, air filter 1 Gasket, MAF	1 Clamp, #072 3 Clamp, #060 7 Button head, screws M6 7 Washer, wavy M6 2 Screws, M4 x .7 x 16 1 3/4" trim seal @ 16.5" L 1 Fitting, plastic elbow 1" 1 Clamp, mini #012
----------------------	---	---	--



Complete Kit w/ Parts

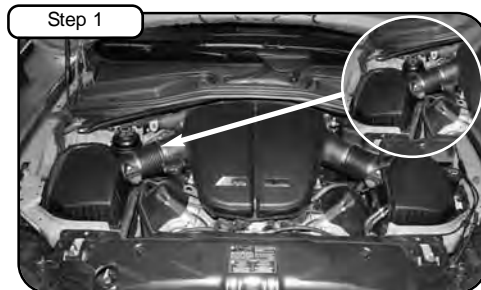

Step 1
Complete Stock Intake. Passenger side.



Step 2
Disconnect MAF sensor harness. Loosen clamps with 1/4" nut driver.



Step 3
Disconnect smog line from air box.

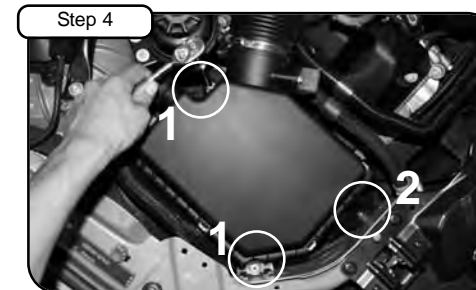

Step 4
1) Loosen the 2 bolts holding in bottom half of air box.
2) Push back clip on bottom half of airbox, located on bottom ram air unit.



Step 5
Remove air box from vehicle.



Step 6
Attach filter adaptor to housing using 3 button head screws & wavy washers. Tighten using 5mm allen key.



Step 7
Attach air diverters to housing using button head and wavy washers. Tighten using 5mm allen key. Install 3/4" trim seal on housing. *Note: Failure to install air diverters may result in CEL (Check Engine Light).*



Step 8
With T30 Torx bit, loosen the bolt holding in bottom ram air unit. Place housing into vehicle. Attach tab to housing to ram air unit. Re-install bolt and tighten.



Step 9
Re-install nut from step 4 and tighten using 10mm socket or wrench.



Step 10
Remove MAF sensor from airbox and install into new tube (05-00889) with screws and gasket provided. Tighten using flathead screwdriver.



Step 11
With couplers and clamps provided, install tube into vehicle.



Step 12
Position tube and tighten using 5/16" nut driver.



Step 12
Remove plastic smog pump elbow. *Note: If difficult to remove, a heat gun may allow for elbow fitting to come out easier.*

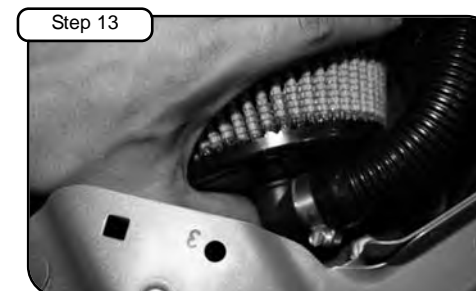

Step 13
Install filter on adaptor. Install plastic elbow with mini clamp provided to filter and smog pump line from step 12. Tighten mini clamp using 1/4" nut driver.



Step 14
Position smog pump line above ram air unit. Tighten clamp on filter using 5/16" nut driver. Re-connect MAF sensor harness. **Continue to page 2 for driver side installation.**

Note: Filter Cleaning and Re-oiling: When cleaning your aFe filter, be sure to use only aFe's "Restore Kit" (aFe P/N: 90-50001 blue oil aerosol, or aFe P/N: 90-50501 blue squeeze bottle oil).
 Filter Replacement: **Pro-5R™** P/N: 24-90052 (black w/blue media). **Pro Dry S™** P/N: 21-90052 (black w/white media) **Pro Dry S™** cleaning: see cleaning instruction sheet 06-00074.
 For replacement part(s) or "Restore Kit" please call aFe sales/tech support @ 951-493-7100



advanced FLOW engineering™
 P.O. Box 1719
 Corona, CA 92878
 Support: 951-493-7100
 www.aFepower.com

Intake kit Installation Instructions: 2006-2008 BMW M5 / M6 V10-5.0L Stage 2

Kit P/N: 51/54-11272	Tools Required: 5/16" nut driver 1/4" nut driver Flat head screwdriver 10mm socket or extension T20 torx bit T30 torx bit 5mm allen key	Parts list Driver side: 1 Air filter (Pro-5R™ 24-90052 or Pro Dry S™ 21-90052) 1 Housing 1 Diverter, air filter 05-00970 1 Diverter, housing 05-00983 1 Coupler, reducer (4-1/4" X 3-1/2") 1 Coupler, straight (3-1/2" X 2") 1 Tube, 05-00969 1 Adaptor, air filter 1 Gasket, MAF	1 Clamp, #072 3 Clamp, #060 7 Button head, screws M6 7 Washer, wavy M6 1 Washer, flat M6 1 Screw, hex M6 2 Screws, M4 x .7 x 16 1 3/4" trim seal @ 13" L 1 7/16" trim seal @ 3.5" L
-----------------------------	---	--	---



Complete Kit w/ Parts

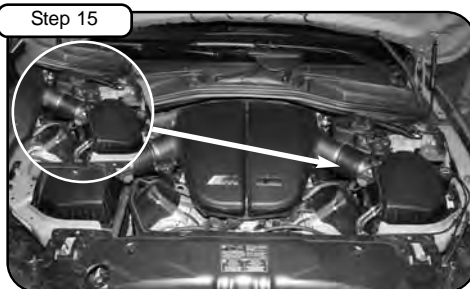

Complete stock intake. Driver side.



Pull out lines on top of air box.



Disconnect MAF sensor harness. Loosen clamps with 1/4" nut driver. Take out plastic intake tube.

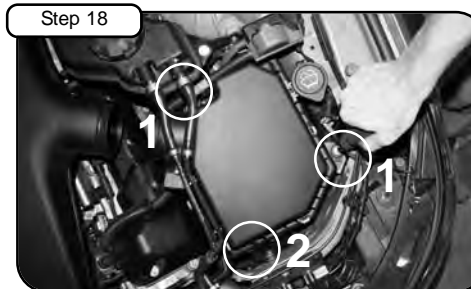

1) Loosen the 2 bolts holding in bottom half of air box.
 2) Push back clip on bottom half of airbox, located on bottom ram air unit.



Remove air box from vehicle.



Attach filter adaptor to housing using 3 button head screws & wavy washers. Tighten using 5mm allen key.



Attach air diverters to housing using button head and wavy washers. Tighten using 5mm allen key. Install 3/4" trim seal on housing. Install small 7/16" trim seal to corner of housing. *Note: Failure to install air diverters may result in CEL (Check Engine Light).*

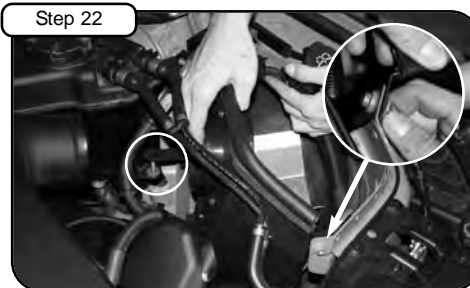

Place housing in vehicle. Attach tab to front radiator support using supplied M6 screw and washer.



Re-install nut from step 4 and tighten using 10mm socket or wrench.



Remove MAF sensor from airbox and install in new tube (05-00969) with screws and gasket provided. Tighten using flathead screwdriver.



With couplers and clamps provided, install tube into vehicle.



Position tube and tighten all clamps using 5/16" nut driver.



Place washer inlet reservoir onto housing tab.



Install air filter and tighten using 5/16" nut driver. Install pre filter. *Make sure cap is installed in filter top.* Re-connect MAF sensor harness.



Your installation is now complete. Check both driver and passenger side clamps and components periodically. Thank you for choosing aFe power!

Note: Filter Cleaning and Re-oiling: When cleaning your aFe filter, be sure to use only aFe's "Restore Kit" (aFe P/N: 90-50001 blue oil aerosol, or aFe P/N: 90-50501 blue squeeze bottle oil).
 Filter Replacement: **Pro-5R™** P/N: 24-90052 (black w/blue media). **Pro Dry S™** P/N: 21-90052 (black w/white media) **Pro Dry S™** cleaning: see cleaning instruction sheet 06-00074.
 For replacement part(s) or "Restore Kit" please call aFe sales/tech support @ 951-493-7100