



advanced FLOW engineering™
P.O. Box 1719
Corona, CA 92878
Support: 951-493-7100
aFepower.com

Intake Kit Installation Instructions: 2007-2008 Scion tC L4-2.4L Stage 2

Kit P/N: 51/54-11562			Tools Required: 5/16" nut driver Flat head screwdriver Phillips screwdriver 10mm socket or wrench Ratchet w/extension Pliers		Parts List: 1 Air filter (Pro-5R™ 24-40505 or Pro Dry S™ 21-40505) 1 Intake tube, MAS (05-00997) 1 Intake tube, TB (05-00808) 1 Housing 2 Screw, slotted M4x7x8 1 Screw Hex Head M6x1x20 1 Flat washer M6		1 3/4" trim seal @ 24.5"L 1 Coupler, Reducer (05-00649) 1 Coupler, Straight (05-00418) 1 Coupler, Straight (05-00417) 1 Clamp #064 5 Clamp #044	
Make:	Scion							
Model:	Year:	Engine:						
tC	2007-2008	L4-2.4L						



Complete Kit w/ Parts



Complete Stock Intake.
Disconnect battery before install.



Disconnect MAF sensor harness.



Loosen clamp on air box with 10mm socket or wrench.



Unclip the side of air box. Remove upper half of air box. Remove air filter.

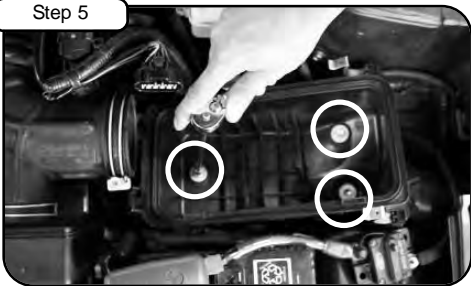

Loosen the 3 bolts holding in bottom of air box with 10mm socket or wrench and remove.

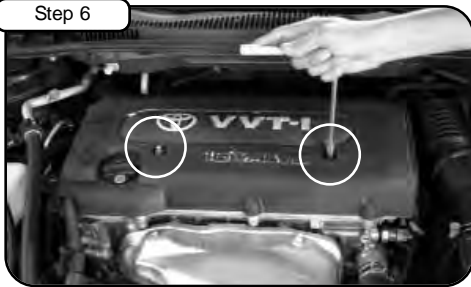

Loosen the two 10mm nuts holding engine cover and remove cover.

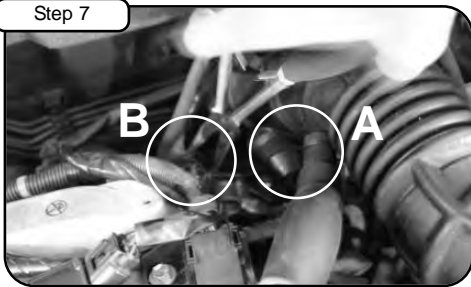

A) Pull back crankcase line from intake tube. B) With pliers, remove factory band clamp on Throttle Body. Pull tube away from Throttle Body.

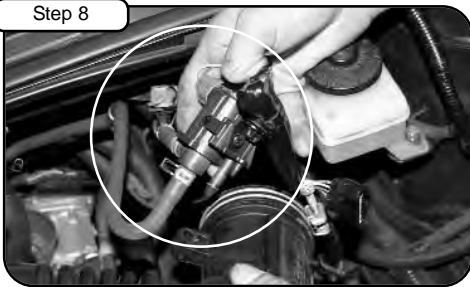

Pull back VSV valve away from intake tube.



Remove stock intake tube out of vehicle.



Attach trim seal to housing.



Loosen bolt holding in brake fluid reservoir. Install housing and position (see step 12).

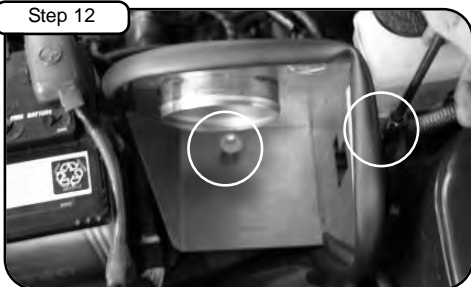

Re-install bolt and tighten tab on housing from step 11. With screw and washer provided, tighten bottom of housing with 10mm socket or wrench.



Install coupler (05-00417) to Throttle Body with clamps provided. Tighten clamp on Throttle Body only.



Install Throttle Body Tube (05-00808) tube along with coupler (05-00418) and clamps. *Do not tighten.*



Install MAF tube (05-00997) with coupler (05-00649) and clamps on housing side. Position all tubes and tighten clamps using 5/16" nut driver.



advanced FLOW engineering™
P.O. Box 1719
Corona, CA 92878
Support: 951-493-7100
aFepower.com

Intake Kit Installation Instructions: 2007-2008 Scion tC L4-2.4L Stage 2

Accessories Available:



Restore Kits
90-50001 Blue Aerosol
90-50501 Blue Squeeze
90-59999 Pro Dry S™ Cleaner

Replacement Air Filter:



Pro 5R™ 24-40505
Blue Media



Pro Dry S™ 21-40505
White Media

Note: Filter Cleaning and Re-oiling: When cleaning your aFe filter, be sure to use only aFe's "Restore Kit" (aFe P/N: 90-50001 blue oil aerosol, aFe P/N: 90-50501 blue squeeze bottle oil, aFe P/N: 90-59999 **Pro Dry S**™ cleaner only.) **Pro Dry S**™ cleaning: see cleaning instruction sheet 06-00074. For replacement part(s) or "Restore Kit" please call aFe sales/tech support @ 951-493-7100

Step 16



With phillips screwdriver, loosen and remove MAF sensor from stock air box.

Step 17



Install MAF sensor to new tube using the M4 screws provided and tighten.

Step 18



Loosen screw on bottom of VSV valve with phillips screw driver (see step 19).

Step 19



Install to bracket on MAF tube and use same screw from step 18 and tighten.

Step 20



Re-connect MAF sensor harness.

Step 21



Re-connect crankcase line to Throttle Body Tube.

Step 22

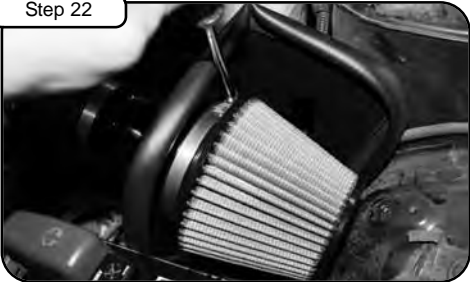

Install air filter and tighten using 5/16" nut driver.

Step 23



Re-install engine cover and tighten. Re-connect battery.

Step 24



Your installation is now complete. Make sure you tighten all clamps and check all electrical connections periodically. Thank you for choosing aFe!