



advanced FLOW engineering™
P.O. Box 1719
Corona, CA 92878
Support: 951-493-7100
aFepower.com

Intake Kit Installation Instructions: GM Duramax LB7 2001-2004 V8-6.6L (td) Stage 2 Si

Kit P/N:	51-80782 54-80782 75-80782-0 75-80782-0V	Make:	Chevrolet
Model:	Silverado 2500 HD Silverado 3500	Year:	'01-'04
Engine:	V8-6.6L(td) LB7 V8-6.6L(td) LB7		
Make:	GMC		
Model:	Sierra 2500 HD Sierra 3500	Year:	'01-'04
Engine:	V8-6.6L(td) LB7 V8-6.6L(td) LB7		

Tools Required:
5/16" nut driver
Flat head screwdriver
10mm socket or wrench
7/16" socket or wrench
Ratchet w/extension
T20 Torx bit
5/32" allen key
Pliers/cutters

Parts List:
1 Air filter (**Pro-GUARD 7™** 72-90038 or **Pro Dry 5™** 21-90038)
1 Housing, rotomold
1 Cover
1 Tube, 05-00988
1 Tube, 05-00989
1 Coupler, Reducer (05-00632)
1 Coupler, Hump (05-00800)
1 Clamp, #060
3 Clamp, #072

1 Clamp, mini #040
2 Screw, 1/4-20" x 1.25
4 Washer, fender 1/4"
2 Nut, nylon insert 1/4-20"
1 Torx bit, T20
2 Screw, #8-32
1 Gasket, MAF sensor
2 Spacer, Nylon
4 Screws, button head M6
1 Plug, Urethane aFe

Bonus Part List: (75-80782-0V only)
1 Air filter (**Pro Dry 5™** 21-90038)
1 Restore kit, gold squeeze
1 Pre-filter



05-00989
Complete Kit w/ Parts



Complete Stock Intake.
Disconnect battery before install.

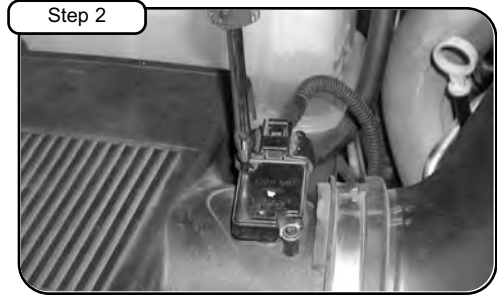

With T20 torx bit provided, loosen the two screws holding in MAF sensor.



Disconnect MAF sensor harness and remove carefully. *Note: MAF sensor can be damaged easily!*

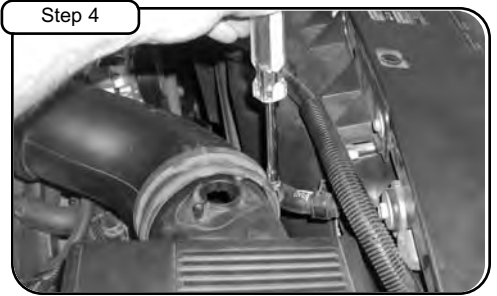

Loosen clamp on air box with 5/16" nut driver.



Lift and pull air box out of vehicle.

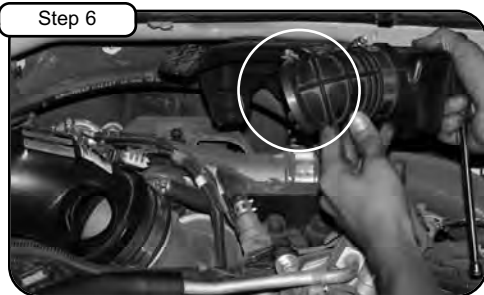

Cut clamp on resonator box connected to factory intake tube and pull back. Replace with mini # 040 clamp provided (see step 18). Do not tighten.



Loosen clamp on turbo with 5/16" nut driver.



Remove factory intake tube.

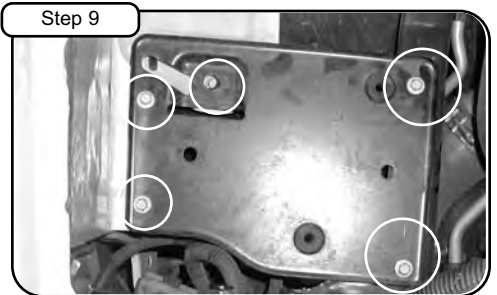

Loosen the 5 bolts on stock air box tray using a 10mm socket or wrench. Save 4 bolts for later use (see step 13). **Remove the air box tray out of vehicle.**



Install MAF sensor into new tube. Use provided screws, nylon spacers and gasket and tighten using flat head screwdriver.

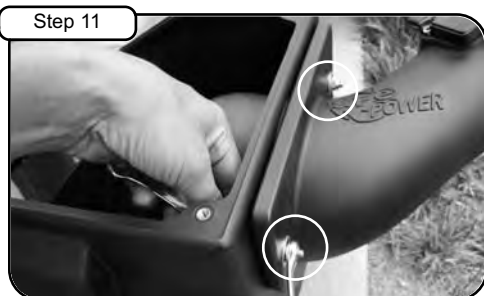

Attach tube to outside of housing using screws, nuts and fender washers provided and tighten using 7/16" socket or wrench.



Install housing with tube into vehicle and position.

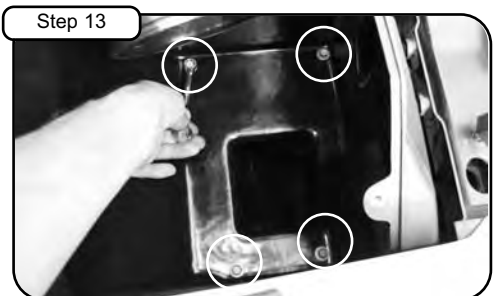

Use the 4 bolts from step 9 and tighten housing using 10mm socket or wrench.



Attach reducer coupler (05-00632) to tube with clamps and hump coupler (05-00800) with clamps. Pull back hump coupler for easier installation. Do not tighten.



Install tube to turbo inlet flange and position. *Make sure reducer coupler is on turbo flange.* Do not tighten.

Turn page over and continue to page 2 →



advanced FLOW engineering™
 P.O. Box 1719
 Corona, CA 92878
 Support: 951-493-7100
 aFepower.com

Intake Kit Installation Instructions: 2001-2004 GM Duramax LB7 V8-6.6L (td) Stage 2 Si

Accessories Available:



Restore Kits

- 90-50000 Gold Aerosol
- 90-50500 Gold Squeeze
- 90-59999 Pro Dry S™ Cleaner

Replacement Air Filter:



**Pro-GUARD 7™ 72-90038
 Gold Media**

**Pro Dry 5™ 21-90038
 White Media**

**PSA™ 24-90038
 White Media**

Note: Filter Cleaning and Re-oiling: When cleaning your aFe filter, be sure to use only aFe's "Restore Kit" (aFe P/N: 90-50000 gold oil aerosol, or aFe P/N: 90-50500 gold squeeze oil, aFe P/N: 90-59999 **Pro Dry S™** cleaner only.) Filter Replacement P/N: 72-90038 **Pro-GUARD 7™** (black w/gold media) or **Pro Dry 5™** P/N 21-90038 (black w/white media) **Pro Dry S™** cleaning: see cleaning instruction sheet 06-00074. For replacement part(s) or "Restore Kit" please call aFe sales/tech support @ 951-493-7100

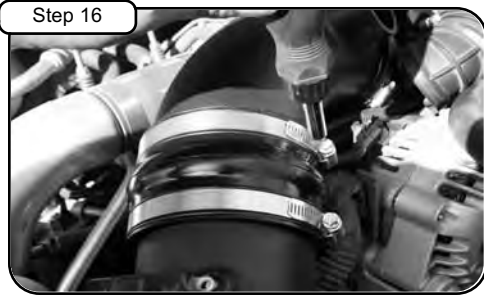

Step 16
 Slide hump coupler and attach both tubes and tighten using 5/16" nut driver. Tighten clamps with 5/16" nut driver.



Step 17
 Tighten reducer coupler clamps with 5/16" nut driver.

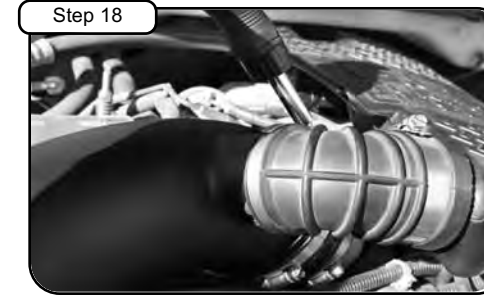

Step 18
 Attach resonator box to new box flange and tighten using flat head screw driver.



Step 19
 If vehicle does not come equipped with resonator box, use aFe urethane plug on tube.



Step 20
 Re-connect MAF sensor harness.



Step 21
 Install air filter to tube. Make sure filter seats on tube bead.



Step 22
 Tighten air filter using 5/16" nut driver.



Step 23
 Attach cover to housing.



Step 24
 Tighten cover using button head screws provided using 5/32" allen key.



Step 25
 Your installation is now complete. Make sure you tighten all clamps and check all electrical connections periodically. Thank you for choosing aFe!