



advanced FLOW engineering™
 P.O. Box 1719
 Corona, CA 92878
 Support: 951-493-7100
 aFepower.com

Intake Kit Installation Instructions: 2008 Mitsubishi Lancer Evolution X L4-2.0L (t) AWD Stage 2

Kit P/N: 51/54-11612	Tools Required: 5/16" nut driver Flat head screwdriver Phillips screwdriver 10mm socket or wrench Ratchet w/extension 6mm allen key	Parts List: 1 Air filter (Pro-5R™ 24-90052 or Pro Dry S™ 21-90052) 1 Housing 1 Coupler, reducer (05-00735) 1 Coupler, straight (05-00664) 1 Tube, intake 3" 1 Rubber edge trim seal @ 15" L 1 Adaptor, filter	1 Washer, flat M6 1 Washer, lock M6 1 Screw, hex M6 1 Clamp, #072 3 Clamp, #048 1 Grommet, rubber 3 Screws, button head M6
-----------------------------	--	--	--



Complete Kit w/ Parts



Step 1
Complete Stock Intake.
 Disconnect battery before install.

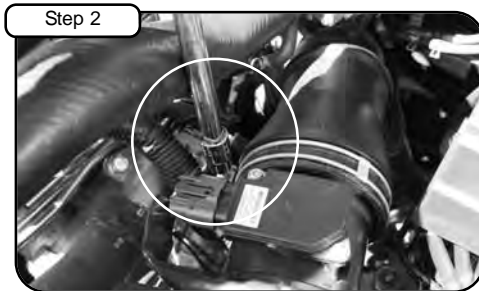

Step 2
 Loosen clamp on MAF sensor with 10mm socket or phillips screwdriver.



Step 3
 Disconnect MAF sensor harness and pull clips away from air box.

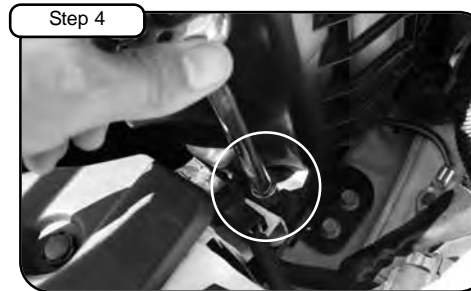

Step 4
 Loosen bolt on air box behind headlight with 10mm socket or wrench and remove.



Step 5
 Pull stock tube away from MAF sensor.



Step 6
 Carefully grab front of air box from ram air unit and lift.



Step 7
 Lift and pull out complete air box.

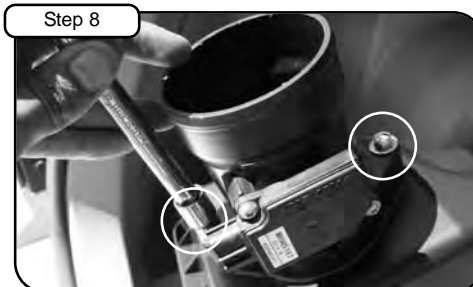

Step 8
 Loosen the 2 bolts holding in MAF sensor tube assembly to air box using 10mm socket or wrench.



Step 9
 Remove MAF sensor tube assembly from air box.

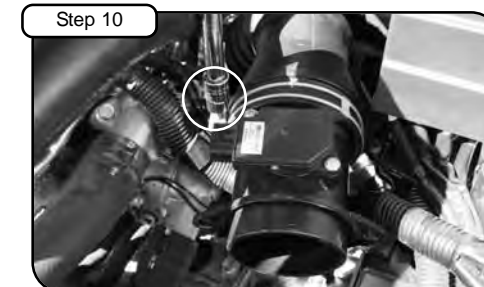

Step 10
 Re-install MAF sensor tube assembly to stock tube and tighten.
 Make sure arrow on MAF sensor is in direction of turbo!



Step 11
 Install rubber edge trim seal to top of housing. Install grommet to hole on housing..



Step 12
 Install filter adaptor to inside of housing. Attach to housing using the 3 button head screws provided and tighten using 6mm allen key.

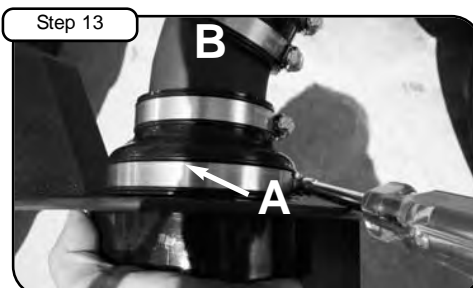

Step 13
 A) Attach reducer coupler (05-00735) to filter adaptor with clamps provided. Tighten clamp on adaptor only.
 B) Install intake tube to reducer coupler with straight coupler (05-00664) and clamps provided and pull back on to tube. Do not tighten.



Step 14
 Install intake assembly shown in step 13 into vehicle and position.



Step 15
 Push down housing for rubber grommet to sit on factory tab.

Turn page over and continue to page 2 →



advanced FLOW engineering™
 P.O. Box 1719
 Corona, CA 92878
 Support: 951-493-7100
aFepower.com

Intake Kit Installation Instructions: 2008 Mitsubishi Lancer Evolution X L4-2.0L (t) AWD Stage 2

Accessories Available:



Restore Kits

90-50001 Blue Aerosol
 90-50501 Blue Squeeze
 90-59999 Pro Dry S™ Cleaner



Pre-filter 28-1009x

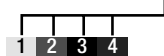

Replacement Air Filter:



**Pro-5R™ 24-90052
 Blue Media**



**Pro Dry S™ 21-90052
 White Media**

Note: Filter Cleaning and Re-oiling: When cleaning your aFe filter, be sure to use only aFe's "Restore Kit" (aFe P/N: 90-50001 blue oil aerosol, aFe P/N: 90-50501 blue squeeze bottle oil, aFe P/N: 90-59999 Pro Dry S™ cleaner only.) Pro Dry S™ cleaning: see cleaning instruction sheet 06-00074. For replacement part(s) or "Restore Kit" please call aFe sales/tech support @ 951-493-7100

Step 16

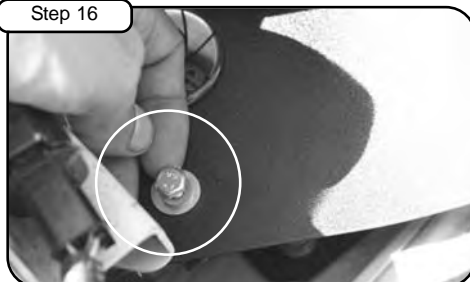

Secure housing using provided M6 screw, lock/ and flat washers provided to tab from step 4.

Step 17



Tighten using 10mm socket or wrench.

Step 18

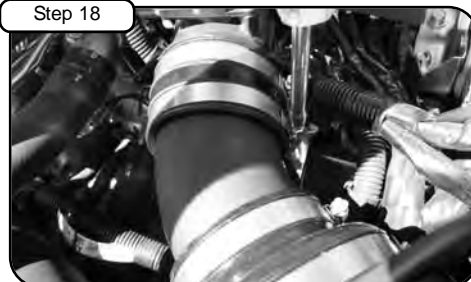

Pull back straight coupler onto MAF sensor and position tube. Tighten all clamps using 5/16" nut driver.

Step 19



Re-connect MAF sensor harness.

Step 20



Install air filter on tube and tighten using 5/16" nut driver.

Step 21



Your installation is now complete. Make sure you tighten all clamps and check all electrical connections periodically. Thank you for choosing aFe!