



advanced FLOW engineering™
 P.O. Box 1719
 Corona, CA 92878
 Support: 951-493-7100
 aFepower.com

Intake Kit Installation Instructions: 2006-2008 BMW E85/86 Z4 L6-3.0L (M54) Stage 2

Kit P/N: 51/54-11602	Tools Required: 5/16" nut driver 1/4" nut driver Flat head screwdriver T25 torx bit 10mm socket or wrench Ratchet w/extension 4mm allen key	Parts List: 1 Air filter (Pro-5R™ 24-60505 or Pro Dry S™ 21-60505) 1 Filter, crankcase 1 Tube (05-00769) 1 Housing 1 Cover 1 Coupler, elbow (05-00763) 1 Gasket, MAF sensor 1 Gasket, tube flange	1 Adaptor, filter 8 Washer, flat M6 4 Screw, hex M6 x 1 x 25 2 Screw, hex M6 x 1 x 12 2 Nut, hex M6 2 Screws, #8-32 x 5/8" 4 Screws, button head M6 2 Clamp, #056
-----------------------------	---	---	--



Complete Kit w/ Parts



Step 1
Complete Stock Intake.
 Disconnect battery before install.

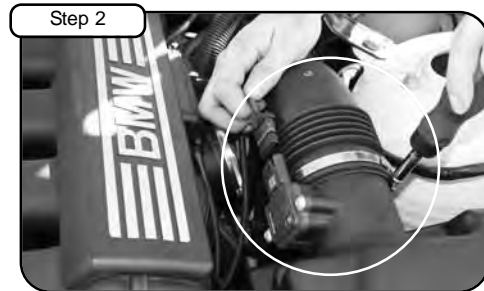

Step 2
 Disconnect MAF sensor and loosen clamp on air box using 1/4" nut driver.

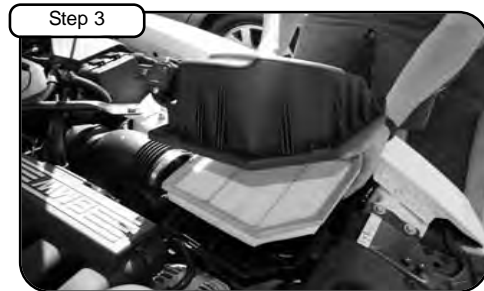

Step 3
 Lift up and pull upper half of air box out. Remove air filter.

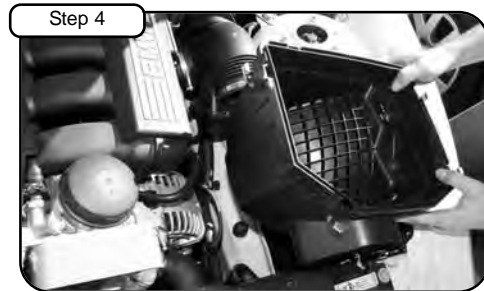

Step 4
 Lift and pull bottom half of air box out of vehicle.



Step 5
 A) Loosen clamp on back of tube attached to smog pump.
 B) Loosen clamp on Throttle Body using 1/4" nut driver.

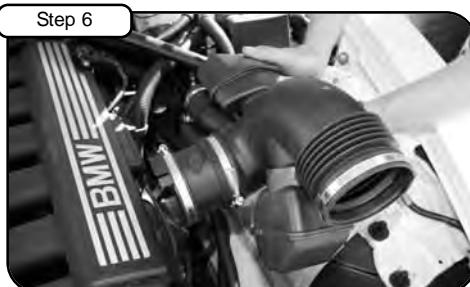

Step 6
 Remove Intake tube out of vehicle.

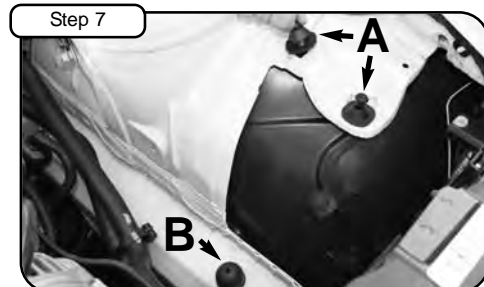

Step 7
 A) Turn and remove both clips from vehicle.
 B) Remove rubber housing mount.

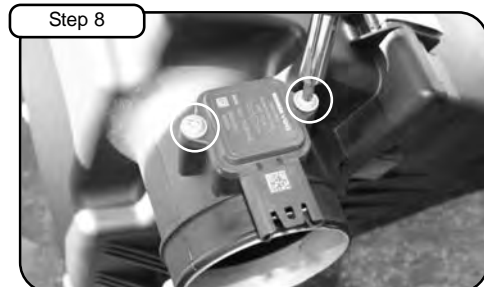

Step 8
 Loosen the 2 screws holding in MAF sensor using T25 Torx bit.



Step 9
 Carefully remove MAF sensor.



Step 10
 Install MAF sensor to tube using Gasket provided and 2 screws. Tighten using flathead screwdriver. Make sure arrow is in direction towards Throttle Body.

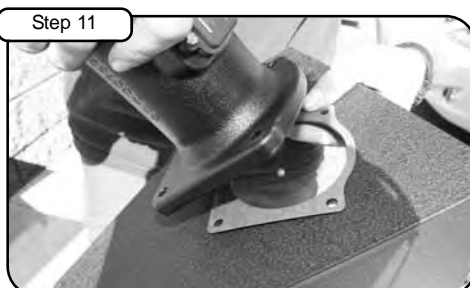

Step 11
 Attach tube to outside of housing using gasket provided.

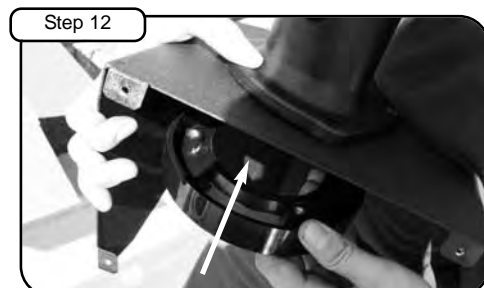

Step 12
 Attach filter adaptor to inside of housing.



Step 13
 Using the 4 M6 x 1 x 25 screws and 4 flat washers provided tighten and secure to adaptor. Tighten using 10mm socket or wrench.

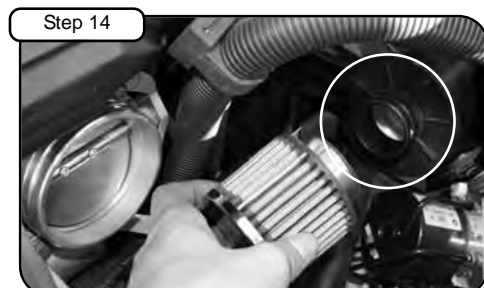

Step 14
 Attach crankcase filter to smog pump and tighten using 5/16" nut driver.



Step 15
 Attach coupler to tube with clamps provided. Do not tighten.

Turn page over and continue to page 2 →



advanced FLOW engineering™
 P.O. Box 1719
 Corona, CA 92878
 Support: 951-493-7100
aFepower.com

Intake Kit Installation Instructions: 2006-2008 BMW E85/86 Z4 L6-3.0L Stage 2

Accessories Available:



Restore Kits

90-50001 Blue Aerosol
 90-50501 Blue Squeeze
 90-59999 Pro Dry S™ Cleaner

Replacement Air Filter:



**Pro-5R™ 24-60505
 Oiled Media**



**Pro Dry S™ 21-60505
 Dry Media**

Note: Filter Cleaning and Re-oiling: When cleaning your aFe filter, be sure to use only aFe's "Restore Kit" (aFe P/N: 90-50001 blue oil aerosol, aFe P/N: 90-50501 blue squeeze bottle oil, aFe P/N: 90-59999 Pro Dry S™ cleaner only.) Pro Dry S™ cleaning: see cleaning instruction sheet 06-00074. For replacement part(s) or "Restore Kit" please call aFe sales/tech support @ 951-493-7100

Step 16



Install into vehicle and position.

Step 17



Secure housing using the 2 M6 x 1 x 12 screws and washers provided. Tighten using 10mm socket and wrench.

Step 18



Tighten all clamps using 5/16" nut driver.

Step 19



Install air filter on tube and tighten using 5/16" nut driver.

Step 20



Install cover to housing using button head screws and tighten using 4mm allen key.

Step 21

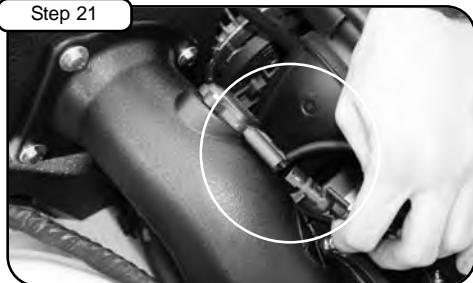

Re-connect MAF sensor harness. Re-connect battery.

Step 22



Your installation is now complete. Make sure you tighten all clamps and check all electrical connections periodically. Thank you for choosing aFe!