



## INSTALLATION INSTRUCTIONS

MAKE: GM  
MODEL: DURAMAX  
YEAR: 2011-2016  
ENGINE: V8-6.6L (td) LML  
WHEELBASE: 240" to 259"

**4" Race Pipe**  
**49-04022 (AL)**  
**49-44027 (409 SS)**



### RACE ONLY DISCLAIMER

This is a Race Only product that is to be used solely for competition, it cannot be used on vehicles that are operated on public streets, roads or highways. Its use is limited to closed-course and open-course racing that is formally sanctioned by a recognized racing organization. Any other use, including recreational off-road use, could be in violation of local, state and federal laws. A competition acknowledgement / liability release form must be filled out and submitted.

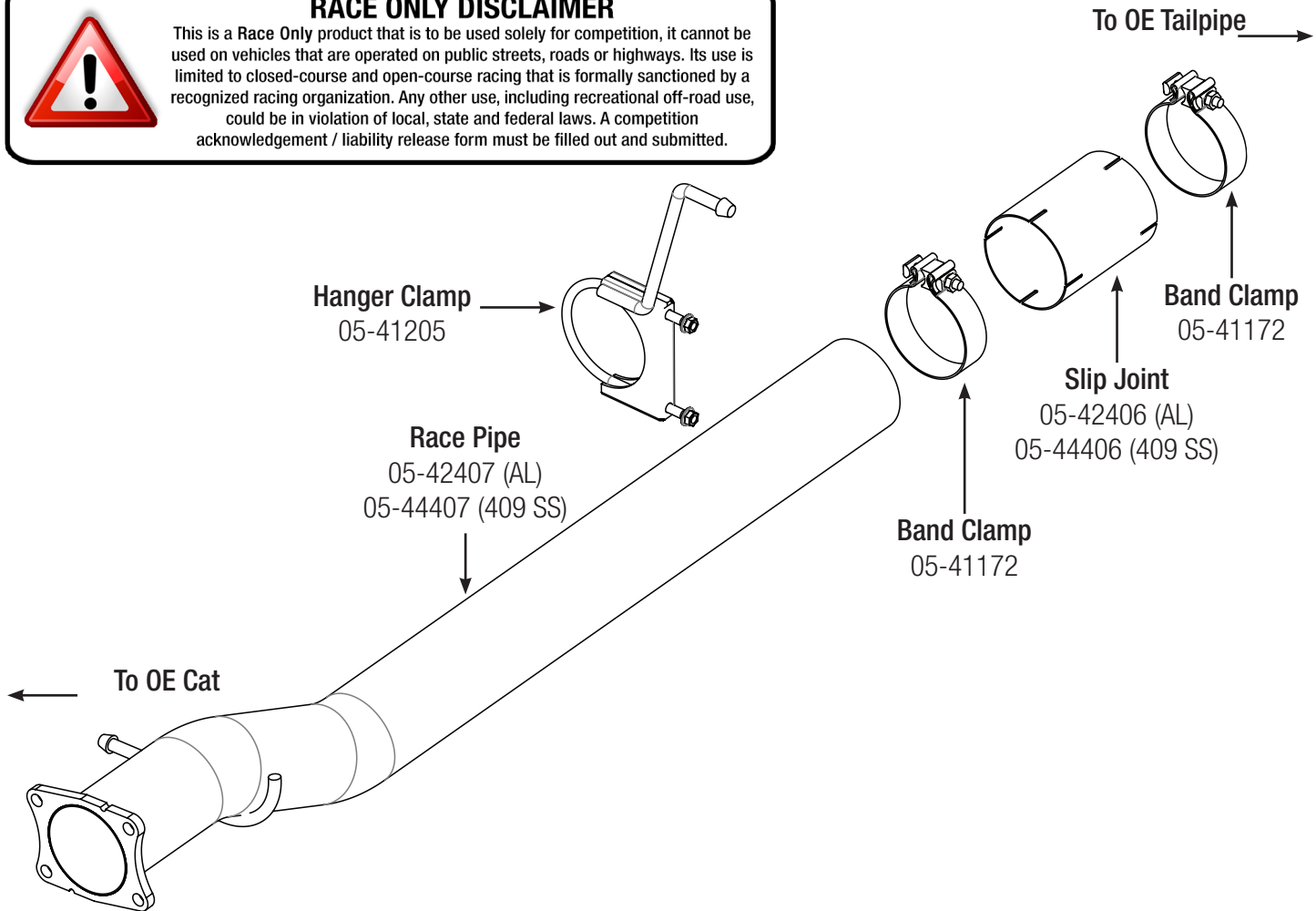

- Step 1: (Read Instructions prior to installation)** Disconnect all sensors that are plugged into the factory DPF. Take caution as not to damage any sensors.
- Step 2: (Requires cutting)** Measure 3 inches from the end of your DPF weld seam. You will have to mark and cut your tailpipe. This will allow you to separate and remove the DPF unit without the removal of your entire exhaust system.
- Step 3:** Remove the (4) four nuts securing the CAT to the DPF.
- Step 4:** Remove the factory DPF by removing the isolation hanger from the DPF then sliding the DPF rearward to remove.
- Step 5:** Install the Slip Joint and two band clamps onto the Race Pipe.
- Step 6:** Ensure that the factory gasket is on the four studs on the end of the CAT.
- Step 7:** Install the race pipe onto the four studs on the CAT, then install the (4) nuts removed in step 3. then slide the Slip Joint over the factory tail pipe, and loosely secure with the two band clamps.
- Step 8:** Install the Race Pipe and Hanger Clamp into the isolators.
- Step 9:** Adjust the exhaust system for alignment and tighten all clamps. Your installation is now complete. It is recommended to re-tighten all exhaust components after the first 50-100 miles.

### NOTES:

- aFe recommends that the tailpipe be at least 1/2"-1" away from any body panels to avoid heat related body damage. **Tighten and secure.**
- Controller/Programmers are required to operate this system.

**Caution:** Allow time for your vehicle to cool down prior to installation. When working on or under your vehicle proceed with caution. Exhaust systems reach high temperatures and may cause serious burns. Wear protective safety equipment; eye goggles and gloves to ensure a safe installation. **aFe recommends professional installation on our products.**