



INSTALLATION INSTRUCTIONS

MAKE: Dodge / RAM

MODEL: 2500, 3500

YEAR: 2007.5-2012

ENGINE: L6-6.7L (td)

WHEELBASE: All except Cab & Chassis

DPF-Back Exhaust

49-42006

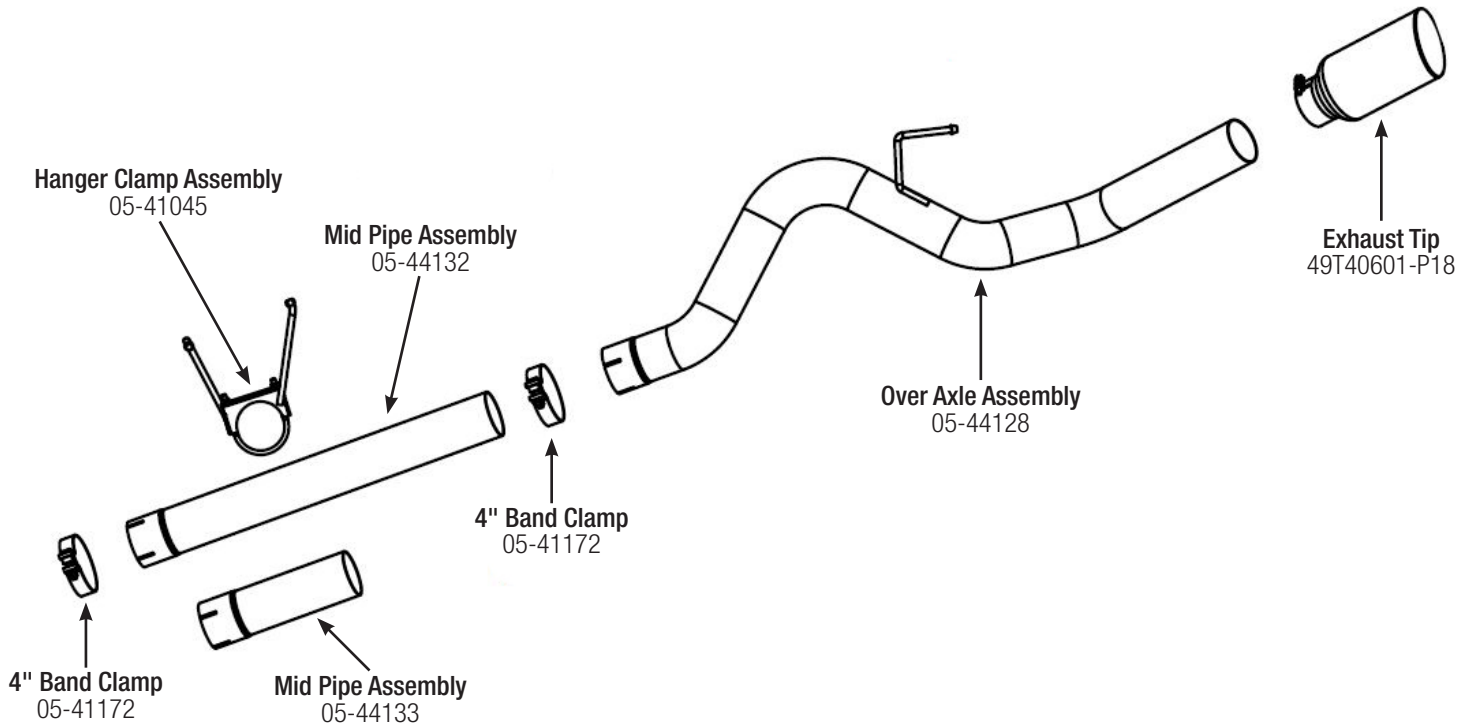

Caution: aFe recommends professional installation on our products. Allow time for your vehicle to cool down prior to installation. When working on or under your vehicle proceed with caution. Exhaust systems reach high temperatures and may cause serious burns. Wear protective safety equipment; eye goggles and gloves to ensure a safe installation.

Step 1: (Read Instructions prior to installation). Loosen band clamp at rear of particulate filter before muffler. Remove the stock exhaust from the rear of the truck working your way forward. Take caution not to damage the factory isolation mounts as they will be reused. **It is recommended to not fully tighten the clamps until the entire system has been installed.**

Step 2: For faster installation spread the pieces of the exhaust along side of your vehicle according to the diagram shown.

Step 3: Slip band clamp over expanded end of tube prior to installation. Install the mid-pipe (SWB) using the short section for regular cab/ quad cab short bed or the long section (LWB) for long wheelbase (MEGACAB or Quad Cab long bed). Locate OE rubber isolators and install hanger, lift system up and slip u-bolt into hanger. Hand tighten nuts.

Step 4: Slip band clamp over expanded end of tube prior to installation of overaxle/tail-pipe. Utilizing the factory isolation mounts now install overaxle/tail-pipe and tighten band clamp. Now make sure to tighten all clamps from front to rear.

Step 5: Install the exhaust tip. Adjust for alignment and tighten all connections. Your installation is now complete. It is recommended to re-tighten all exhaust components after the first 50 - 100 miles.