



DODGE CUMMINS

2004.5-2007 L6-5.9L (td)

P/N
49-42007
49-42012

FULL 5" STAINLESS STEEL DIESEL EXHAUST

Features:

- High performance
- 5" mandrel-bent tubing
- 409 SS construction
- OE style clamps and hangers
- 2-piece tailpipe
- Turbo-back & Cat-back

Benefits:

- + 179% flow increase
- Increased MPG
- Lowers EGTs

aFePower.com



Tech Sheet

Exhaust Systems



P/N 49-42007
49-42012



Material
Muffler
Clamps
Tailpipe
Tip
Install Time

Full 5" 409 stainless steel tube
8" 409 stainless steel
Band clamp
2-piece
Included (304 SS)
2 hour

Application

Make Dodge

Model RAM 2500 & 3500

Year 2004.5-2007

Engine L6-5.9L
Cummins (td)

Chassis RCLB, QCSB,
QCLB & MEGA Cab

Features & Benefits

Bayonet hangers

Swaged bayonet ends lock your exhaust component into place for the most secure installation possible. Other manufacturers use less expensive bent hangers that allow tubes and parts to slide from side to side, causing premature wear and damage.

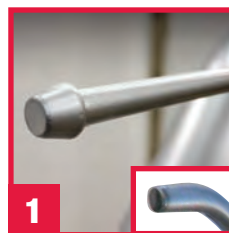

Welded-on hangers

Every hanger is thoroughly welded on each side to ensure a stronger connection, compared to other manufacturers who use only inferior floating hangers.

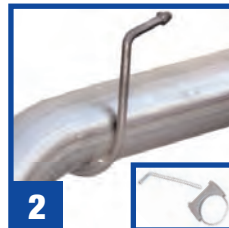

Band style clamps

Premium-quality band clamps are used on critical joints to provide the tightest, leak-free seal possible. Other systems use common, less expensive U-bolt clamps.



Mandrel bent

All aFe tubing is 100% mandrel-bent. Mandrel bending ensures the tubing maintains its shape and size, providing smooth, unrestricted airflow. Standard tubing can lose as much as 20% of its diameter in sharp bends.



See chart at left

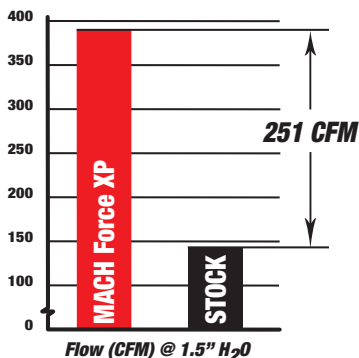
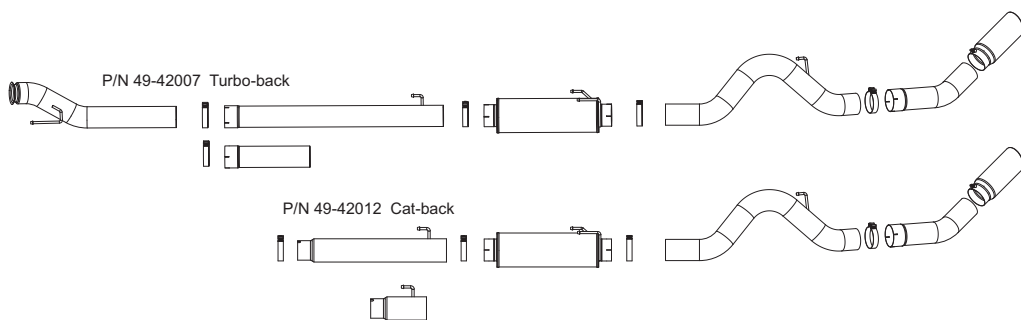
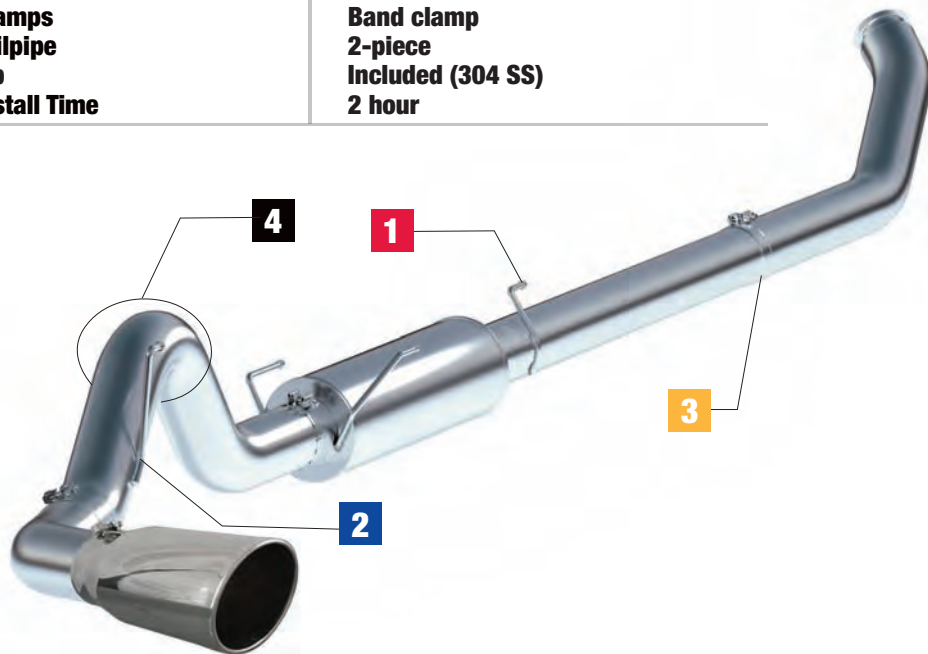

Performance Data

CFM Up to 179% increase

EGTs Reduced by 100°F

MACH Force XP

Turbo-back
Cat-back

P/N

49-42007
49-42012

Weight

88 lbs.
69 lbs.

Box Size

49" x 13" x 23"
49" x 13" x 23"

UPC

80295949452
80295949467

MSRP

\$882.35
\$676.47

J-Price

\$750.00
\$575.00

advanced FLOW engineering

252 Granite St. Corona, CA 92879 • 951.493.7100 • FAX: 951.493.7177 • aFepower.com

40-12348

Last update: 9-2008