



INSTALLATION INSTRUCTIONS

MAKE: Toyota
MODEL: Tundra
YEAR: 2007-2008
ENGINE: V8-5.7L
WHEELBASE: 145.7" (ONLY)



3.5" Cat-Back (409SS)
49-46006

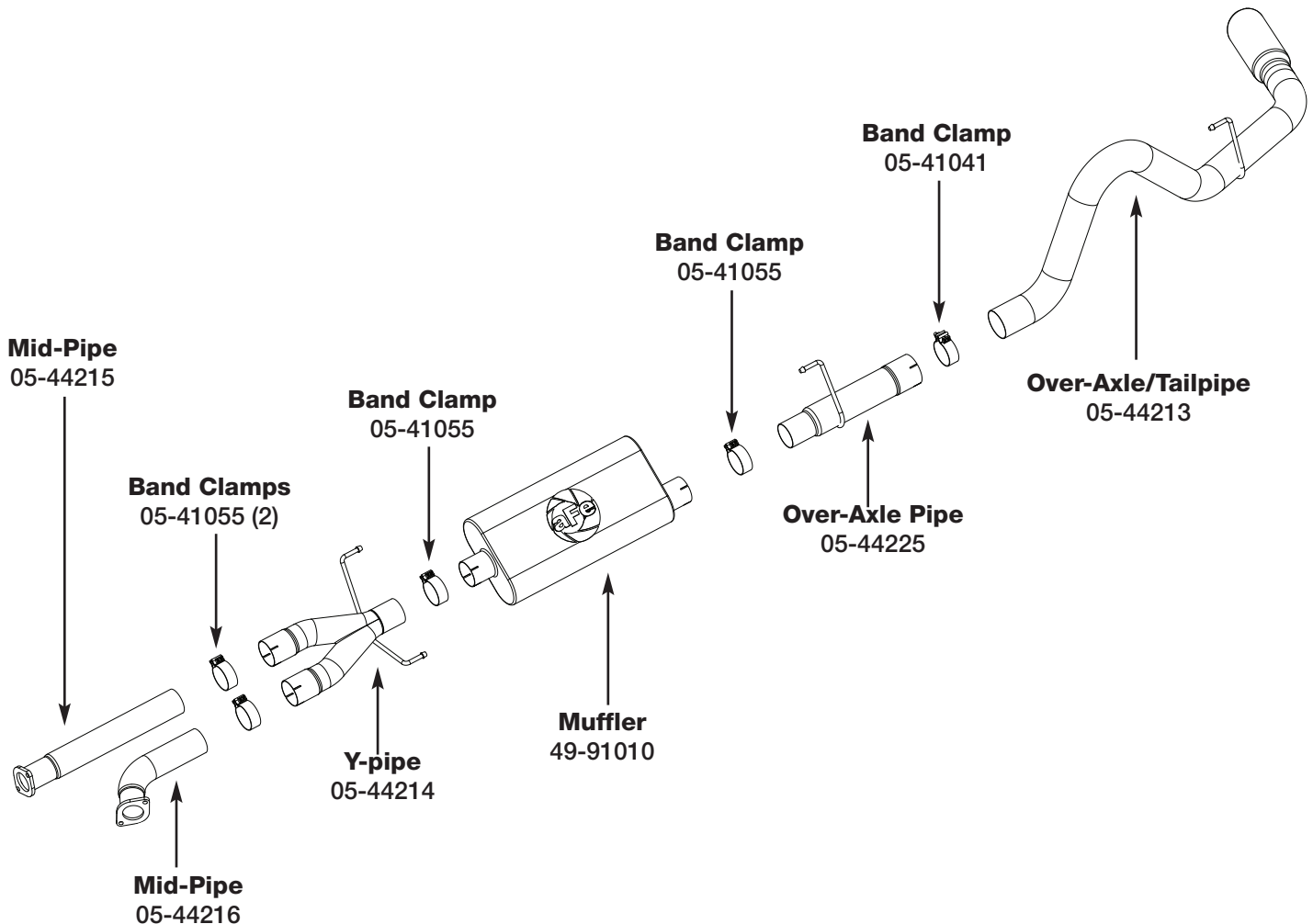

Step 1: (Read Instructions prior to installation) Remove your stock exhaust up to the catalytic converter from the rear of your truck working your way forward. Take caution not to damage the factory bolts and isolation mounts as they will be reused.

It is recommended to not fully tighten the clamps until the entire system has been installed.

Step 2: For faster installation spread the pieces of the exhaust along side of your vehicle according to the diagram shown.

Step 3: Install mid-pipes using factory bolts at flanges. Do not over tighten, now slip band clamps over the ends of the Y-pipe and slide the Y-pipe onto the mid-pipes and the factory isolation mounts.

Step 4: Slip the band clamps over the ends of the muffler prior to installation, at this time install the muffler.

Step 5: Utilizing the factory isolation mounts now install the over-axle pipe and the over-axle/tailpipe. Now tighten all of the band clamps from front to rear.

Step 6: Your installation is now complete. It is recommended to re-tighten all exhaust components after 50-100 miles.

NOTE:

- aFe recommends that the tailpipe be at least **1/2"-1"** away from any body panels to avoid heat related body damage. **Tighten and secure.**

Caution: Allow time for your vehicle to cool down prior to installation. When working on or under your vehicle proceed with caution. Exhaust systems reach high temperatures and may cause serious burns. Wear protective safety equipment; eye goggles and gloves to ensure a safe installation. **aFe recommends professional installation on our products.**