

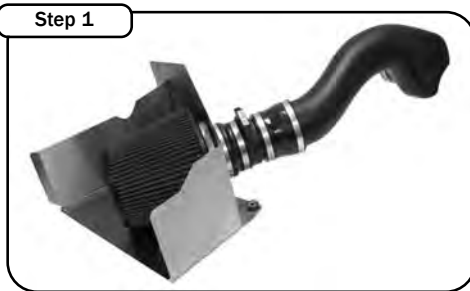

P.O. Box 1719
 Corona, CA 92878
 Support: 951-493-7100
 www.aFeFilters.com

Intake Kit Installation Instructions: '03-'05 Hummer H2 V8-6.0L

Kit Part # 51/54-10402	Tools Required: 5/16" nut driver or slotted screwdriver 8mm socket or wrench 10mm socket or wrench Ratchet and extension	Part List: Stage 2 1 Air filter (24-91018) or Pro Dry S™ 21-90020 1 Housing 1 Air filter adapter 1 Coupler 4x3-3/4" 5 M6 washer wavy 5 M6x1x10, Button head screw	1 Clamp#072 1 Trim Seal 3/4" bulb (30.5") 1 Trim seal 7/16" bulb (4") 1 Intake tube 1 Coupler reducer, 05-00020 1 Coupler reducer, 05-00033 2 Clamps #60 3 Clamps #64
Make: Hummer			
Model H2	Year '03-'05	Engine V8-6.0L	



Step 1
 Complete kit .Stage 2 shown.Stage 1 kit does not include tube,clamps and couplers.



Step 2
 Complete stock intake.

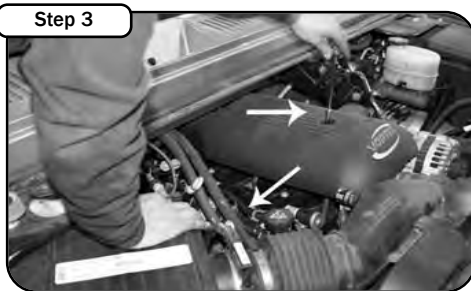

Step 3
 Disconnect negative terminal from battery. Remove the 8mm engine cover bolt and set aside. Disconnect the MAF sensor.



Step 4
 Loosen the hose clamp connecting the MAF sensor to the filter hosing.remove the three 10mm bolts securing the housing to the engine.

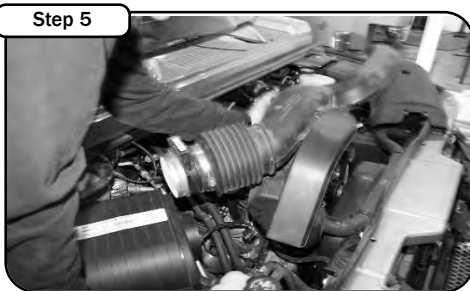

Step 5
 Loosen the clamps connecting the intake duct to the throttle body.If installing on Stage 2 system remove entire intake duct out of the engine bay.



Step 6
 Remove the three rubber mounts on the bottom of the airbox.Use a flathead screwdriver to remove the steel sleeve in the center.



Step 7
 Transfer the rubber mounts to the new air filter housing.(Hint)Use a bit if lubricant to ease installation of the mounts.

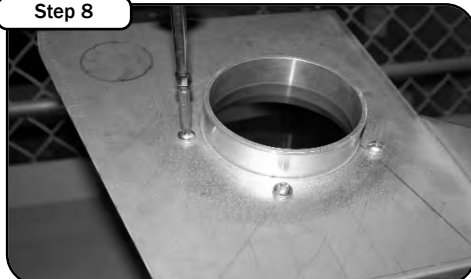

Step 8
 Slide the MAF sensor adapter in to the housing.Bolt the adapter to the housing using the supplied M6 screws and washer.



Step 9
 Place the rubber trim seal along edges of the housing..Bolt the housing to the engine bay using the factor bolts removed in step 4.If installing stage 1 kit re-connect factory tube to MAF sensor.



Step 10
 Install intake filter into housing.Complete stage 1 system installed.Your installation is now complete .Make sure you tighten all clamps and check all electrical connections.Re check periodically.Continue onto steps 11-13 to install stage 2.

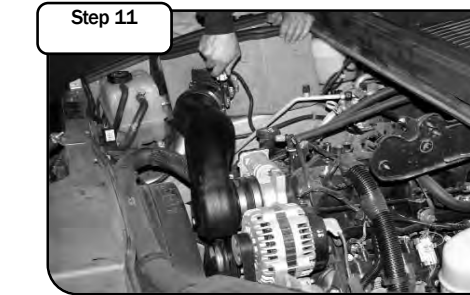

Step 11
 Place straight coupler on throttle body and install intake tube.Tighten and secure all hose clamps.Rotate fan to make sure there is sufficient clearance between the intake tube and the fan.



Step 11
 Re install the plastic engine cover

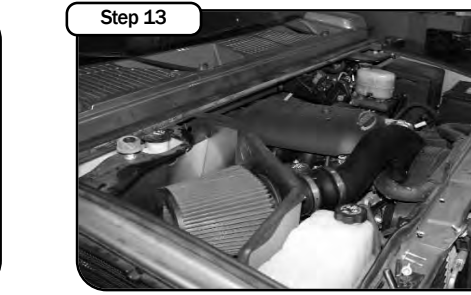

Step 13
 Place enclosed CARB EO sticker on a smooth/clean surface on or near the intake system. Eo identification label is required in passing Smog Check inspection. Your installation is now complete. Make sure you tighten all clamps and check all electrical connections.Re check periodically.



Housing end Tube end

Note: Filter Cleaning and Re-oiling: When cleaning your aFe filter, be sure to use only aFe's "Restore Kit" (aFe P/N: 90-50001 blue oil aerosol, or aFe P/N: 90-50501 blue squeeze bottle oil or aFe P/N: 90-50000 gold oil aerosol, or aFe P/N: 90-50500 gold squeeze oil). Filter Replacement: Magnum FLOW PN: 24-91018 (black w/blue media. **Pro Dry S™** P/N: 21-90020 (black w/white media) **Pro Dry S™** cleaning: see cleaning instruction sheet 06-00074.