



P.O. Box 1719  
 Corona, CA 92878  
 Support: 951-493-7100  
 www.aFeFilters.com

# Intake Kit Installation Instructions: 2005-Up Nissan Frontier 4.0L V6

<b>Kit Part #</b>	54-10492 51-10492 Pro Dry S™	<b>Tools Required</b>	<b>Parts List:</b>	2 Spacer nylon
<b>Make:</b>	Nissan	5/16" nut driver	1 Air Filter Replacement P/N (24-91034 or Pro Dry S™ 21-90047)	1 Gasket MAF sensor
<b>Model:</b>	Frontier, Pathfinder, Xterra	Slotted screwdriver	1 Intake tube	1 Trim seal 3/4" Bulb (26.5")
<b>Engine:</b>	4.0L V6	10mm socket or wrench	1 Intake housing	1 Coupler 3.5"x4"
<b>Year:</b>	2005- Up	Ratchet and extension	2 Screw M6x1x25	2 Clamps #060
			2 M6 washer	
			2 Washer wavy M6	
			2 M6 nut	
			2 Phillips screw #8-32	



**Step 1**  
 Complete kit. Please verify all components are present prior to beginning installation.



**Step 2**  
 Complete stock intake.

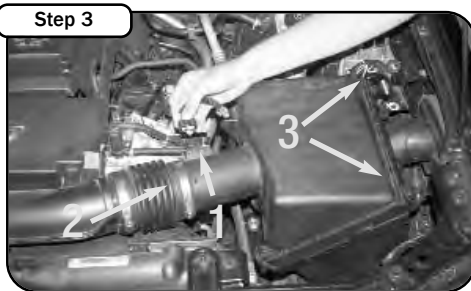

**Step 3**  
 Disconnect the MAF sensor (1). Loosen the hose clamp on the air box (2), and unclip the upper portion of the air box (3).



**Step 4**  
 Remove the upper portion of the air box and the factory air filter.

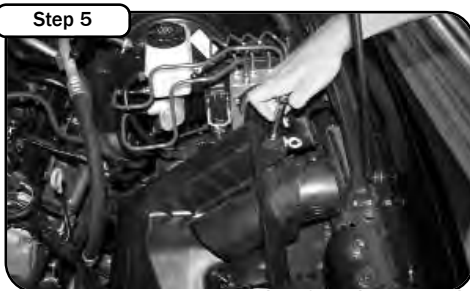

**Step 5**  
 Remove the 10mm bolt on the side of the air box set aside for later use. Lift the lower air box up and out of the engine bay.



**Step 6**  
 Transfer the rubber vibration mounts located on the bottom of the air box over to the new housing.



**Step 7**  
 Place the rubber trim seal along the edge of the housing. Lower the housing into the engine bay secure housing with the bolt removed in step 5.



**Step 8**  
 Place the coupler on to the intake tube. Do not tighten clamps at this time.



**Step 9**  
 Slide the intake tube assembly into the housing. Secure the tube to the housing with the supplied M6 hardware. Tighten and secure the hose clamp.

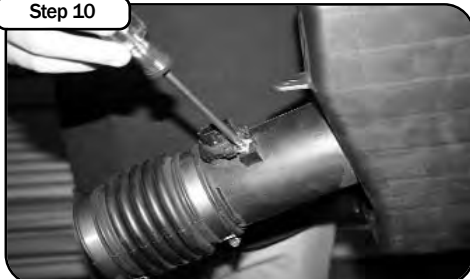

**Step 10**  
 Carefully remove the MAF sensor from the OEM air box lid.



**Step 11**  
 Transfer the MAF sensor to the aFe intake tube. Secure with the supplied gaskets, spacers, and screws. Make sure you pay attention to the direction of the arrow on the MAF sensor.

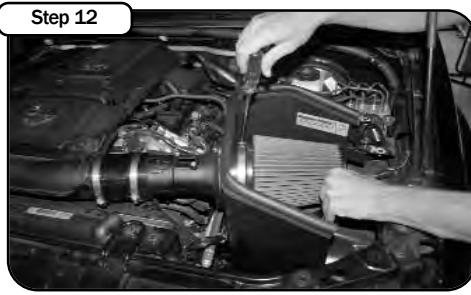

**Step 12**  
 Install the pre oiled air filter. Do not use any grease or oil. Secure with the provided clamp.



**Step 13**  
 Your installation is now complete. Make sure you tighten all clamps and check all electrical connections. Re check periodically

Note: Filter Cleaning and Re-oiling: When cleaning your aFe filter, be sure to use only aFe's "Restore Kit" (aFe P/N: 90-50001 blue oil aerosol, or aFe P/N: 90-50501 blue squeeze bottle oil or aFe P/N: 90-50000 gold oil aerosol, or aFe P/N: 90-50500 gold squeeze oil).  
 Filter Replacement: Magnum FLOW PN: 24-91034 (black w/ blue media).  
 Pro Dry S™ N/P 21-90047 (black w/ white media) Pro Dry S™ cleaning: see cleaning instruction sheet 06-00074