



P.O. Box 1719
 Corona, CA 92878
 Support: 877-512-8111
 www.afeilters.com

Kit Part #	54-10542
Make:	Ford
Model:	Class C motorhome / E-Series Van
Engine:	V-10 6.8 L
Year:	1997-2006
Note: Please confirm Parts List and read all instructions steps before proceeding with actual installation.	

Intake Kit Installation Instructions: 1997-2006 Ford class C Motorhome & E-Series V10

Tools Required	8mm socket 5/16" nut driver 10mm socket Ratchet and extension Fathead screwdriver
Part List:	1 Air filter part # 24-60512 / 72-60512 1 Housing powder coat black wrinkle 1 Intake tube rotomolded 1 Filter adapter 5 M6 x 1 x 20mm hex head 1 Spacer nylon 1 Coupler 3.5 x 3.0"

2 Trim seal (1.5")	2 Clamps #056
1 Grommet temp sensor	1 Decal Magnum Force
1 Instruction sheet	1 MAF sensor housing (Models 2005 and up)
1 Filter adapter	
1 Gasket MAF	
1 Gasket nylon	
1 Coupler 3.5 x 3.0"	

Step 1



Complete kit with parts.



Loosen hose clamp on the intake pipe and plastic internal baffle with a nut driver or flat head screwdriver. Remove the intake pipe and baffle out of vehicle.

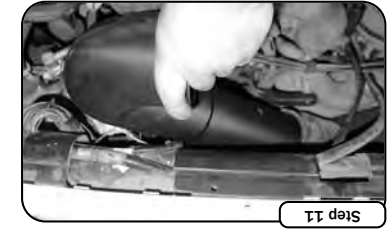

Remove the black grounding strap and bolt located on the top of the engine bay. Install the new intake pipe to the engine and tighten down the factory hose clamp.

Step 2

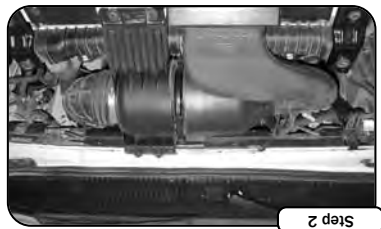

Complete stock intake.



Separate the filter canister by unfastening the band clamp and removing the air filter. Disconnect the harness from the MAF sensor. Undo the MAF sensor from the filter base and the short wire harness set aside for later use

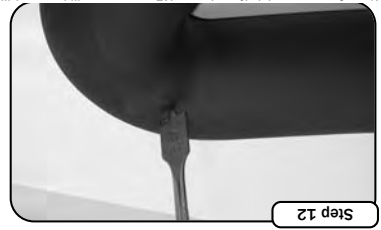

Note: On some models if you have a IAT sensor you will have to drill a hole in the intake pipe for the sensor. The location for this sensor is already pre determined with a yellow dot. Carefully drill a 1/4" hole in the intake pipe. Insert the supplied rubber grommet in the adhis inside prior to installation)

Step 3



Disconnect negative post from battery terminal. Remove the 8mm bolts that hold the factory air intake assembly (set these bolts to the side you will be reusing these later).

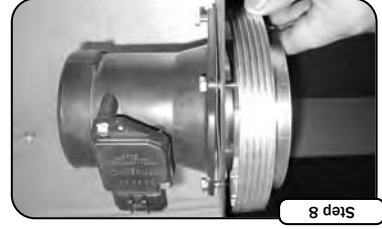

(On '97-04 Models) Mount the MAF sensor and MAF sensor gasket to the outside of the air filter housing. On the inside of the housing mount the air filter adapter. Use the (4) M6x1x20 screws and tighten down with a 10mm wrench.



Mount the housing into the engine compartment. Insert the supplied plastic spacer over the grounding strap making sure the hole in the spacer is lined up correctly. Finally tighten down all the bolts. Install pre-plaid filter.

Step 4



Loosen the factory hose clamp with a nut driver or screwdriver connecting the black rubber intake pipe to the factory air filter housing. (Bracket located on side of air box by pulling straight out.)



On 2005 and up models remove MAF sensor from factory housing and install into AFE tube. Install using provided screws, spacers, and gasket. Bolt tube onto housing using provided screws, washers and gaskets.



Place the rubber coupler between the MAF sensor and the intake pipe and slip the (2) #56 hose clamps over the connection and tighten the hose clamps. Insert the white mounting fastener on the MAF harness into the provided hole located on the side of the housing. Reconnect the MAF wiring harness to the engine.

Step 5

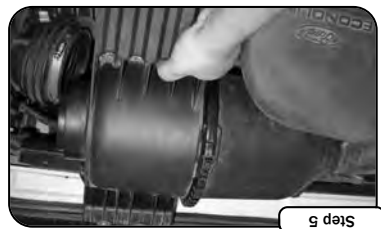

Remove air filter housing by pulling straight up and out of the engine bay.



Transfer the (4) rubber grommets from the factory housing and install into the provided slots. Push the grommets into the provided slots.

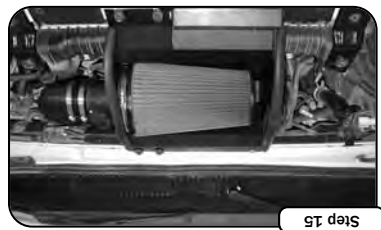

Your installation is now complete. Make sure all hoses and clamps are tight and reattach components after a few hours of operation. Close hood slowly to verify hood clearance.

Note: Filter Cleaning and Re-oiling: When cleaning your AFE filter, be sure to use only AFE's "Restore Kit" AFE P/N: 90-50001 blue oil aerosol, or AFE P/N: 90-50004 blue oil aerosol, or AFE P/N: 90-50000 yellow oil aerosol, or AFE P/N: 90-50500 yellow squeeze bottle oil on Filter Replacement. PN: 72-60512 Pro-GUARD 7 (black w/ gold media).

Updated 2-3-05 06-80098