



P.O. Box 1719
 Corona, CA 92878
 Support: 951-493-7100
 www.aFeFilters.com

Intake Kit Installation Instructions: '02-'05 Chevrolet Trailblazer/ GMC Envoy/ Oldsmobile Bravada I6-4.2L

Kit Part #	51/54-10872	Tools Required:	Part List:	2 Nut M6x1
Make:	Chevrolet	5/16" nut driver	1 Air Filter (replacement # 24-40011)	6 Washer, Flat M6
Model:	Year Engine	Slotted screwdriver	Pro Dry S™ 21-40011	4 Washer, Wavy
Trailblazer	'02-'05 I6-4.2L	10mm socket or wrench	1 Intake Tube	4 Button Head Screws M6x1x12
Make:	GMC	Ratchet and extension	1 Intake Housing	
Model:	Year Engine		1 Housing Cover	Additional parts for "air injection" supply hose.
Envoy	'02-'05 I6-4.2L		1 Air Temp. Sensor Grommet	1 Elbow 1"
Make:	Oldsmobile		1 Coupler 3-1/2"Dx3"L	1 Grommet 1" ID
Model:	Year Engine		2 Clamps #056	1 Clamp #016
Bravada	'02-'04 I6-4.2L		4 Screw M6x1x25	



Step 1
 Complete kit. Please make sure you have all the components listed prior to beginning your installation.



Step 2
 Complete stock intake.

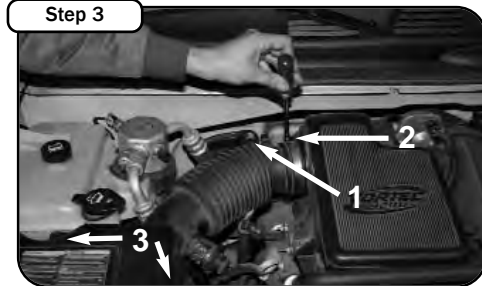

Step 3
 (1) Disconnect the MAF sensor. (2) Loosen the intake manifold clamp. (3) Remove the two screws holding the air box housing in place. *Models with "air injection" hose unplug from intake tube.



Step 4
 Remove the air box housing. (1) Remove the stock air filter.



Step 5
 Remove the air tube.



Step 6
 Slip the coupler over the intake manifold and secure with a clamp.



Step 7
 Insert the "air temp. sensor grommet" into the aFe intake tube



Step 8
 Insert the aFe air intake tube into the coupler on the intake manifold. Once in position secure the tube using a clamp.



Step 9
 Fit the aFe housing over the intake tube. Using 2 screws, washers and lock washers secure the housing in the engine compartment.



Step 10
 Next using the 2 longer screws, 2 washers each, wavy washer and bolts. Fasten the housing onto the intake tube.



Step 11
 Remove the air temp. sensor from the OEM intake tube.



Step 12
 Insert the air temp. sensor into the aFe intake tube. Re-connect the air temp. sensor plug.

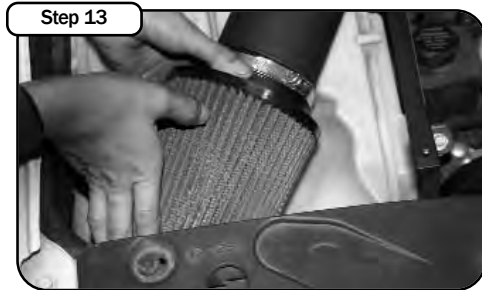

Step 13
 Install the new aFe air filter onto the intake tube and secure.



Step 14
 Position the housing cover and secure in position using 4 button head screws. Your installation is now complete. Make sure you tighten all clamps and check all electrical connections. Re-check periodically.

If your vehicle is equipped with an "air injection" supply hose. **Please refer to page 2 for further instructions.**

Note: Filter Cleaning and Re-oiling: When cleaning your aFe filter, be sure to use only aFe's "Restore Kit" (aFe P/N: 90-50001 blue oil aerosol, or aFe P/N: 90-50501 blue squeeze bottle oil or aFe P/N: 90-50000 gold oil aerosol, or aFe P/N: 90-50500 gold squeeze oil). Filter Replacement: Magnum FLOW PN: 24-40011 (black w/blue media). **Pro Dry S™** P/N: 21-40011 (black w/ white media) **Pro Dry S™** cleaning: see cleaning instruction sheet 06-00074



P.O. Box 1719
 Corona, CA 92878
 Support: 951-493-7100
 www.aFeFilters.com

Page 2 "Air Injection" Supply Hose Installation Instructions

Kit Part #	51/54-10872	Tools Required:	Part List:
Make:	Chevrolet	1/4" nut driver	1 Elbow 1"
Model:	Year Engine	1 3/8" Spade Bit	1 Rubber Grommet 1" ID
Trailblazer	'02-'05 I6-4.2L	Drill	1 Clamp #016
Make:	GMC	Wire Cutters	
Model:	Year Engine	Long nose pliers	
Envoy	'02-'05 I6-4.2L		
Make:	Oldsmobile		
Model:	Year Engine		
Bravada	'02-'04 I6-4.2L		



Step 1
 Complete kit. Please make sure you have all the components listed prior to beginning your installation.



Step 2
 Using wire cutters remove the factory metal clamp from the air injection hose.



Step 3
 Remove the vent tube connector from the air injection hose.

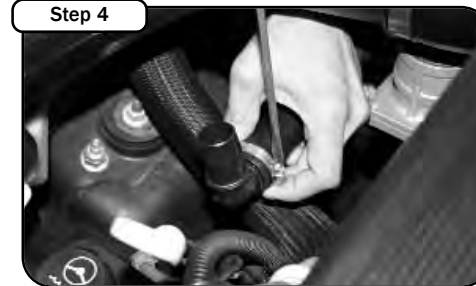

Step 4
 Using the #12 clamp and supplied vent elbow, secure onto the air injection hose.



Step 5
 Position the elbow so it sits inline under the intake tube. Mark the center of the location.

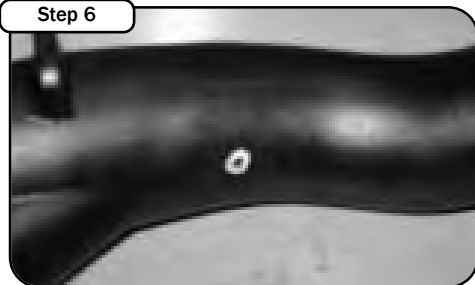

Step 6
 Now with the center marked, remove the aFe intake tube.

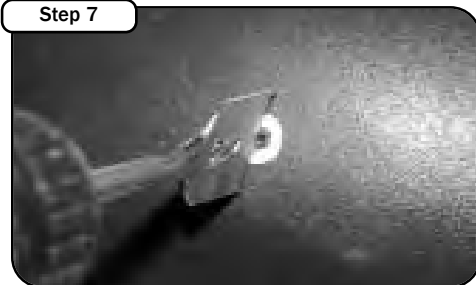

Step 7
 Using a 1 3/8" spade bit drill out a hole where you made your mark.



Step 8
 Remove the debris from the intake tube.



Step 9
 Insert the grommet so that its sits securely in the hole.



Step 10
 This is a sample photo of how the elbow should be inserted into the aFe intake tube.



Step 11
 Now that your hole is drilled re-install the aFe intake tube and insert the elbow. Your installation is now complete. Make sure you tighten all clamps and check all electrical connections. Re-check periodically.