



Intake Kit Installation Instructions: '01-'07 BMW M3 (E46) L6-3.2L

252 Granite St. Corona
CA 92879
Support: 951-493-7100
www.aFePower.com

Kit Part #	51/54-10461	Tools Required:	Part List:	1 Spacer, nylon
Make:	BMW	1/4" socket, nut-driver	1 Air Filter Pro DRY S 21-91031 or Pro 5R 24-91031	1 Nut, hex M6 x 1
Model	Year	Engine	1 Housing	2 M4 x .7 x 16
M3	'01-'07	L6-3.2L	1 Housing cover (aluminum)	
			4 M6 x 1 x 12mm button head	
			4 M6 x 1 x 10mm button head	
			1 Washer, flat #6	
			1 Billet adapter	



Complete kit with parts.

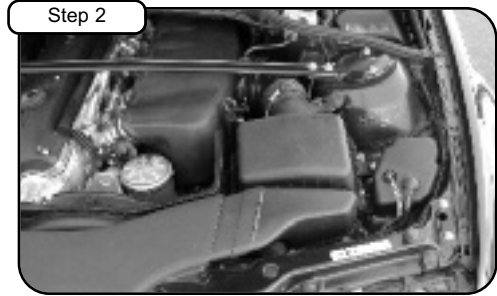

Complete stock intake.



Remove factory harness from Mass Air Flow sensor and place out of the way until re-assembly.



Remove front snorkel from ducting to stock airbox.



Using a standard screwdriver loosen the clamp securing intake track to factory airbox. Undo clamps securing top half of airbox and remove top half. Set aside for future removal of stock MAF sensor.



Remove plastic cover from headlight controller via locking tabs. Using a 10mm socket, remove the (2) bolts securing controller to allow for its movement and to release lower half of airbox.



Using a 10mm socket remove the remaining bolt holding the factory intake in place, remove the lower half of the intake. Set the bolt aside for re-installation of heat shield.

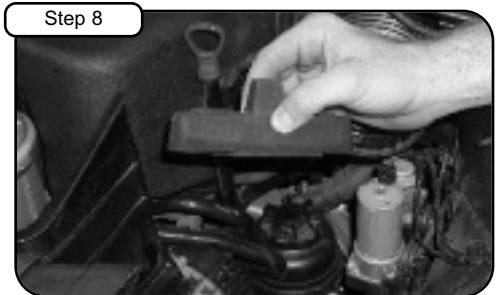

Remove rubber mount from tab beneath factory airbox.

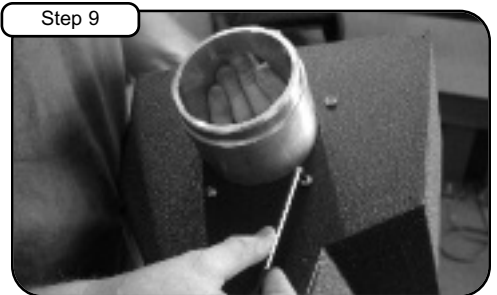

Using 4mm hex key, fasten aluminum adapter to heat shield using (4) provided M6 x 10mm button head screws.



Using 10mm socket replace headlight controller using original bolts and provided spacer on lower tab. Place heat shield into engine compartment, placing slot over the bolt that originally secured the rubber mount.

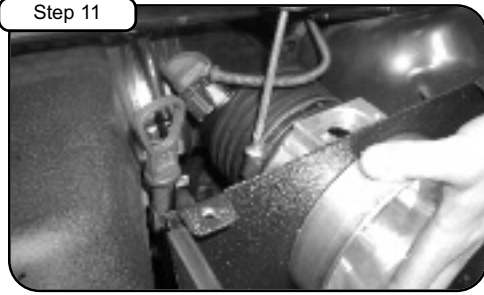

Using standard screwdriver fasten factory intake track to aluminum adapter. NOTE: it may be necessary to loosen and re-tighten the clamp securing the intake track to factory intake plenum to gain extra rotation.

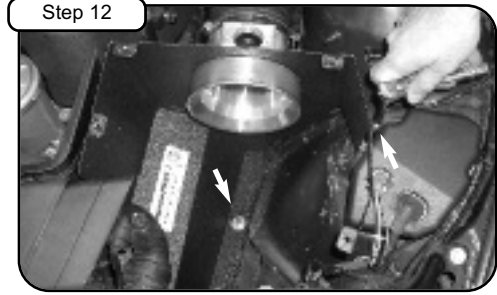

Using a 10mm socket and provided M6 nut and washer as well as original 10mm bolt, secure heat shield to engine compartment using now available mounting locations.

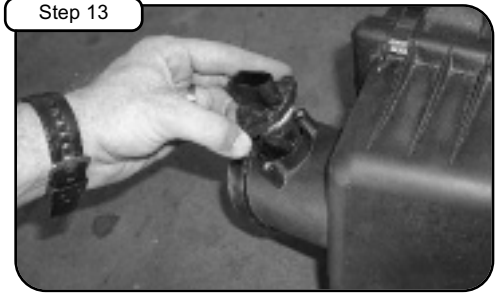

Using provided Torx bit, remove MAF sensor from factory airbox and re-install into aluminum adapter using (2) provided M4 screws. Re-connect factory harness to MAF sensor.

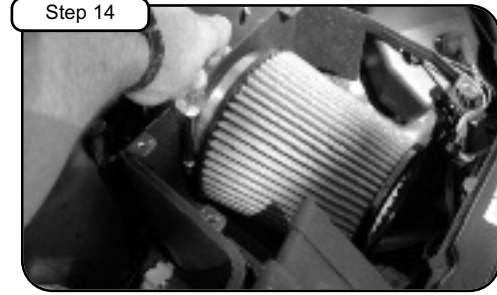

Using a 5/16" nut driver or flat blade screwdriver install pre-oiled aFe filter. Using a 4mm hex key install (4) M6 x 12mm button head screws. Make sure all hoses and clamps are tight and that all electrical components (if applicable) are secure. Check and retighten connections and filter after a few hours of operation.

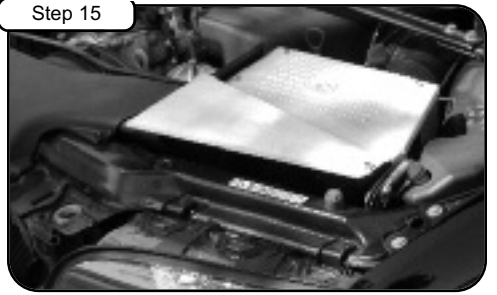

Place enclosed CARB EO sticker on a clean/smooth surface on or near the intake system. EO identification label is required in passing the smog check inspection. Your installation is now complete.

Note: Filter Cleaning and Re-oiling: When cleaning your aFe filter, be sure to use only aFe's "Restore Kit" (aFe P/N: 90-50001 blue oil aerosol, or aFe P/N: 90-50501 blue squeeze bottle oil). Filter Replacement: PN: 24-91031 (black w/blue media)