

Intake Kit Installation Instructions: 2004-2005 Ford F-150 5.4L V8



P.O. Box 1719
 Corona, CA 92878
 Support: 877-512-8111
 www.aFilters.com

Kit Part #	54-10512
Make:	Ford
Model:	F-150
Engine:	V-8 5.4L
Year:	2004-2006
Note: Please confirm Parts List and read all instructions steps before proceeding with actual installation.	

Tools Required	8mm socket 5/16" nut driver 10mm socket Flathead screwdriver Ratchet and extension T-20 Torx Bit
Part List:	1- Air filter p/n# 24-90008 1- Air filter Housing 1- Intake tube rotomolded 1- Intake tube support mount 1- Housing support tab 1- MAF sensor gasket 4- M6 Button head screws 5- M6 x 12 hex head screws 9- M6 washers



Step 1

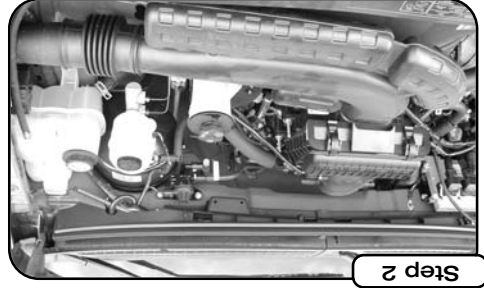

Step 2

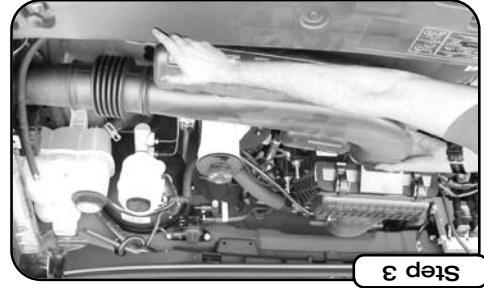

Step 3



Step 4

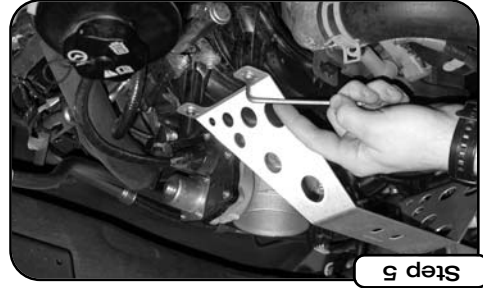

Step 5



Step 6

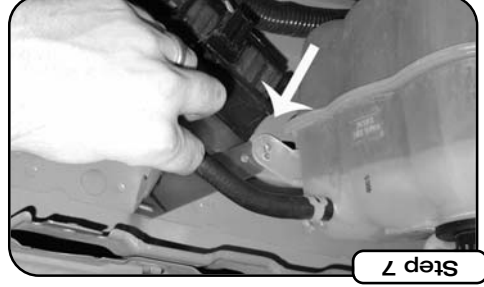

Step 7

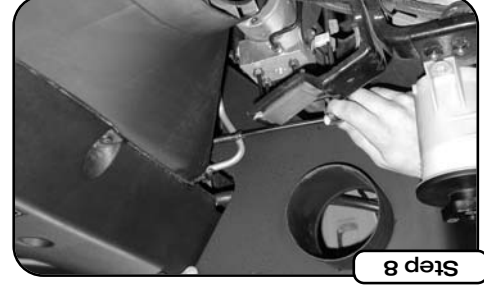

Step 8

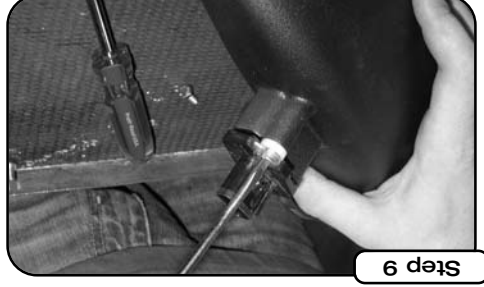

Step 9



Step 10



Step 11



Step 12

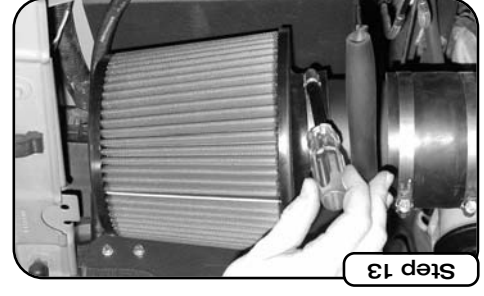

Step 13



Step 14



THROTTLE BODY

Line up the mounting holes on the intake duct and tighten assembly with the provided screws and washers.

Re-connect the MAF sensor and use provided 1/2" breather hose to connect the intake duct to the crankcase breather on the engine valve cover.

Install the pre-oiled filter in the housing and sides of the panel by starting at one corner and working your way around the edge of the housing.

Your installation is now complete. Check after a few hours of operation all hoses and clamps are tight and that all electrical components are secure. Close hood slowly to verify hood clearance.

Position coupler and clamps over throttle body (3.5" x 4.0") (clamps removed for clarification). The smaller (3.5") end of the coupler goes over the throttle body. The (4") end of the coupler goes around the intake tube.

Remove the 8mm bolt on the top left of the fan shroud. Sandwich the housing support bracket between the coolant reservoir tab and the fenderwell. Reinstall the 8mm bolt.

Remove the 8mm bolt on the side of the coolant reservoir. Position the housing into the engine bay. Line up the mounting holes with the rear support bracket and the radiator shroud and tighten all the nuts and bolts using the supplied hardware.

Transfer the MAF sensor from the factory airbox to the new intake tube. Make sure you use the provided spacer and gasket.

Place urethane coupler on the throttle body and the housing. Position intake duct into engine bay and tighten down the clamps.

(see diagram below for correct coupler position) Position coupler and clamps over throttle body (3.5" x 4.0") (clamps removed for clarification). The smaller (3.5") end of the coupler goes over the throttle body. The (4") end of the coupler goes around the intake tube.