



P.O. Box 1719
Corona, CA 92878
Support: 877-512-8111
www.aFeFilters.com

Intake Kit Installation Instructions: '03-'05 Dodge Neon SRT-4 L4-2.4L Turbo Stage-2 Air Intake

Kit Part #	51/54-10582	Tools Required	Part List:	2 #044 clamps
Make	Dodge	5/16 nutdriver	1 Air filter (replacement # 24-91033)	1 Trim seal, 11" long
Model	Year	10mm socket	1 Housing	1 Trim seal, 15" long
Neon SRT-4	'03-'05	13mm socket	1 Tube mounting bracket	1 M6 nut
	Engine	8mm socket	1 Solenoid Mount Bracket	
	L4-2.4L Turbo	Ratchet	1 Intake tube	
			3 M6x1x16 hex head screw	
			3 M6 flat washer	
			1 M6 lock washer	
			1 Coupler 2.5x2	
<i>Note: Please confirm Parts List and read all instruction steps before proceeding with actual installation.</i>				



Complete Stage 2 shown.



Complete stock airbox.



Loosen and remove solenoid mount, also loosen and remove stock airbox lid.



Loosen and remove 4 screws that hold stock intake tube to airbox.

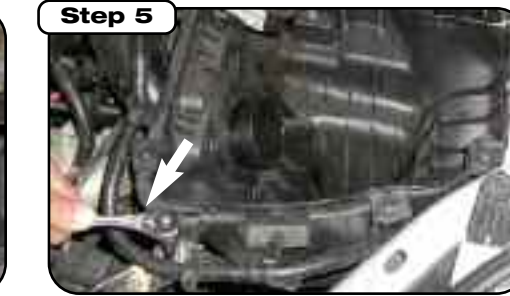

Loosen and remove stock airbox from vehicle.



Loosen clamp on turbo inlet side of tube and remove stock intake tube from vehicle. Disconnect vent hoses from intake tube. Save as these will be reused.



From the stock airbox, remove 1 washer and 1 rubber grommet and insert into new housing provided taking note of orientation of the washer.



Before installing housing, install trim seal using 15" trim seal on hole cut out and 11" trim seal on panel edge.

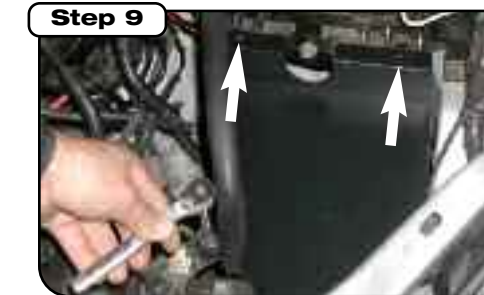

Remove two screws as shown and reinstall after placing housing into the vehicle.



Remove and reinstall lower screw once placing solenoid bracket into place. Once bracket is secure, fasten existing solenoid bracket to upper portion of new bracket using supplied screws.



Install coupler onto the turbo side of intake tube, install tube into the vehicle and slide coupler onto turbo flange until coupler bottoms out on the lip of turbo inlet.



Remove plastic engine cover. Engine cover is held on by 2 grommets. Pull up cover evenly from both sides, making sure not to pull dramatically from one side so that engine cover will break. Using the aluminum bracket provided, place M6 washer onto stud, place bracket into place and secure tight with washer and nut provided. Align and install M6 bolt and lock washer to fasten bracket to the tube.



Remove air temperature sensor from stock intake housing. See step 14 for new air temperature sensor location.



Install filter to intake tube and place temperature sensor into hole provided on the filter.



Complete kit installed. Retighten all connections after first hour of operation. Place the included CARB EO Sticker on or near the intake system on a smooth, clean surface. E.O. identification label is required in passing the Smog Check Inspection.

Note: Filter Cleaning and Re-oiling: When cleaning your aFe filter, be sure to use only aFe's "Restore Kit" (aFe P/N: 90-50001 blue oil aerosol, or aFe P/N: 90-50501 blue squeeze bottle oil). Filter Replacement: PN: 24-91033.