



# Intake Kit Installation Instructions: '02-'05 Subaru Impreza WRX H4-2.0L/ WRX STI H4-2.5L

P.O. Box 1719  
Corona, CA 92878  
Support: 951-493-7100  
www.aFeilters.com

<b>Kit Part #</b>	54-10802	<b>Tools Required:</b>	<b>Part List:</b>	8 M6 Button Head Screw
<b>Make:</b>	Subaru	5/16" Nut Driver	1 Air Filter (P/N: #24-55505)	1 Clamp #064
<b>Model</b>	<b>Year</b>	<b>Engine</b>	1 Housing	3 Clamp #044
Impreza WRX	'02-'05	H4-2.0L	1 Housing Cover	
Impreza WRX STI	'04-'05	H4-2.5L	1 Intake Tube (Red)	
			1 Air Filter Injection Adaptor	
			1 Reducing Coupler 4"x 2-3/4"	
			1 Straight Coupler 2-3/4"x 1-3/4"	
			5 M6 Wavy Washers	



**Step 1**  
Complete intake kit. Please verify all components are present prior to beginning installation.



**Step 2**  
Complete stock intake system.

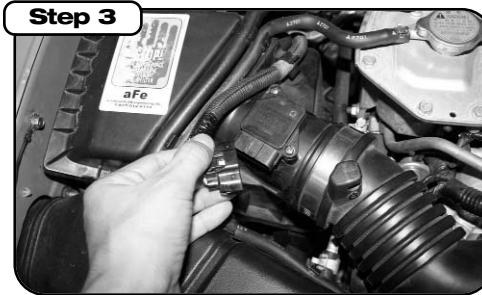

**Step 3**  
Unplug the MAF sensor.

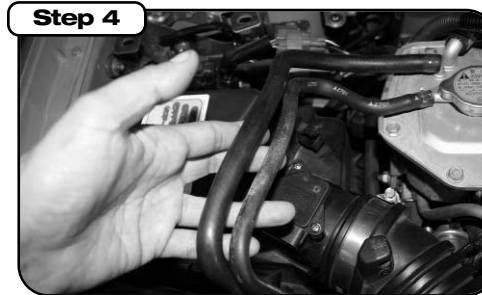

**Step 4**  
Pull-up the two tubes located on the upper air box.



**Step 5**  
Loosen the clamp located on the throttle body intake tube.



**Step 6**  
Lift up and pull out the upper portion of the airbox and intake tube. Remove the stock air filter.



**Step 7**  
Using your 12mm socket and ratchet extension, un-bolt the lower air box housing and remove.

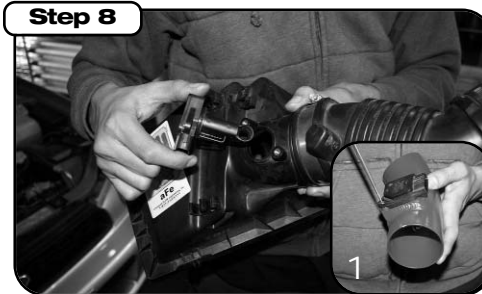

**Step 8**  
Un-bolt the MAF sensor from the OEM upper air box housing. (1) Install the MAF sensor on the aFe intake tube.

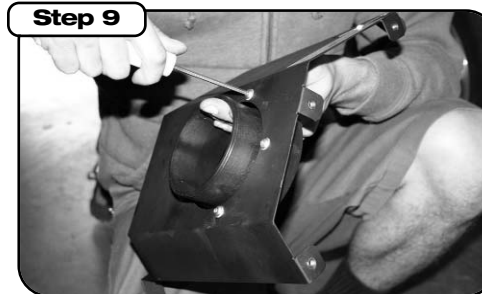

**Step 9**  
Using 5-M6 button head screws and 5-M6 wavy washers fasten the adaptor on the housing.

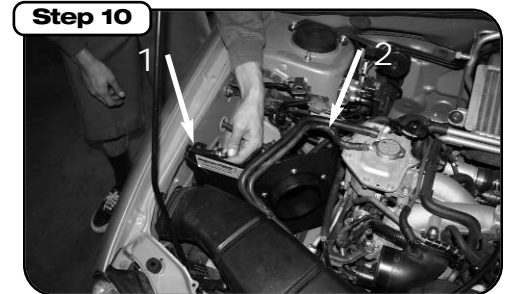

**Step 10**  
(1) Fasten the aFe housing using the existing bolt on the inside fender (with the black grounding wire). (2) Bolt onto the chassis using the original bolt. Do not tighten/leave loose for now.



**Step 11**  
With the housing slightly loose (for play) slip on the reducing coupler on the adaptor. \*You will need this "play" to insert the aFe intake tube (tight fit).

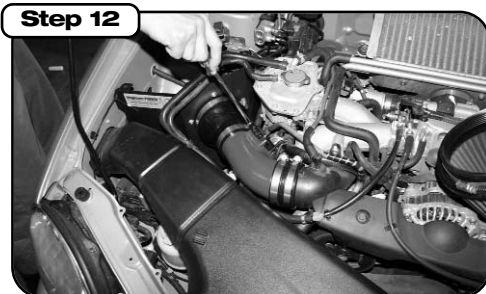

**Step 12**  
Place the straight coupler & clamps on the aFe intake tube. Slide the coupler completely on the tube. Insert the tube into position, slide the coupler over and secure the clamps & housing. Plug in the MAF sensor.

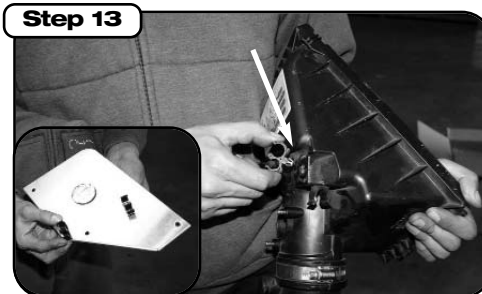

**Step 13**  
Using the pliers to remove the two hose clamps on the OEM upper housing. Clip them onto the aFe housing cover.



**Step 14**  
Insert and fasten the aFe air filter. (1) Secure the housing cover with 3-M6 button head screws. Clamp the two hoses on the cover.



**Step 15**  
Place enclosed CARB EO sticker on a clean/smooth surface on or near the intake system. EO identification label is required in passing the Smog Check inspection. Your installation is now complete. Make sure to tighten all clamps and check all electrical connections. Re-check periodically.

**Note:** Filter Cleaning and Re-oiling: When cleaning your aFe filter, be sure to use only aFe's "Restore Kit" (aFe P/N: 90-50001 blue oil aerosol, or aFe P/N: 90-50501 blue squeeze bottle oil).  
Filter Replacement: Magnum FLOW PN: #24-55505 (black w/blue media).