

# advanced FLOW engineering

## Instruction Manual P/N: 54-82362

Make: **BMW** Model: **328i (F30)** Year: **12-15** Engine: **L4-2.0L (Turbo) N26**  
(N26 engine is the SULEV (Super Ultra Low Emissions Vehicle) of the N20 Engine)



- Please read the entire instruction manual before proceeding.
- Ensure all components listed are present.
- If you are missing any of the components, call customer support at 951-493-7100.
- Ensure you have all necessary tools before proceeding.
- Do not attempt to work on your vehicle when the engine is hot.
- Disconnect the negative battery terminal before proceeding.
- Retain factory parts for future use.

Label	Qty.	Description	Part Number
A	1	Air Filter (Pro 5R)	24-91056
B	1	Tube	05-82362B1
C	1	Housing	05-82212B2
D	1	Clamp, 096	03-50003
E	2	Screw, Chs Hd: M4	03-50030
F	1	Torx Bit	03-50066
G	2	Ties, Cable Nylon	05-60167

Installation will require the following tools:  
Phillips screw driver & 8mm nut driver.

Note: Legal in California for use on race vehicles only. The use of this device on vehicles used on public streets or highways is strictly prohibited in California and others states that have adopted California emission regulations.

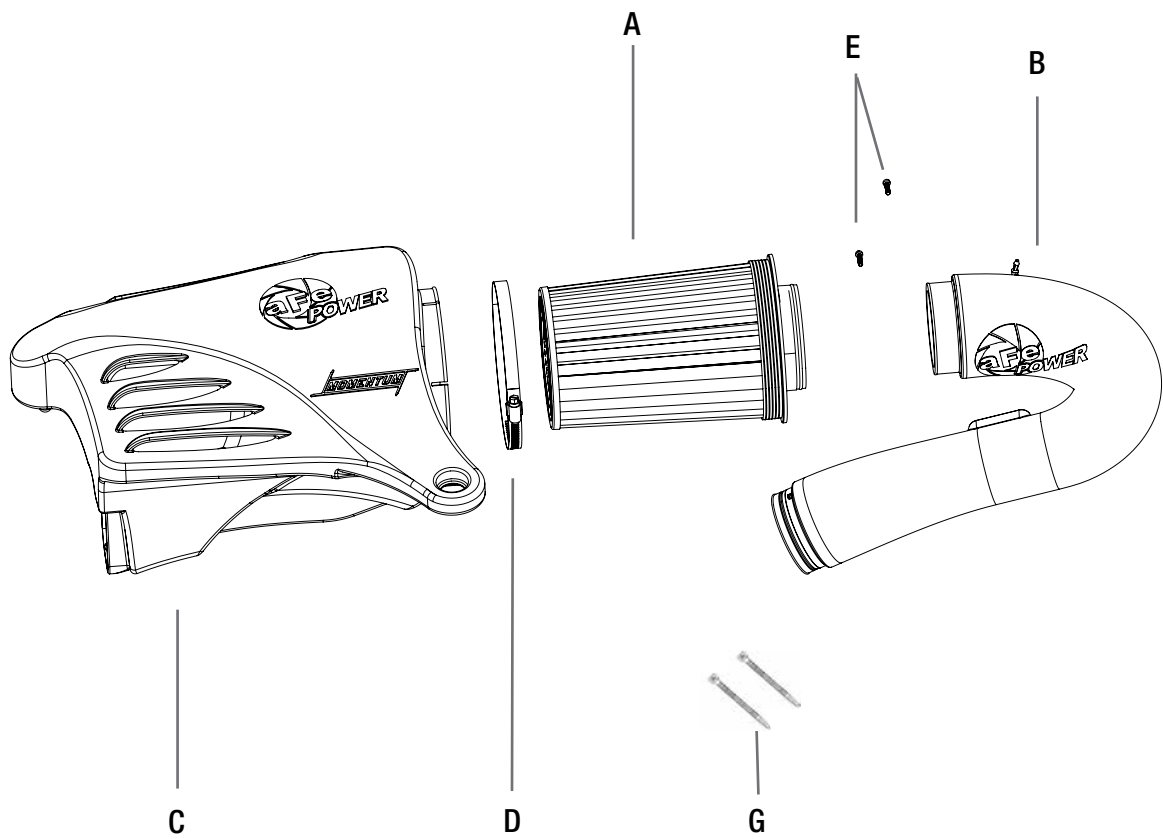



**Refer to Figure A for step 1-3**

Step 1: Disconnect MAF sensor harness (1).

Step 2: Loosen the clamp between the OE airbox and tube (2) and disconnect hood cable.

Step 3: Pull the complete OE housing out of the vehicle (3).

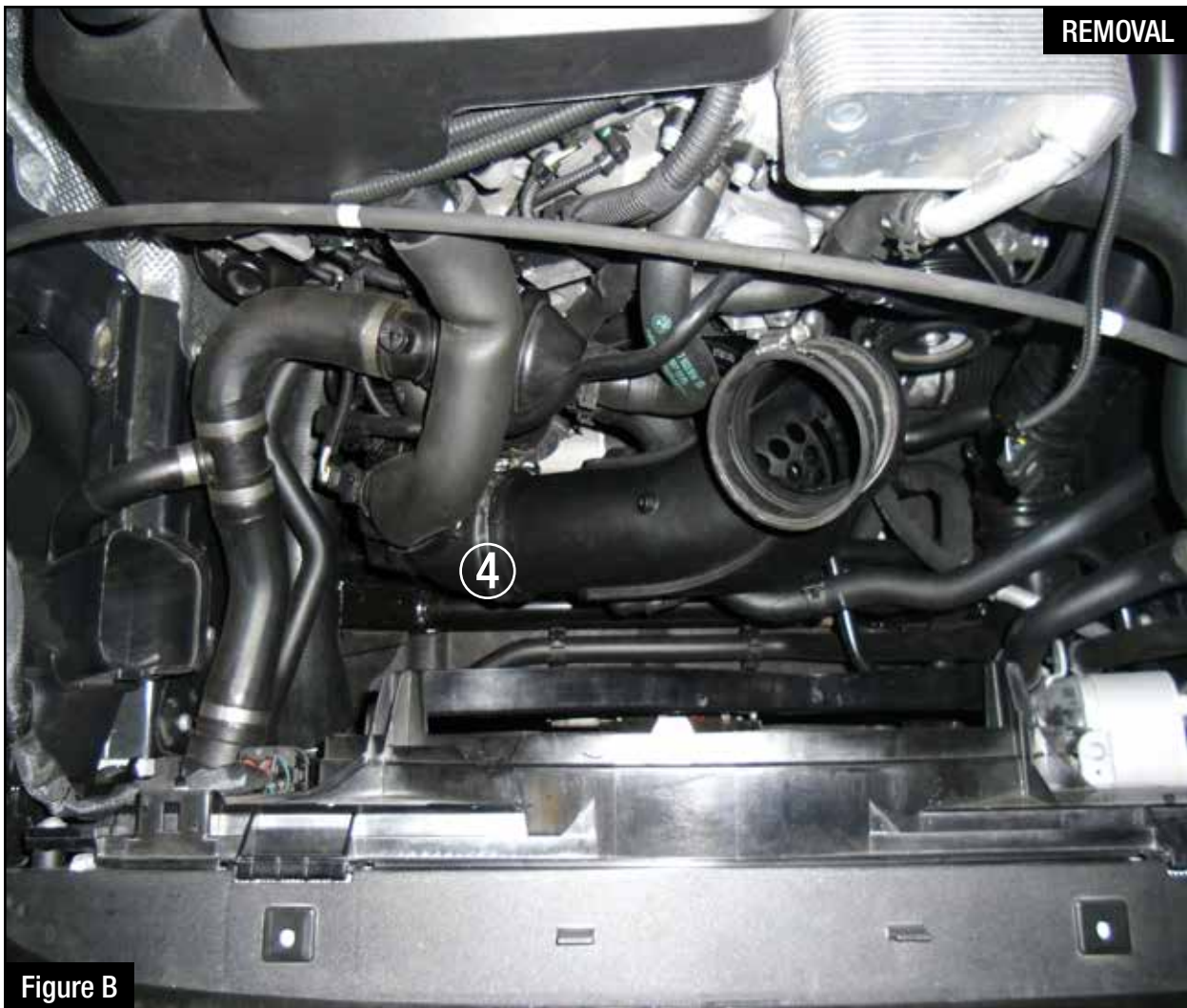

Figure B

**Refer to Figure B for steps 4-5**

Step 4: Loosen the clamp on the OE tube ④.

Step 5: Pull the OE tube out of the vehicle.

**Figure C****Refer to Figure C for steps 6-7**

Step 6: Remove MAF sensor from the OE housing with the furnished T20 torx bit.

Step 7: Install MAF sensor into your aFe intake tube using the furnished M4 screws (5).



Figure E



INSTALL



Figure D

**Refer to Figure D for steps 8-10**

Step 8: Install aFe tube into the vehicle using the OE clamp removed in step 4 (6).

Step 9: Re-direct wiring harness to the new MAF sensor location and secure the harness away from the serpentine belt using the supplied cable ties as shown in figure E.

Step 10: Re-connect wiring harness to the MAF sensor (7) and re-connect the small vacuum line to fitting.

**Figure F****Refer to Figure F for steps 11-12**

Step 11: Install aFe filter onto the aFe airbox using the furnished clamp (8).

Step 12: Take OE grommet off OE airbox and install it on aFe airbox (9).



**Figure G****Refer to Figure G for steps 13-16**

Step 13: Install the aFe airbox assembly into vehicle.

Step 14: Connect the air filter to the intake tube using the furnished clamp (10).

Step 15: Secure the hood cable on housing (11).

Step 16: Verify all clamps are secure and re-check periodically. Your Installation is now complete.



Pro DRY S Air Filter



P/N: 21-91056

Pro 5R Air Filter



P/N: 24-91056

Pro DRY S Restore Kit



P/N: 90-59999

Blue Squeeze Restore Kit



P/N: 90-50501

Sprint Booster



P/N: 77-16302

Dynamic Air Scoop



P/N: 54-12218-C

Throttle Body Spacer



P/N: 46-31009

Tuner



P/N: 77-46303

To purchase any of the items above, view airflow charts, dyno graphs, photos, and video; please go to [aFepower.com](http://aFepower.com).

# Warranty

## General Terms:

- aFe warrants their products to be free from manufacturer's defects due to workmanship and material.
- This warranty applies only to the original purchaser of the product and is non-transferrable.
- Proof of purchase of the aFe product is required for all warranty claims.
- Warranty is valid provided aFe instructions for installation and/or cleaning were properly followed.
- Proper maintenance with regular inspections of product is required to insure warranty coverage.
- Damage due to improper installation, abuse, unauthorized repair or alteration is not warranted.
- Incidental or consequential damages or cost, including installation and removal of part, incurred due to failure of aFe product is not covered under this warranty.
- All warranty is limited to the repair and/or replacement of the aFe part. To request Return Goods Authorization ("RGA"), email [RGA@afepower.com](mailto:RGA@afepower.com) or call (951)493-7100. Upon receipt of the RGA, you must return the product to the address provided in the RGA, freight prepaid and accompanied with a dated proof of purchase and the RGA. Upon receipt of the defective product and upon verification of proof of purchase, aFe will either repair or replace the defective product within a reasonable time, not to exceed thirty days.

Product Category	P/N Prefix	Warranty duration
Direct OE Replacement Filters	10, 11, 30, 31, 71, 73	Life of the vehicle
Racing Filters	18	1 year
Universal	21, 24, 72,TF	2 years
Air Intake Systems	50, 51, 54, 55, 75,TR,TA,TL	2 years
Exhaust Systems	49	2 years
Intercoolers & Intercooler Tubes	46-2	2 years
Intake Manifolds	46-1	2 years
Differential Cover	46-7	Life of the vehicle
Exhaust Manifolds	46	2 years
Throttle Body Spacers	46-3	2 years
Turbochargers	46-6	2 years*
Fluid Filters	44	90 days
Pre-Filters	28	2 years
Heavy Duty OE Replacement	70	2 years
PowerSports OE Replacement	81, 87	2 years
PowerSports Intake Systems	85	2 years

No other warranty expressed or implied applies nor is any person or advanced FLOW engineering authorized to assume any other warranty. Some States do not allow the exclusion or limitation of incidental or consequential damages or do not allow limitations on how long an implied warranty lasts, so the above limitations or exclusions may not apply to you. This warranty gives you specific legal rights, and you may also have other rights which vary from State to State.

\*See turbocharger warranty for more info

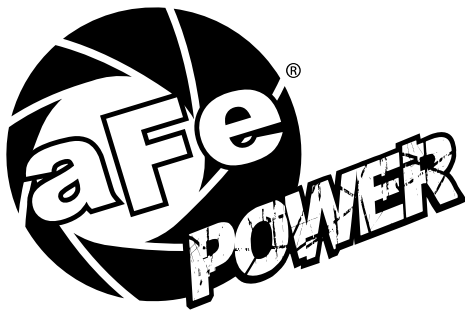

**advanced FLOW engineering, inc.**  
252 Granite Street Corona, CA 92879  
TEL: 951.493.7100 • TECH: 951.493.7100 x23  
E-Mail: [Tech@aFepower.com](mailto:Tech@aFepower.com)