

INSTALLATION GUIDE

AMP RESEARCH Power Step

MADE IN USA

APPLICATION	MODEL YR	PART #
Dodge Ram Quad Cab 1500	2009 - up	75143-01A
Dodge Ram Crew Cab 1500	2009 - up	75138-01A
Dodge Ram Crew Cab 2500/3500	2010 - up	75138-01A
Dodge Ram Mega Cab 2500/3500	2010 - up	75138-01A

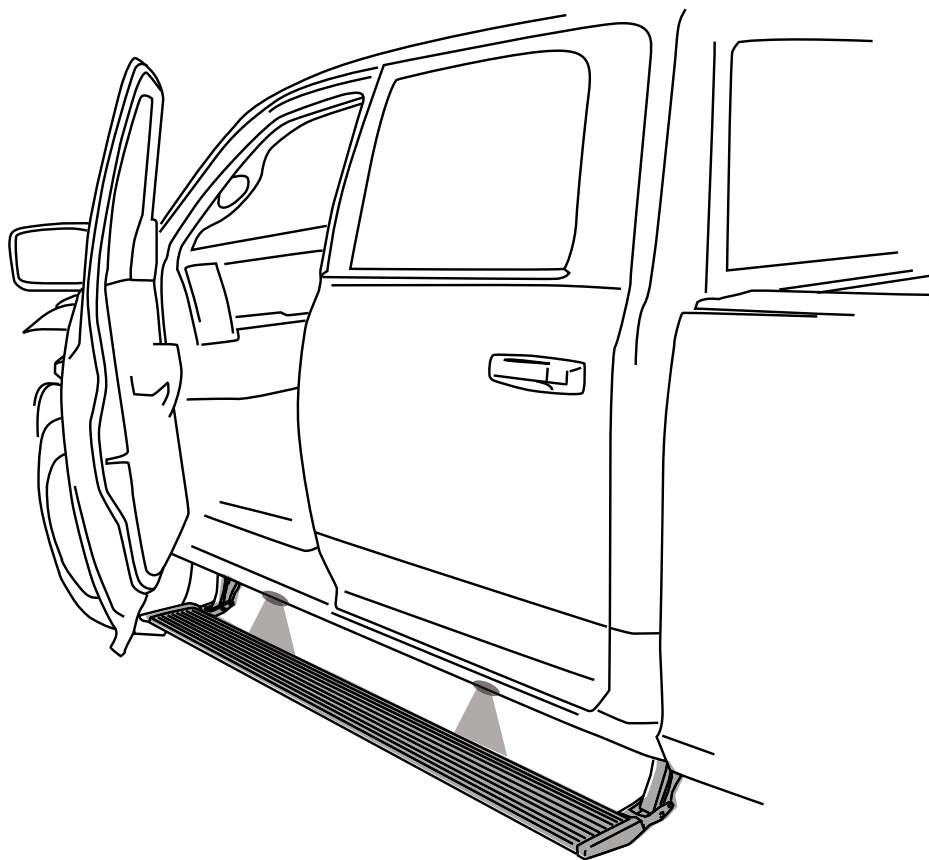

INSTALLATION TIME

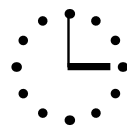

3:00 hrs

SKILL LEVEL



4= Experienced

TOOLS REQUIRED

- Safety goggles
- Measuring tape
- 13mm wrench
- 19mm wrench
- 13mm socket
- 10mm socket
- Ratchet wrench and extension
- Wire stripper / cutter
- 3/16" hex key (allen wrench)
- 4mm hex key (allen wrench)
- Electrical tape

AMP RESEARCH TECH SUPPORT 1-888-983-2204 (Press 2) Monday - Friday, 6:00 AM - 5:00 PM PST

Designed and manufactured by AMP Research®. Patent Number 6,830,257; 6,641,158; 6,834,875; 6,938,909; 6,942,233; 7,007,961; 7,055,839; 7,163,221; 7,367,574; 7,380,807; 7,398,985; 7,413,204; 7,487,986; 7,566,064; 7,584,975; CA 2,463,717. Other US and Worldwide patents pending.
 Made in USA © 2010 AMP Research 5-year limited warranty. Professional installation is recommended.

INSTALLATION GUIDE

Attaching motor to linkage assembly

The motors must be attached to the linkage assemblies before continuing the installation process.

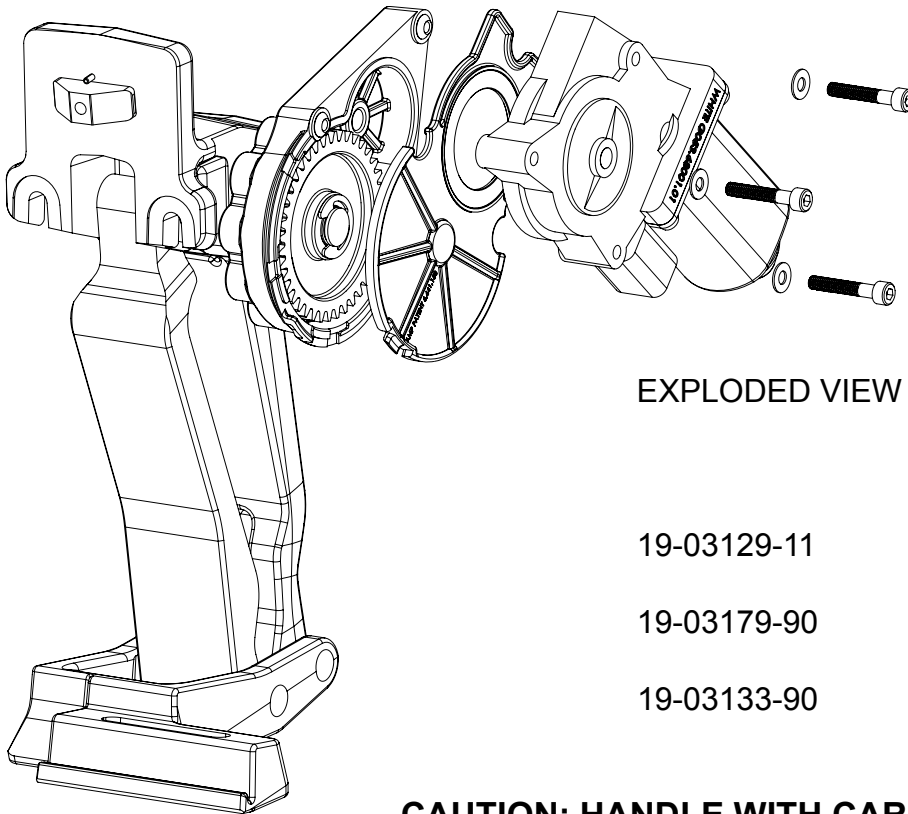

EXPLODED VIEW

19-03129-11	Motor
19-03179-90	Socket cap screw
19-03133-90	Washer

CAUTION: HANDLE WITH CARE.

To ensure our customers receive all components with full integrity, we pack the motors separate from their linkage assemblies. This requires that the installer position and fasten the motor before continuing with the install. Please follow the instructions below and handle the assembly carefully.

CAUTION: Dropping the assembly or any excessive impact MAY cause damage to the motor.

Instructions:

1. Position the gear cover in place as shown if not already in place.
2. Make sure the linkage is partially retracted before positioning motor, as shown here.
3. Seat motor into position on the three mounting bosses. This may require an adjustment of the gear by moving the swing arms.
4. After seating into place, fasten the motor with the three motor mount screws with 4mm Hex Wrench. Tighten screws to 80 in-lbs (9N-m). Do not over torque.

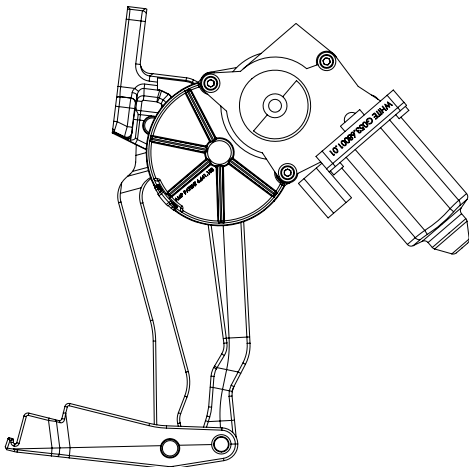

COMPONENT/PARTS IDENTIFICATION

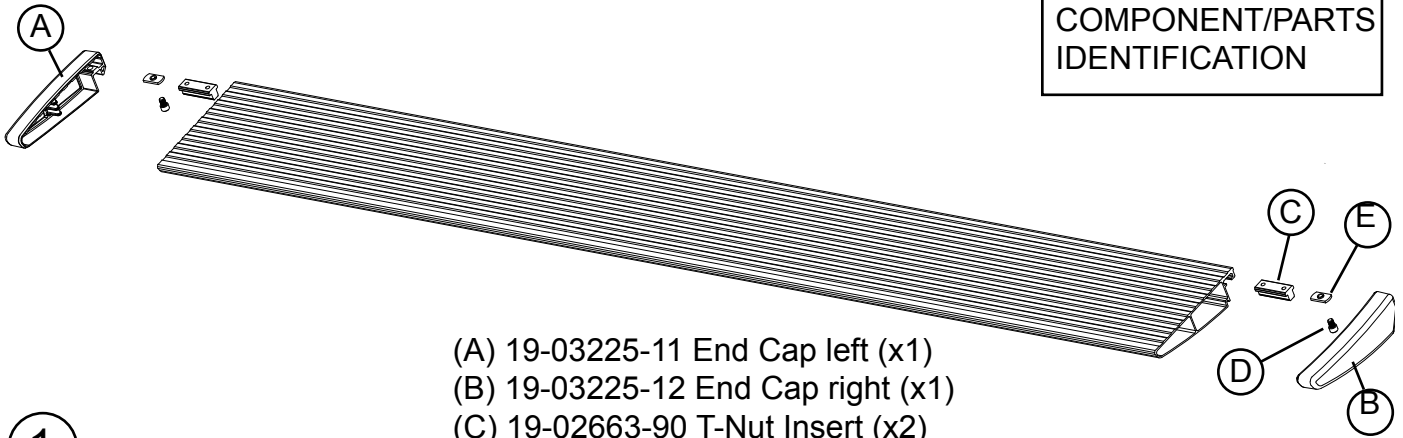

- (A) 19-03225-11 End Cap left (x1)
- (B) 19-03225-12 End Cap right (x1)
- (C) 19-02663-90 T-Nut Insert (x2)
- (D) 19-03236-90 Socket Cap Screw (x2)
- (E) 19-03237-90 Nut Plate (x2)

1 x2
 20-03314-XX
 Running board assembly

Driver Side Linkages

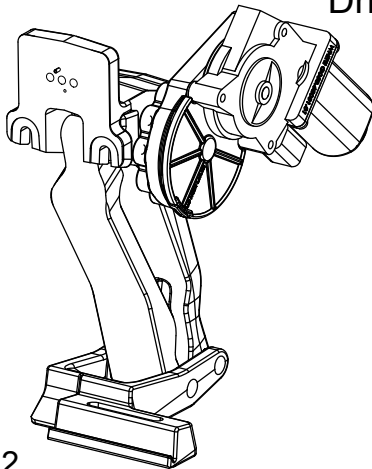

2a
 10-03656-12
 Motor Linkage Assembly - Driver Side

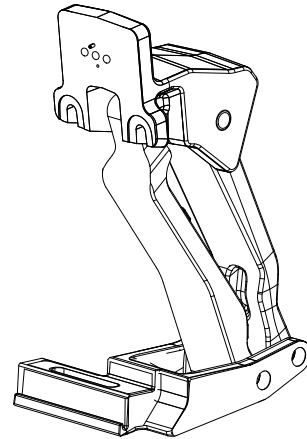

3a
 10-03662-12
 Idler Linkage Assembly - Driver Side

Passenger Side Linkages

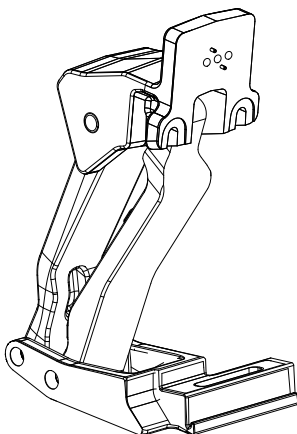

3b
 10-03662-11
 Idler Linkage Assembly - Passenger Side

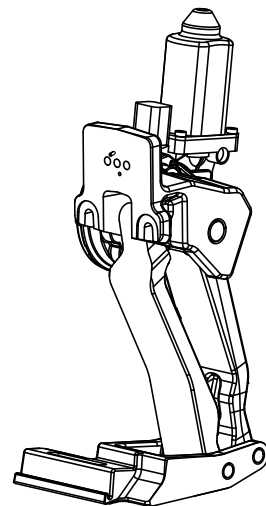

2b
 10-03656-11
 Motor Linkage Assembly - Passenger Side

PARTS LIST AND HARDWARE IDENTIFICATION

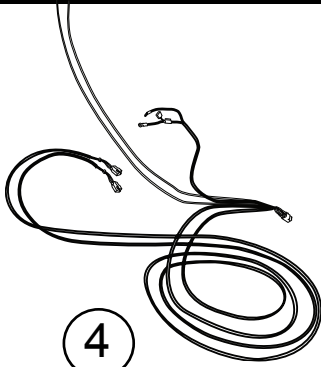

4
19-03695-90
Wire Harness

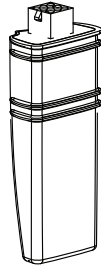

5
19-03297-93
Type-A
Controller

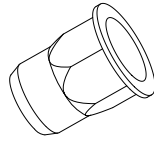

6 x8
19-03696-90
Rivet Nut

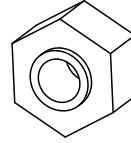

7
19-03205-90
Rivet Nut Tool

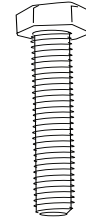

8 x10
19-03326-90
M8 Hex bolt

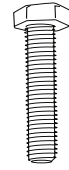

9 x4
19-03732-90
M6x30 Hex Bolt

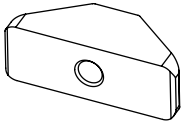

10 x4
19-03730-90
Mounting Insert



11 x8
16-03014-90
Washer (SS)

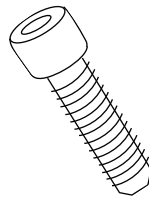

12 x8
19-02802-90
Socket Cap
Screw

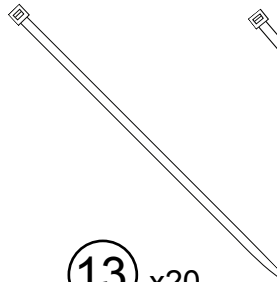

13 x20
19-02805-90
Cable Tie (7")

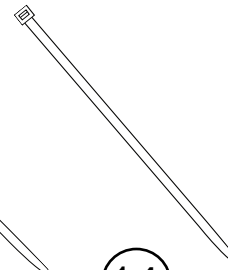

14 x2
19-03339-90
Cable Tie (11")

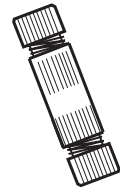

15 x4
19-03354-90
Posi-Tap™
Connector

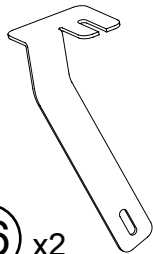

16 x2
16-03733-90
Support Bracket
(not for Mega Cab)

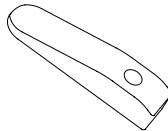

17 x2
19-02777-90
Bracket Insert
(not for Mega Cab)



18 x2
19-03037-90
M8 Flange Bolt
(not for Mega Cab)

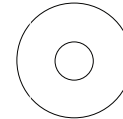

19 x2
19-02389-90
Large Washer
(not for Mega Cab)

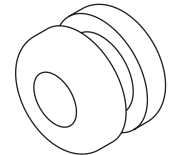

20 x4
19-02640-90
Grommet

FOR QUAD CAB ONLY. Items Not included in Crew Cab kit.

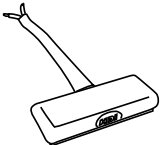

21 x4
80-03302-90
LED Lamp



22 x8
19-02989-90
Butt Connector

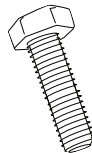

23
19-02849-90
Short Hex Bolt

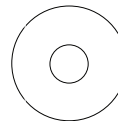

24
19-02389-90
Large Washer

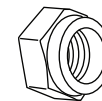

25
10-00115-60
Nylock Nut

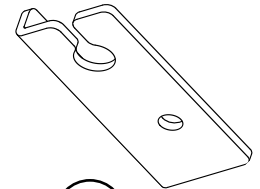

26
16-03701-90
Bracket

NOTE: 1500 Quad Cab installations require additional steps and come with the required additional hardware. (These parts will not be available in Crew Cab kits.) Please read and carefully follow the instructions in Step 1 for your vehicle model.

1500 QUAD CAB

Follow Steps 2-5 to relocate brake cable and then proceed with the Power Step installation.

1500 CREW CAB

& ALL 2500/3500 MODELS

Skip to Step 6 and proceed with the Power Step installation. Relocation of the brake cable is not necessary on Crew Cabs.

1a

While holding brake cable adjustment nut with wrench (located on driverside along frame, towards the rear), loosen brake cable to allow for slack. Mark position of nut before loosening.

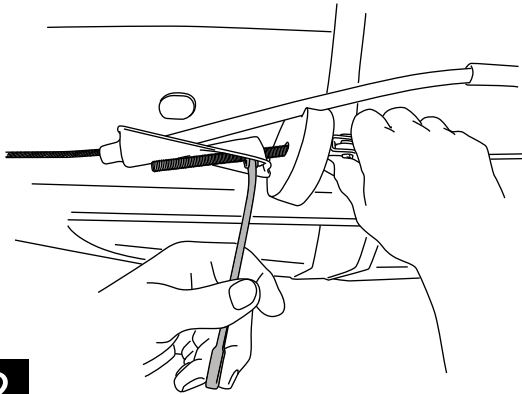

2



1b

After gaining enough slack, detach brake cable as shown below. This detachment point is located just to the rear of the adjustment nut.

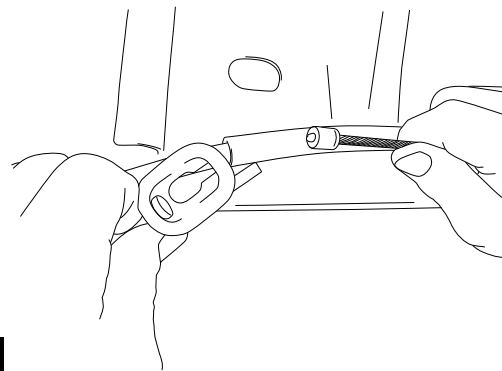

3

Remove brake cable guide from frame by depressing locking tabs and sliding guide out through hole. Unthread brake cable from frame mount.

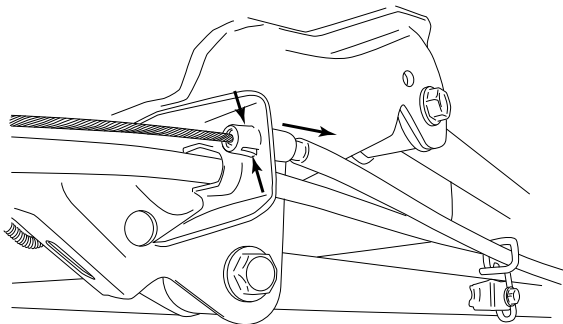

4

Attach brake cable guide to supplied Brake Cable Bracket (23) and mount bracket with supplied hardware. Reattach brake cable and readjust brake cable adjustment nut to original position.

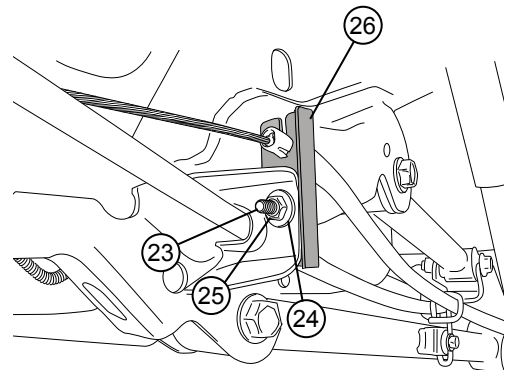

5

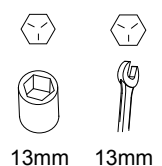

HARDWARE MOUNTING OVERVIEW (passenger side shown)

Locate forward most and rearward most mounting provisions on inner sill of truck. Remove tape from sill drain hole at both mounting points.

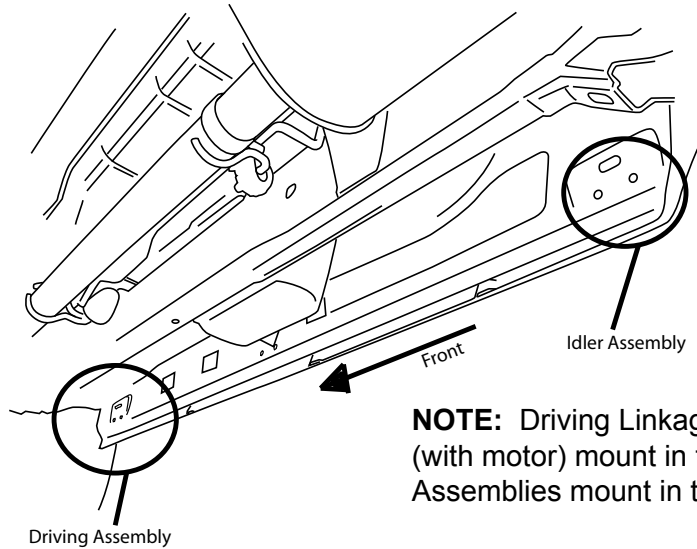

NOTE: Driving Linkage Assemblies (with motor) mount in the front; Idler Assemblies mount in the rear.

6

Assemble Hex Bolt, Rivet Tool, and Rivet Nut together as shown and place into hex cutouts in sill.

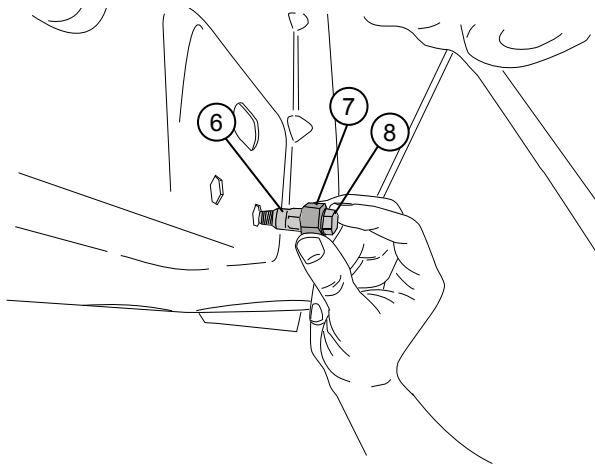

With Rivet Nut Tool held in place with 19mm wrench, tighten Hex Bolt until Rivet Nut deforms and secures itself to the sheet metal (15 ft-Lbs.). Remove Hex Bolt and Rivet Nut Tool. Repeat for each of the four mentioned mounting locations.

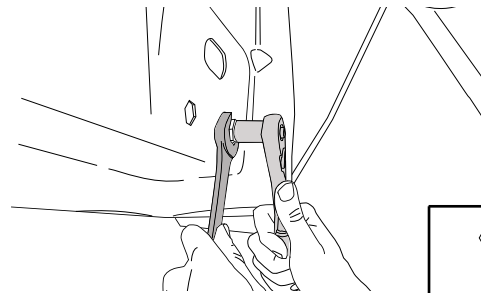

NOTE: Hold Rivet tool with wrench while loosening bolt.

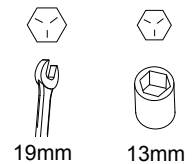

7

Start M8 Hex Bolts and Washers into installed Rivet Nuts, leaving about 1/2 inch of thread. Make sure washers remain flush to bolt head.

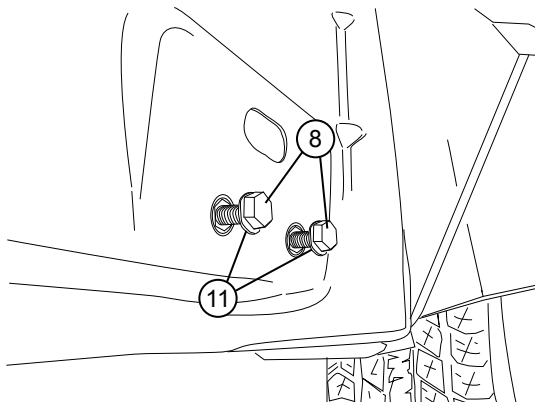

8

With linkage assembly in hand, insert Hex Bolt and rotate as shown to orient Mounting Insert correctly. Make sure Insert remains in this orientation during next step.

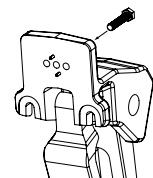
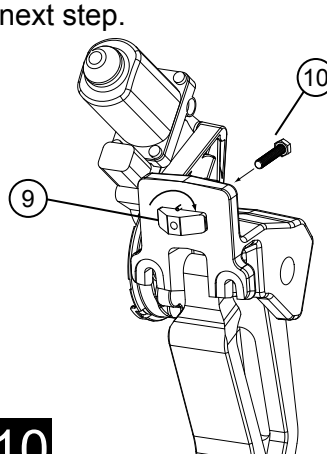

Bolt Location: Position in center hole except for Idler Linkage on Quad Cabs... for these position bolt in rear most hole. Remove upper pin on Quad Cab and remove lower pin on all others.

9

10

Linkage Installation. With Linkage tilted back as shown and Mounting Insert still oriented correctly, hook two mounting slots of Linkage onto the pre-mounted Hex Bolts.

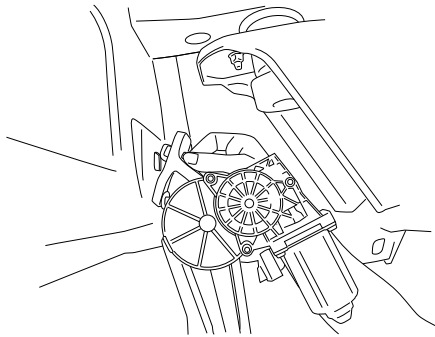

11 NOTE: Linkage needs to be partially retracted to install.

Tilt Linkage forward, dropping Mounting Insert into sheetmetal slot, and tighten M6 Hex Bolt to 6 ft-lbs. Do not allow bolt to rotate counter-clockwise, as this may disengage Mounting Insert. Then tighten lower Hex Bolts to 16 ft-lbs with 13mm wrench.

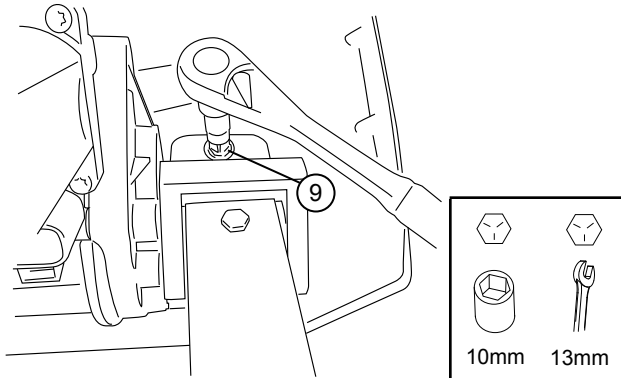

12

The jogs in the lower part of the linkages point toward one another, as shown, Drive (motor) Linkage in the Front and Idler Linkage in the Rear. Note: Linkage position described in parts list on page 3.

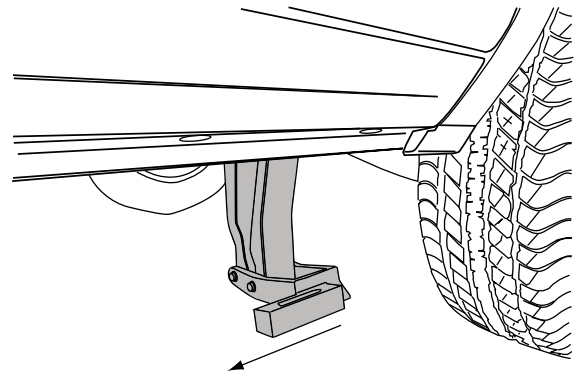
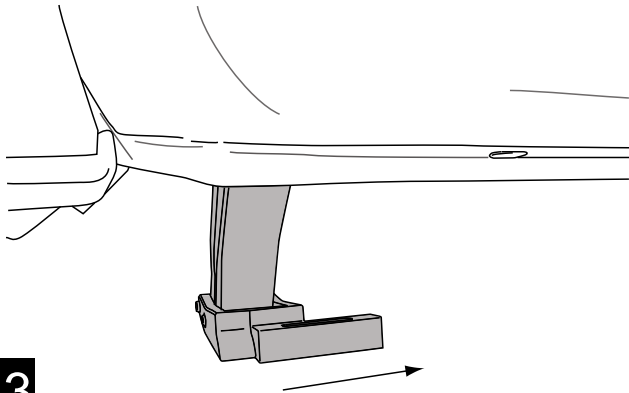

13

Slide mounting T-Nut of board into position and attach to linkages. The end of board/end cap will align flush with Rear Linkage.

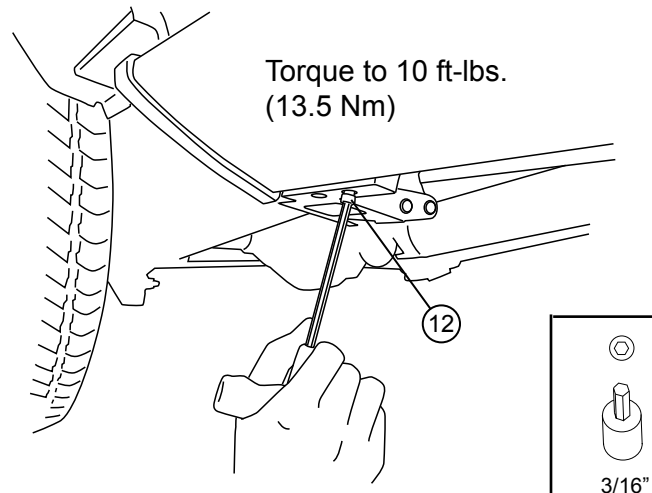
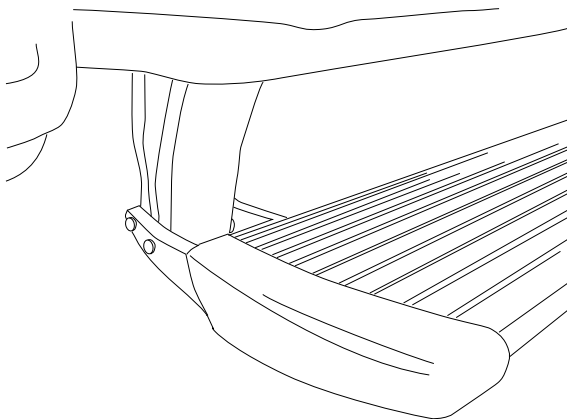

14

NOTE: Skip steps 15-19 on Mega Cab models. Mega Cab models do not take Support Bracket.

Rear Support. Preassembly Bracket Insert with Hex Bolt and Washer and insert into body support member above Idler Linkage.

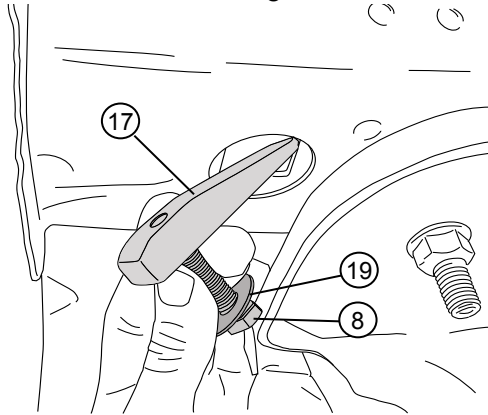

15

SEE MEGA CAB NOTE ABOVE

Position Bracket Insert assembly with the long end of the insert pointing toward the center of the truck (inboard) leaving enough threads for bracket installation.

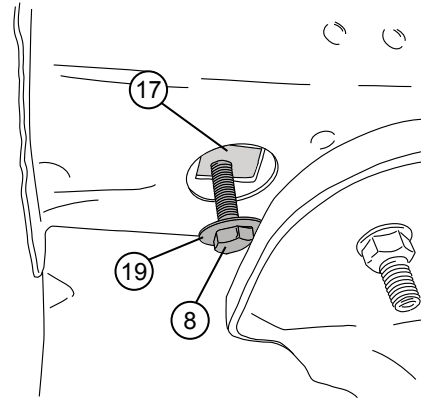

16

Position Support Bracket as shown below, resting against rear face of Idler Linkage and slotted end around hanging bolt and washer from step 16.

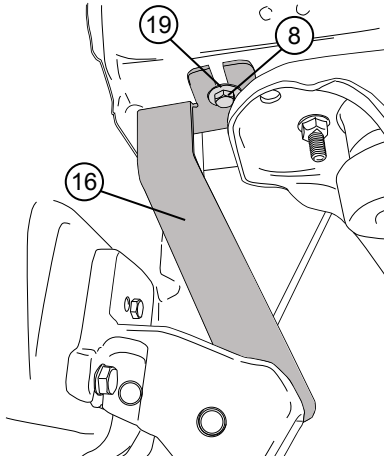

17

With Support Bracket flush to the sheet metal and upper Hex Bolt snug, shift bracket until slot lines up with the threaded hole. Insert Flange Bolt.

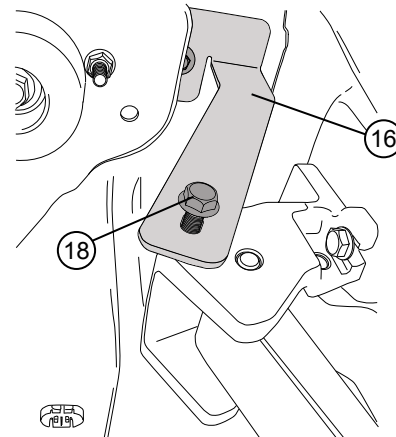

18

With bolts snug and bracket squarely mounted to truck sheet metal and Linkage Assembly, tighten both Hex Bolts to 16 ft-lbs with 13mm wrench or socket.

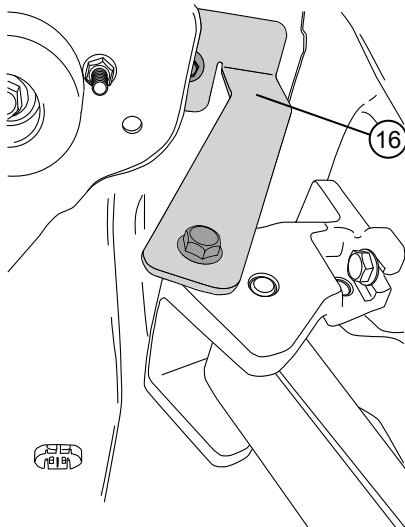

19

Torque to 16 ft-lbs.
(22 Nm)

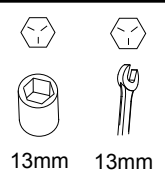

AMP RESEARCH POWER STEP – DODGE RAM

Prepare large tie-wraps for mounting Power Step Controller. Loosely loop tie-wraps around large bundle of wires behind battery in engine compartment.

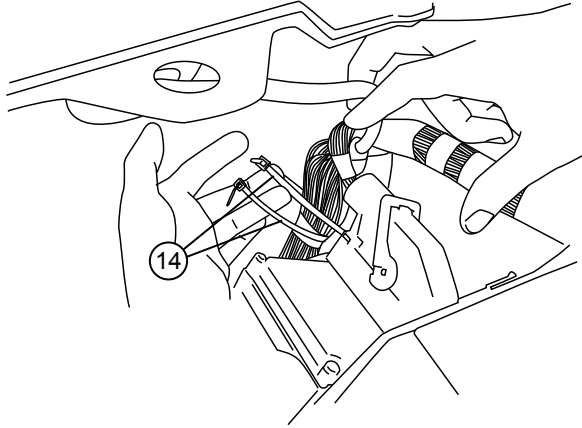

20

Insert controller into tie-wrap loops and cinch down securely. The tie-wraps should cinch down into channels on controller surface.

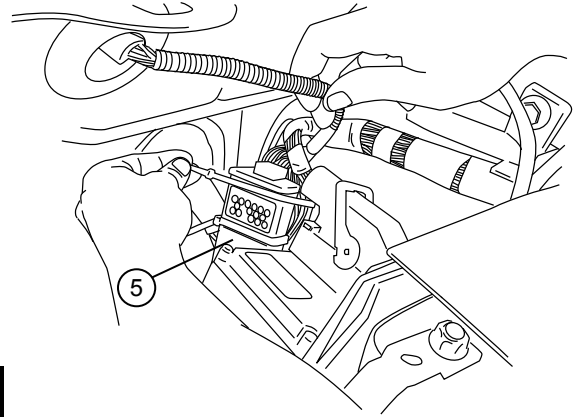

21

Remove fuse from Power Step Wire Harness.

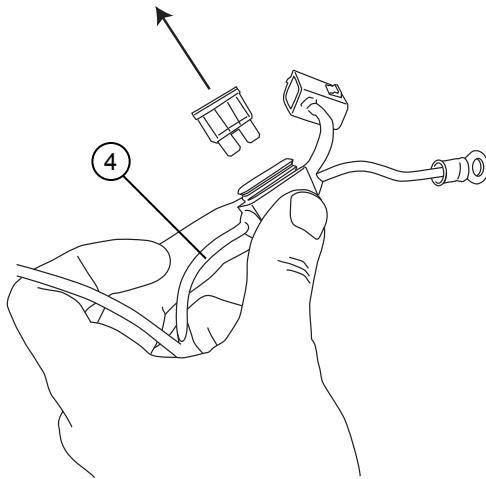

22

Connect power leads from Controller, Red to positive battery terminal and Black to the vehicle body ground as shown.

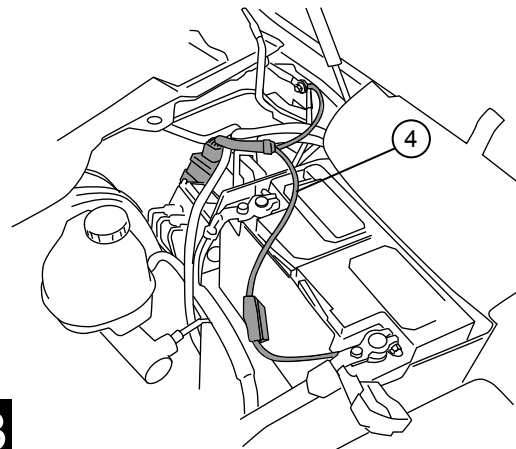

23

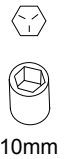

10mm

Route the trigger wires of Power Step Harness (Purple wires) down toward the fuse box located in front of the battery.

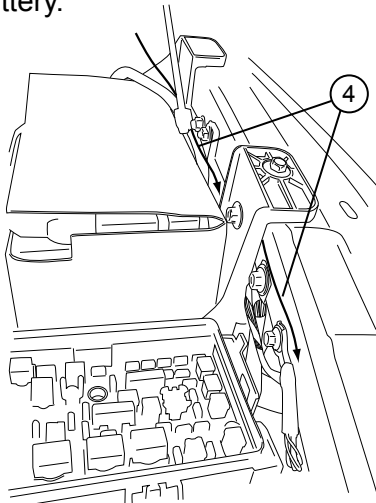

24

Remove fuse box lid and fuse box power lead with 13mm wrench. While depressing release tabs, lift fuse box to view bottom side.

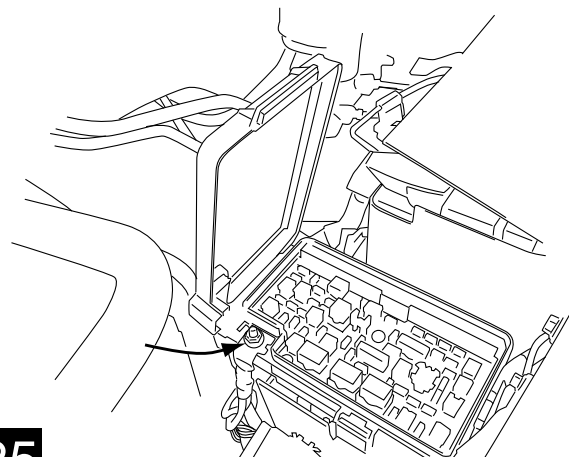

25



13mm

AMP RESEARCH POWER STEP – DODGE RAM

Locate and remove Black Connector with Gray latch on bottom side of fuse box (labeled “G” where connected to fuse box).

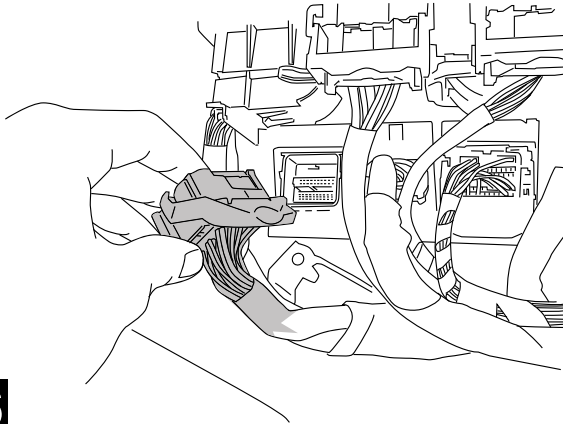

Locate the vehicle’s Door Ajar Switch wires on the removed connector as indicated in chart and diagram below.

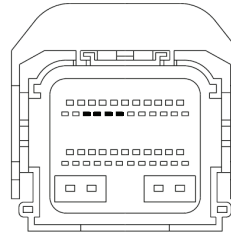

CAVITY	COLOR	FUNCTION
14	VIOLET	DRIVER DOOR AJAR SWITCH SENSE
15	VIOLET / WHITE	PASSENGER DOOR AJAR SWITCH SENSE
16	VIOLET / GRAY	LEFT REAR DOOR AJAR SWITCH SENSE
17	VIOLET / YELLOW	RIGHT REAR DOOR AJAR SWITCH SENSE

26

27

Splice Power Step trigger wires into the Door Ajar wires with provided Posi-Tap™ splicers. The Power Step trigger wires color coordinate with the factory Door Ajar wires. Follow the steps below to correctly splice wires.

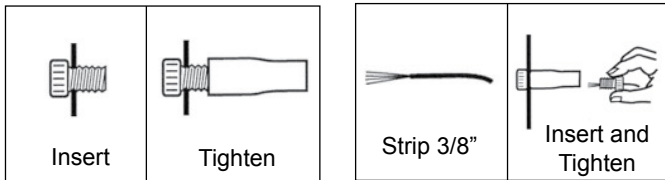

With Posi-Taps securely in place, carefully replace connector and drop wire bundles and fuse box back into place. Reattach fuse box power lead that was removed in previous step.

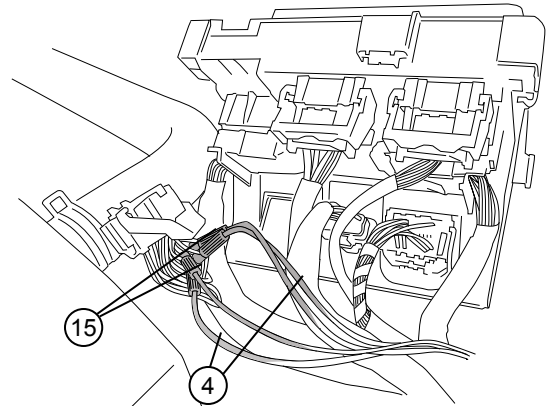

28

29

Route the two Wire Harness legs down over the wheel wells toward Motor Linkages, long leg across to the passenger side. Secure harness with tie wraps.

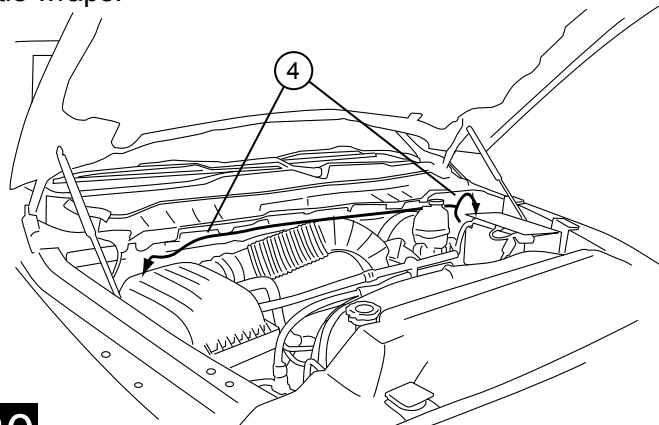

On driver side, run Wire Harness leg down and along underside of the vehicle floor and frame to front Drive Linkage. Connect harness to motor and secure harness with tie wraps. Route remainder of wire harness towards rear linkage assembly for LED lights

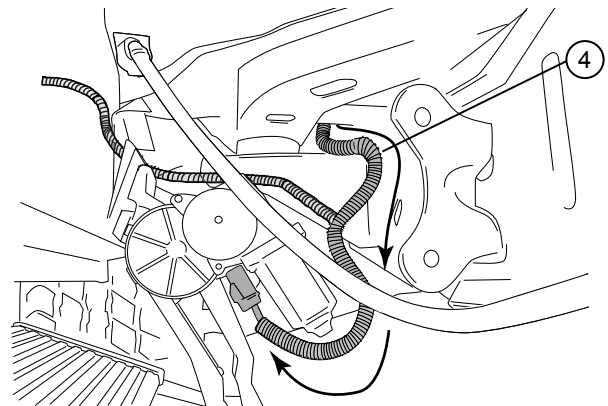

30

31

On Passenger Side, run Wire Harness leg down and along underside of the vehicle floor and frame to front Drive Linkage. Connect harness to motor and secure harness with tie wraps. Route remainder of wire harness towards rear linkage assembly for LED lights

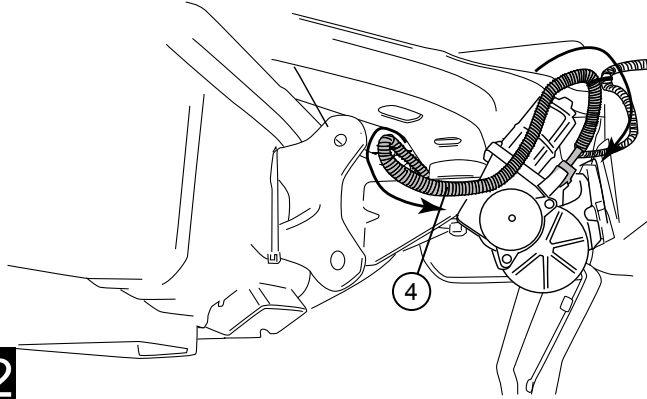

32

On each side of the vehicle measure from the front edge of door line on the pinch weld to the specified lengths below. Measure at 22" for the front LED Light and 64-3/4" for the rear LED Light.

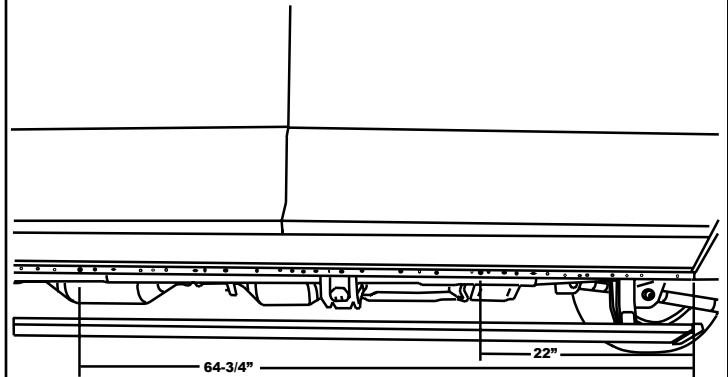

33

Drill a 9/32" hole through the pinch weld at marked locations. Deburr all holes.

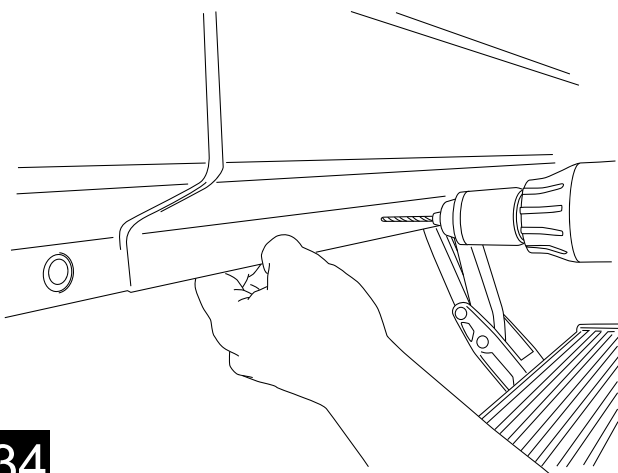

34

Insert grommet into drilled holes. Insert lamp wires through the grommets. (Silicon lube will help wires slip through grommets.)

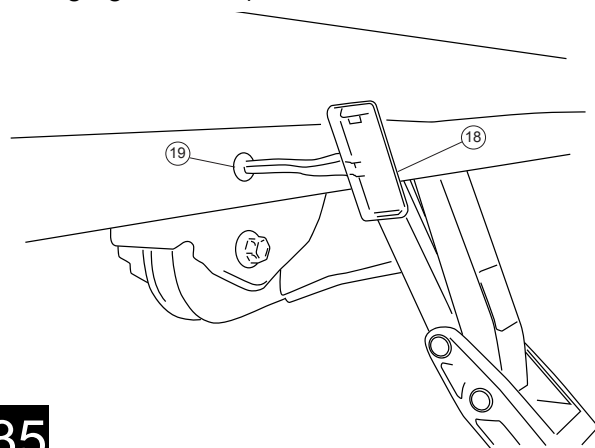

35

Affix lamp to rocker panel surface. Make sure lamp is affixed to a flat, clean surface.

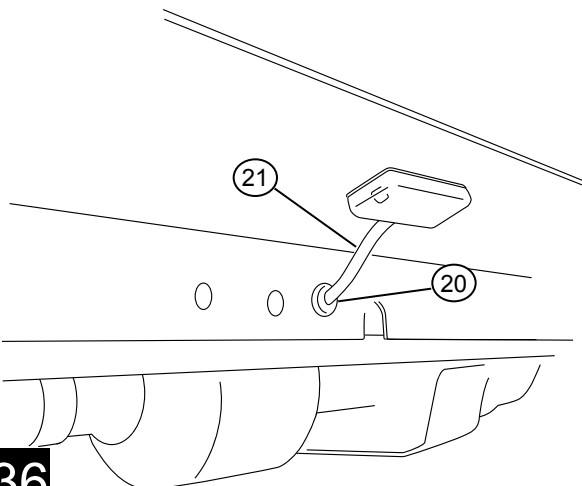

36

Using supplied butt connectors, connect the lamp wires. Red to Red, Black to Black

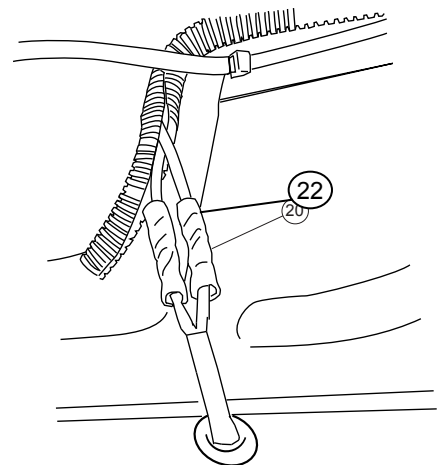

37

Close and wrap with conduit and electrical tape. Secure all loose wires with cable ties, with lamp wires pulled upward to avoid any wire snagging.

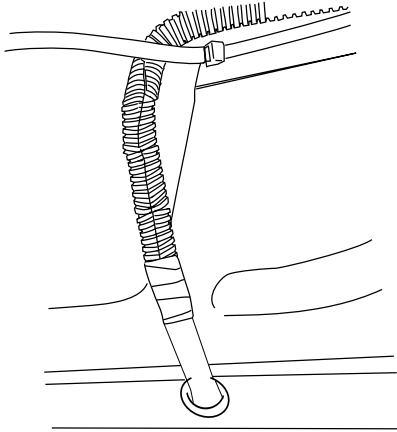

38

Reinstall fuse.

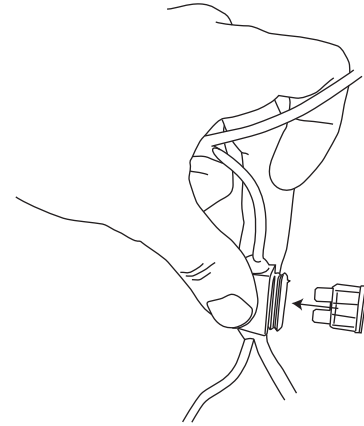

39

Check that all doors activate the Power Step and the LED Lights work when doors open and close. Reinstall any remaining trim panels.

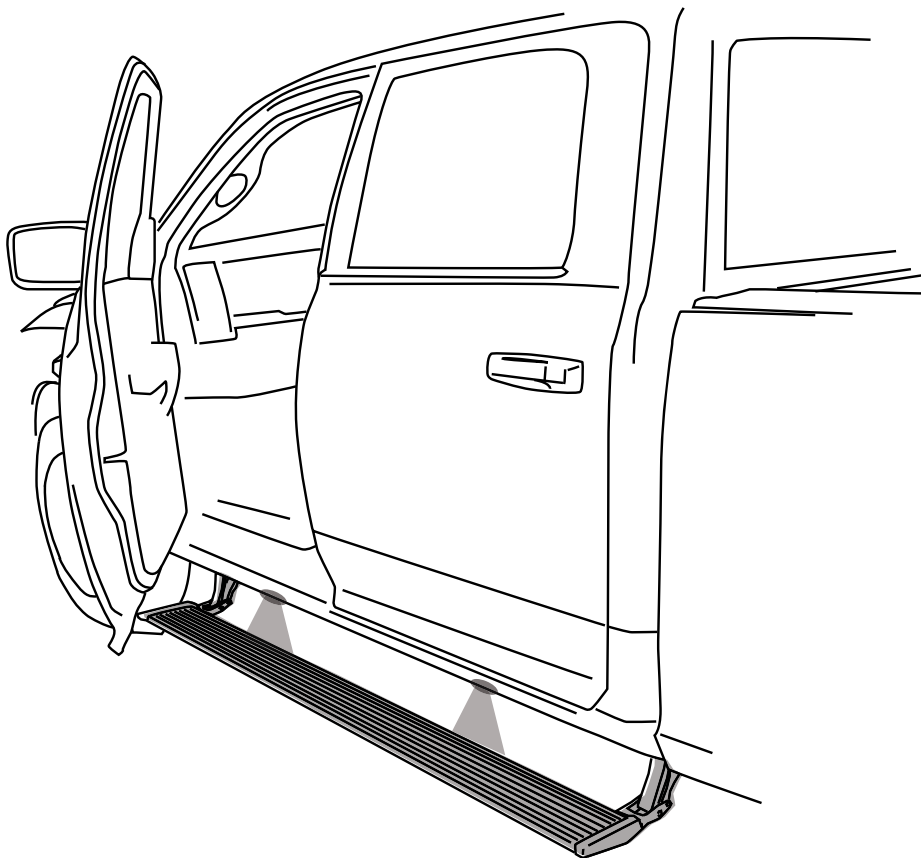

Correct operation of Lights: All four lamps will illuminate upon opening any door of vehicle. Lamps will stay on until restowing of both Power Steps or until 5 minutes has expired with the doors open. When the lights timeout after 5 minutes, they can be reilluminated by closing and opening any door of vehicle.

40

Congratulations on the purchase of your AMP Research Power Step



Here's what you should know...

OPERATION

The AMP Research Power Step automatically deploys when at least one door opens and automatically retracts under your vehicle when both front and rear doors close. If resistance or blockage is encountered while the Power Step is in motion, the drive system is designed to automatically stop. To reset, simply open or close the vehicle door and the Power Step will resume normal operation.

MAINTENANCE TIPS

The stepping surface and drive mechanism can be wash with mild soap and water using a soft brush or sponge to dislodge any mud, dirt or accumulated road grime. Rinse with fresh water.

To prevent slipping, avoid applying waxes, lubricants or protectants like Armor All® to the step surface.

When washing your vehicle, the Power Steps can be set to remain deployed with the doors closed for easy cleaning. Do this...

- 1** With the Power Step deployed, press and hold the board down with your foot.
- 2** Close the door while continuing to press down the board. (This will not harm motor.)
- 3** To reset the Power Step, simply open and close the door. (Repeat for both sides of vehicle.)

CAUTION! BE SURE TO KEEP HANDS AWAY WHEN THE POWER STEP IS IN MOTION.

amp-research.com

LIMITED WARRANTY

AMP RESEARCH warrants product to be free from defects in material and workmanship, for terms specified below, provided there has been normal use and proper maintenance. All remedies under this warranty are limited to the repair or replacement of any item found by the factory to be defective within the time period specified.

If you have a warranty claim, first you must call our factory at the number below for instructions. You must retain proof of purchase and submit a copy with any items returned for warranty work. Upon completion of warranty work, if any, we will return the repaired or replaced item or items to you freight prepaid. Damage to our products caused by accidents, fire, vandalism, negligence, misinstallation, misuse, Acts of God, or by defective parts not manufactured by us, is not covered under this warranty.

THE WARRANTY TIME PERIOD IS AS FOLLOWS: 5-YEARS FROM DATE OF PURCHASE.

ANY IMPLIED WARRANTIES OF MERCHANTABILITY AND/OR FITNESS FOR A PARTICULAR PURPOSE CREATED HEREBY ARE LIMITED IN DURATION TO THE SAME DURATION AND SCOPE AS THE EXPRESS WRITTEN WARRANTY. OUR COMPANY SHALL NOT BE LIABLE FOR ANY INCIDENTAL OR CONSEQUENTIAL DAMAGE.

Some states do not allow limitations on how long an implied warranty lasts, or the exclusion or limitation of incidental or consequential damages, so the above limitations or exclusions may not apply to you. This warranty gives you specific legal rights, and you may also have other rights that vary from state to state.

WARNING

Be sure to read and precisely follow the provided instructions when installing this product. Failure to do so could place the vehicle occupants in a potentially dangerous situation. After installing or reinstalling, re-check to insure that the product is