

AIR RAID®

INTAKE SYSTEMS

#200-154 INSTALLATION INSTRUCTIONS

2004 Chevy HD Truck

04-05 GMC HD Truck

Duramax Diesel High Output “LLY”

Thank you for purchasing the Airaid Intake System. Please read the instruction manual carefully before proceeding with the installation. Contact Airaid @ (800) 498-6951 8:00 AM - 5:00 PM MST weekdays for questions regarding fit or instructions that are not clear to you. Your Airaid Intake System was carefully inspected and packaged. Check that no parts are missing, or were damaged during shipping. If any parts are missing, contact Airaid. The air filter element is protected from direct exposure to water and debris; care should be taken not to drive through deep water. WATER INGESTION IS THE DRIVERS RESPONSIBILITY! The air filter is reusable and should be cleaned using the Airaid Filter Tune-Up Kit periodically.

Thank you for selecting Airaid.

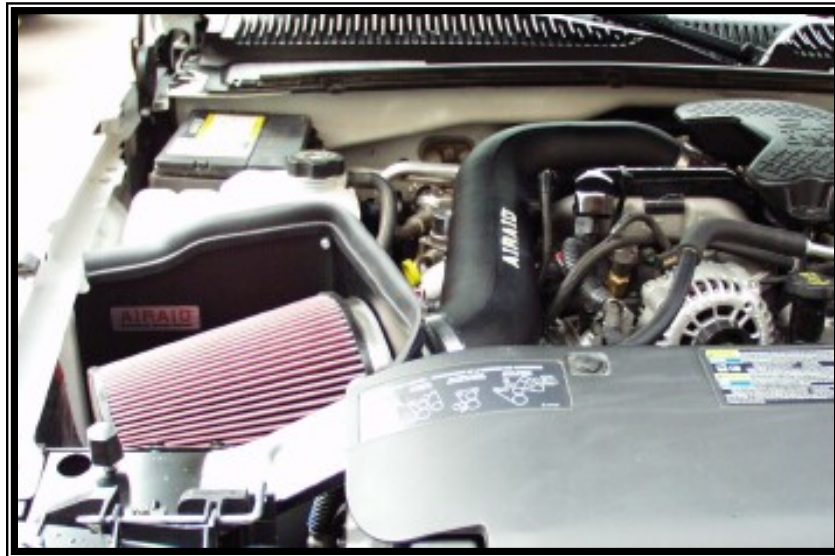

Packing List:

700-469	Airaid Premium Filter	1
KIT112MAFADA	Black MAF adapter	1
KIT112MAFC	Front Cool Air Dam Panel	1
KIT1121RRDAMC	Rear Cool Air Dam Panel	1
KITHUMPHS05	Silicone Hump Hose	1
KITCOUPLER01	Silicone Coupler	1
KIT154T	Modular Intake Tube	1
KIT154WS	Weather Strip	1
KIT154HP-	Hardware & Instructions	1
- KIT10BHCP50	8-32 x 1/2 Button Screw	2
- KIT6NWSAPZ	#6 Flat Washer	5
- KIT6CNKEPZ	6-32 Nut	5

Packing List (cont'd):

- KIT6C31MXPPZ	6-32 x 5/16 Screw	5
- KIT15DHC3050	1/4-20 Button Head Bolt	3
- KIT09FWZ019	3/16 Flat Washer	7
- KIT60C250HCS	M6-1.25 Hex Bolt	4
- KIT10ANSSWAS	#10 AN Flat Washer	2
- KITBIT#T20	#T20 Security bit	1
- KITHS60	#60 Hose Clamp	2
- KITHS64	#64 Hose Clamp	2

Tools Required for this Installation:

Flat Head Screwdriver
8mm, 10mm socket
3/32 Allen Wrench

Installation Instructions. Read Me!



1. Disconnect negative battery cable. Using supplied T-20 security cable. Using supplied T-20 security bit, remove factory mass air sensor (save for later use).



2. Remove factory filter minder and grommet.



3. Loosen hose clamps on factory intake tube assembly and remove from engine. Unsnap factory air box assembly and remove from vehicle.



4. Using a 10mm socket, remove the five bolts and plate from engine compartment.

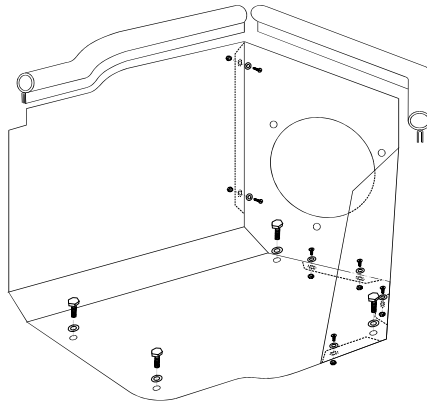

5. Assemble Airaid Cool Air Dam panels using the supplied #6 screws, washers and nuts.

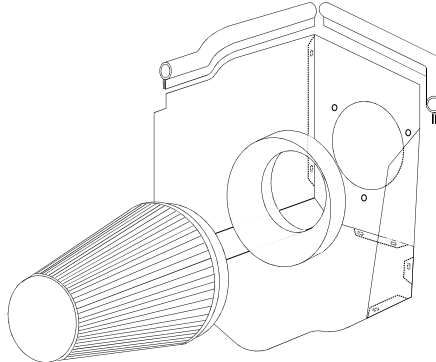

6. Using the three supplied 1/4 - 20 bolts and washers, install the air filter adaptor on the Airaid Cool Air Dam.



7. Install Airaid Cool Air Dam assembly in engine compartment using the supplied bolts and washers.



8. Using the supplied 8/32 allen head bolts and washers, install factory mass air sensor in Airaid intake tube. (*Note: Sensor must be installed in direction shown in picture.*)



9. Install factory rubber grommet and air filter minder in Airaid intake tube.



- 10.** Install supplied hump hose and two #64 hose clamps onto large end of Airaid intake tube. (*Note: Leave hose clamps loose until final assembly.*)



- 11.** Install coupler and two #60 hose clamps onto small end of Airaid intake tube. (*Note: Leave hose clamps loose until final assembly.*)



- 12.** Install Airaid intake assembly onto engine. Position coupler and hump hose and tighten hose clamps. (*Note: There should be a gap in between the Airaid intake tube and the air filter adaptor.*)

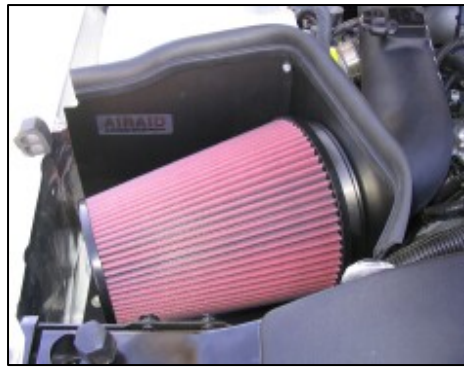

- 13.** Install the supplied Airaid filter on the air filter adaptor. Install the supplied weather strip on the Airaid Cool Air Dam. (*Note: Start from one corner and work your way around to insure proper alignment of weather strip.*)

- 14.** Double check your work to be certain that all nuts, bolts, and clamps are securely fastened.
- 15.** Reconnect the negative battery cable.

**PROUDLY MADE IN THE
USA** 

Before



After!



Don't Forget Your AIRAID Filter Tune-Up Kit!



P/N 790-550

Instructions Revision
Date: 11/7/05