

# AIRRAID®

## INTAKE SYSTEMS

### #200-168 INSTALLATION INSTRUCTIONS

2005 Chevrolet Silverado HD 6.0L & 8.1L

2006 Chevrolet Silverado 4.3L, 4.8L, 5.3L, 6.0L, 8.1L

(Does not fit GMC truck)

Thank you for purchasing the Airaid Intake System. Please read the instruction manual carefully before proceeding with the installation. Contact Airaid @ (800) 498-6951 8:00 AM - 5:00 PM MST weekdays for questions regarding fit or instructions that are not clear to you. Your Airaid Intake System was carefully inspected and packaged. Check that no parts are missing, or were damaged during shipping. If any parts are missing, contact Airaid. The air filter element is protected from direct exposure to water and debris; care should be taken not to drive through deep water. WATER INGESTION IS THE DRIVERS RESPONSIBILITY! The air filter is reusable and should be cleaned using the Airaid Filter Tune-Up Kit periodically.

*Thank you for selecting Airaid.*



#### Packing List:

700-469	Airaid Premium Filter	1
KIT112MAFADA	Black MAF Adapter	1
KIT167RRDAMC	Rear Air Dam Coated	1
KIT167MAFDAC	MAF Panel Coated	1
KITWSTRIP02	Weather Strip 21"	1
KIT168HP	Hardware Pack	1
-KIT15DHC3050	1/4-20 x 1/2" SS Button Head Bolt	3
-KIT168TRIM	7/4" Rubber Trim	1
-KIT60C250HCS	M6-1x25 Hex Bolt	4

#### Packing List (cont'd):

-KIT6CNKEPZ	6-32 Keps Nut	5
-KIT6C31MXPPZ	6-32 X 5/16" Screw	5
-KIT6NWSAPZ	#6 Flat Washer	5
-KIT09FWZ019	1/4" Flat Washer	7

#### Tools Required for this Installation:

Flat Head & Phillips Screwdriver  
 10mm Socket or Wrench  
 6" Socket Extension & Ratchet  
 5/32" Allen Wrench

## Installation Instructions. Read Me!



1. Disconnect the negative battery cable. Loosen the 2 factory hose clamps located at the Mass Air Flow (MAF) meter.

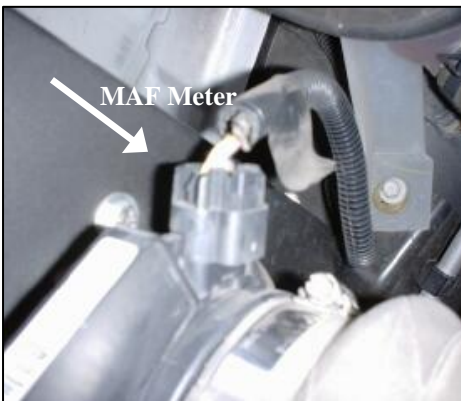

2. Unplug the MAF meter and remove the meter from the factory intake tube.



3. Remove the factory air filter lid and base from vehicle as an assembly. (Hint: pull straight up on the air filter base to remove, there are no bolts; just friction mounts).



4. Remove the five 10mm bolts that secure the factory air filter housing platform and remove.

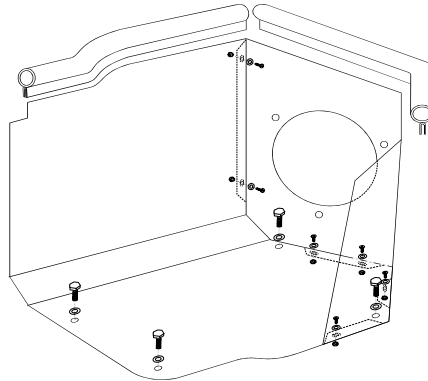

5. Position the two Airaid Cool Air Dam panels and fasten them together with the small #6 screws, nuts & washers provided.



6. Install the 7 1/4" rubber trim onto the side of the air dam as illustrated.



7. Install the black plastic filter adapter using the three 1/4-20 x 1/2" button head bolts and washers provided.

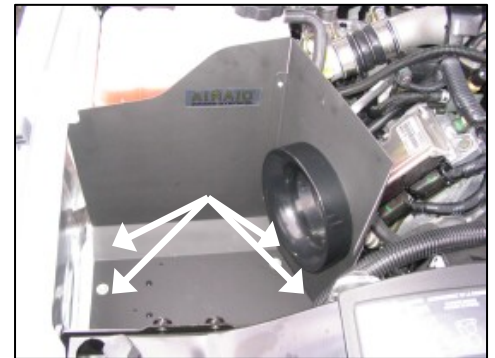

8. Position the Airaid Cool Air Dam Intake system in place of the factory air box & secure the Airaid system to the factory mounting pad using the four supplied 6mm bolts and washers. (*Caution: over tightening may distort the cold air dam!*)

**PROUDLY MADE IN THE**  
**USA** 



9. Slide the factory MAF meter into the black plastic filter adapter. Tighten hose clamp. *(Note: The factory clamp / rubber bushing must be in place on the inlet to the MAF meter.)* Reconnect the factory intake tube, and tighten clamp.



10. Mount the Airaid Premium Air Filter onto the black plastic filter adapter and tighten hose clamp. Press supplied weather stripping along the top edges of the Airaid cold air dam; assure that it is fully seated along the edges. *(Hint: Begin at a corner and work toward the ends).*

11. Check for any foreign objects or debris in the intake path.
12. Double check your work to be certain that all nuts, bolts, and clamps are securely fastened.
13. Reconnect the negative battery cable!

*Before*



*After!*



# Don't Forget Your AIRAID Filter Tune-Up Kit!



**P/N 790-550**

Instructions Revision  
Date: 3/1/05