

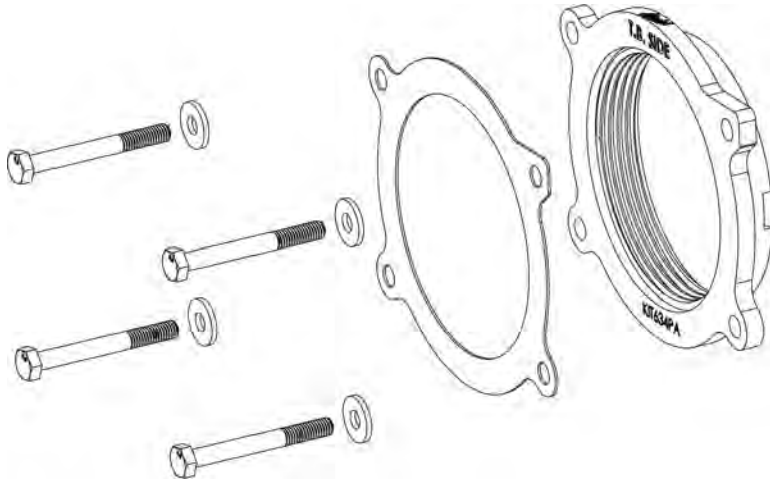

Installation Instructions
Part Number 250-634
2010-15 Chevrolet Camaro
6.2L V-8

INTAKE SYSTEMS FOR VEHICLES LISTED ARE 50
STATE LEGAL. SEE AIRAID.COM FOR CARB STATUS
ON EACH PART FOR A SPECIFIC VEHICLE.



Parts List

AIR-KIT634PA	Aluminum Plate	(1)
AIR-KIT634G	Gasket	(1)
AIR-KIT634H	Hardware	
	6mmx50mm Bolt	(4)
	6mm Flat Washer	(4)

Tools Required For Installation

5/16", 10mm Socket
Ratchet and Extension

Thank you for purchasing the Airaid Throttle Body Spacer. Please read the instruction manual carefully before proceeding with the installation. Your Airaid Throttle Body Spacer was carefully inspected and packaged. Check that no parts are missing, or were damaged during shipping. If you need any assistance please call 1-800-858-3333 to speak with a representative in our Customer Service Center before returning the product.
Thank you for selecting AIRAID.



1. Disconnect the negative battery cable!

Remove the oil fill cap and set it aside.
Lift straight up on the engine beauty cover and set it aside.
Reinstall the oil fill cap after the beauty cover has been removed to prevent any foreign material from entering the crankcase.



2. Disconnect the breather hose elbow by pulling it straight away from the intake tube. It is only held in place by an O-ring. Loosen the two hose clamps that secure the intake tube to the throttle body, and the air box lid. Remove the air intake tube.



3. Remove the four bolts that secure the throttle body to the intake manifold.

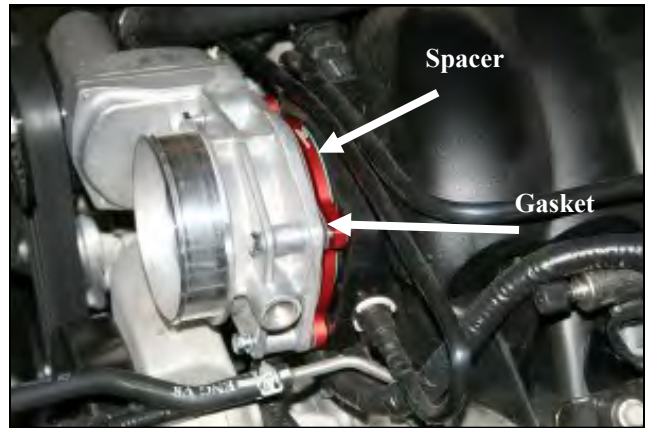

4. Install the Airaid Spacer between the throttle body and the intake manifold with the supplied gasket next to the throttle body as shown. *Note: Airaid spacer must be installed with bore protruding into intake manifold away from throttle body. Incorrect installation will hinder performance. Reference picture below for spacer orientation.



5. Install the provided bolts and washers thru the throttle body, gasket, and Airaid Spacer and tighten to the manufacturer's specifications.



6. Reinstall the intake tube, tighten the two hose clamps, and reconnect the crankcase breather tube. Reinstall the beauty cover, and oil cap in the reverse order that they were removed. **Re-connect the negative battery cable!**

The sound of power...The "whistle" means its working!



Example of proper spacer installation. Spacer must protrude into intake manifold and away from throttle body.

Contact your nearest Airaid dealer for an Airaid Intake System for your car, truck or SUV.

AIR-125634C
Rev. 06.29.20

Airaid. 1455 Citrus St, PO Box 1329, Riverside, CA 92502 (800) 498-6951 AiraidInfo@airaid.com