



Installation Instructions

For Part Numbers:

400-203	720-472 Airaid Oiled Media Filter
401-203	721-472 SynthaMax Dry Media Filter - Red
402-203	722-472 SynthaMax Dry Media Filter - Black
403-203	723-472 SynthaMax Dry Media Filter - Blue

2005-07 Ford F-250/F-350 Super Duty
6.8L V10

Component Identification

1.	Airaid Premium Filter	1
2.	MAF Panel	1
3.	Bottom Panel	1
4.	MAF Adapter	1
5.	Weather Strip 33"	1
6.	1/4-20x1/2" Button Head Bolt	5
7.	1/4" Flat Washer	5
8.	1/4" Serrated Nut	1
9.	8-32x3/8" Button Head Screw	2
10.	6-32x5/16" Screw	7
11.	#6 Flat Washer	7
12.	6-32 Keps Nut	7
13.	L-Bracket	1
14.	#20 Torx Bit	1
15.	Airaid Decal	1

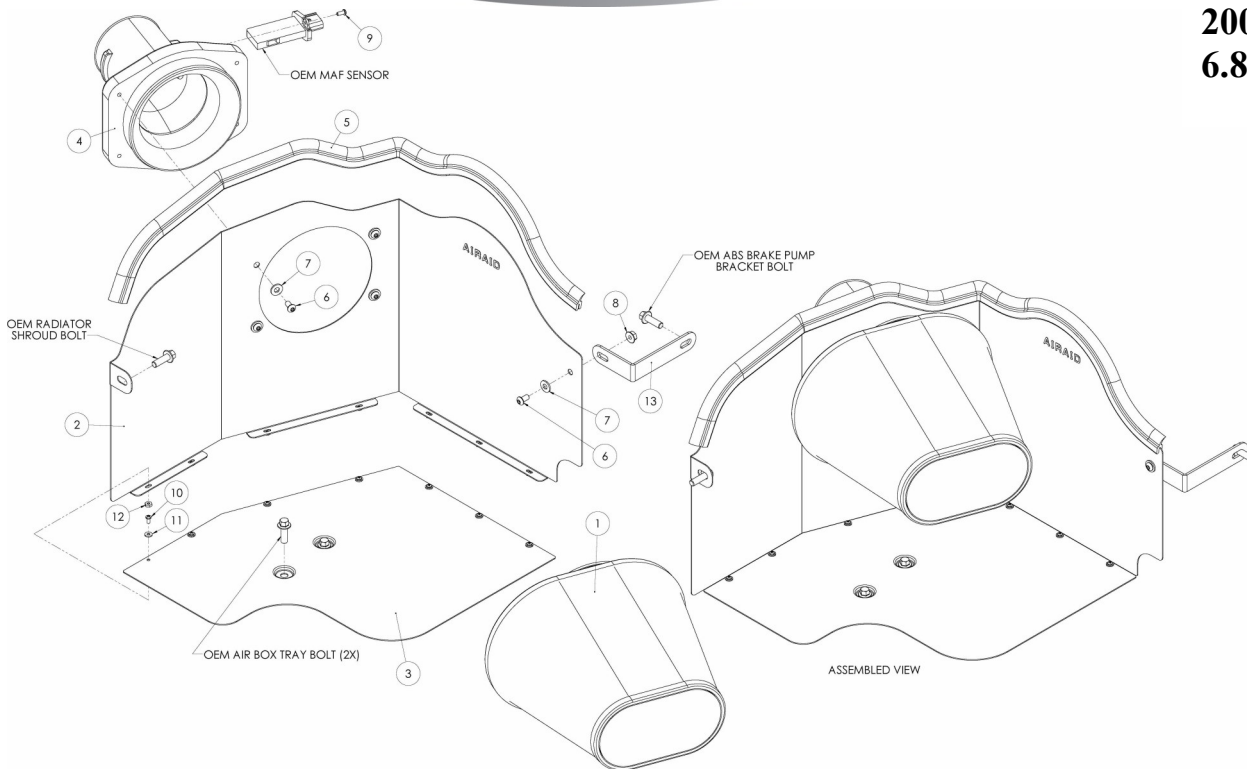

Full color instructions can be viewed on our web site at Airaid.com. Use the **Product Search** function to find your part number, and click **View Details**.

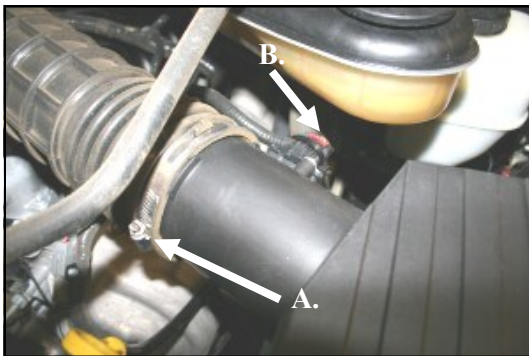

- 1. Disconnect the negative battery cable!**
A.) Loosen the hose clamp on the factory intake tube.
B.) Slide back the red tab, and disconnect the factory mass air sensor wiring harness.



- 2.** Unlatch the three metal clips that hold the airbox lid to the base.



- 3.** Remove the airbox lid and air filter from the vehicle.



- 4.** Remove the base assembly by pulling it up out of the mounting grommets. Using the supplied torx bit (#14), 1/4" socket, ratchet and extension remove the two screws holding the factory mass air sensor in place, and remove the mass air sensor from the air cleaner lid.



- 5.** Install the factory mass air sensor into the Airaid MAF Adapter (#4), using the two supplied 8-32 button head screws (#9) and a 3/32" allen wrench. Note the direction of flow on the sensor, and mount as shown above. **DO NOT USE THE FACTORY SCREWS!!**

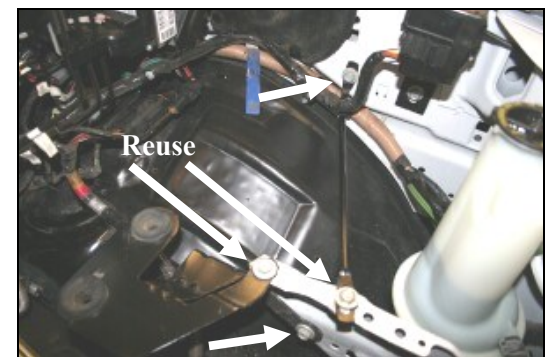

- 6.** Using a 1/2" socket, ratchet and extension, remove the 2 bolts that hold the support rod, and 2 bolts that hold the air cleaner base support. Remove the support rod and base support and set them aside. The 2 bolts that hold the air cleaner base support will be reused in step #11.



- 7.** Using a 1/2" socket, ratchet, and extension, remove one bolt attaching the air cleaner base alignment bracket to the radiator support. The bolt will be reused in step #11.

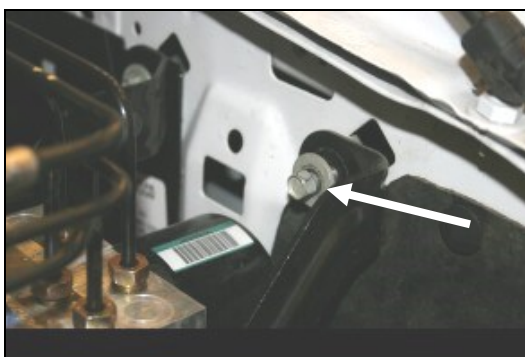

- 8.** Using a 10mm socket, remove one bolt which secures the anti lock braking system bracket to the drivers side inner fender. The bolt will be reused in step #12.

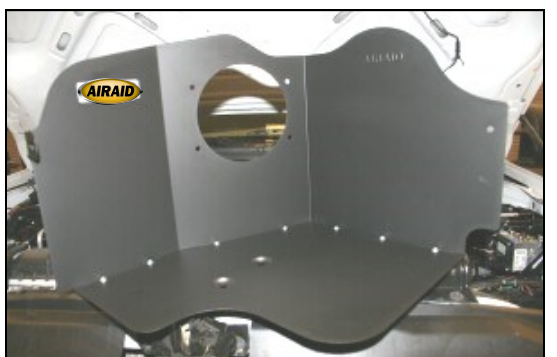

- 9.** Assemble the two Cool Air Dam panels (#2 and #3) as shown, using seven 6-32 screws (#10), #6 washers (#11), and keps nuts (#12). Tighten securely. Apply the Airaid Foil Decal onto the Panel as shown.



10. Install the MAF adapter (#4) into the panel, using four 1/4-20 button head bolts (#6), and 1/4" washers (#7). Be sure to orient the tube with the mass air sensor to the rear of the vehicle. Using a 5/32" allen wrench, tighten the 4 bolts securely.

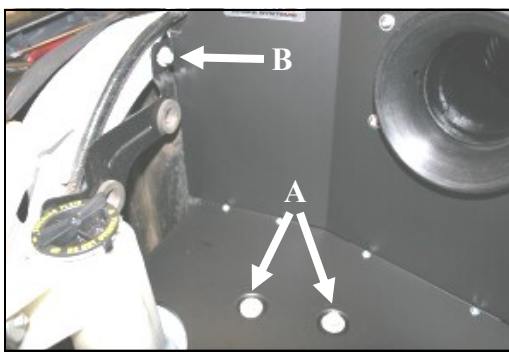

11. A.) Align the two panel holes with the air cleaner base support holes on the vehicle. B.) Align the tab on the panel with the radiator support bolt hole. The tab will mount on top of the bracket. Re-install the bolts saved from steps #6 and #7 into the two bottom holes of the Cool Air Dam, and one through the radiator support tab.

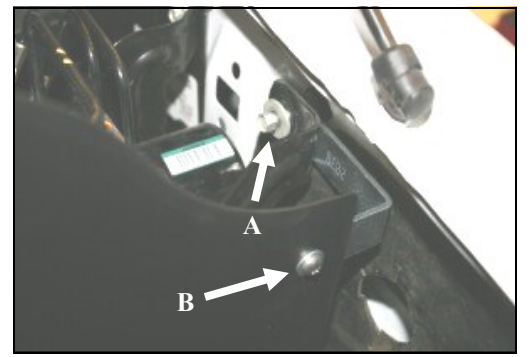

12. A.) Slide the L-bracket under the anti lock braking system bracket, and re-install the bolt removed in step #8. B.) Fasten the bracket onto the back of the panel using one 1/4-20x1/2" button head bolt (#6), washer (#7), and serrated nut (#8). Tighten securely.

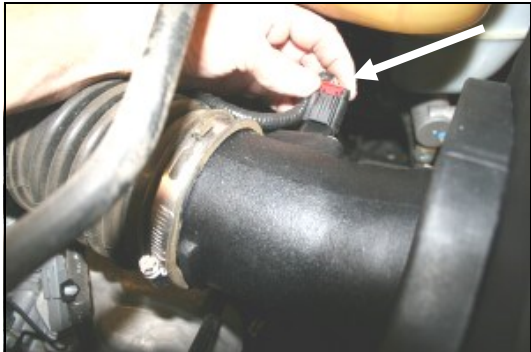

13. Reconnect the factory air intake tube onto the MAF adapter (#4), and tighten the hose clamp securely. Next, re-connect the mass air flow sensor wiring harness onto the sensor.



14. Install the Airaid Premium Filter (#1) onto the MAF adapter and tighten the clamp. Next, install the weather strip (#5) onto the top of the CAD, starting next to the fender and working your way towards the radiator.

15. Double check your work!

Make sure there is no foreign material in the intake path. Make sure all clamps, hoses, bolts, and screws are tight.

16. Re-connect the negative battery cable!

Thank you for purchasing the Airaid Intake System. Contact Airaid @ (800) 498-6951 8:00 AM - 5:00 PM MST weekdays for questions regarding fit or instructions that are not clear to you. Your Airaid Intake System was carefully inspected and packaged. Check that no parts are missing, or were damaged during shipping. If any parts are missing, contact Airaid. The air filter element is protected from direct exposure to water and debris; care should be taken not to drive through deep water. WATER INGESTION IS THE DRIVERS RESPONSIBILITY! The air filter is reusable and should be cleaned periodically.

FILTER IDENTIFICATION

720-472 Airaid Oiled Media
722-472 Airaid SynthaMax Dry Media - Black

721-472 Airaid SynthaMax Dry Media - Red
723-472 Airaid SynthaMax Dry Media - Blue

For your Oiled media filter we suggest using the AIRAID Filter Tune-Up Kit!



P/N 790-551 Aerosol Spray
P/N 790-550 Squeeze Spray



SynthaMax

Do Not Oil

Synthamax Air Filters do not require oil. Service air filter as needed by cleaning with common non-petroleum all-purpose household cleaner and water. Simple Green®, Formula 409® or equivalent works great. Apply cleaner to outside of air filter and allow to soak. Then flush filter clean from the inside out with a garden hose and repeat steps if necessary. Do not apply high pressure water or air to clean filter. Allow filter to air dry and reinstall.