

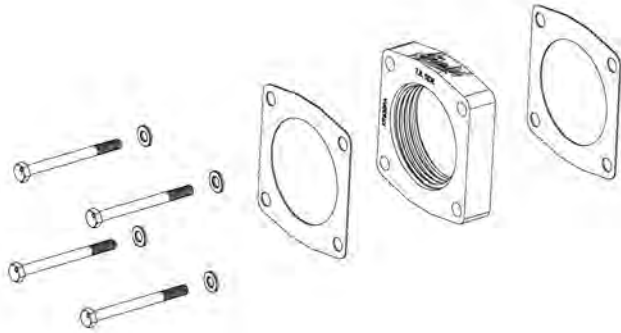

**Installation Instructions
Part Number 530-632
Poweraid Spacer For
2006-09 Honda Ridgeline
2006-09 Honda Pilot
3.5L V-6**



Parts List

- AIR-KIT632PA Aluminum Plate (1)
- AIR-KIT632G Fiber Gasket (2)
- AIR-KIT632H Hardware
 - 8mm x 75mm Hex Bolts (4)
 - 8mm Flat Washers (4)

NOT LEGAL FOR SALE OR USE ON ANY POLLUTION CONTROLLED MOTOR VEHICLE IN CALIFORNIA OR STATES ADOPTING CALIFORNIA EMISSION PROCEDURES.

See AIRAID.COM for CARB status on each part for a specific vehicle.

Tools Required For Installation

- 10mm, 12mm, 13mm Sockets
- 12mm Wrench
- Flat Blade Screwdriver
- Ratchet & Extension

Thank you for purchasing the Airaid Throttle Body Spacer. Please read the instruction manual carefully before proceeding with the installation. Your Airaid Throttle Body Spacer was carefully inspected and packaged. Check that no parts are missing, or were damaged during shipping. If you need any assistance please call 1-800-858-3333 to speak with a representative in our Customer Service Center before returning the product.

Thank you for selecting AIRAID.



1. **Disconnect the negative battery cable!**
Using a flat blade screwdriver, turn the plastic keepers at the front of the engine beauty cover. Remove the engine beauty cover by lifting up and releasing it from the grommets.



2. A.) Disconnect the wiring connector on the top of the throttlebody. B.) Squeeze the clamp with your fingers and disconnect the metal tube from the intake tube. C.) Using a 10mm socket, loosen the hose clamp on the throttle body end of the factory intake tube. Pull the intake tube out from between the throttle body and the airbox and set it out of the way.

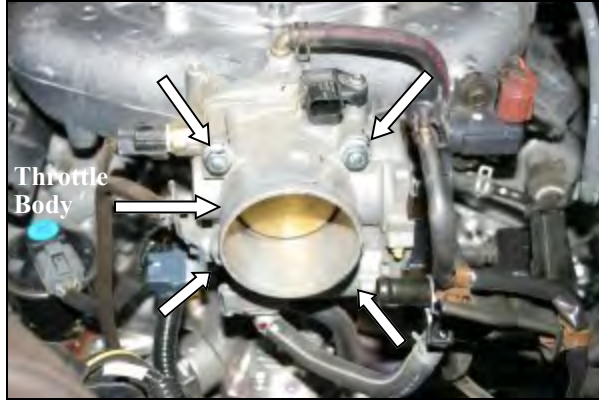

3. Remove the two nuts and two bolts that secure the throttle body to the intake manifold. Remove the throttle body and the factory gasket. Remove the two studs that are left in the intake manifold.



5. Reinstall the factory intake tube, and tighten the hose clamp. Reconnect the metal tube to the intake tube. Reconnect the throttle body wiring connector. Reinstall the engine beauty cover.
Re-connect the negative battery cable!

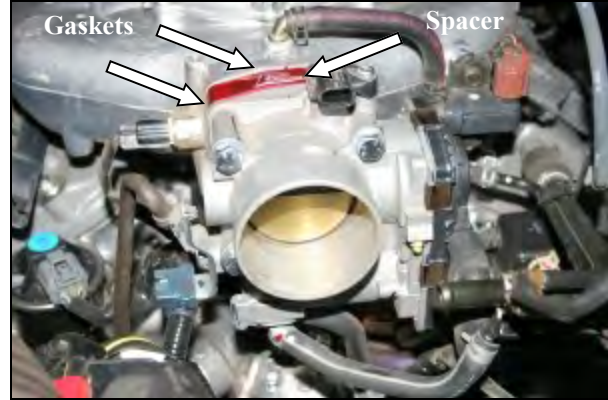

4. Install the spacer (#1) (with the flat side of the helix bore facing the throttle body) between the intake manifold, and the throttle body with one of the supplied gaskets (#2) on each side of the spacer. Insert four 8mm x 75mm Hex Bolts (#3), and 8mm Flat Washers (#4) through the throttle body, Airaid Spacer, and into the intake manifold. Using a 13mm socket, tighten all 4 throttle body bolts evenly, to the manufacturer's specifications.

Do Not Over Tighten The Bolts!

The sound of power...The "whistle" means its working!

Contact your nearest Airaid dealer for an Airaid Intake System for your car, truck or SUV.

AIR-I53632C
Rev. 09.29.20

Airaid. 1455 Citrus St., P.O. Box 1329, Riverside, CA. 92502 1-800-498-6951 AiraidInfo@airaid.com