



INSTALLATION INSTRUCTIONS
2006-08 GRAND VITARA
PART # 200008 / 200008-2

ATTENTION

- λ Please read this installation Menu before installing this part. When install it, pay attention to protecting your vehicles.
- λ When use it, please check this parts at a fix time - lapse, such as one month or two month.

PART LIST

No.	NAME	QTY	REMARKS	No.	NAME	QTY	REMARKS
1	SIDE STEP (Left Side)	1		4	FLAT WASHER	4	12mm
2	SIDE STEP (Right Side)	1		9	CAPSCREW	4	M 8×25
3	FRONTBRACKET (Dr. Side)	1			LOCK WASHER	4	8mm
4	FRONT BRACKET(Pass. Side)	1	M10×25×1.25		FLAT WASHER	4	8mm
5	REAR BRACKET(Dr. Side)	1	10mm	10	Threaded Bar	8	M 10×40
6	. REAR BRACKET(Pass. Side)	1			LOCK WASHER	8	10mm
7	THREADED PLATE	2			FLAT WASHER	8	10mm
8	HEX NUT	4	M12		HEX NUT	8	M10
	LOCK WASHER	4	12mm				

INSTALLATION STEPS

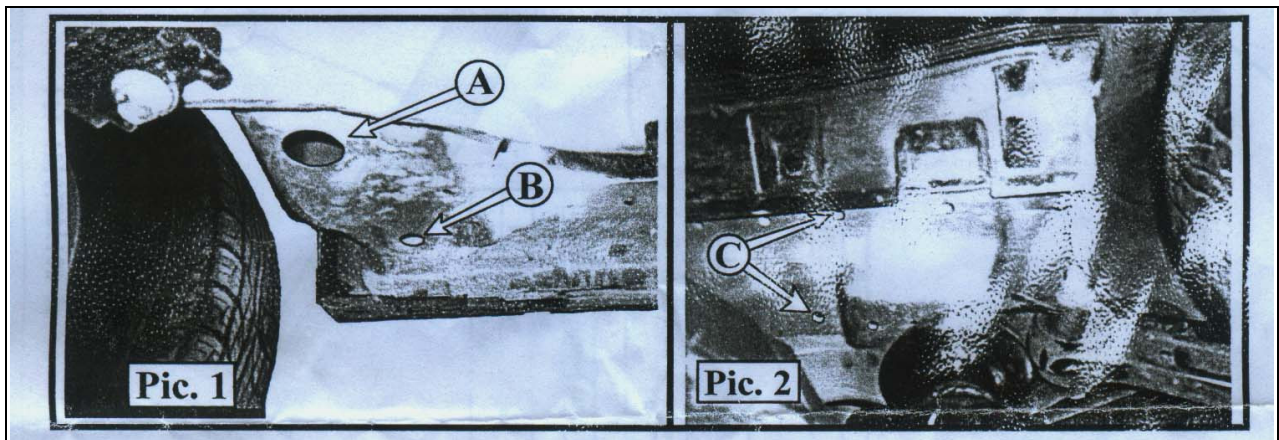

threaded bar would expose from chassis holes "B" according to Pic. No 1.

2. Place Front Bracket # 4 so that Thread Bar # 7 expenses through it. Screw with nuts # 8 & # 9.

3. Place Rear Bracket # 6 on the chassis holes "C" on the passenger side and attach it with bolts # 10.
4. Screw Thread Bar # 11 to the Side Step # 2.
5. Insert the Side Step # 2 by Thread Bar # 11 in the Brackets (# 4 & # 6) and screw with washers and nuts.
6. Install Side Step # 1 on the driver side in the same way.
7. Adjust the Side Steps and tighten the bolts.

Note:It is recommendable to retighten all fixing bolts and nuts after the SideStep has been in use for some 1000 km/600 miles.

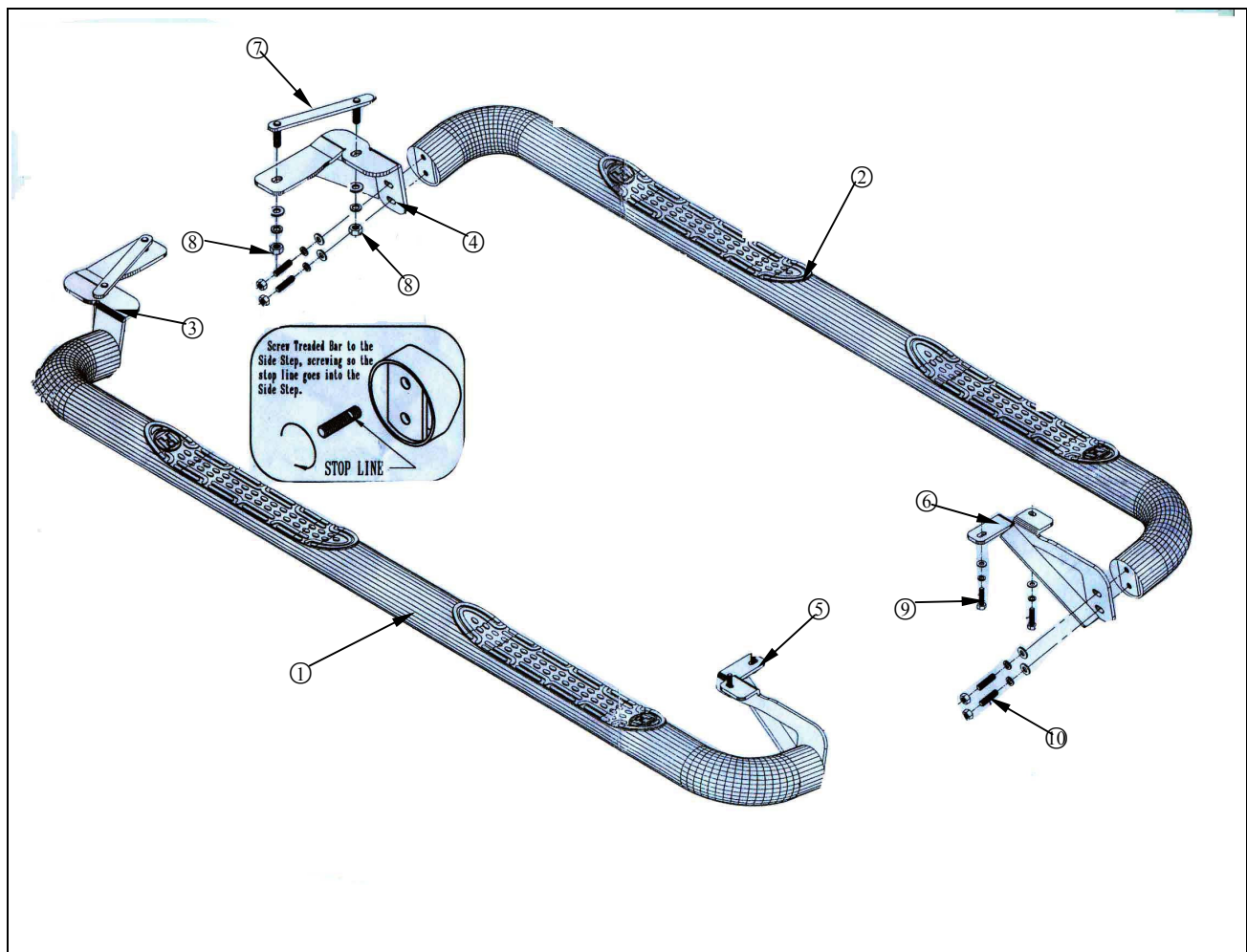

Picture for reference