



INSTALLATION INSTRUCTION

SPORT BAR PART #2550

2008-10 TOYOTA HIGHLANDER

ATTENTION

- λ Please read this installation Menu before installing this part. NOTE: Pictures are for reference only, actual parts may be different. Installation is the same.
- λ You may need to periodically to re-tighten all hardware, such as one month or two month.
- λ Please periodically check and retighten all the hardware and clean the investment for a refresh look.

PART LIST

NO.	NAME	QTY	REMARKS	NO.	NAME	QTY	REMARKS
①	Grille guard	1		⑨	Lock Washers	2	6mm
②	Bracket	2		⑩	Hex nut	2	M6
③	T-Bolt 1	2	M10×35	⑪	Hex bolt	4	M12×35
④	Big washer	2	10mm	⑫	Big washer	8	12mm
⑤	Lock Washers	2	10mm	⑬	Lock Washers	4	12mm
⑥	Hex nut	2	M10	⑭	Hex nut	4	M12
⑦	T-Bolt 2	2	M6×26	⑮	Plastic Clip	4	M10
⑧	Flat washer	2	6mm	⑯	Plastic Clip	2	M6

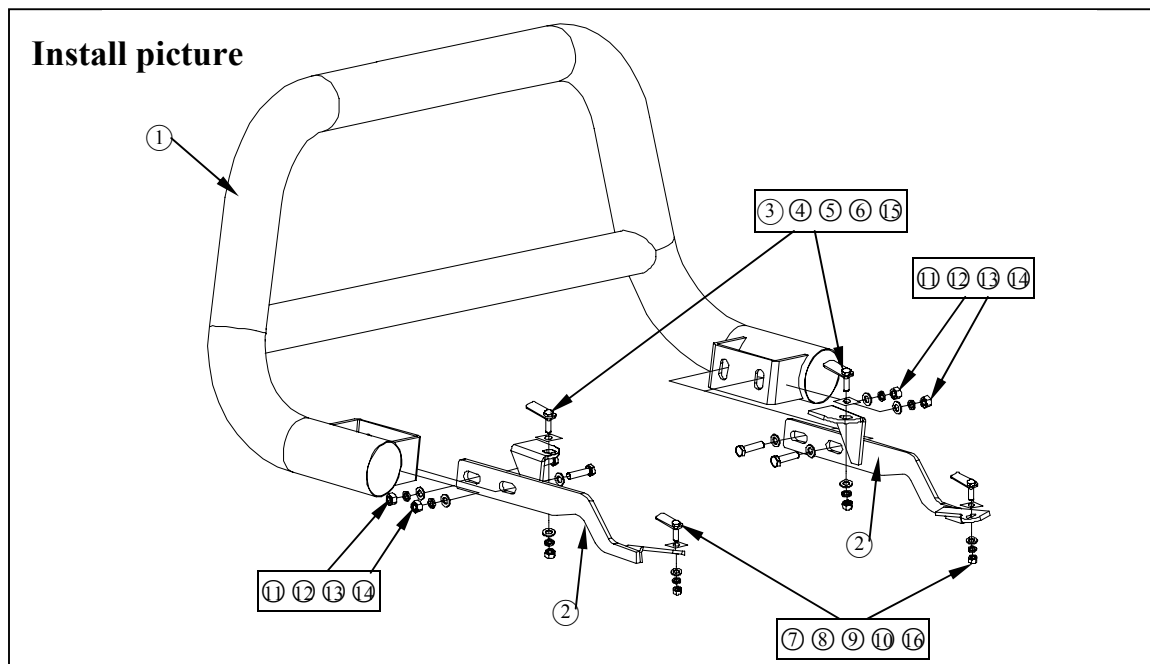



INSTALLATION INSTRUCTION

SPORT BAR PART #2550

TOYOTA HIGHLANDER 08

INSTALLATION STEPS

Step 1: Verify that all parts are present according to the manual.

Step 2: Remove the factory skid plate1 (Fig#1).

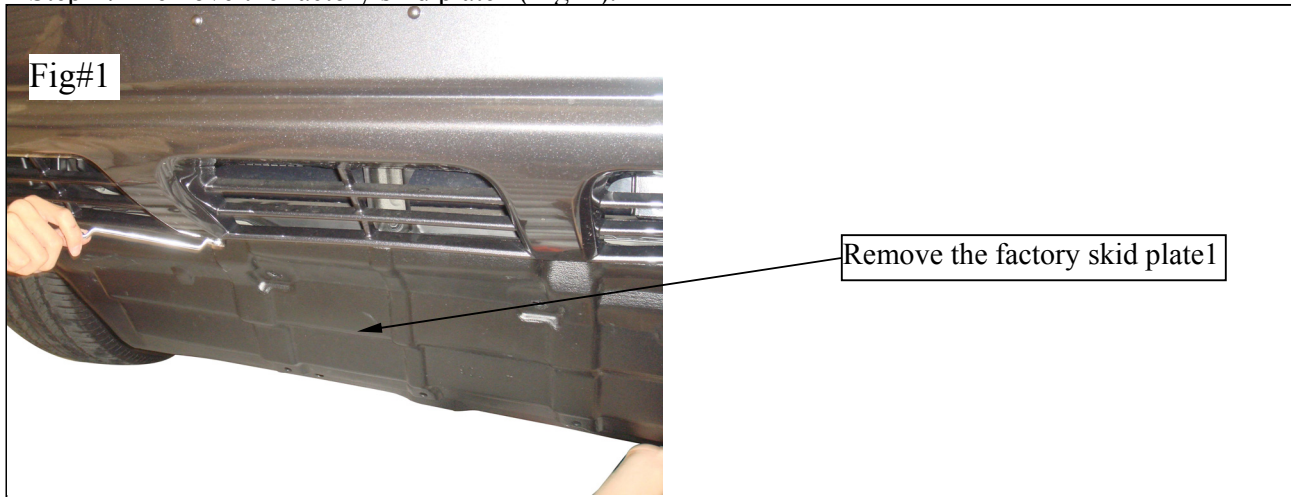

Step3: Install the L-bracket to the chassis using the ③ ④ ⑤ ⑥ ⑦ ⑧ ⑨ ⑩ ⑬ ⑯ of the vehicle as Fig#2.

1)、Remove the parts in the skid plate 2, open the skid plate 2(look the original hole).

2)、Install the T bolt2 through the original hole under the chassis, install the plastic clipM6 to the T bolt2 , Before install the bracket(Note: At the same time, install the T bolt1).

3)、Install the bracket to the chassis using the④ ⑤ ⑥ ⑧ ⑨ ⑩.

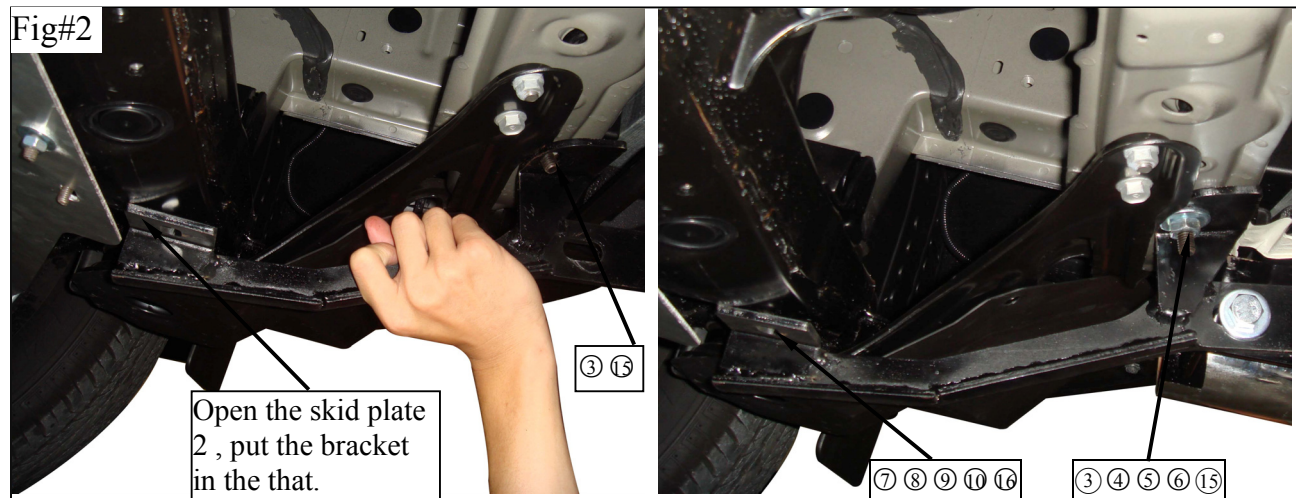

Step 4: Repeat step 2 、 3 for the R- bracket of vehicle to complete installation.

Step 5: Install the grille guard to the brackets using⑪ ⑫ ⑬ ⑭ as Install picture.

Step 6: Test and make sure that the grille guard is steadily fixed.

Step 7: Installation is finished .