



INSTALLATION INSTRUCTIONS
DOOR HANDLE COVER #5HAND
2006 HUMMER H3

PARTS LIST

5 LARGE HANDLE COVERS WITH ADHESIVE BACKING
5-SMALL HANDLE COVERS WITH ADHESIVE BACKING
PACKET OF ALCOHOL SWABS

1. FIRST MAKE SURE CONTENT IS COMPLETE.
2. START WITH BACK DOOR AND CLEAN HANDLE. MAKE SURE HANDLE IS FREE FROM LOOSE DEBRIS AND ANY FOREIGN SUBSTANCE. USE ALCOHOL SWABS AROUND ENTIRE SURFACE OF HANDLE.
3. REMOVE ADHESIVE FROM SMALL HANDLE COVER AND PLACE ACCURATELY OVER SMALL PORTION OF HANDLE. PRESS FIRMLY DOWN ON COVER ONCE IN LINE (SEE FIGURE ONE).
4. TAKE LARGE HANDLE COVER AND REMOVE ADHESIVE. LINE LARGER COVER WITH SMALL HANDLE (LINES MATCHING UP) AND PRESS DOWN THIS PORTION FIRST. ALLOW THE COVER TO COMPLETELY SLIDE OVER THE REMAINDER OF THE HANDLE WHILE HOLDING THE INITIAL PORTION DOWN (SEE FIGURE TWO).
5. REPEAT PROCESS ON REMAINING FOUR HANDLES.

FIGURE 1



FIGURE 2

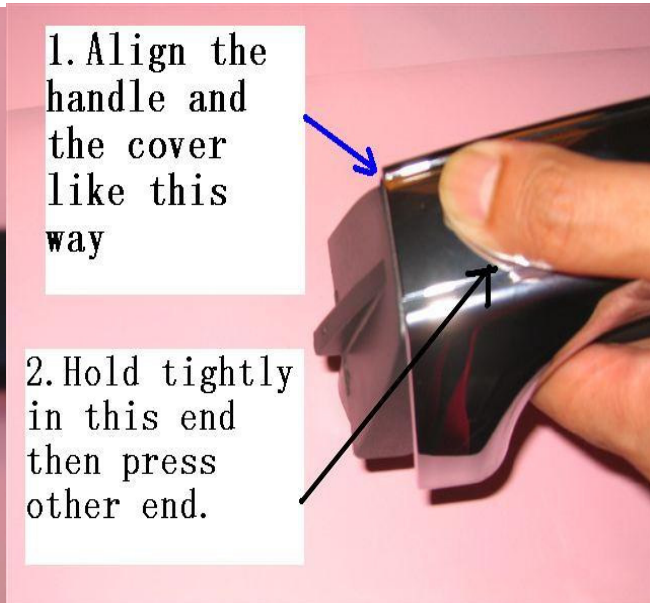

ENJOY YOUR NEW LOOK! 888-800-2743.