



# X-INTAKE AIRBOX KIT

The BD X-Intake Air Stainless Steel Intake is designed to allow for maximum airflow through the intake for quicker throttle response, lower exhaust temperatures and increased power output. If your engine breathes better, it will perform better.

BD's polished stainless steel intake box looks and works great combined with a performance free-flowing air filter. Give your diesel engine that unrestricted airflow it needs to put all that pure diesel power to the wheels.

Application	BD Part #	
Dodge Ram 1994-2002	1041050	Pages 2-5
Dodge Ram 2003-2007	1041053	Pages 6-7
Dodge Ram 2003-2007 (w/ Flow Adapter)	1041055	Pages 6-7
Ford Powerstroke 1999½-2003 (7.3L)	1041070	Pages 8-9
GMC/Chevrolet Duramax LB7	1041060	Pages 10-11
GMC/Chevrolet Duramax LLY	1041065	Pages 10-11

*Kit Includes: Filter, Filter Box & Clamp.*

# **DODGE RAM (1994-2002) INSTALLATION**



Remove the air cleaner box to turbo inlet hose.

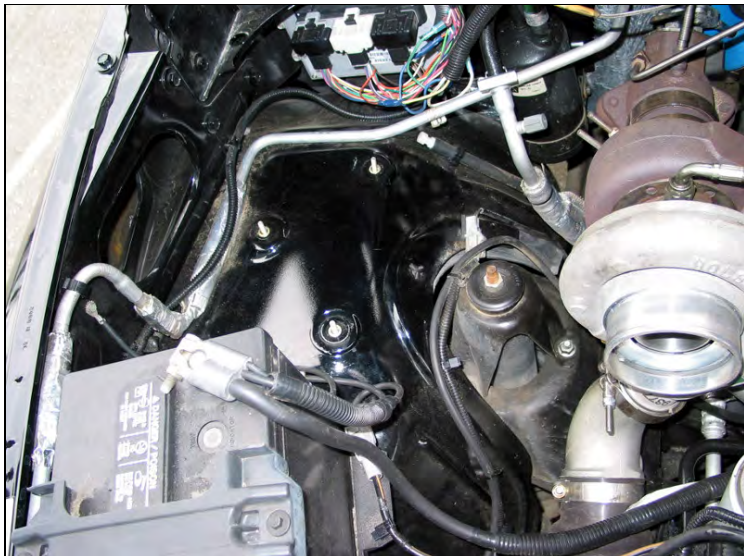

Lift the airbox off of the support stands to remove.



Remove the rubber stands/grommets from the bottom of the OEM airbox.





These stands are constructed of two (2) pieces.



Separate stands from grommets.

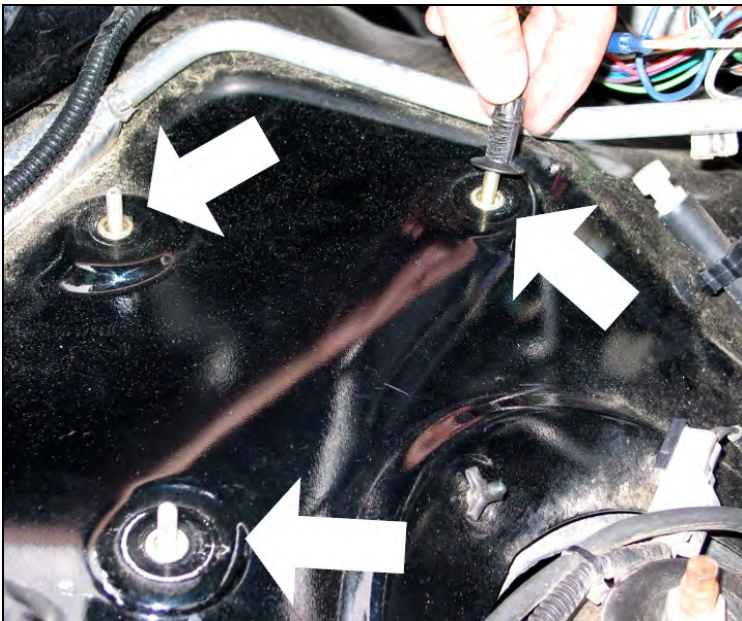

Place the stands on the mounting bolts in the fender.

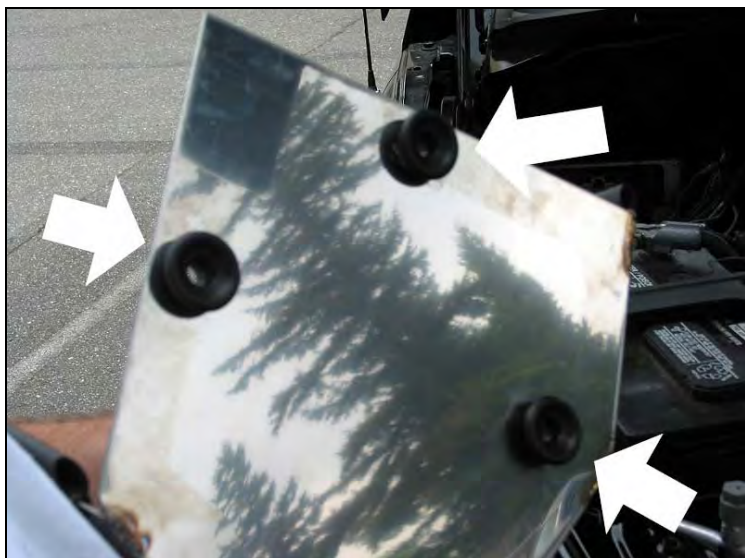

Install the grommets into the holes on the bottom of the X-Intake Airbox.



Follow the manufacturer's instructions to prepare the air filter element and then install it on X-Intake Airbox housing (as shown in the picture to the left) and secure with the filter hose clamp.



Insert the turbo inlet hose onto X-Intake Airbox housing as shown.

**NOTE:** This will require a considerable amount of force; a small amount of lube will ease installation.





Line up the grommets on the base of the X-Intake Airbox with the stands on the fender and push down ensuring the base is secure on the mount stands.



Install the air hose to the turbocharger and tighten all clamps.

**\*\*\*NOTE\*\*\*:**

The OEM filter minder is not installed with this application. Save all parts from the OEM filter and airbox for re-installation at a later date if desired.

## ***DODGE RAM (2003-07) INSTALLATION***

**\*\*\* CAUTION- Disconnect the battery before beginning this procedure! \*\*\***

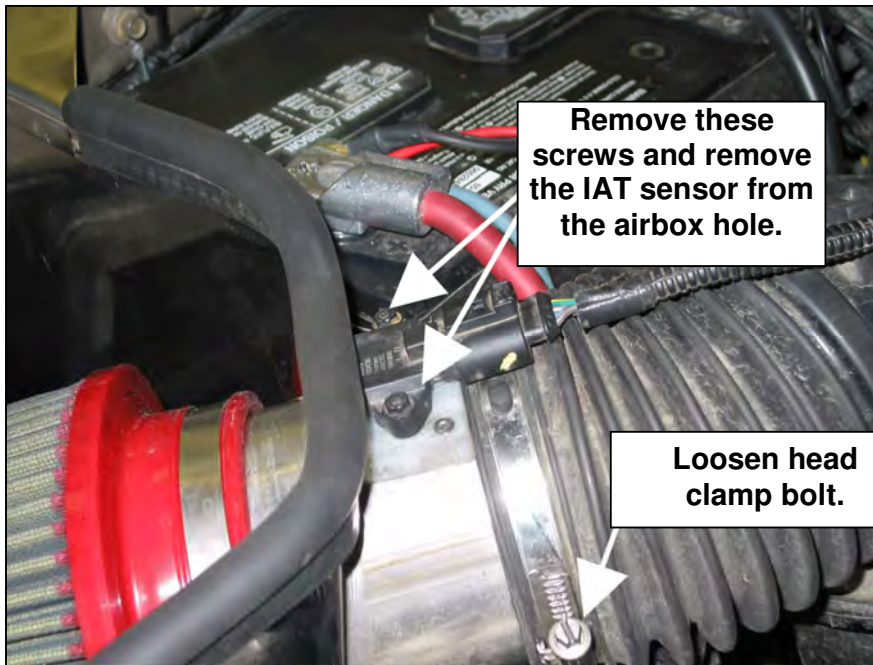

Remove these screws and remove the IAT sensor from the airbox hole.

Loosen head clamp bolt.

Loosen the band clamp and remove the air inlet hose from the stock airbox.

Remove the Intake Air Temperature (I.A.T.) Sensor & harness and retain the factory screws for later use with X-Intake system.

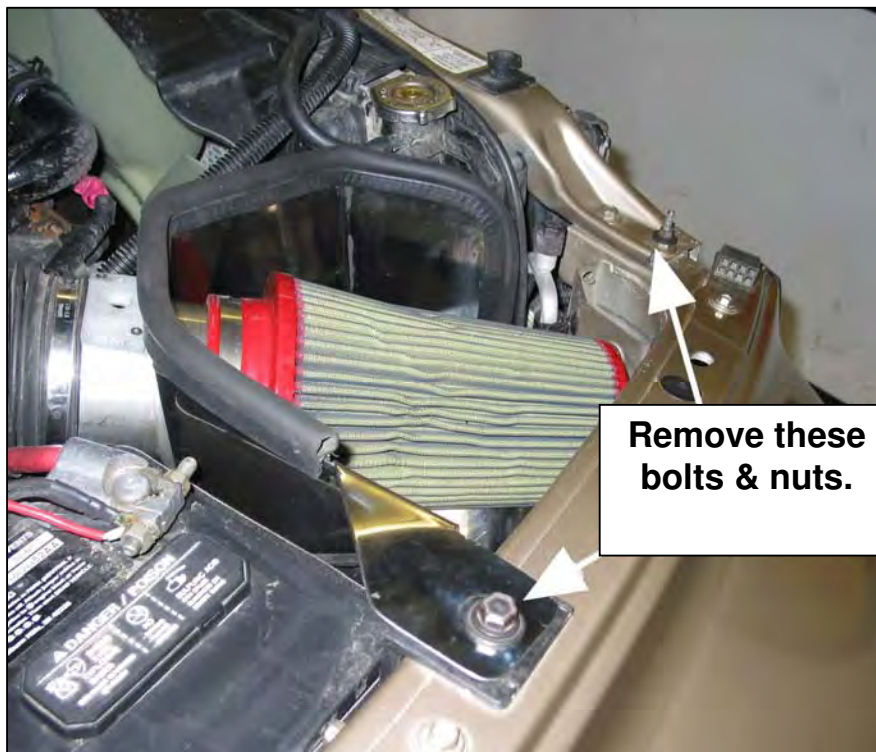

Remove these bolts & nuts.

Remove the airbox retaining nut and lift the airbox off of the support stand to remove.

\*\*Removal of the battery tray bolt may be done at this time also, or once the factory airbox has been removed.

Install the supplied air filter onto the X-Intake airbox. **This WILL NOT be possible once the airbox has been installed into the vehicle.**

BD Engine Brake Inc.

Plant Address: Unit A10, 33733 King Rd, Abbotsford, BC, Canada V2S 7M9

U.S. Shipping Address: 88-446 Harrison St, Sumas, WA 98295 U.S. Mailing Address: P.O. Box 231, Sumas, WA 98295

Phone: 604-853-6096 Fax: 604-853-8749 Internet: [www.bd-power.com](http://www.bd-power.com)





Mount the airbox into the opening.

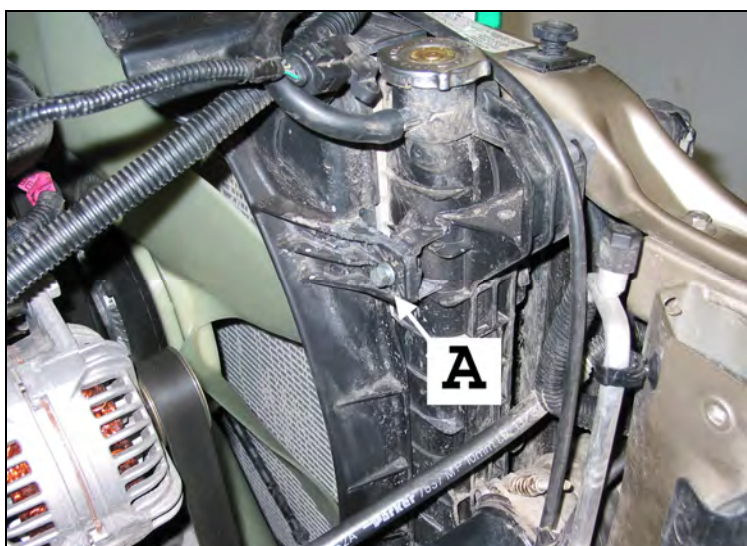

Remove the factory bolt and install the supplied Fan Shroud Support (A) bolt. Re-use the Battery Tray bolt and tighten snugly.

**\*\*DO NOT OVER TIGHTEN!!**



Insert the Intake Air Temperature (IAT) Sensor into the hole on top of the X-Intake airbox and re-fasten using the factory screws.

Install the air inlet hose onto X-Intake opening and tighten clamp securely.

**NOTE:** The OEM Filter minder is not installed with this application. Save all parts from the OEM filter and box for re-installation at a later date if desired.

BD Engine Brake Inc.

Plant Address: Unit A10, 33733 King Rd, Abbotsford, BC, Canada V2S 7M9

U.S. Shipping Address: 88-446 Harrison St, Sumas, WA 98295 U.S. Mailing Address: P.O. Box 231, Sumas, WA 98295

Phone: 604-853-6096 Fax: 604-853-8749 Internet: [www.bd-power.com](http://www.bd-power.com)

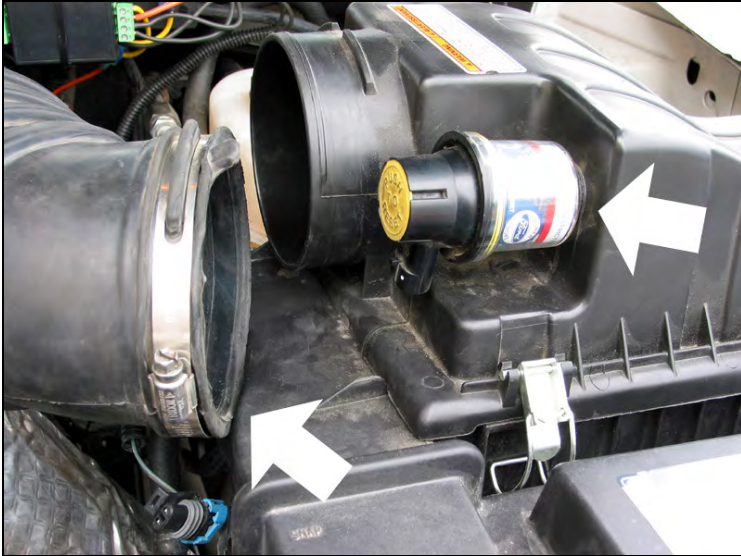
**FORD 7.3L POWERSTROKE (1999½-2003) INSTALLATION**

Remove the air inlet hose from the airbox.

Remove the filter minder and grommet from the OEM airbox.



On the firewall side of the OEM airbox, there is an Intake Air Temperature (IAT) Sensor. Twist and remove it from the airbox.

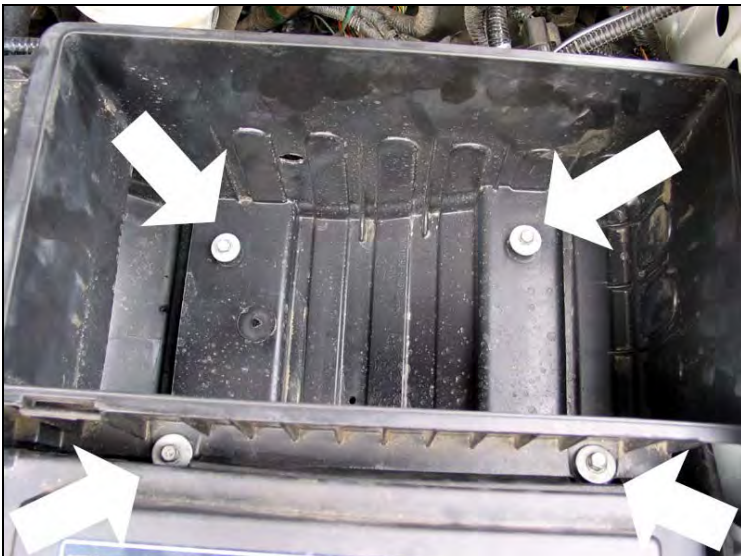

Remove the OEM air filter and then remove the four (4) mounting bolts that hold the OEM airbox in place.

BD Engine Brake Inc.

Plant Address: Unit A10, 33733 King Rd, Abbotsford, BC, Canada V2S 7M9

U.S. Shipping Address: 88-446 Harrison St, Sumas, WA 98295 U.S. Mailing Address: P.O. Box 231, Sumas, WA 98295

Phone: 604-853-6096 Fax: 604-853-8749 Internet: [www.bd-power.com](http://www.bd-power.com)





Install the X-Intake Airbox into place and secure with the two factory mounting bolts. The two bolts near the battery are **NOT** re-used.

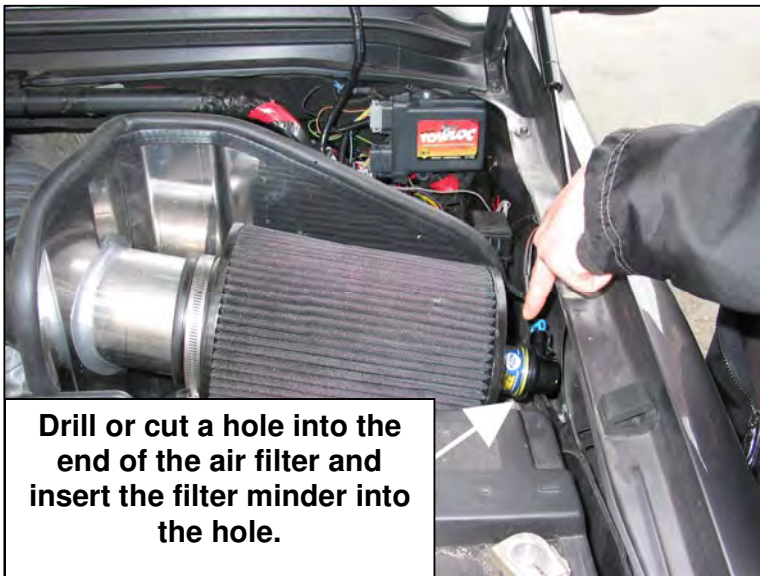

Install the air sensor into the hole on firewall side of the X-Intake Airbox.

Follow the manufacturer's direction to prepare the air filter element and then install it on X-Intake Airbox housing as shown and secure with the filter hose clamp.

**\*\*\*NOTE\*\*\*:**

Save all parts from the OEM filter and box for reinstallation at a later date if desired.

**GMC/CHEVY w/DURAMAX DIESEL (LB7 & LLY ENGINES)**

Remove the air inlet hose and airflow sensor.



Remove the airbox from the fender well.

NOTE: The OEM airbox is secured using stands and grommets. To remove, just lift out airbox.

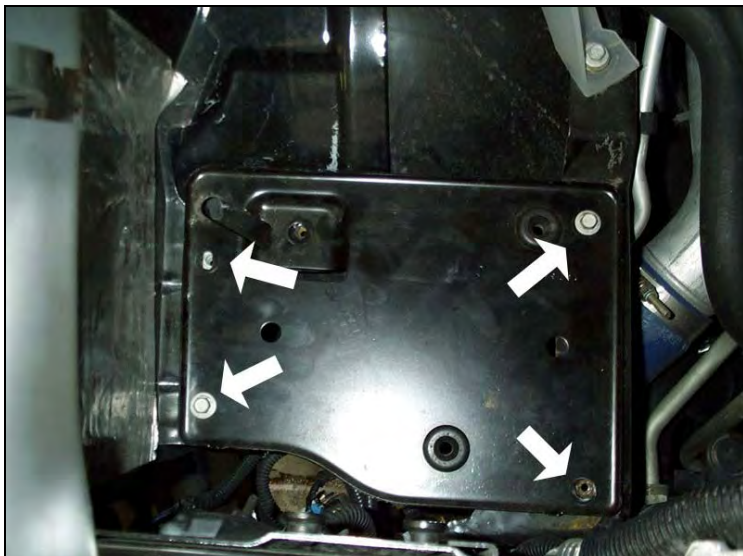

Remove four (4) bolts securing the airbox tray in place.

BD Engine Brake Inc.

Plant Address: Unit A10, 33733 King Rd, Abbotsford, BC, Canada V2S 7M9

U.S. Shipping Address: 88-446 Harrison St, Sumas, WA 98295 U.S. Mailing Address: P.O. Box 231, Sumas, WA 98295

Phone: 604-853-6096 Fax: 604-853-8749 Internet: [www.bd-power.com](http://www.bd-power.com)





Install the splash shield supplied in the kit to the front support and secure with the bolt provided.



Install the X-Intake Airbox in place and secure with four (4) mounting bolts.



Install the airflow sensor and secure in place. Install the air inlet hose and secure with the hose clamp.

Follow manufacturer's directions to prepare the air filter element and then install it on X-Intake Airbox housing as shown and secure with hose clamp.

**\*\*\*NOTE\*\*\*:** Although shown in this picture, current X-Intake models DO NOT re-use the OEM supplied Filter Minder. Save all the parts from the OEM filter and box for reinstallation at a later date if desired.