



**Thank you for purchasing a Borla Performance Cat-Back™ Exhaust System.**

Precision manufactured using aircraft quality T-304 stainless steel; this system is designed to endure years of heavy use. Installing a Borla Performance Exhaust System on your vehicle will eliminate the restrictive design of the stock exhaust, allowing your engine to discharge exhaust gas easier. The result is more horsepower and torque, longer engine life, and a distinctive throaty growl- all this, with easy bolt-on installation. These installation instructions have been written to help you in the installation of your Borla Performance Exhaust System. Please read it completely before installing your system.

**This Borla Performance Cat-Back™ Exhaust System (Part number 140003) has been designed for the 2002-2004 Chevrolet Avalanche equipped with two or four-wheel drive a 5.3L V8 engine and automatic transmission.**

Borla Performance Industries recommends that an exhaust shop or professional after market parts installer, who has all the necessary equipment, tools and experienced personnel needed for proper installation, should perform the installation of this system. However, if you decide to perform the installation, we recommend someone should help you. Ensure the installer uses all under car safety precautions including eye protection.

***Please take time to read and understand the following...***

By installing your Borla Performance Exhaust System, you indicate that you have read this document and you agree with the terms stated below.

It is the responsibility of the purchaser to follow all installation instruction guidelines and safety procedures supplied with your Borla Performance Exhaust System.

Borla Performance Industries assumes no responsibility for damages occurring from misuse, abuse, improper installation, improper operation, lack of responsible care, or all previously stated reasons resulting from incompatibility with other manufacturer's products and/or systems.

Included with your Borla Performance Exhaust System is a warranty card. Please read it carefully before you begin any work on your vehicle. If you should have any questions regarding our warranty policy, installation, or any other matter pertaining to your new Borla Performance Exhaust System, please give us a call at the number provided on the warranty card.

## Borla Performance Cat-Back™ Bill of Materials

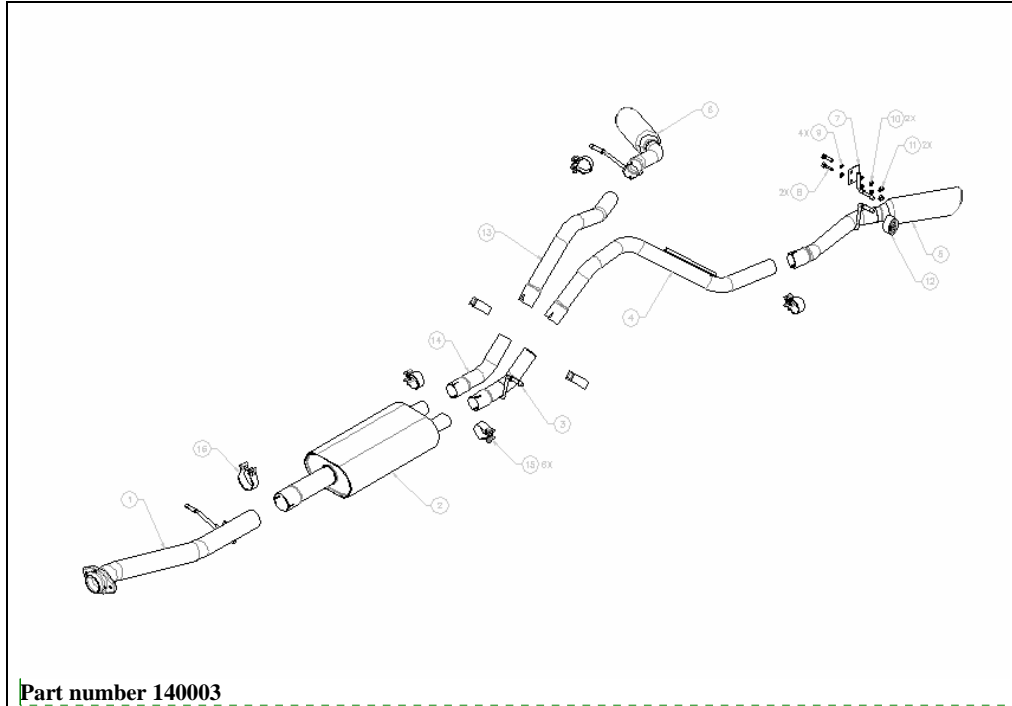

Part number 140003

Comment [J1]: Part number 14945

1. Front pipe assembly
2. Muffler assembly
3. Left muffler outlet pipe
4. Left intermediate pipe
5. Left tail pipe assembly
6. Right tail pipe assembly
7. Hanger assembly
8. Bolt (qty 2)
9. Flat washer (qty 4)
10. Lock washer (qty 2)
11. Hex nut (qty 2)
12. Rubber bracket
13. Right intermediate pipe
14. Right muffler outlet pipe
15. 2.25" Accuseal™ clamp (qty 6)
16. 3.00" Accuseal™ clamp

**Caution!!! Never work on a hot exhaust system. Serious injury in the form of burns can result** If the vehicle has been in use and the exhaust system is hot, allow vehicle to cool for at least 1 hour. Always wear eye protection when working under any vehicle.

*Note: It is our recommendation that you use a hoist or hydraulic lift to facilitate the installation of your new Borla Performance Cat-Back™ Exhaust System.*

Taking all under car safety precautions, lift the vehicle using a hoist or hydraulic lift. Once this has been done, you may begin the removal of your old exhaust system from your vehicle.

*Note: Before removing the original exhaust system from your vehicle, please compare the parts you have received with the bill of materials provided on the previous page to assure that you have all the parts necessary for the installation of your new Borla Performance Cat-Back™ Exhaust System.*

## Original Exhaust System Removal

*Note: With a used vehicle, we suggest a penetrating spray lubricant to be applied liberally to all exhaust fasteners and allowing a significant period of time for the chemical to lubricate the threads before attempting to disassemble.*

1. Unbolt flange shown in figure 1 in front of muffler assembly.
2. Using a reciprocating saw or a hacksaw, cut the exhaust just behind the muffler assembly as shown in figure 2.

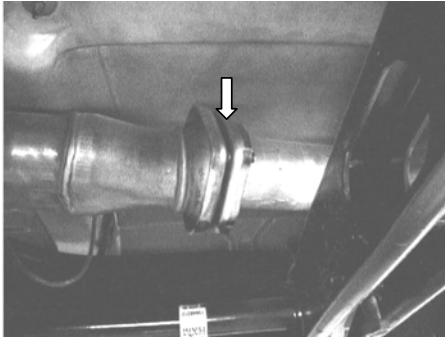

**Figure 1**



**Figure 2**

3. Lubricate all hangers and rubber brackets.
4. Remove hanger located on tail pipe assembly from rubber bracket and remove tail pipe assembly from vehicle.
5. Using a muffler stand or an additional person to hold the remaining exhaust system in place, remove all hangers from the rubber brackets and remove the old exhaust system from the vehicle.

## Borla Performance Cat-Back™ Exhaust System Installation

**Warning:** Use extreme caution during installation. Torque all fasteners according to manufacturer's torque values and tightening sequence. DO NOT use air impact tools to tighten fasteners on Borla Performance Exhaust Systems. Use of such tools may result in bent flanges or gasket contact areas leading to exhaust leaks.

1. Place the front pipe into position as shown in figure 3 using the original hardware to secure the flange. Install the hanger into the rubber bracket.
2. Place a clamp over the expanded end of the muffler assembly and place it into position as shown also in figure 4. DO NOT tighten the clamp.

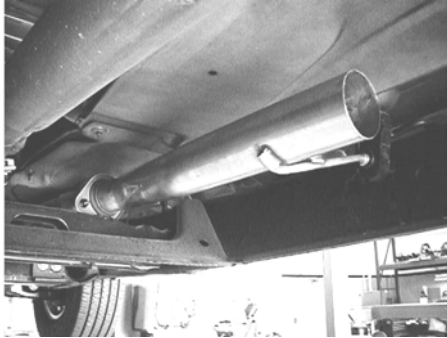

Figure 3

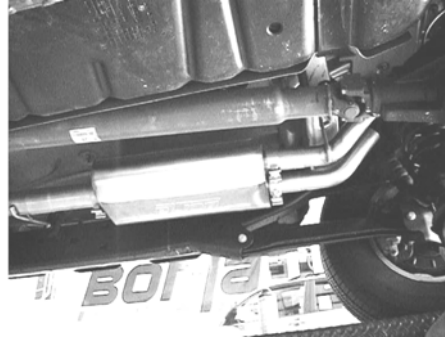

Figure 4

3. Place a clamp over each expanded end of both left and right muffler outlet pipes and place them into position as shown in figure 5. Install hanger on left muffler outlet pipe into rubber bracket. DO NOT tighten the clamps.
4. Place a clamp over the expanded end of both left and right over axle pipes and place into position. DO NOT tighten the clamps.
5. Using the hardware provided, install hanger assembly on driver side of vehicle just behind rear tire as shown in figure 6.

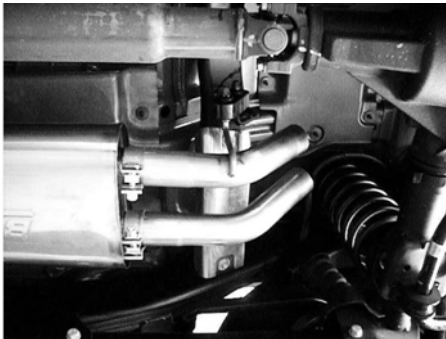

Figure 5

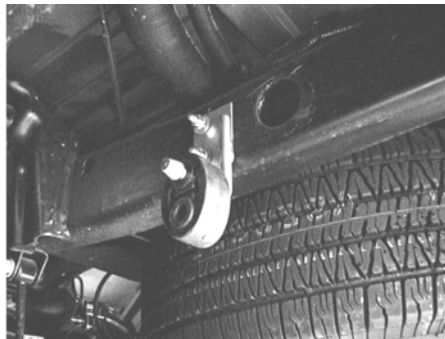

Figure 6

6. Place a clamp over the expanded end of left and right tail pipe assemblies. Place into position and install hangers into rubber brackets.
7. Check your exhaust system for proper clearance under the vehicle and also for tip alignment.

8. Once position has been determined to be correct, tighten the Accuseal™ clamps to 32-35 ft. lbs. working from the front of the vehicle to the rear.
9. Before starting your vehicle, make sure to check all wires, hoses, brake lines, body parts and tires for safe clearance from the exhaust system.
10. Start vehicle and check for any leaks. If any leaks are found, determine cause (such as loose or incorrectly positioned clamp) and repair as necessary.

*Note: When you first start your vehicle after the installation of your new Borla Performance Exhaust System, there may be some smoke and fumes coming from the system. This is a protective oil based coating used in the manufacturing of mandrel bent performance exhaust tubing. This is not a problem and will disappear within a very short period of time after the exhaust has reached normal operating temperatures.*



**Congratulations!!!** You have completed the installation of the world famous Borla Performance Stainless Steel Exhaust System.