



Thank you for purchasing a Borla Performance™ Cat-back™ Exhaust System.

Precision manufactured using aircraft quality T-304 stainless steel; this system is designed to endure years of heavy use. Installing a Borla Performance™ Exhaust System on your vehicle will eliminate the restrictive design of the stock exhaust, allowing your engine to discharge exhaust gas easier. The result is more horsepower and torque, longer engine life, and a distinctive throaty growl- all this, with easy bolt-on installation. These installation instructions have been written to help you in the installation of your Borla Performance™ Exhaust System. Please read it completely before installing your system.

This Borla Performance™ Cat-back™ Exhaust System (Part number 140130) has been designed for the 2004 BMW 745I equipped with a 4.5L V-8 engine and an automatic transmission.

Borla Performance™ Industries recommends that an exhaust shop or professional after market parts installer, who has all the necessary equipment, tools and experienced personnel needed for proper installation, should perform the installation of this system. However, if you decide to perform the installation, we recommend someone should help you. Ensure the installer uses all under car safety precautions including eye protection.

Please take time to read and understand the following...

By installing your Borla Performance™ Exhaust System, you indicate that you have read this document and you agree with the terms stated below.

It is the responsibility of the purchaser to follow all installation instruction guidelines and safety procedures supplied with your Borla Performance™ Exhaust System

Borla Performance™ Industries assumes no responsibility for damages occurring from misuse, abuse, improper installation, improper operation, lack of responsible care, or all previously stated reasons resulting from incompatibility with other manufacturer's products and/or systems.

Included with your Borla Performance™ Exhaust System is a warranty card. Please read it carefully before you begin any work on your vehicle. If you should have any questions regarding our warranty policy, installation, or any other matter pertaining to your new Borla Performance™ Exhaust System, please give us a call at the number provided on the warranty card.

Borla Performance™ Cat-back™ Bill of Materials

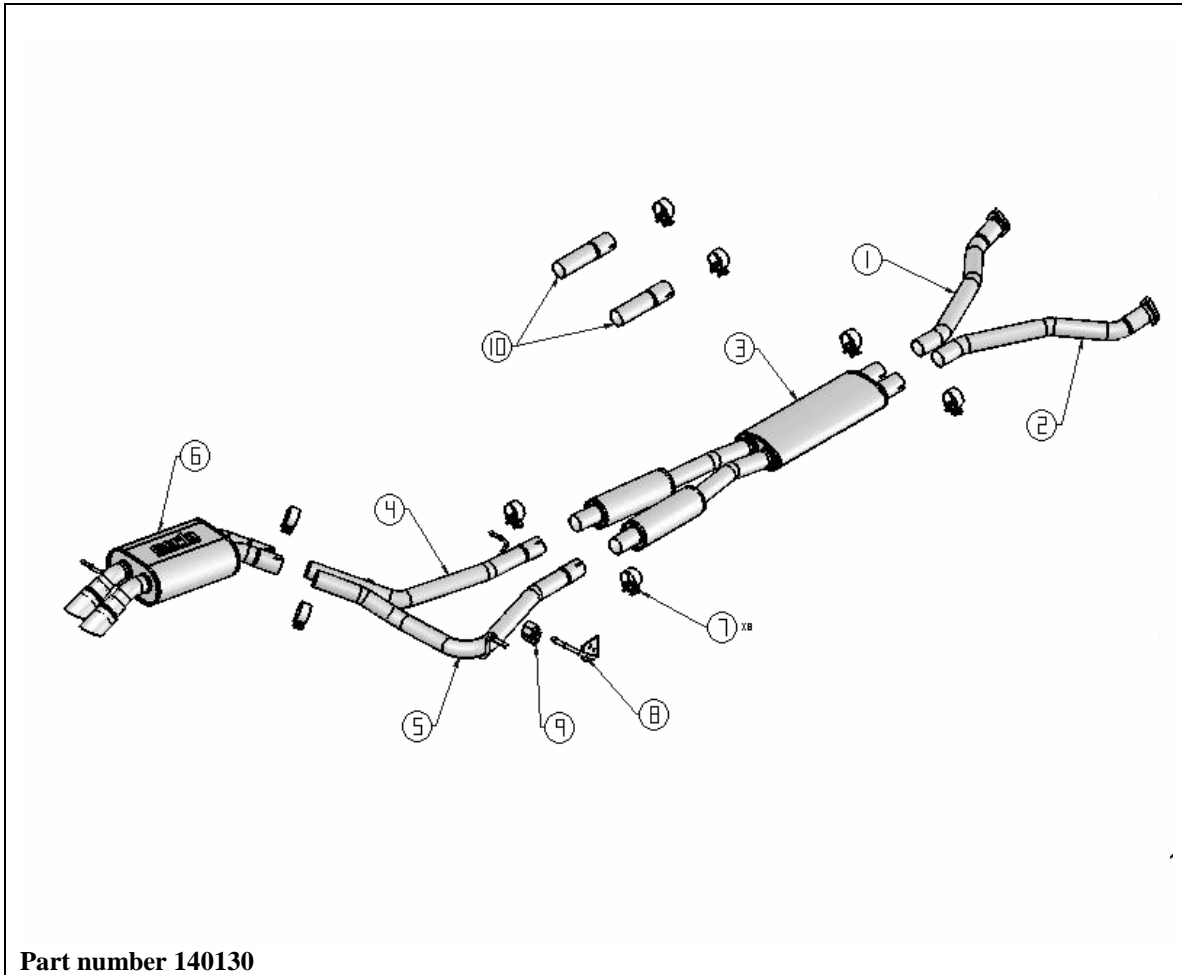

Part number 140130

1. Left front pipe assembly
2. Right front pipe assembly
3. Front muffler assembly
4. Left mid pipe assembly
5. Right mid pipe assembly
6. Rear muffler assembly
7. 2.25" Accuseal clamp (qty 8)
8. Bracket/Hanger assembly
9. Rubber isolator
10. Extension pipe (For IL models only)

Caution!!! Never work on a hot exhaust system. Serious injury in the form of burns can result If the vehicle has been in use and the exhaust system is hot, allow vehicle to cool for at least 1 hour. Always wear eye protection when working under any vehicle.

Note: It is our recommendation that you use a hoist or hydraulic lift to facilitate the installation of your new Borla Performance™ Cat-back™ Exhaust System.

Taking all under car safety precautions, lift the vehicle using a hoist or hydraulic lift. Once this has been done, you may begin the removal of your old exhaust system from your vehicle.

Note: Before removing the original exhaust system from your vehicle, please compare the parts you have received with the bill of materials provided on the previous page to assure that you have all the parts necessary for the installation of your new Borla Performance™ Cat-back™ Exhaust System.

Original Exhaust System Removal

Note: With a used vehicle, we suggest a penetrating spray lubricant to be applied liberally to all exhaust fasteners and allowing a significant period of time for the chemical to lubricate the threads before attempting to disassemble.

1. Unbolt and remove the center support bracket shown in figure 1 located just in front of the center muffler.
2. Remove the vacuum line from the valve shown in figure 2 located at the rear of the vehicle. Insert the barbed plug provided with your system into the vacuum line.

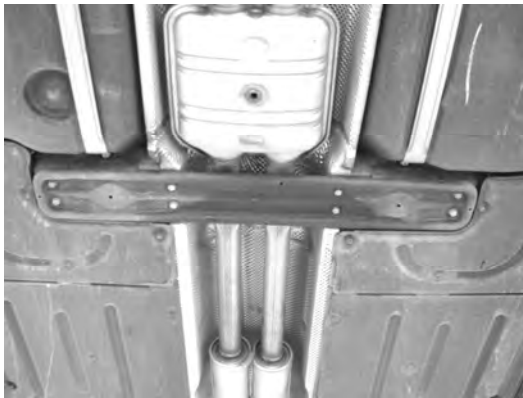

Figure 1



Figure 2

3. Unbolt the flanges shown in figure 3 located just behind the catalytic converters.
4. Lubricate all hangers and rubber isolators.
5. Using a muffler stand or an additional person to hold the exhaust system up in position, remove all the hangers from the rubber isolators and remove the entire exhaust system shown in figure 4 from the vehicle.

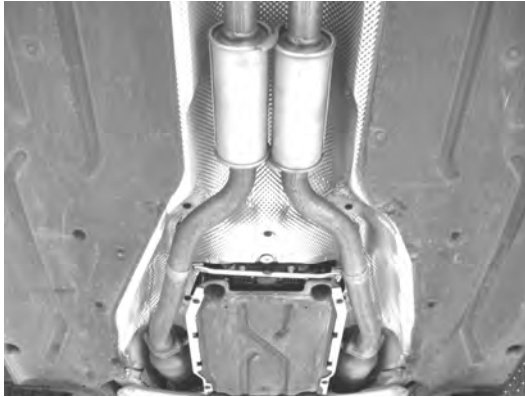

Figure 3

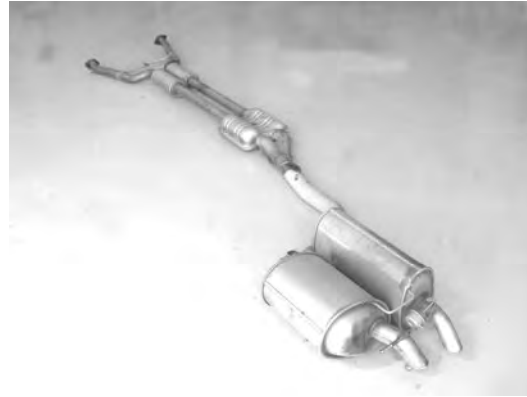

Figure 4

6. Unbolt and remove the support hanger/bracket assembly also shown in figure 3 from the original exhaust system and set aside for use during the installation of your new Borla Performance Cat-Back exhaust system.

Borla Performance™ Cat-back™ Exhaust System Installation

Warning: Use extreme caution during installation. Torque all fasteners according to manufacturer's torque values and tightening sequence. **DO NOT** use air impact tools to tighten fasteners on Borla Performance™ Exhaust Systems. Use of such tools may result in bent flanges or gasket contact areas leading to exhaust leaks.

1. Install the support hanger/bracket assembly on to the left and right front pipe assemblies. Using the hardware supplied and the original gaskets, place the front pipe assemblies up into position as shown in figure 5. Secure the hardware to the vehicle manufacturer's specifications.
2. For IL models, place a clamp over the expanded end of each extension pipe and place them into position just behind the front pipe assemblies. **DO NOT** tighten the clamps.
3. Place a clamp over the expanded ends of the front muffler assembly and place it into position as shown in figure 6. **DO NOT** tighten the clamps. Using the original hardware, install the center support bracket also shown in figure 6.

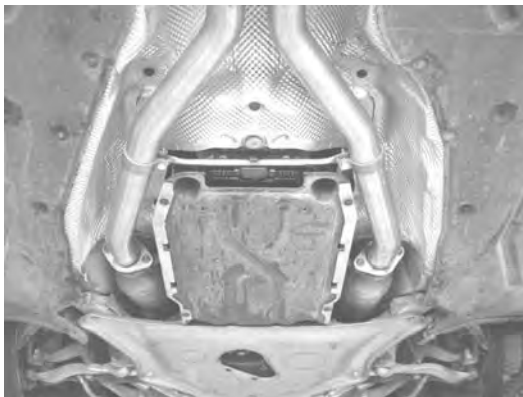

Figure 5



Figure 6

- Using the hardware supplied, install the bracket/hanger assembly on the passenger side of vehicle just above the control arm nut as shown in figure 7. Install the rubber isolator supplied with your system onto the hanger/bracket assembly.
- Place a clamp over the expanded end of left and right over axle pipes and place them into position as shown in figure 8. Make sure to install the hangers into the rubber isolators. **DO NOT** tighten the clamps. **DO NOT** tighten the clamps.



Figure 7



Figure 8

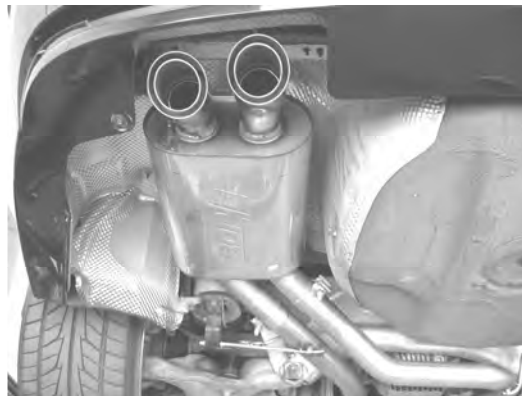

Figure 9

- Check your exhaust system for proper clearance under the vehicle and also for tip alignment.
- Once position has been determined to be correct, tighten the Accuseal™ clamps to 32-35 ft. lbs. working from the rear of the vehicle to the front.
- Before starting your vehicle, make sure to check all wires, hoses, brake lines, body parts and tires for safe clearance from the exhaust system.
- Start vehicle and check for any leaks. If any leaks are found, determine cause (such as loose or incorrectly positioned clamp) and repair as necessary.

Note: When you first start your vehicle after the installation of your new Borla Performance™ Exhaust System, there may be some smoke and fumes coming from the system. This is a protective oil based coating used in the manufacturing of mandrel bent performance exhaust tubing. This is not a problem and will disappear within a very short period of time after the exhaust has reached normal operating temperatures.



Congratulations!!! You have completed the installation of the world famous Borla Performance Stainless Steel Exhaust System.