

Shelby GT500 Exhaust System Installation PN-140210



These instructions have been written to help you with the installation of your Borla Performance Exhaust System. Please read this document completely before beginning the installation of your system.

Please compare the parts in the box with the bill of materials provided to assure that you have all the parts necessary for this installation.

To ensure this part number fits your specific model year, please visit our website for the latest model year listings at www.BORLA.com.

Thank you for purchasing a Borla Performance Cat-Back™ Exhaust System.

This Borla Performance Cat-Back™ Exhaust System (Part number 140210) has been designed for the Shelby GT500 equipped with a 5.4L Supercharged V8 engine and a manual transmission.

Borla Performance Industries recommends that an exhaust shop or professional after market parts installer perform the installation of this system. However, if you decide to perform the installation on your own it is recommended that two people are used. This installation should not be performed by one person due to the risk of injury. Ensure the installers use all under car safety precautions including eye protection.

Please take time to read and understand the following...

By installing your Borla Performance Cat-Back™ Exhaust System, you indicate that you have read this document and you agree with the terms stated below.

It is the responsibility of the purchaser to follow all installation instruction guidelines and safety procedures supplied with your Borla Performance Cat-Back™ Exhaust System.

Borla Performance Industries assumes no responsibility for damages occurring from misuse, abuse, improper installation, improper operation, lack of responsible care, or all previously stated reasons resulting from incompatibility with other manufacturer's products and/or systems.

Included with your Borla Performance Cat-Back™ Exhaust System is a warranty card. Please read it carefully before you begin any work on your vehicle. If you should have any questions regarding our warranty policy, installation, or any other matter pertaining to your new Borla Performance Cat-Back™ Exhaust System, please give us a call at the number provided on the warranty card.

Minimum Required Tool List:

TOOLS:

- 1 3/8" Drive Ratchet
- 2 3/8" Drive Extension 3"
- 3 15mm Socket
- 4 Pry Bar
- 5 Flat blade screwdriver
- 6 Tape measure
- 7 Marker
- 8 Reciprocating saw or pipe cutter

SHOP SUPPLIES:

- 1 Spray Lubricant

Borla Performance Cat-Back™ Bill of Materials

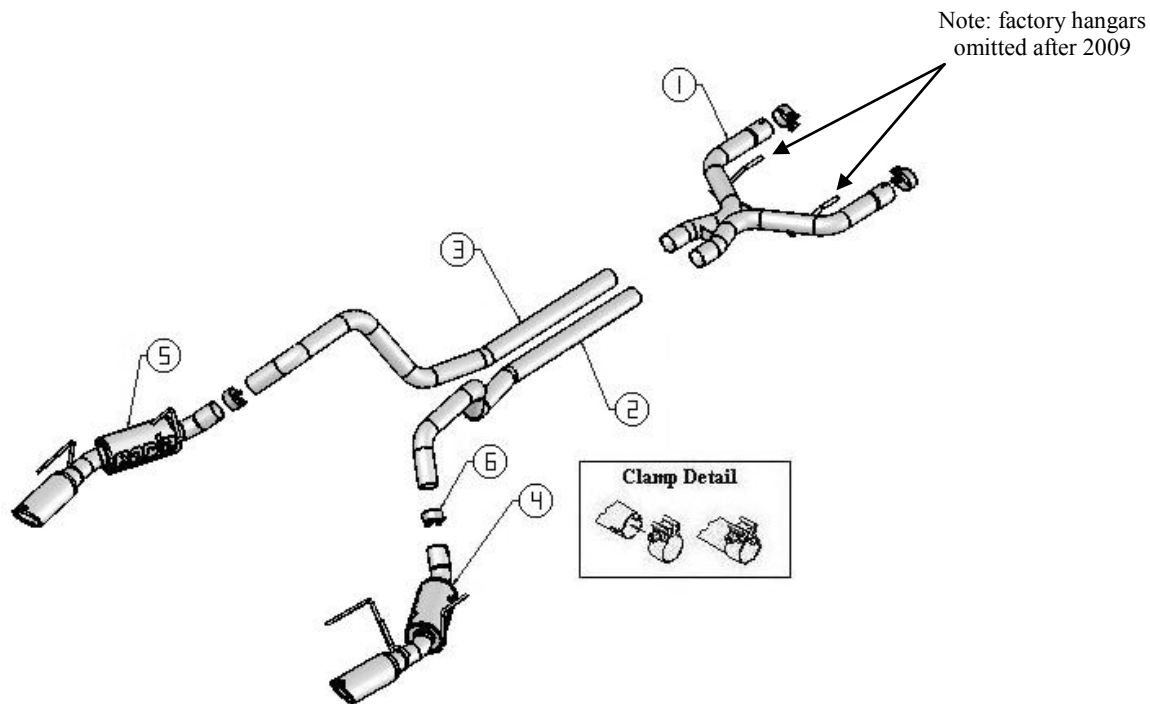

1. X- pipe assembly
2. Right over axle pipe
3. Left over axle pipe
4. Right muffler assembly
5. Left muffler assembly
6. 2.50" clamp (qty 4)

Caution!!! Never work on a hot exhaust system. Serious injury in the form of burns can result If the vehicle has been in use and the exhaust system is hot, allow vehicle to cool for at least 1 hour. Always wear eye protection when working under any vehicle.

Note: It is our recommendation that you use a hoist or hydraulic lift to facilitate the installation of your new Borla Performance Cat-Back™ Exhaust System .

Taking all under car safety precautions, lift the vehicle using a hoist or hydraulic lift. Once this has been done, you may begin the removal of your original exhaust system from your vehicle.

Note: Before removing the original exhaust system from your vehicle, please compare the parts you have received with the bill of materials provided on the previous page to assure that you have all the parts necessary for the installation of your new Borla Performance Cat-Back™ Exhaust System.

Original Exhaust System Removal

Note: With a used vehicle, we suggest a penetrating spray lubricant to be applied liberally to all exhaust fasteners and allowing a significant period of time for the chemical to lubricate the threads before attempting to disassemble.

1. Loosen the clamps shown in figure 1 located just behind the h-pipe.
2. Loosen the clamps shown in figure 2 located just in front of each muffler assembly.
3. Beginning with the left (driver) side, using a flat blade screwdriver, pull the clip as shown in figure 3 to disengage it from the pipe.
4. Remove the left (driver) side over axle pipe shown in figure 4 by removing the front of the pipe first then sliding it out of the muffler assembly. Remove the original clamp and set it aside for use during the installation of your new exhaust system.
5. Repeat steps 3 and 4 for the removal of the right side over axle pipe.
6. Remove the left (driver) side muffler from the vehicle. Remove the right (passenger) side muffler assembly.
7. Front-pipe removal:
(Use Figure 5A if front pipes have hangars): Measure and mark a line 1” on front pipe in front of hangar.
(Use Figure 5B if front pipes do not have hangars): Measure and mark a 10” line on front pipe after the catalytic converter.
 Using a reciprocating saw or a chain style pipe cutter, cut the pipes as marked. Remove original H-Pipe from assembly. De-bur the inside and outside of the pipes.
8. Using a reciprocating saw or a chain style pipe cutter, cut the pipes where marked.
9. Remove the original H-Pipe assembly from the vehicle
10. De bur the inside and outside of the vehicle pipes.

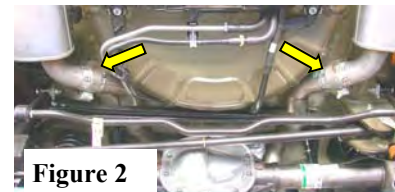
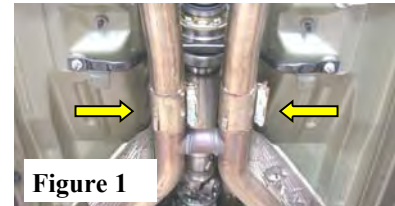

Warning: Use extreme caution during installation. Torque all fasteners according to manufacturer's torque values and tightening sequence. **DO NOT** use air impact tools to tighten fasteners on Borla Performance Exhaust Systems. Use of such tools may result in bent flanges or gasket contact areas leading to exhaust leaks.

Borla Performance Cat-Back™ Exhaust System Installation

1. Place a clamp provided over the expanded end of the X-Pipe assembly and set it up into position installing the hangers into the rubber isolators. Do Not tighten the clamps. (See Fig. 7)
2. Place a clamp provided over the expanded end of the left (driver side) and right (passenger) side muffler assemblies and set them into position. Do Not tighten the clamps. (See Fig. 8)
3. Place the original clamp over the front end of left (driver) side and right (passenger) over axle pipes and set them into position by first installing the rear portion into the muffler assembly than the front into the X pipe assembly. Do Not tighten the clamps. (See Fig. 9)
4. Check your exhaust system for proper clearance under the vehicle and also for tip alignment.
5. Once position has been determined to be correct, tighten the Accuseal™ and factory clamps to 32-35 ft. lbs making sure the clamp opening is not over any of the notches.
7. Before starting your vehicle, make sure to check all wires, hoses, brake lines, body parts and tires for safe clearance from the exhaust system.
8. Start vehicle and check for any leaks. If any leaks are found, determine cause (such as loose or incorrectly positioned clamp) and repair as necessary.

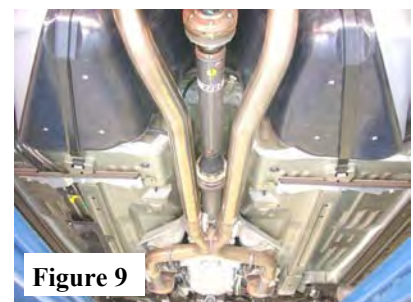
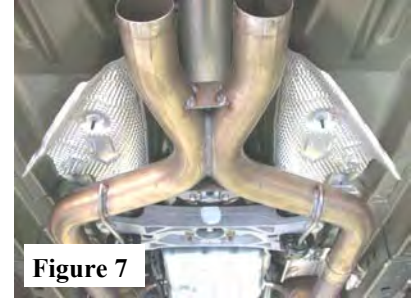

Note: When you first start your vehicle after the installation of your new Borla Performance Exhaust System, there may be some smoke and fumes coming from the system. This is a protective oil based coating used in the manufacturing of mandrel bent performance exhaust tubing. This is not a problem and will disappear within a very short period of time after the exhaust has reached normal operating temperatures.