

Exhaust System Installation For Chevrolet Cobalt SS

PN-140359



These instructions have been written to help you with the installation of your Borla Performance Exhaust System. Please read this document completely before beginning the installation of your system.

Please compare the parts in the box with the bill of materials provided to assure that you have all the parts necessary for this installation.

To ensure this part number fits your specific model year, please visit our website for the latest model year listings at www.BORLA.com.

Thank you for purchasing a Borla Performance Cat-Back™ Exhaust System.

This Borla Performance Cat-Back™ Exhaust System is designed for the Chevrolet Cobalt SS equipped with a 2.0L Turbo engine, FWD, and manual transmission.

Borla Performance Industries recommends that an exhaust shop or professional after market parts installer perform the installation of this system. However, if you decide to perform the installation on your own it is recommended that two people are used. This installation should not be performed by one person due to the risk of injury. Ensure the installers use all under car safety precautions including eye protection.

Please take time to read and understand the following...

By installing your Borla Performance Exhaust System, you indicate that you have read this document and you agree with the terms stated below. It is the responsibility of the purchaser to follow all installation instruction guidelines and safety procedures supplied with your Borla Performance Exhaust System

Borla Performance Industries assumes no responsibility for damages occurring from misuse, abuse, improper installation, improper operation, lack of responsible care, or all previously stated reasons resulting from incompatibility with other manufacturer's products and/or systems.

Included with your Borla Performance Exhaust System is a warranty card. Please read it carefully before you begin any work on your vehicle. If you should have any questions regarding our warranty policy, installation, or any other matter pertaining to your new Borla Performance Exhaust System, please give us a call at the number provided on the warranty card.

Minimum Required Tool List:

TOOLS:

1. 3/8" Drive Ratchet
2. 3/8" Drive Extension 3"
3. 15mm Socket
4. Pry Bar

SHOP SUPPLIES:

- 1 Spray Lubricant

Borla Performance Cat-back™ Bill of Materials

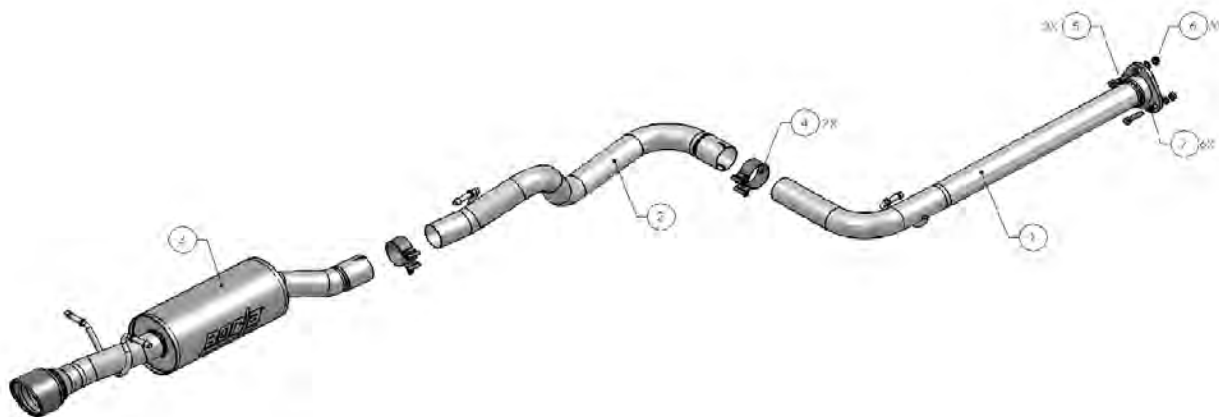

1. Front Pipe Assembly
2. Intermediate Pipe Assembly
3. Muffler Assembly
4. 2.50" clamp (qty 1)
5. Screw, (M10 x 40mm x 1.5p)
6. Nut (M10 x 1.50p)
7. Flat Washer (M10)

Caution!!! *Never work on a hot exhaust system. Serious injury in the form of burns can result* If the vehicle has been in use and the exhaust system is hot, allow vehicle to cool for at least 1 hour. Always wear eye protection when working under any vehicle.

Note: It is our recommendation that you use a hoist or hydraulic lift to facilitate the installation of your new Borla Performance Exhaust System. Taking all under car safety precautions, lift the vehicle using a hoist or hydraulic lift. Once this has been done, you may begin the removal of your old exhaust system from your vehicle.

Note: Before removing the original exhaust system from your vehicle, please compare the parts you have received with the bill of materials provided on the previous page to assure that you have all the parts necessary for the installation of your new Borla Performance Exhaust System.

Original Exhaust System Removal

Note: With a used vehicle, we suggest a penetrating spray lubricant to be applied liberally to all exhaust fasteners and allowing a significant period of time for the chemical to lubricate the threads before attempting to disassemble.

Note: Keep ALL hardware for installation of your new Borla Cat-Back exhaust

1. Lubricate all hangers and rubber isolators.
2. Cut the pipe of the exhaust pipe in front of the rear muffler as shown (See Fig.1)
3. Carefully remove the rear muffler from the rubber isolators. Remove rear muffler section. (See Fig. 2)
4. Unbolt (3) bolts on front flange behind the catalytic converter. Remove this front-pipe section from hangars and remove pipe section carefully from vehicle. **NOTE: Keep flange gasket for installation of your new Borla cat-back.** (See Fig. 3).

Warning: Use extreme caution during installation. Torque all fasteners according to manufacturer's torque values and tightening sequence. **DO NOT** use air impact tools to tighten fasteners on Borla Performance Exhaust Systems. Use of such tools may result in bent flanges or gasket contact areas leading to exhaust leaks.

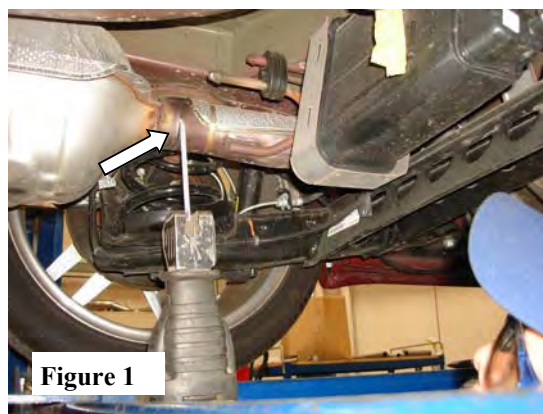

Borla Performance Cat-Back™ Exhaust System Installation

1. Orient front gasket as shown (See Fig.4). Using a muffler stand to support the Front Pipe Assembly, insert hangers into rubber isolators (See Fig.5) and attach Front Pipe using provided hardware. Tighten the flange hardware to 18-22 ft. lbs. (See Fig.6)
2. Place a clamp over the expanded end of the Intermediate Pipe Assemble and insert into the Front Pipe Assembly. **Lightly tighten clamp bolt orienting it between the notches in the pipe.** (See Fig 6A)
3. Place a clamp over the expanded end of the Muffler Assemble and insert into the Intermediate Pipe Assembly. (See Fig.7) **Lightly tighten clamp bolt orienting it between the notches in the pipe.** (See Fig 6A)
4. Orient Intermediate Pipe and Muffler Assembly where exhaust tip is centered in valence cutout. (See Fig.8)
5. Once position has been determined to be correct, tighten the accusal clamps to 35 ft.lbs. **Do not over-tighten bolts.**
6. Before starting your vehicle, make sure to check all wires, hoses, brake lines, body parts and tires for safe clearance from the exhaust system.
7. Start vehicle and check for any leaks. If any leaks are found, determine cause and repair as necessary.

Note: When you first start your vehicle after the installation of your new Borla Performance Exhaust System, there may be some smoke and fumes coming from the system. This is a protective oil based coating used in the manufacturing of mandrel bent performance exhaust tubing. This is not a problem and will disappear within a very short period of time after the exhaust has reached normal operating temperatures.

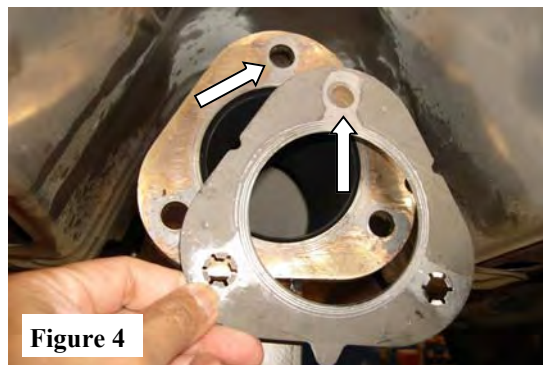
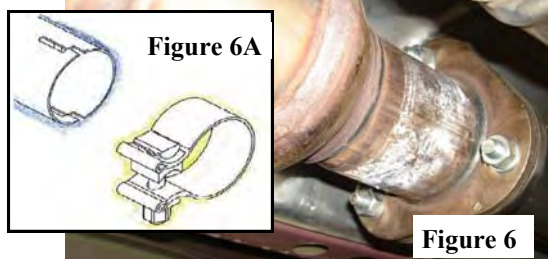
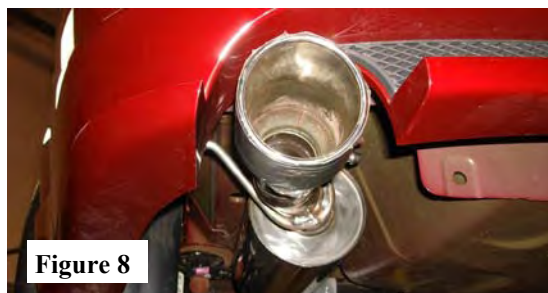
**Figure 4****Figure 5****Figure 6A****Figure 6****Figure 7****Figure 8**