



Thank you for purchasing a Borla Performance Cat-Back™ Exhaust System.

Precision manufactured using aircraft quality T-304 stainless steel; this system is designed to endure years of heavy use. Installing a Borla Performance Exhaust System on your vehicle will eliminate the restrictive design of the stock exhaust, allowing your engine to discharge exhaust gas easier. The result is more horsepower and torque, longer engine life, and a distinctive throaty growl- all this, with easy bolt-on installation. These installation instructions have been written to help you in the installation of your Borla Performance Exhaust System. Please read it completely before installing your system.

This Borla Performance Cat-Back™ Exhaust System (Part number 14982) has been designed for the 2001-2003 Chevrolet Tahoe and 2001-2003 GMC Yukon each equipped with two or four wheel drive, a 5.3L V8 engine and automatic transmission.

<p>Borla Performance Industries recommends that an exhaust shop or professional after market parts installer, who has all the necessary equipment, tools and experienced personnel needed for proper installation, should perform the installation of this system. However, if you decide to perform the installation, we recommend someone should help you. Ensure the installer uses all under car safety precautions including eye protection.</p>

Please take time to read and understand the following...

By installing your Borla Performance Exhaust System, you indicate that you have read this document and you agree with the terms stated below.

It is the responsibility of the purchaser to follow all installation instruction guidelines and safety procedures supplied with your Borla Performance Exhaust System.

Borla Performance Industries assumes no responsibility for damages occurring from misuse, abuse, improper installation, improper operation, lack of responsible care, or all previously stated reasons resulting from incompatibility with other manufacturer's products and/or systems.

Included with your Borla Performance Exhaust System is a warranty card. Please read it carefully before you begin any work on your vehicle. If you should have any questions regarding our warranty policy, installation, or any other matter pertaining to your new Borla Performance Exhaust System, please give us a call at the number provided on the warranty card.

Borla Performance Cat-Back™ Bill of Materials

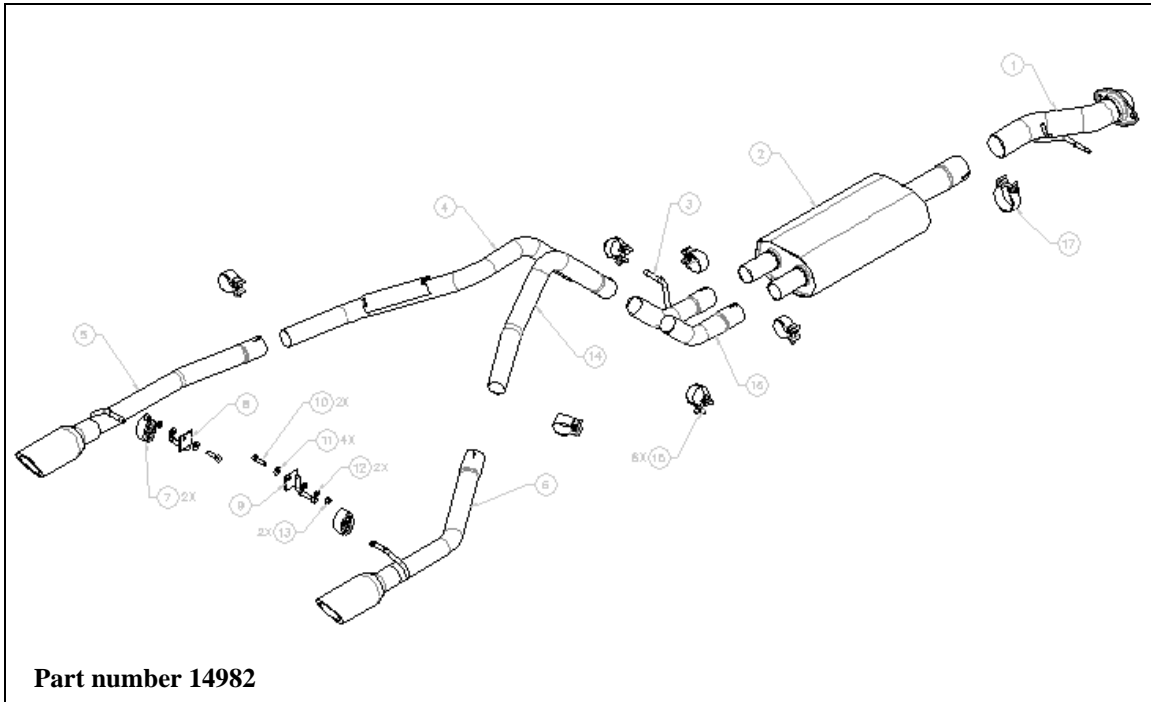

1. Front pipe assembly
2. Muffler assembly
3. Left muffler outlet pipe
4. Left intermediate pipe
5. Left tail pipe assembly
6. Right tail pipe assembly
7. Rubber bracket (qty 2)
8. Left hanger/bracket assembly
9. Right hanger/bracket assembly
10. Hex head screw (qty 2)
11. Flat washer (qty 4)
12. Lock washer (qty 2)
13. Hex nut (qty 2)
14. Right intermediate pipe
15. 2.25" Accuseal™ clamp (qty 6)
16. Right muffler outlet pipe
17. 3.00" Accuseal™ clamp

Caution!!! *Never work on a hot exhaust system. Serious injury in the form of burns can result* If the vehicle has been in use and the exhaust system is hot, allow vehicle to cool for at least 1 hour. Always wear eye protection when working under any vehicle.

Note: It is our recommendation that you use a hoist or hydraulic lift to facilitate the installation of your new Borla Performance Cat-Back™ Exhaust System.

Taking all under car safety precautions, lift the vehicle using a hoist or hydraulic lift. Once this has been done, you may begin the removal of your old exhaust system from your vehicle.

Note: Before removing the original exhaust system from your vehicle, please compare the parts you have received with the bill of materials provided on the previous page to assure that you have all the parts necessary for the installation of your new Borla Performance Cat-Back™ Exhaust System.

Original Exhaust System Removal

Note: With a used vehicle, we suggest a penetrating spray lubricant to be applied liberally to all exhaust fasteners and allowing a significant period of time for the chemical to lubricate the threads before attempting to disassemble.

1. Remove spare tire as recommended by vehicle manufacturer.
2. Cut exhaust pipe just in front of muffler assembly as shown in figure 1.
3. Unbolt front pipe flange shown in figure 2 connecting exhaust system to y-pipe assembly and remove front pipe from vehicle.

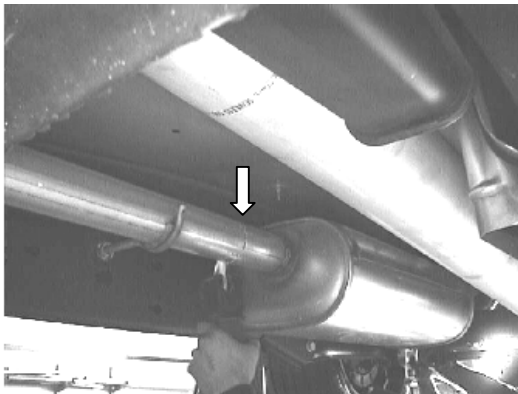

Figure 1



Figure 2

4. Supporting exhaust system with a muffler stand or an additional person, lubricate all rubber brackets and remove hangers from rubber brackets.
5. Remove old exhaust system from vehicle.

You are now ready for the installation of your Borla Performance Cat-Back™ System.

Borla Performance Cat-Back™ Exhaust System Installation

Warning: Use extreme caution during installation. Torque all fasteners according to manufacturer's torque values and tightening sequence. DO NOT use air impact tools to tighten fasteners on Borla Performance Exhaust Systems. Use of such tools may result in bent flanges or gasket contact areas leading to exhaust leaks. If any welding is performed, protect vehicle brake, fuel, vacuum or similar lines. Always check for any damage after welding has been done. Also check inside vehicle for damage to such items as carpet, inner liner, etc. Always have a class C fire extinguisher and a bucket of water available during any welding process.

1. Place front pipe assembly into position shown in figure 3 and insert hanger into rubber bracket. Install hardware onto flange and hand tighten them for now.
2. Place a clamp over the expanded end of the inlet pipe on the muffler assembly. Now place the muffler assembly in position shown in figure 4. DO NOT tighten the clamps.



Figure 3



Figure 4

3. Place clamps over expanded end of left and right muffler outlet pipe and install each one into position as shown in figure 5. Install hanger into rubber bracket on left outlet pipe assembly. DO NOT tighten clamps.
4. Place clamps over expanded end of left and right intermediate pipe assemblies and install into position over the rear axle of the vehicle. DO NOT tighten clamps.
5. Install hanger supplied on the outside of each frame rail as shown in figure 6 using the hardware provided. Once installed, place rubber bracket onto hanger assembly.



Figure 5



Figure 6

6. Place clamp over expanded end of left and right tail pipe assembly and install into position as shown in figure 7. Install hangers into rubber brackets.
7. Align tips and tighten the hardware securing the flange to the vehicle manufacturers recommendation.
8. Tighten all the Accuseal™ clamps to 32-35 ft. lbs. working from the front of the vehicle to the rear.



Figure 7

9. Before starting your vehicle, remove all plastic from the system and make sure to check all wires, hoses, brake lines, body parts and tires for safe clearance from the exhaust system.
10. Start vehicle and check for any leaks. If any leaks are found, determine cause (such as loose or incorrectly positioned clamp) and repair as necessary.
11. Install spare tire as recommended by vehicle manufacturer.

Note: When you first start your vehicle after the installation of your new Borla Performance Exhaust System, there may be some smoke and fumes coming from the system. This is a protective oil based coating used in the manufacturing of mandrel bent performance exhaust tubing. This is not a problem and will disappear within a very short period of time after the exhaust has reached normal operating temperatures.



Congratulations!!! You have completed the installation of the world famous Borla Performance Stainless Steel Exhaust System.