

2005-2007 Porsche 997 Header Installation



Precision manufactured using aircraft quality T-304 stainless steel; this system is designed to endure years of heavy use. Installing a Borla Performance Exhaust System on your vehicle will eliminate the restrictive design of the stock exhaust, allowing your engine to discharge exhaust gas easier. The result is more horsepower and torque, longer engine life, and a distinctive throaty growl- all this, with easy bolt-on installation. These installation instructions have been written to help you in the installation of your Borla Performance Exhaust System. Please read it completely before installing your system.

Thank you for purchasing a Borla Performance Stainless Steel Header System

This Borla Performance Stainless Steel Header System (Part number 17240) has been designed for designed for the 2005-2007 Porsche 997 equipped with a 3.6L 6 cylinder engine, rear-wheel drive and a manual transmission.

FOR RACING USE ONLY. NOT LEGAL FOR USE ON PUBLIC ROADS.

Borla Performance Industries recommends that an exhaust shop or professional after market parts installer, who has all the necessary equipment, tools and experienced personnel needed for proper installation, should perform the installation of this system. However, if you decide to perform the installation, we recommend someone should help you. Ensure the installer uses all under car safety precautions including eye protection.

Please take time to read and understand the following...

By installing your Borla Performance Stainless Steel header system, you indicate that you have read this document and you agree with the terms stated below.

It is the responsibility of the purchaser to follow all installation instruction guidelines and safety procedures supplied with your Borla Performance Header System

Borla Performance Industries assumes no responsibility for damages occurring from misuse, abuse, improper installation, improper operation, lack of responsible care, or all previously stated reasons resulting from incompatibility with other manufacturer's products and/or systems.

Included with your Borla Performance Exhaust System is a warranty card. Please read it carefully before you begin any work on your vehicle. If you should have any questions regarding our warranty policy, installation, or any other matter pertaining to your new Borla Performance Exhaust System, please give us a call at the number provided on the warranty card.

Minimum Required Tool List:

TOOLS:

- 1 3/8" Drive Ratchet
- 2 3/8" Drive Extension 3"
- 3 15mm Socket

SHOP SUPPLIES:

- 1 Spray Lubricant

Borla Performance Stainless Steel Header System Bill of Materials

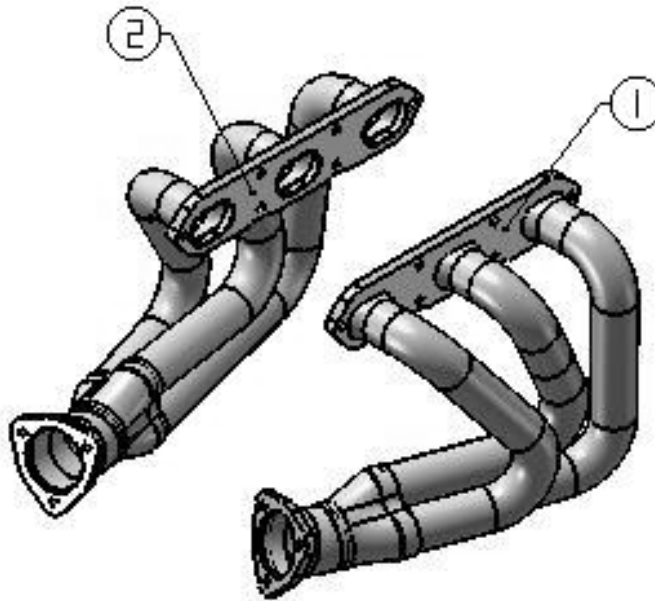

1. Right header assembly
2. Left header assembly

Caution!!! *Never work on a hot exhaust system. Serious injury in the form of burns can result* If the vehicle has been in use and the exhaust system is hot, allow vehicle to cool for at least 1 hour. Always wear eye protection when working under any vehicle.

Note: It is our recommendation that you use a hoist or hydraulic lift to facilitate the installation of your new Borla Performance Header System.

Taking all under car safety precautions, lift the vehicle using a hoist or hydraulic lift. Once this has been done, you may begin the removal of your old exhaust system from your vehicle.

Note: Before removing the original exhaust system from your vehicle, please compare the parts you have received with the bill of materials provided on the previous page to assure that you have all the parts necessary for the installation of your new Borla Performance Header System.

Original Exhaust Manifold Removal

Note: With a used vehicle, we suggest a penetrating spray lubricant to be applied liberally to all exhaust fasteners and allowing a significant period of time for the chemical to lubricate the threads before attempting to disassemble.

1. Disconnect the battery as recommended by vehicle manufacturer.
2. Unbolt the left collector flange as shown in figure 1. Place the hardware to the side for use during the installation of your new Borla Performance Stainless Steel headers.
3. Unbolt the and remove the head flange hardware shown in figure 2. Place the hardware to the side for use during the installation of your new Borla Performance Stainless Steel headers.
4. Remove the original exhaust manifold from the vehicle as shown in figure 3. Place the gaskets aside for use during the installation of your new Borla Performance Stainless Steel headers.
5. Repeat steps 2-4 for the removal of the right (passenger) side exhaust manifold as shown in figure 4.



Figure 1



Figure 2



Figure 3

Warning: Use extreme caution during installation. Torque all fasteners according to manufacturer's torque values and tightening sequence. **DO NOT** use air impact tools to tighten fasteners on Borla Performance Exhaust Systems. Use of such tools may result in bent flanges or gasket contact areas leading to exhaust leaks.

Borla Performance Stainless Steel Header System Installation

1. Using the original gaskets and hardware, place the left (driver) side header into position as shown in figure 4. Tighten the hardware to 18-24 ft. lbs.
2. Repeat step 1 for the installation of the right (passenger) side header as shown in figure 5.
3. Reconnect the battery as recommended by the vehicle manufacturer.
4. Start the vehicle and allow the header to reach normal operating temperature. Allow headers to cool and then re-torque all hardware.

Note: When you first start your vehicle after the installation of your new Borla Performance Exhaust System, there may be some smoke and fumes coming from the system. This is a protective oil based coating used in the manufacturing of mandrel bent performance exhaust tubing. This is not a problem and will disappear within a very short period of time after the exhaust has reached normal operating temperatures.

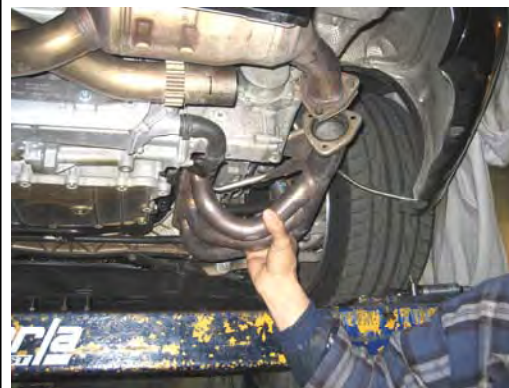

Figure 4



Figure 5