



AUTOMOTIVE GROUP

Toyota Scion XB

Set Part #114005

Rev-0 07-01-10

BUMPER PROTECTOR

STEP 1 - PRIOR TO INSTALLATION

- A)** Bushwacker only approves installing the bumper protectors according to these written instructions with the hardware provided. **WARNING:** Failure to install according to these instructions will invalidate the warranty. This includes, but is not limited to using alternative installation methods, hardware, or materials. **DO NOT USE:** Loctite, SuperGlue, or similar products on the bumper protector.
- B) Fit:** Verify the fit of the bumper protector to vehicle. (Some filing, sanding, or cutting may be necessary to ensure proper fit).
- C) Painting:** (Optional) if paint is desired it must be done prior to installing bumper protector on the vehicle clean outer surface with a good grade degreaser. **DO NOT USE LACQUER THINNER OR ENAMEL REDUCER AS A DEGREASER.** Wipe outer surface thoroughly with a tack rag prior to paint. Paint bumper protector using a high quality enamel, or polyurethane automotive paint. (Application of a primer coat is optional) If painting edge trim (not recommended), use a flex additive.

TOOLS FOR EASY INSTALLATION:

- Masking Tape

LIMITED LIFETIME WARRANTY AGAINST ANY MANUFACTURING DEFECTS

- To claim a warranty, you must provide Proof of Purchase.

Bumper Protector Installation Procedures



Open rear door of vehicle. **WITHOUT** peeling liner from tape pads, align part on bumper, the shorter center rib of the bumper protector lining up with the center of the striker latch location.



Apply a piece of masking tape along the driver side edge of part for ease of placement during installation.



Make sure that all installation surfaces are free of dirt and/or grease. Use a clean, lint-free cloth and isopropyl alcohol-based cleaner.



Peel red liners partially from tape pads. Center liner must be peeled back further or it will stick to outer liner tape pad. NOTE: Make sure tabs are folded toward the outside of the part.



Hold the part at an angle to prevent tape from prematurely sticking and align the part on bumper by aligning shorter center rib in part with center of striker latch location and using the masking tape applied in Step 2 as a guide. Stick peeled end to Bumper and pull tab nearest the rear of the vehicle while applying downward/forward pressure to the rear edge of part.

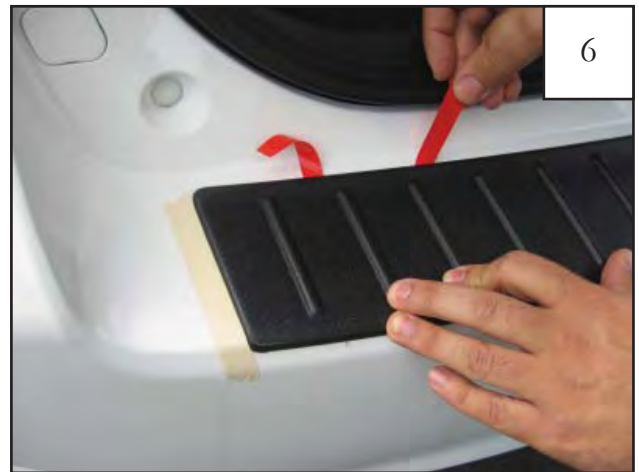

Maintaining part placement, repeat process for center liner closest to center of vehicle.



Maintaining part placement, repeat process for final tab liner.



Press the part into place starting at the left side, pushing downward and forward while working your way to the right. Apply 30 PSI to the taped areas for proper bond. Tape reaches maximum adhesive bond after 24 hours of contact.