



IMPORTANT WARRANTY & INSTALLATION INSTRUCTIONS ATTACHED

*Please Forward All Attached Information to Consumer. Warranty
Not Valid Unless Returned to CORSA Exhaust*

We ask that you take a few moments to
Complete our warranty registration form.

To Activate Your 10 Year LIMITED WARRANTY, Go To:
CORSAPERFORMANCE.COM/WARRANTY



MADE IN THE USA



For Full-Color Installation Instructions, Please Visit:
CORSAPERFORMANCE.COM & Search Part #

Please be sure to review the enclosed instructions prior to beginning the installation process. If you have any questions about the enclosed parts, instructions or encounter a problem during installation, **CALL CORSA PERFORMANCE TECHNICAL ASSISTANCE AT 800.486.0999**

Chevy Monte Carlo / Chevy Impala / Pontiac Grand Prix 2000 & newer - All models Dual Rear Exit Exhaust System Installation Instructions

TOOLS/SUPPLIES NEEDED: Safety glasses, 15mm deep socket, 15mm wrench, 5/16" Allen wrench, torque wrench & lubricant

Please be sure to review the attached instructions prior to beginning the installation process. If you have any questions about the enclosed parts, instructions or encounter a problem during installation, call CORSA Performance Technical Assistance at 800.486.0999. Do not attempt to make any modifications to parts as this will void your warranty.

All TORCA clamps should be tightened using a properly calibrated Torque Wrench. Using an air impact gun will damage the clamp and reduce its ability to effectively seal the joint. It may also cause the joint to separate thereby causing damage to your exhaust system and your vehicle.

C A U T I O N

Prior to installation, be sure your vehicle is parked on a level surface and the exhaust system is cool. For safety purposes and ease of installation, we urge you to take your vehicle to a qualified service center or muffler installer that employs the use of a lift.

Exhaust System Removal:

- 1) After your vehicle is properly secured and there is enough clearance to work under the vehicle, use 15mm socket or wrench to remove two Center Muffler flange bolts (See Fig. A).
- 2) The next step is to remove the hanger on the Center Muffler Extension Pipe (See Fig. B).

NOTE: Some models may have a second Center Muffler Extension Pipe hanger. If so, remove rubber insulator.

- 3) Next, remove two (2) rubber insulators from each Rear Muffler (See Fig. C & D). Use a lubricant to facilitate removal.

NOTE: DO NOT REMOVE THE TWO RUBBER "O-RINGS" FROM THE CATALYTIC CONVERTER PIPE (See Fig. E).

NOTE: Be sure to keep the rubber insulators as they will be needed for installation of the new exhaust system.

- 4) Now the system can be removed in one piece (See Fig. F).

Exhaust System Installation:

- 1) Remove all new exhaust system parts from the shipping cartons including clamps. NOTE: There are (4) 2-1/2" and (2) 2" clamps supplied.



FIG. A



FIG. B



FIG. C



FIG. D

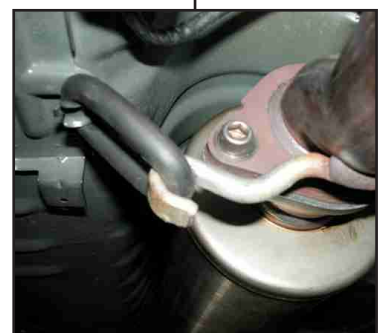

FIG. E

FOR TECHNICAL ASSISTANCE, CALL (800) 486-0999.

INSTALLATION NOTE:

Be sure to apply the anti-seize lubricant that has been provided to all bolts, fasteners and clamps. A pouch with anti-seize lubricant is included with the hardware kit. Apply the supplied anti-seize lubricant to the threads **ONLY** of all TORCA band clamps. Failure to follow this procedure can cause the nuts to seize on clamps and potentially damage threads.

WARNING: Be sure to thoroughly clean hands after use. Anti-seize lubricant will tarnish stainless steel parts.

IMPORTANT NOTE: If you are converting from a single tail pipe exhaust to this, a CORSA dual exit exhaust system, you will need to purchase another muffler hanger to complete this installation. Contact your nearest GM dealer for the correct muffler hanger. (See Page 5).

- 2) Locate Center Muffler (See Fig. G) and Flange Gasket, Bolts and Nuts (See Fig. H).
- 3) Place Gasket on Catalytic Converter flange (See Fig. I) and using supplied Flange Bolts, position Center Muffler flange. You can tighten the Flange hardware to recommended torque setting (See Fig. J).

NOTE: Center Muffler weld seam must face up (See Fig. K).

- 4) Locate Center Muffler Extension Pipe and place a TORCA clamp on inlet end (See Fig. L) and slide over Center Muffler outlet and snug fit clamp. Next, insert Extension Pipe hanger into rubber insulator.
- 5) Locate "Y" Pipe and slide a TORCA clamp over inlet (See Fig. M) and slide onto Extension Pipe outlet (See Fig. N) and snug fit clamp.



FIG. F



FIG. G

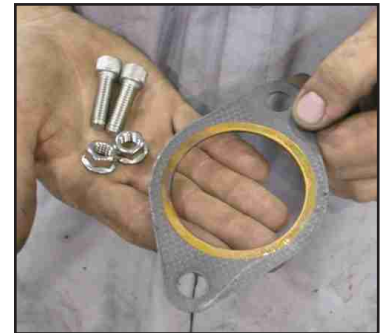

FIG. H



FIG. I

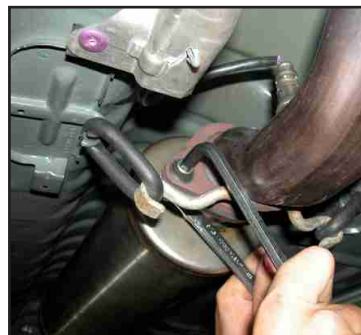

FIG. J



FIG. K

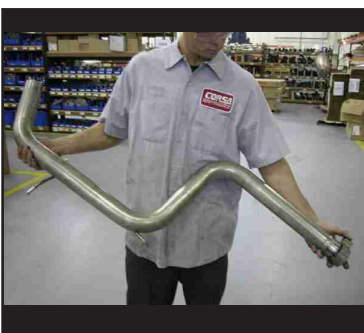

FIG. L



FIG. M



FIG. N

FOR TECHNICAL ASSISTANCE, CALL (800) 486-0999.

NOTE: At this point make sure 1) Extension Pipe is level and not in contact with body and 2) “Y” Pipe is level with Sway Bar (**See Fig. O**). If adjustments are needed, loosen clamps, push up on Extension Pipe and or “Y” Pipe and tighten clamps.

- 6) Locate either Driver or Passenger side Rear Muffler and slide a TORCA clamp over inlet (**See Fig. P**). Insert hangers into rubber insulators (**See Fig. Q**) and then position over “Y” Pipe outlet and snug fit clamp. Repeat process for other side.
- 7) Locate either Driver or Passenger side Tip Assembly and slide a TORCA clamp over inlet (**See Fig. R**) and slide over Rear Muffler (**See Fig. S**). Snug fit clamp and repeat process for other side. Be sure clamp is positioned correctly (**See Fig. T & U**).
- 8) Now, visually inspect how each muffler is positioned, alignment of the exhaust tips and check for pipe clearance. Make any needed adjustments at the various slip joints.
- 9) When you are satisfied with the positioning of the exhaust system and the exiting exhaust tips, begin tightening all clamps working from the front to rear of the vehicle. **Torque Setting: 45 ft.-lbs.**
- 10) It is MANDATORY that all clamps be checked and tightened if necessary after road testing the vehicle and after system has cooled.

NOTE: During cold weather start-ups, you may experience an exhaust sound that is deeper and louder in tone than usual. This is temporary and will diminish to normal levels once your engine has reached its normal operating temperature.

NOTE: Immediately following the installation of your CORSA exhaust system, you may experience a trace of smoke after initial start-up. Do NOT be alarmed. The smoke is caused by the burning of a small amount of forming oil residue used in manufacturing process.

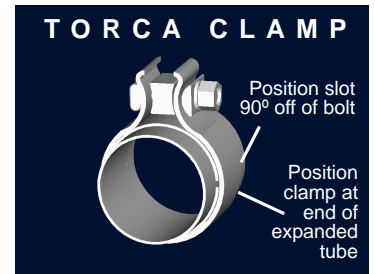

FIG. U



FIG. O



FIG. P



FIG. Q



FIG. R

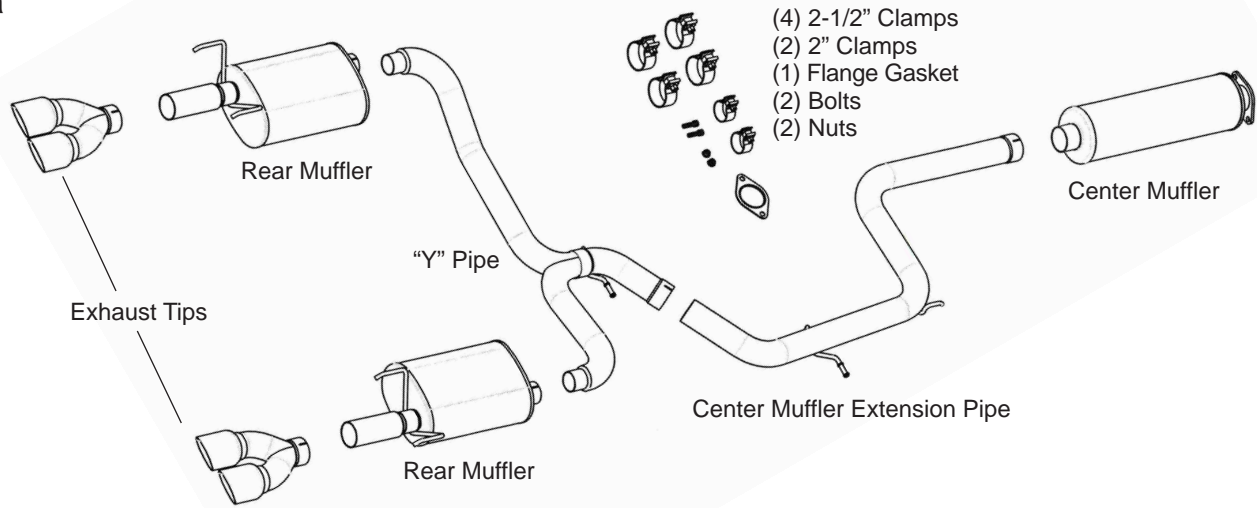

FIG. S

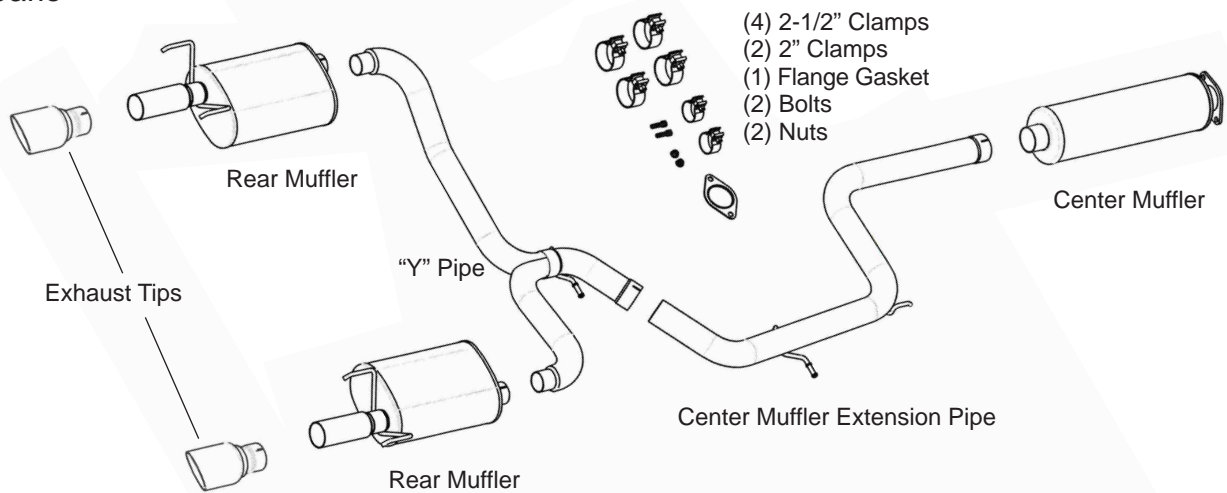

FIG. T

Impala



Monte Carlo



Grand Prix

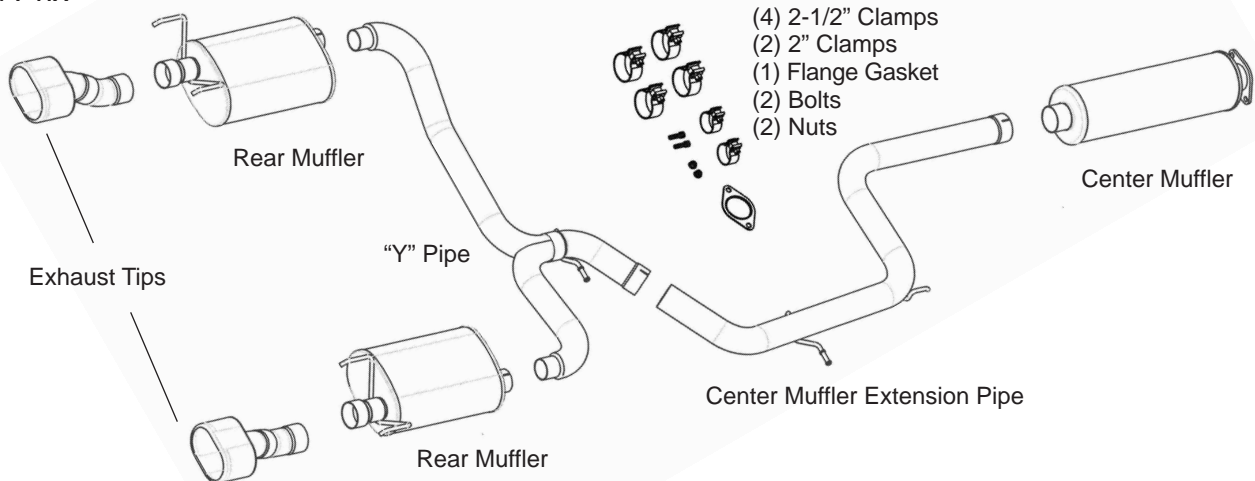

If you have any questions about the installation process, call CORSA Performance and ask one of our Sales & Technical Service Representatives. Do not attempt to make any modifications to parts as this will void your warranty. **CALL (800) 486-0999.**

Impala		
Quantity	Part Number	Description
2	11515757	Bolts
2	10304424	Rubber Insulators
1	10328741	Hanger Assembly



Monte Carlo/Grand Prix		
Quantity	Part Number	Description
2	10304424	Rubber Insulators
1	10328742	Hanger Assembly



**FOR TECHNICAL ASSISTANCE,
CALL (800) 486-0999.**