



IMPORTANT WARRANTY & INSTALLATION  
INSTRUCTIONS ATTACHED

*Please Forward All Attached Information to Consumer  
Warranty Not Valid Unless Returned to CORSA Performance*

**We ask that you take a few moments to complete our warranty registration form:**

TO ACTIVATE YOUR LIMITED LIFETIME WARRANTY GO TO:  
**[CORSAPERFORMANCE.COM/WARRANTY](http://CORSAPERFORMANCE.COM/WARRANTY)**



**For Full-Color Installation Instructions, Please Visit:  
[CORSAPERFORMANCE.COM](http://CORSAPERFORMANCE.COM) and Search by Part Number**

Please be sure to review the enclosed instructions prior to beginning the installation process. If you have any questions about the enclosed parts, instructions or encounter a problem during installation:  
**CALL CORSA PERFORMANCE TECHNICAL ASSISTANCE AT 800.486.0999**

Please take time to read and understand these installation instructions.

CORSA recommends that installation of this system be performed by a qualified service center or professional muffler installer who has the necessary equipment, tools and experienced personnel. However, if you decide to perform this install, the use of a hoist and an additional person will be required.

**CAUTION:** Never work on a hot exhaust system. Allow time for the vehicle to cool. Always wear eye protection when working under a vehicle.



Please confirm that all parts are present before beginning the factory exhaust system removal and CORSA exhaust system installation.

## Bill of Materials:

- Driver Muffler Assembly (13MV2023)
- Passenger Muffler Assembly (13MV2024)
- Hardware Kit (13MV7026)
- Packet of Anti-Seize

## Recommended Tools:

- Safety glasses
- 13mm socket and ratchet
- Long extension (12") for 13mm socket
- 1/2" socket or wrench
- Saw or chain-style pipe cutter
- Torque wrench
- File or sanding device for deburring
- Grommet pullers
- Soap and water solution

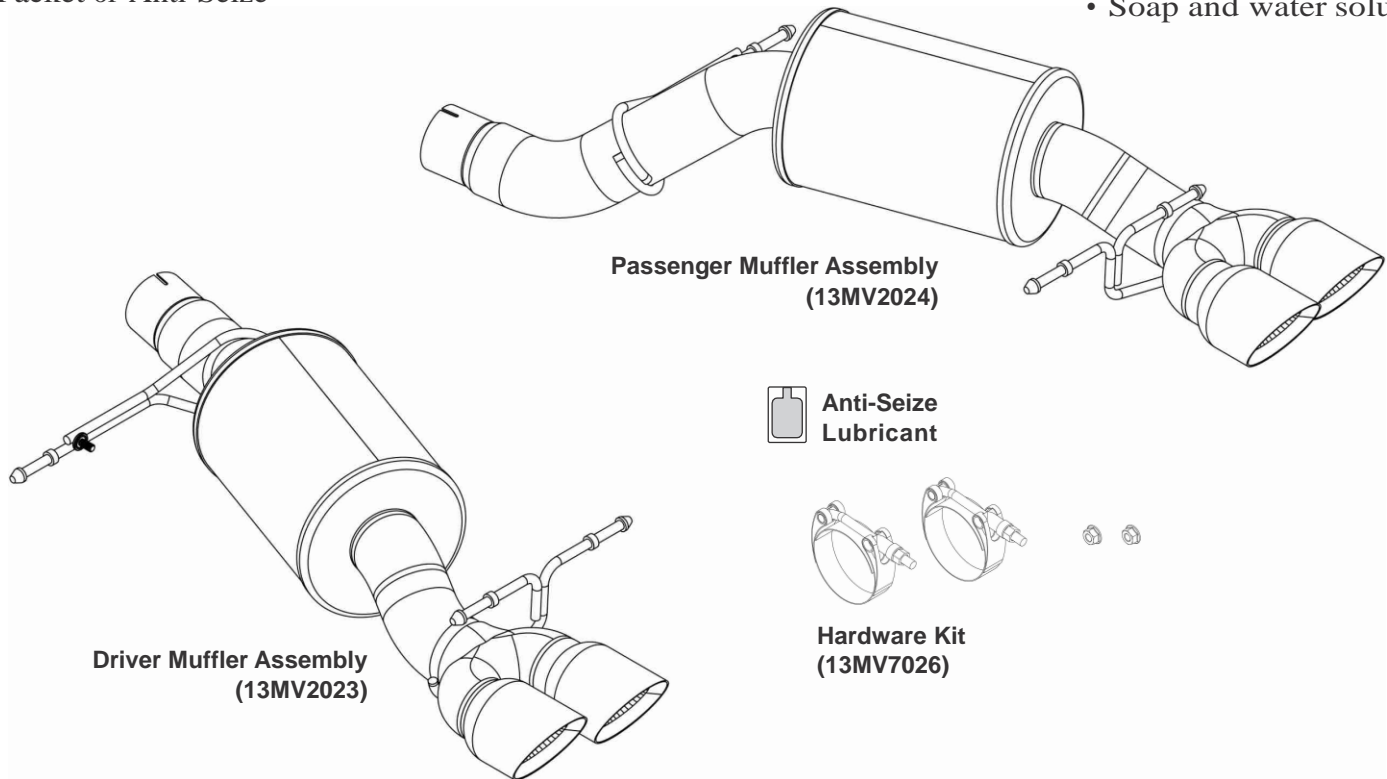

## Removal Of Stock Exhaust:

1. Measure from the end of the heat shield near the rear differential and mark the passenger side exhaust pipe at 2.75 inches. Repeat on the driver side.
2. Using a saw or chain style pipe cutter, cut each pipe at the marks. Deburr the cut edge of the retained factory pipe using a file or sanding device to aid in the installation process. **(See Fig. A)**
3. Remove ground strap and strap retaining nut from the passenger side front muffler hanger using a 13mm socket. Repeat on the driver side. Note: these two ground strap nuts will not be reused. **(See Fig. B)**
4. Unbolt the passenger side front hanger mount using a 13mm socket and ratchet. **(See Fig. C)** Use caution as the stock muffler assembly may drop down on the front side when it is only being retained by the two rear hangers.
5. Unbolt the passenger side outer rear hanger assembly using a 13mm socket and a long extension. **(See Fig. D)**
6. Unbolt the passenger side inner rear hanger using a 13mm socket and a long extension. **(See Fig. E)** This will free the stock muffler assembly from the vehicle. **(See Fig. F)** With the rear muffler on the ground, remove the factory hangers from the rubber isolators on the hanger mounts using a grommet puller or a similar device. Set aside the rear muffler hanger mounts and all retaining nuts to be reused during the installation process.

**NOTE:** The use of a soap and water solution may aid in the removal and later installation of the hangers in the rubber isolators.

7. Repeat steps 4-6 for the driver side.
8. Removal is complete. Installation of your CORSA Performance exhaust system can now begin. See Page 3.



FIG. A

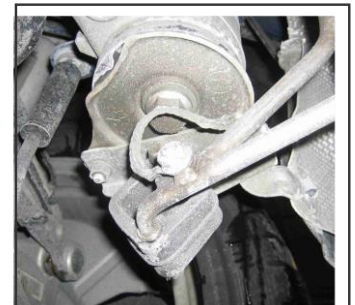

FIG. B

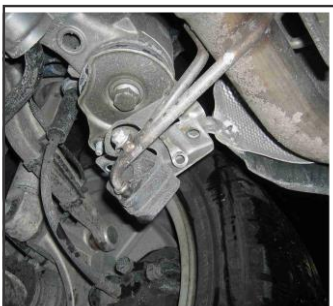

FIG. C

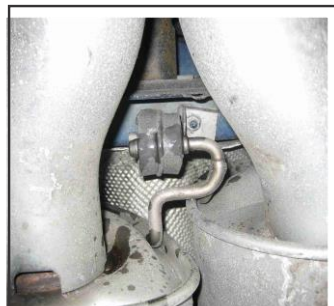

FIG. D

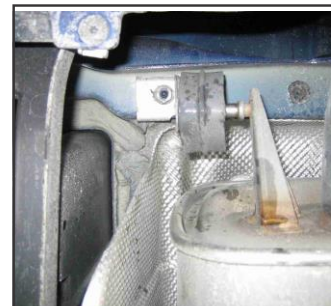

FIG. E



FIG. F

**If at any time you need technical assistance, call (800) 486-0999 to speak with a CORSA Representative.**

## Installation of CORSA Exhaust System:

**NOTE:** Apply the anti-seize lubricant (supplied) to the threads **ONLY** of all the clamps and flange bolts. Failure to follow this procedure can cause nuts to seize on clamps and potentially destroy threads. After applying anti-seize lubricant, be sure to thoroughly clean hands as lubricant will tarnish stainless steel. All clamps should be tightened using a properly calibrated Torque Wrench. Using an air impact gun will damage the clamp and reduce its ability to effectively seal the joint. It may also cause the joint to separate thereby causing damage to your exhaust system and your vehicle.

**NOTE:** Align all clamps so that the bolt is 90 degrees from the notch in the pipe. (See Fig. G)

1. Remove all exhaust system components from the shipping carton, including the two T-Bolt band clamps and the two 5/16-18 Flange nuts. (See Fig. H)

**NOTE:** The unbolted hanger assemblies from the removal process should now be installed onto the corresponding hangers on the CORSA mufflers by pushing the rubber isolators onto the hangers. Once again, a soapy water solution will aid in this installation process.

3. Properly align the band clamp (see above note) on the muffler inlet and slide the muffler inlet over the passenger side factory pipe. (See Fig. I) Make sure the muffler inlet is over the stock pipe deep enough that no gap shows through in the pipe notch.
4. Assemble both unbolted rear hanger mounts onto the threaded mounting studs, and secure with the 13mm nuts retained from the removal process. Using a torque wrench, torque the 13mm nuts to 18 ft-lbs (24 N-m). (See Fig. J & K) Repeat this process for the front hanger mount. (See Fig. L)
5. Adjust the amount of overlap of the muffler inlet pipe onto the passenger side factory pipe until the exhaust tips look properly positioned in the bumper opening, and then snug tighten the band clamp on the muffler inlet pipe using a 1/2" socket. (See Fig. M)

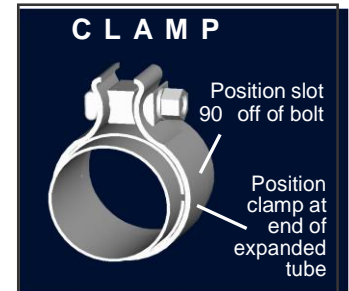

FIG. G



FIG. H



FIG. I



FIG. J



FIG. K



FIG. L

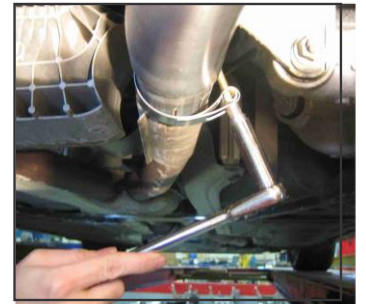

FIG. M

6. Secure the ground strap with the supplied 5/16" flange nut to the mounting stud on the passenger side front hanger using a 1/2" socket or wrench. Torque nut to 18 ft-lbs (24 N-m). **(See Fig. N)**
7. Repeat steps 2-6 for the driver side.
8. Visually inspect the exhaust system position, tip alignment, clamp orientation, and exhaust pipe clearance. Make any necessary adjustments at the slip joint.
9. When the exhaust system is in the desired location, tighten the nuts on the band clamps. Torque nuts to 45 ft-lbs (61 N-m).
10. It is **STRONGLY SUGGESTED** that all clamps be checked and re-tightened (if necessary) to the recommended torque after initial road testing of the vehicle, as thermal cycling has occurred on the system. Please wait until system has fully cooled to conduct this process.



FIG. N

**NOTE:** During cold weather start-ups, you may experience an exhaust sound that is deeper and louder in tone than usual. This is temporary and will diminish to normal levels once your engine has reached its normal operating temperature.

**NOTE:** Immediately following the installation of your CORSA exhaust system, you may experience a trace of smoke after initial start-up. DO NOT be alarmed. The smoke is caused by the burning of a small amount of forming oil residue used in the manufacturing process.